

PROFILE	SURVEYED	DATE
NOTE BOOK	GRADES CHECKED	
NO.	E.M. NOTED	
	FIELD SITE NOTATIONS ERMG	

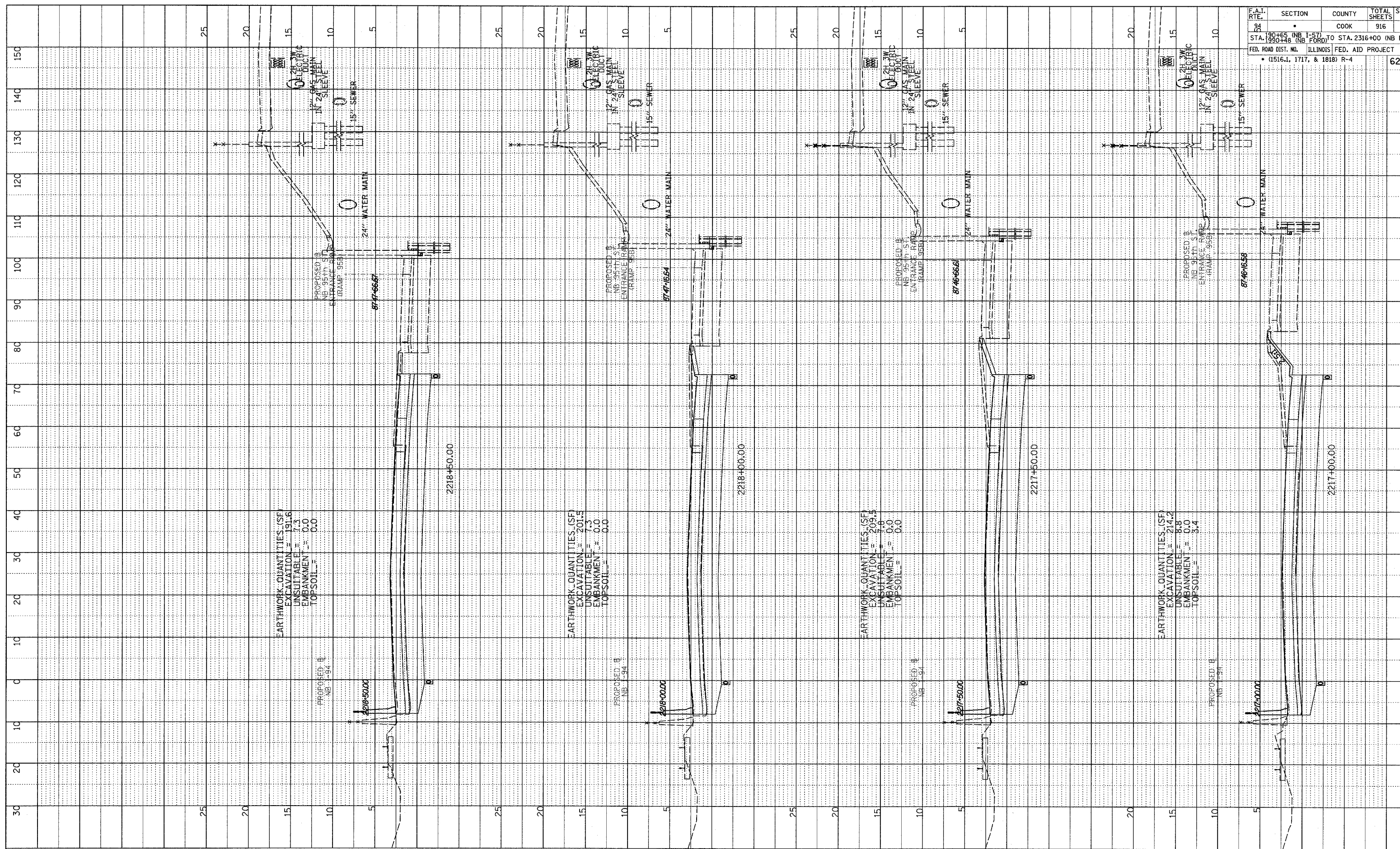

F.A.I. RTE.	SECTION	COUNTY	TOTAL SHEETS	SHEET NO.
84		COOK	916	705
STA. 190+65 (NB I-94) TO STA. 2316+00 (NB RYAN)		ILLINOIS FED. AID PROJECT		
FED. ROAD DIST. NO. 1516.1, 1717, & 1818) R-4		62584		

TYLIN INTERNATIONAL



NORTHBOUND I-94 (DAN RYAN EXPWY)  
STA. 2217+00 TO STA. 2218+50