

DATE	BY
PROFILE SURVEYED GRADES CHECKED NOTE BOOK NO.	
STRUCTURE NOTATIONS CHECKED NO.	

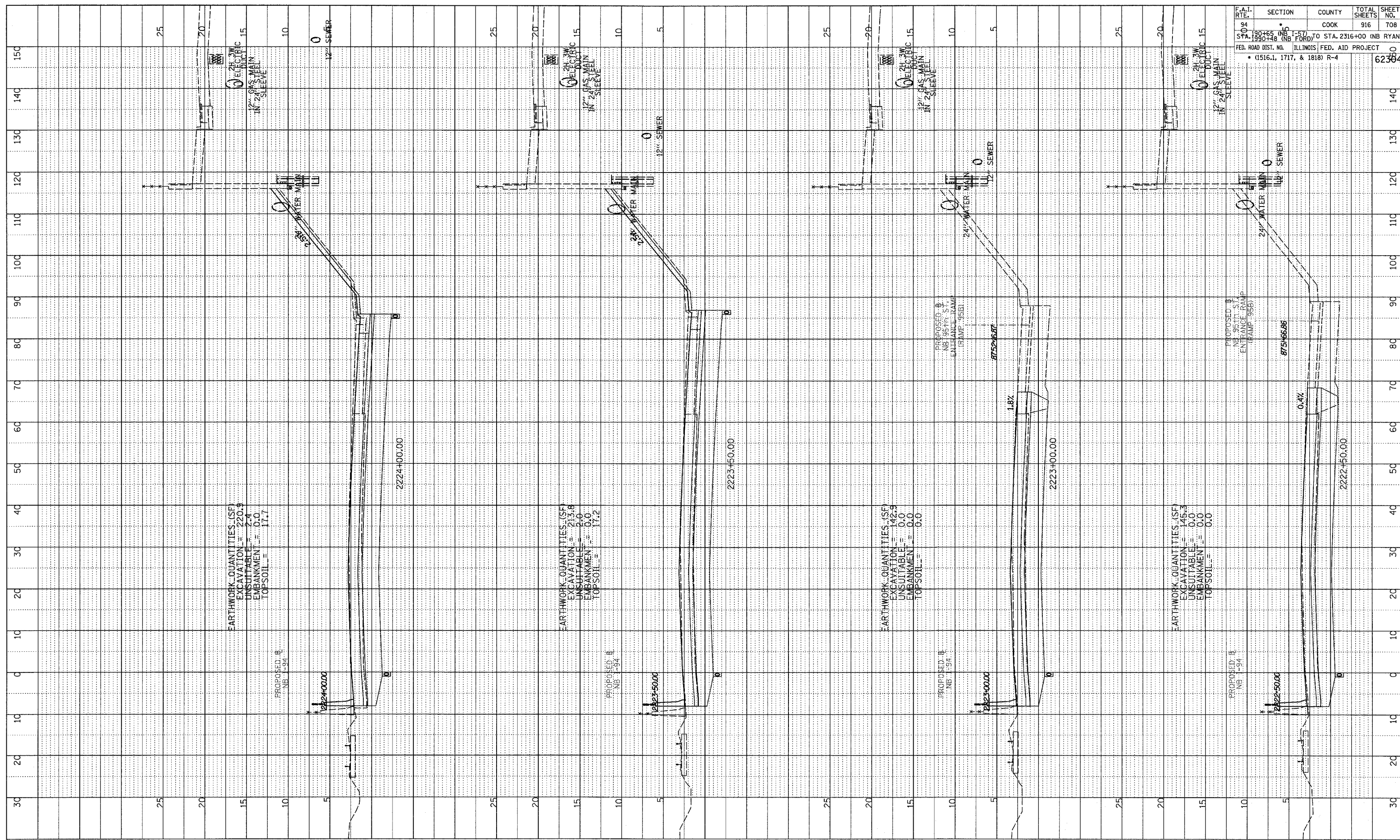

F.A.I. RTE.	SECTION	COUNTY	TOTAL SHEETS	SHEET NO.
94	5	COOK	916	708
STA. 190+48 (NB I-57) TO STA. 2316+00 (NB RYAN)				
FED. ROAD DIST. NO. ILLINOIS FED. AID PROJECT				
(1516.1, 1717, & 1818) R-4				
				62364

TYLIN INTERNATIONAL

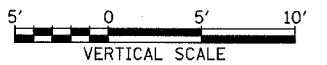

NORTHBOUND I-94 (DAN RYAN EXPWY)
 STA. 2222+50 TO STA. 2224+00

03/03/2006 04:05:57 PM