

PROFILE SURVEYED
 GRADES CHECKED
 B.M. NOTED
 STRUCTURE NOTATION CHRD
 NO.

BT

DATE

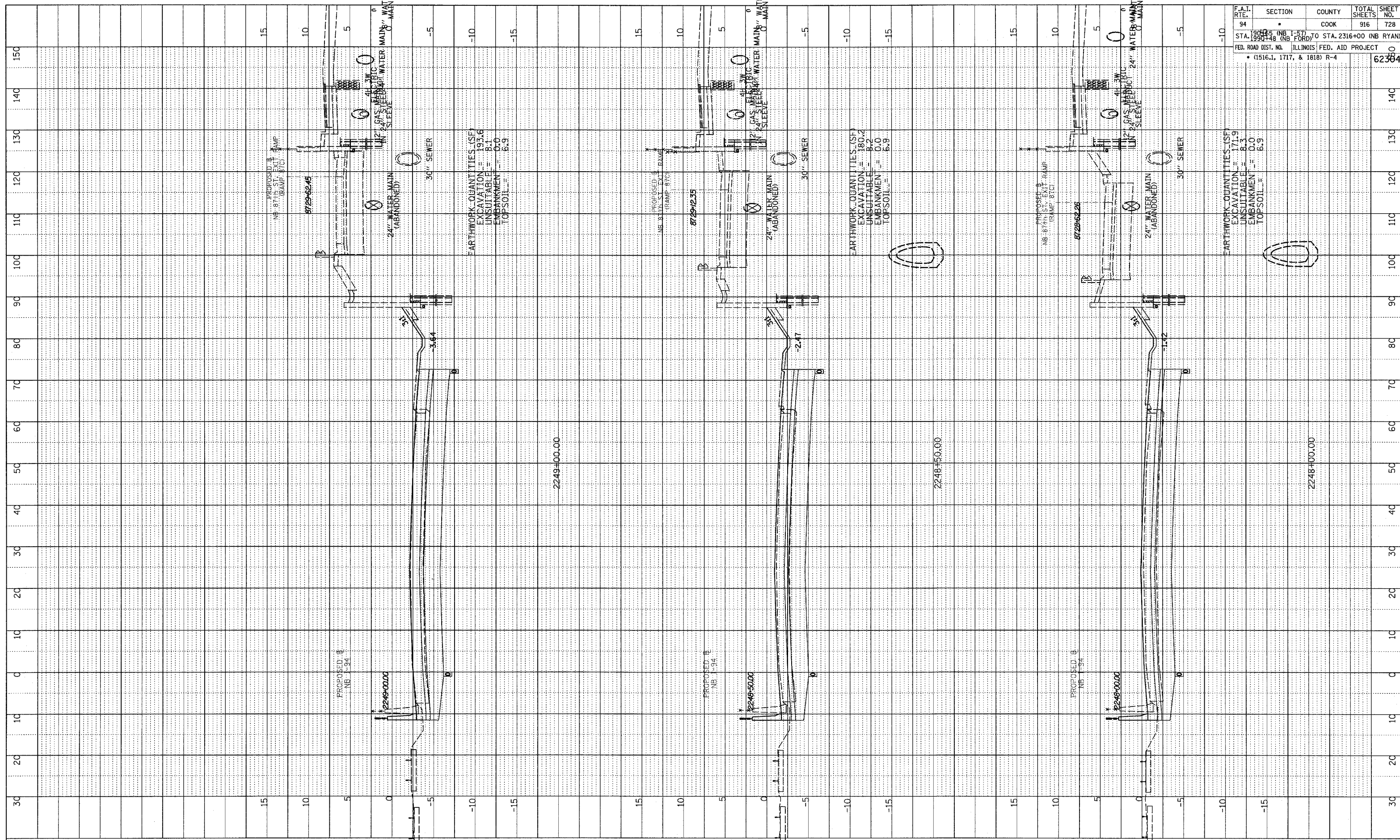

F.A.I. RTE.	SECTION	COUNTY	TOTAL SHEETS	SHEET NO.
94	•	COOK	916	728

STA. 1990+48 (NB FORD) TO STA. 2316+00 (NB RYAN)
 FED. ROAD DIST. NO. ILLINOIS FED. AID PROJECT
 • (1516.1, 1717, & 1818) R-4

TYLIN INTERNATIONAL

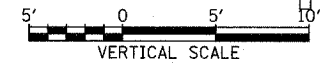
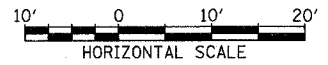

NORTHBOUND I-94 (DAN RYAN EXPWY)
 STA. 2248+00 TO STA. 2249+00

03/03/2006 04:40:08 PM