

PROFILE	DATE
BY	
REVISED	
GRADES CHECKED	
BY	
NOTE BOOK	
NO.	
INCLUDE NOTATIONS	

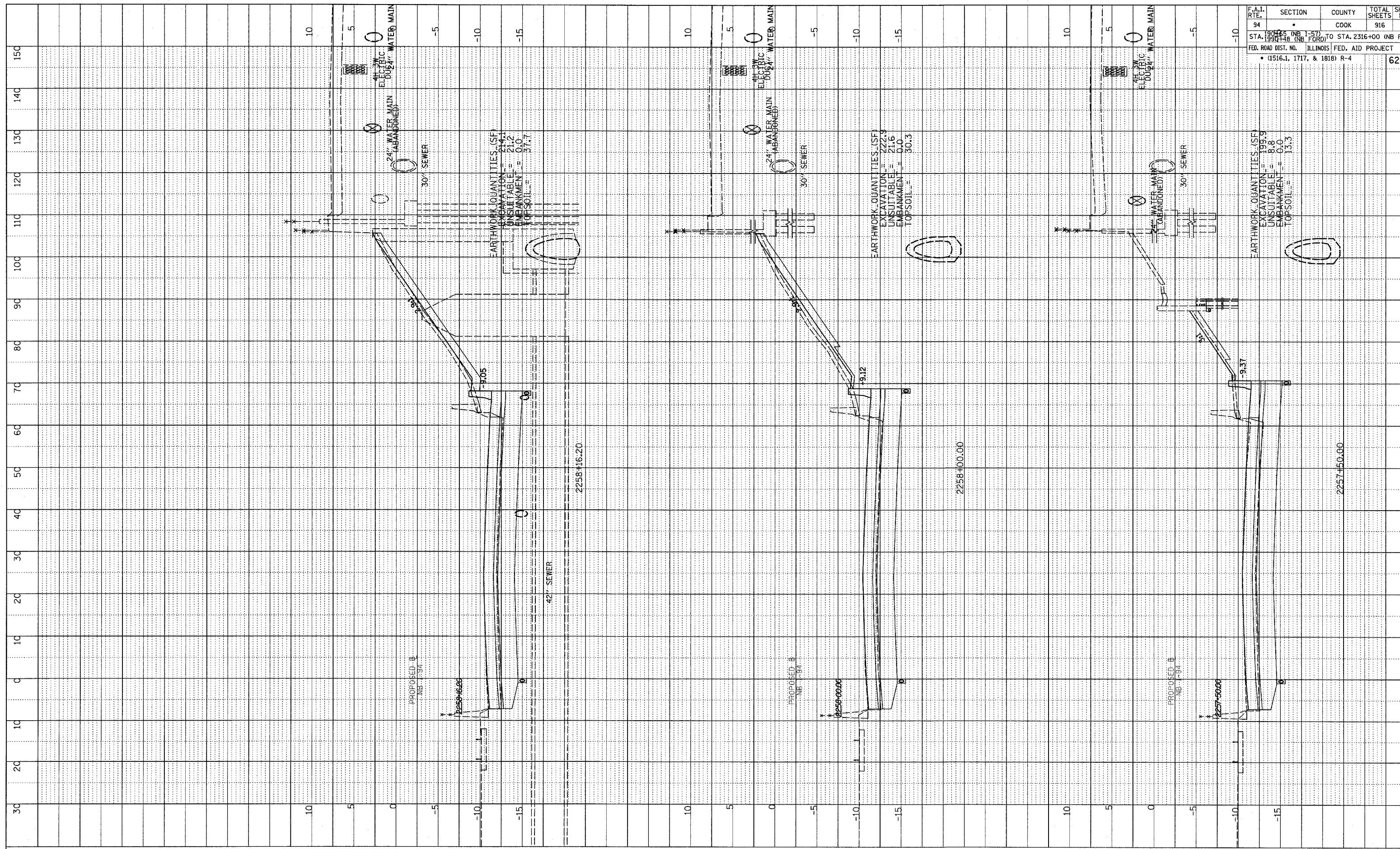

F.A.I. RTE.	SECTION	COUNTY	TOTAL SHEETS	SHEET NO.
94	•	COOK	916	735
STA. 1991+58 (NB FORD) TO STA. 2316+00 (NB RYAN)				
FED. ROAD DIST. NO. ILLINOIS FED. AID PROJECT				
• (1516.1, 1717, & 1818) R-4				
				62380

TYLIN INTERNATIONAL

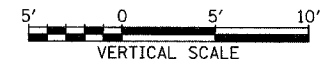
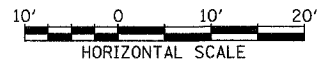

NORTHBOUND I-94 (DAN RYAN EXPWY)
 STA. 2257+50 TO STA. 2258+16.20

03/03/2006 04:16 PM