

PROFILE
 SURVEYED
 PLOTTED
 GRADES CHECKED
 NO. _____ DATE _____
 STRUCTURE NOTATIONS CHFD

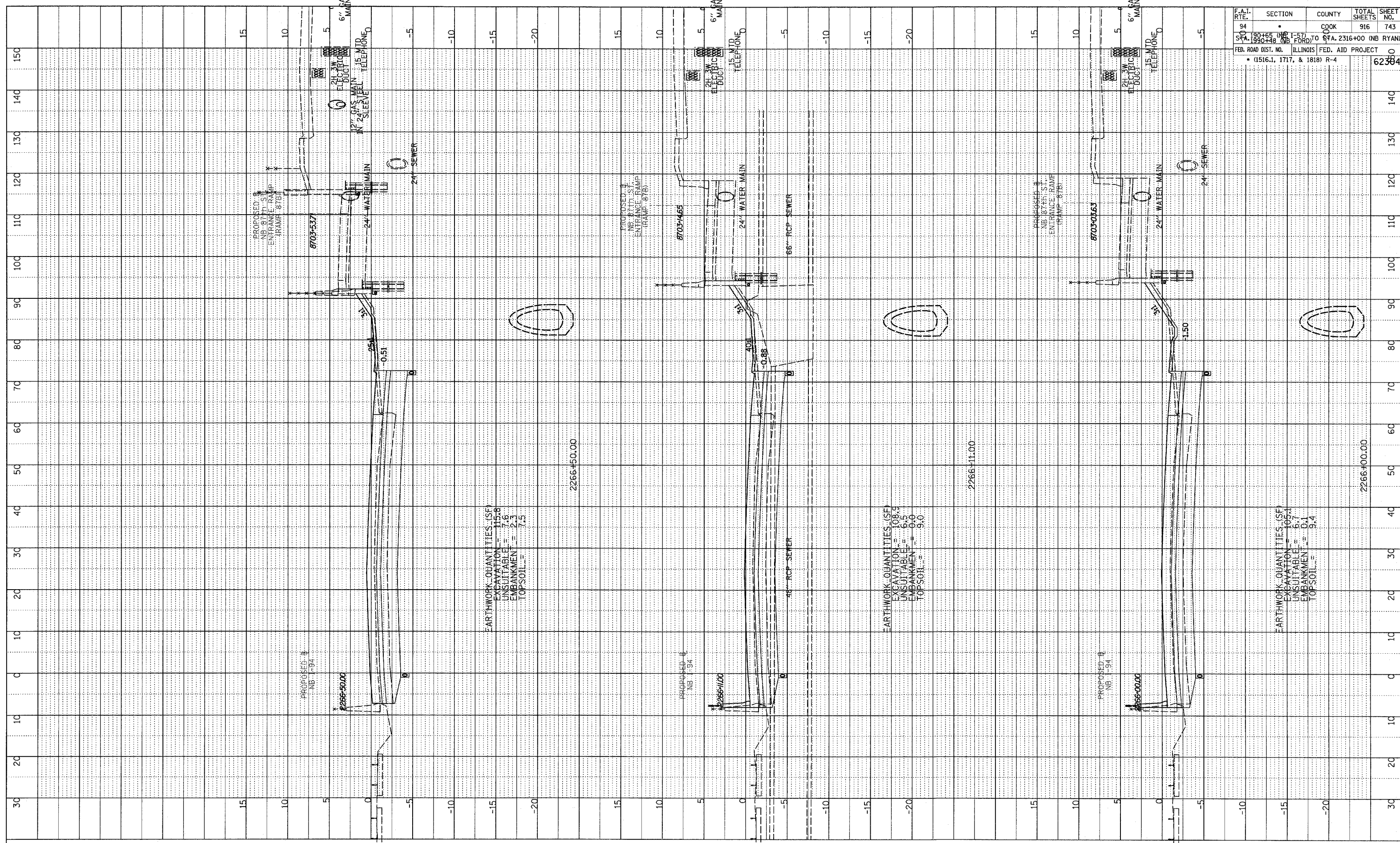

F.A.I. RTE.	SECTION	COUNTY	TOTAL SHEETS	SHEET NO.
94	•	COOK	916	743
STA. 190+65 TO STA. 195+48	•	ILLINOIS	FED. AID PROJECT	• (1516.1, 1717, & 1818) R-4

TYLIN INTERNATIONAL

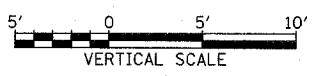
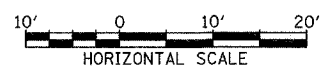

NORTHBOUND I-94 (DAN RYAN EXPWY)
 STA. 2266+00 TO STA. 2266+50

03/03/2006 04:18:30 PM
 A:\0231\94\road\20\gpk\20axis\87.dwg