

PROFILE SUBMITTED: \_\_\_\_\_ BY: \_\_\_\_\_ DATE: \_\_\_\_\_  
 NOTE BOOK GRADES CHECKED \_\_\_\_\_  
 NO. \_\_\_\_\_ PUNCH LINE NOTATIONS ERWD

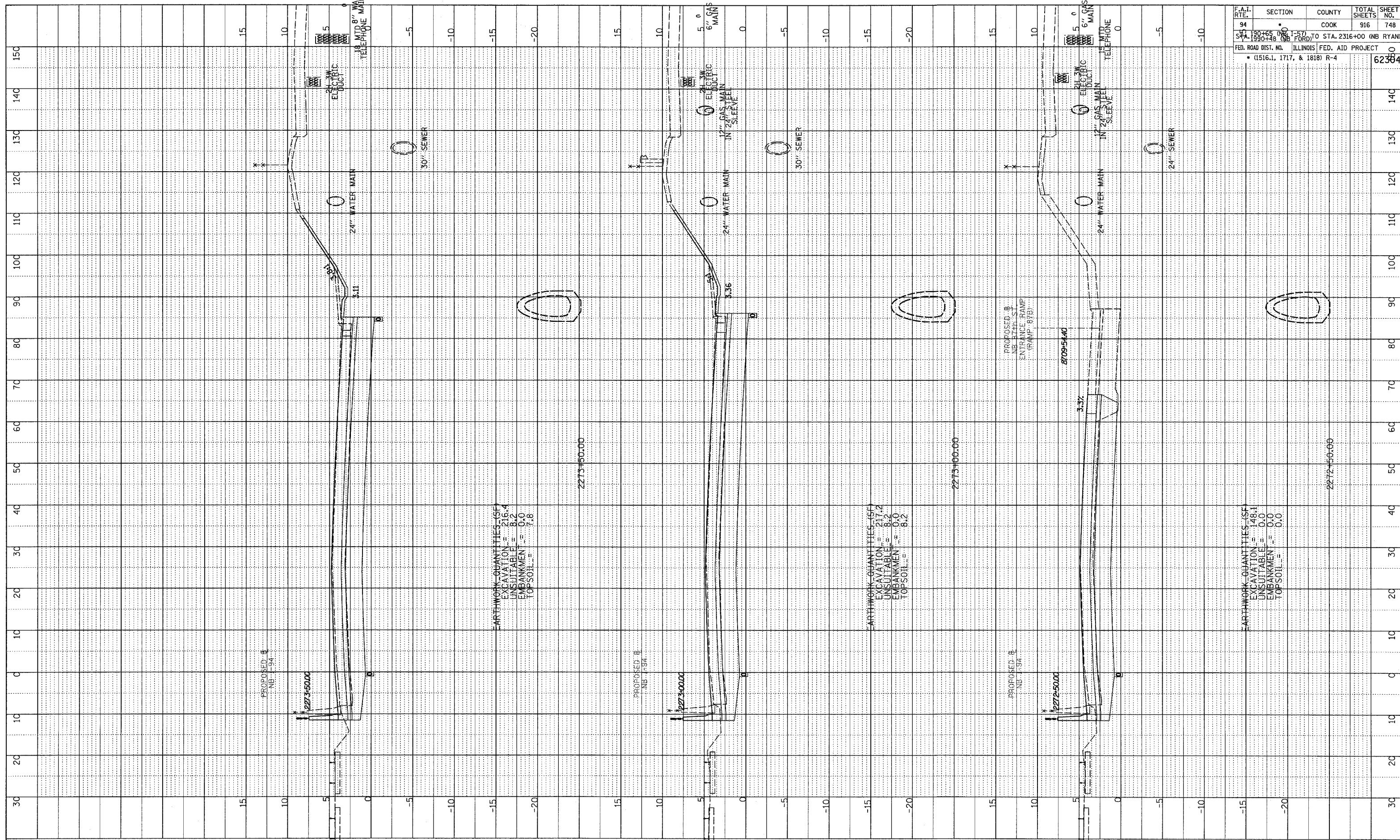

TYLIN INTERNATIONAL

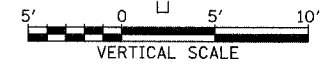
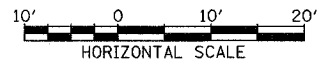

NORTHBOUND I-94 (DAN RYAN EXPWY)  
 STA. 2272+50 TO STA. 2273+50

F.A.I. RTE.	SECTION	COUNTY	TOTAL SHEETS	SHEET NO.
94	150+00 (NB I-94) TO STA. 2316+00 (NB RYAN)	COOK	916	748
ILLINOIS FED. AID PROJECT				
• (1516.1, 1717, & 1818) R-4				

03/03/2006 04:48:53 PM