

DATE	BT
BY	
NO.	
STRUCTURE	INDUSTRIAL CHWD
NOTE BOOK	
SURVEYED	CHECKED
B.M. NOTED	
GRADES	

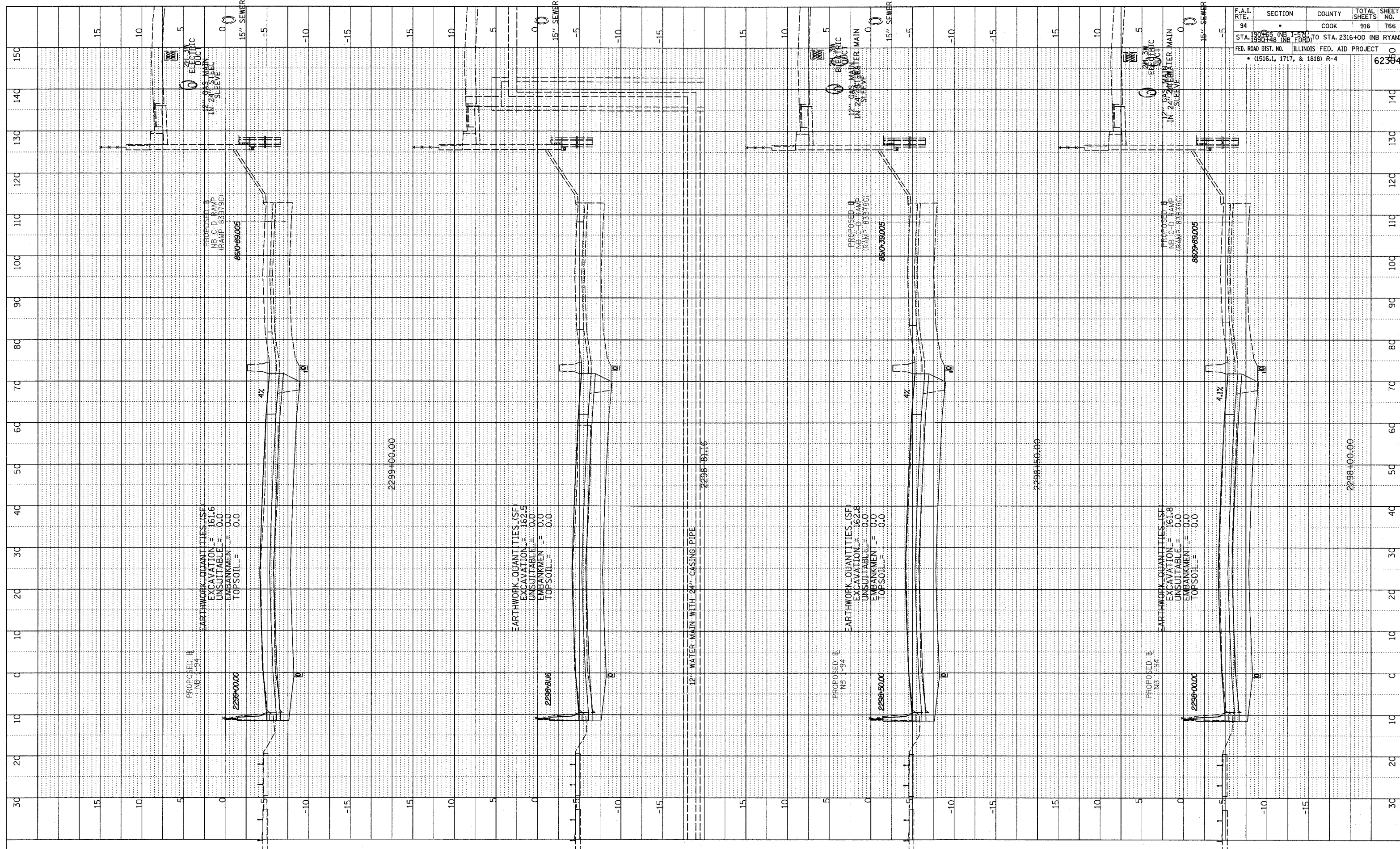

F.A.I. RTE.	SECTION	COUNTY	TOTAL SHEETS	SHEET NO.
94		COOK	916	766
STA. 190+00 (NB I-94) TO STA. 2316+00 (NB RYAN)				
FED. ROAD DIST. NO. ILLINOIS FED. AID PROJECT				
• (1516.1, 1717, & 1818) R-4				

TYLIN INTERNATIONAL



NORTHBOUND I-94 (DAN RYAN EXPWY)  
STA. 2298+00 TO STA. 2299+00

03/03/2006 04:46:50 PM