

PROFILE SURVEYED _____ DATE _____
 NOTE BOOK _____
 NO. _____
 SURVEYED BY _____
 GRADES CHECKED _____
 B.M. NOTED _____
 PHOTOLOGIC NOTATIONS SHOWN _____

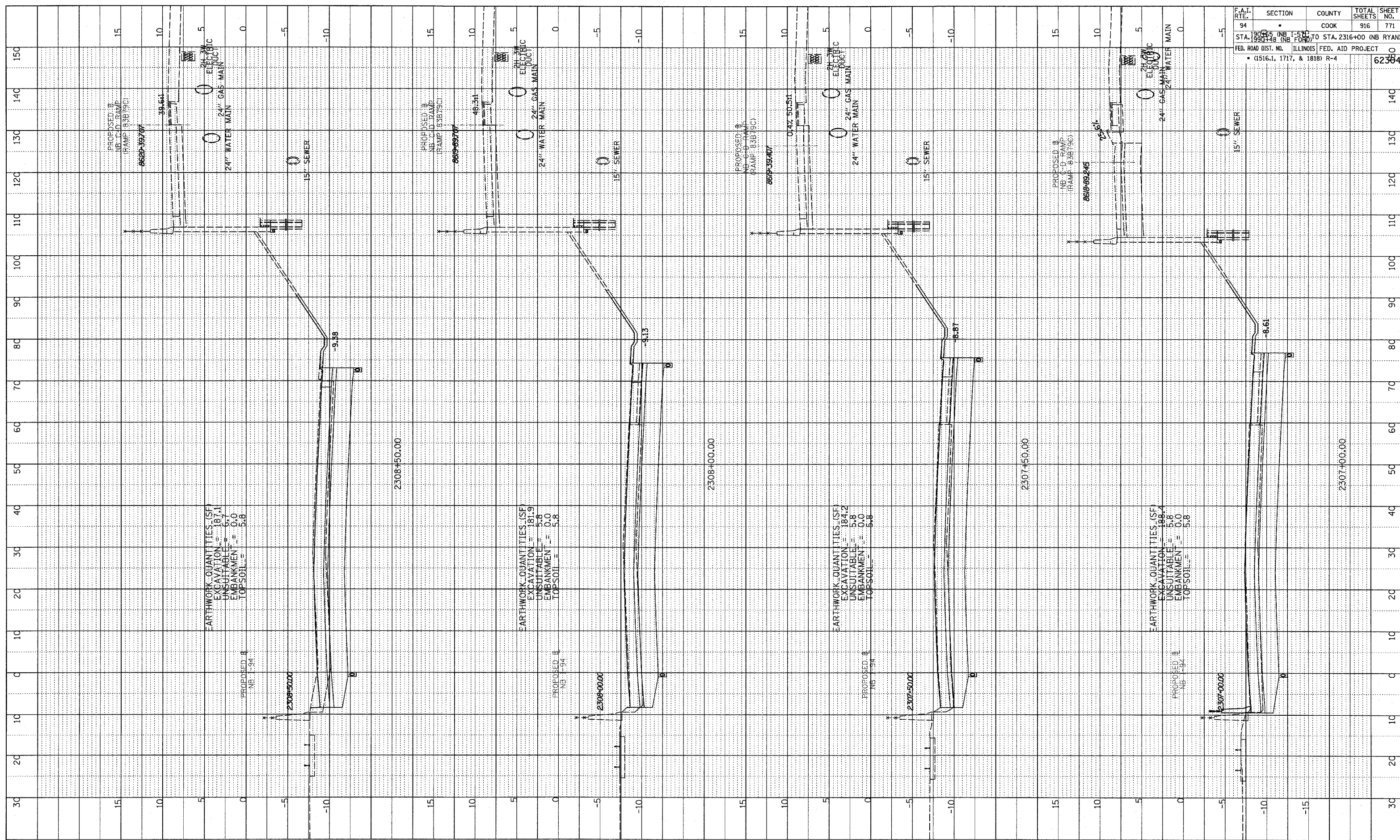

F.A.I. RT#	SECTION	COUNTY	TOTAL SHEETS	SHEET NO.
94	94	COOK	916	771
STA. 190+00 (NB I-94) TO STA. 2316+00 (NB RYAN)				
FED. ROAD DIST. NO. ILLINOIS FED. AID PROJECT				
• (1516.1, 1717, & 1818) R-4				
				62384

TYLIN INTERNATIONAL

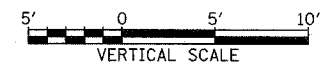
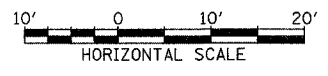

NORTHBOUND I-94 (DAN RYAN EXPWY)
 STA. 2307+00 TO STA. 2308+50

03/03/2006 04:46:53 PM