

F.A.T. RTE.	SECTION	COUNTY	TOTAL SHEETS	SHEET NO.
94	•	COOK	916	805
STA. 190+65 (NB I-57) TO STA. 2316+00 (NB RYAN)				
STA. 190+48 (NB I-57) TO STA. 2316+00 (NB RYAN)				
FED. ROAD DIST. NO. ILLINOIS FED. AID PROJECT				
• (1516.1, 1717, & 1818) R-4				
				62304

PROFILE	DATE
BY	
REVIEWED	
GRADES CHECKED	
PLAN NOTED	
STRUCTURE NOTATIONS OK'D	
NO.	

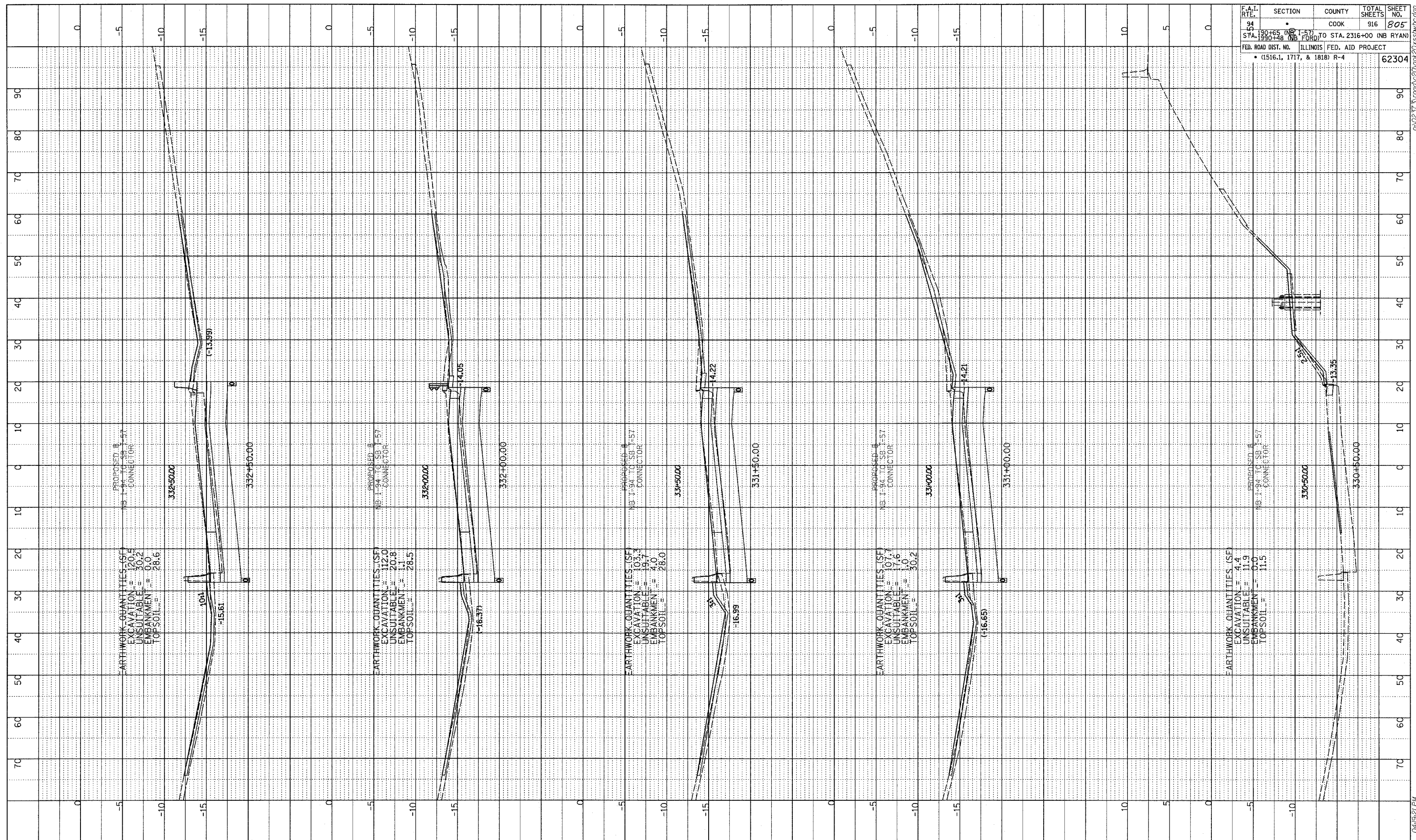

EARTHWORK QUANTITIES (SF)  
 EXCAVATION = 120.5  
 UNSUITABLE = 30.2  
 EMBANKMENT = 0.0  
 TOPSOIL = 28.6

EARTHWORK QUANTITIES (SF)  
 EXCAVATION = 112.0  
 UNSUITABLE = 20.8  
 EMBANKMENT = 1.1  
 TOPSOIL = 28.5

EARTHWORK QUANTITIES (SF)  
 EXCAVATION = 109.3  
 UNSUITABLE = 19.7  
 EMBANKMENT = 4.0  
 TOPSOIL = 28.0

EARTHWORK QUANTITIES (SF)  
 EXCAVATION = 107.7  
 UNSUITABLE = 17.6  
 EMBANKMENT = 1.0  
 TOPSOIL = 30.2

EARTHWORK QUANTITIES (SF)  
 EXCAVATION = 4.4  
 UNSUITABLE = 11.9  
 EMBANKMENT = 0.0  
 TOPSOIL = 11.5

TYLIN INTERNATIONAL

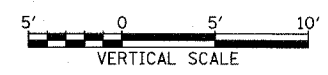
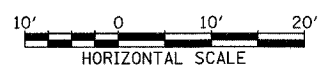

WB I-94 TO I-57 CONNECTOR  
 STA. 330+50 TO STA. 332+50

03/03/2006 04:19:21 PM