

F.A.I. RTE.	SECTION	COUNTY	TOTAL SHEETS	SHEET NO.
94		COOK	764	309
STA. 88+00 (SB I-57) TO STA. 1313+00 (SB RYAN)				
FED. ROAD DIST. NO. ILLINOIS FED. AID PROJECT				
• (1516.1, 1717, & 1818) R-5				
				62593

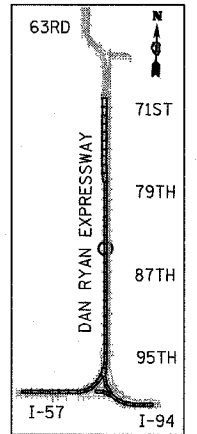
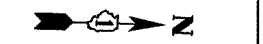
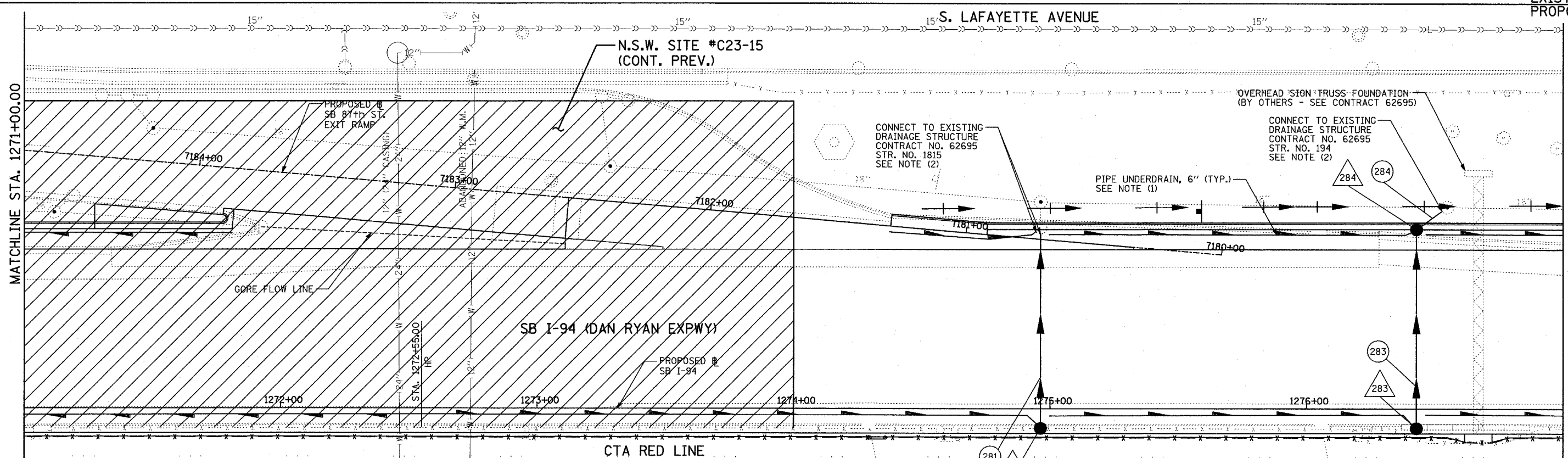
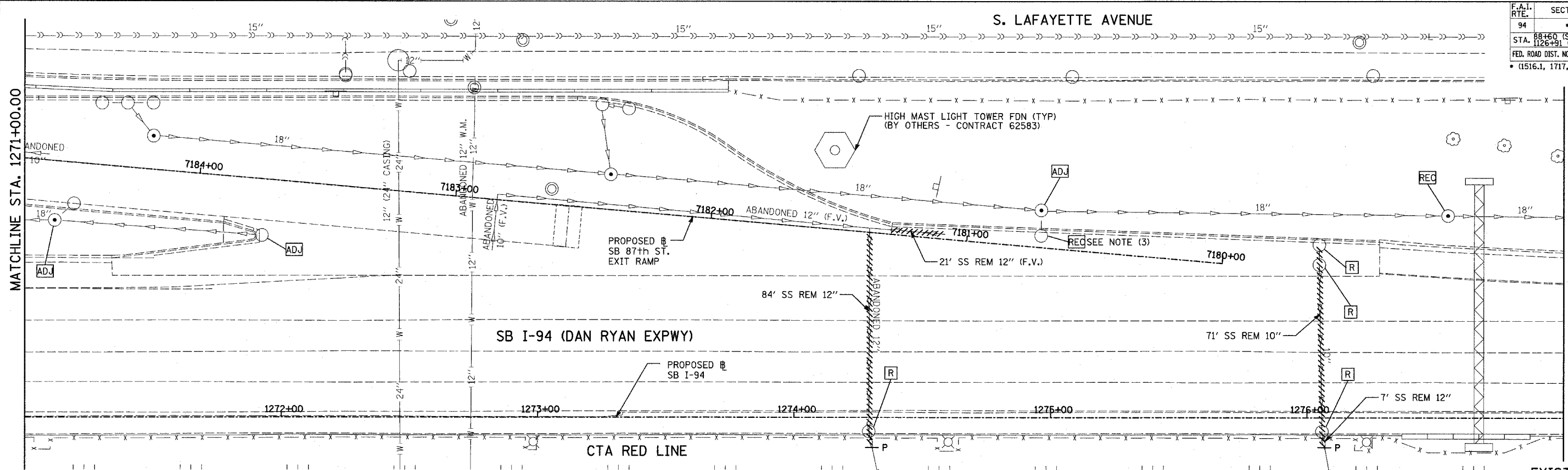

LOCATION MAP

LEGEND:

- EXISTING COMBINED SEWER
- XY PROPOSED STORM SEWER NUMBER (X=SHEET NO., Y=PIPE NO.)
- XY PROPOSED STRUCTURE NUMBER (X=SHEET NO., Y=STRUCTURE NO.)
- S- PIPE STUBOUT TO BE PLUGGED
- P SEWER PLUG
- F.V. FIELD VERIFY
- /// UTILITY REMOVAL
- PROPOSED CATCH BASIN CONSTRUCTED IN CONCURRENT CONTRACT 62304
- PROPOSED STORM SEWER CONSTRUCTED IN CONCURRENT CONTRACT 62304

NOTES:

1. FOR CLARITY, PIPE UNDERDRAINS ARE SHOWN OFFSET FROM THEIR PROPOSED LOCATIONS. FOR DETAILED PLACEMENT, SEE SHEET "PIPE UNDERDRAINS DETAIL."
2. CORE DRILL AND CONNECT TO EXISTING DRAINAGE STRUCTURE. CONNECTION COST SHALL BE INCLUDED IN THE COST TO CONSTRUCT THE STORM SEWER.
3. REMOVE AND REPLACE CONE. ROTATE CONE AND INSTALL LID IN THE GUTTER.

1 NSW - NON SPECIAL WASTE SITES ADDED TO SHEET

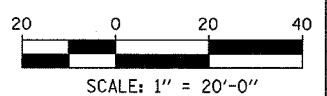

SHEET 28 OF 65

REVISIONS	
NAME	DATE

ILLINOIS DEPARTMENT OF TRANSPORTATION
F.A.I. 94 (DAN RYAN EXPRESSWAY)
DRAINAGE AND UTILITY PLAN
SB I-94 (DAN RYAN EXPRESSWAY)
SB I-94 STA. 1271+00.00 TO 1277+00.00

SCALE: 1"=20'
DATE: MARCH 1, 2006
DRAWN BY: NSB
CHECKED BY: DA

TYLIN INTERNATIONAL

5/5/2006 12:02:27 PM