

PIER 2 - PLAN

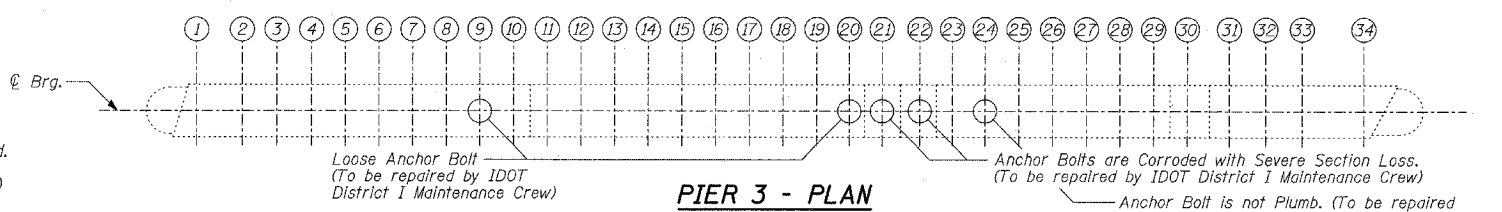

PIER 3 - PLAN

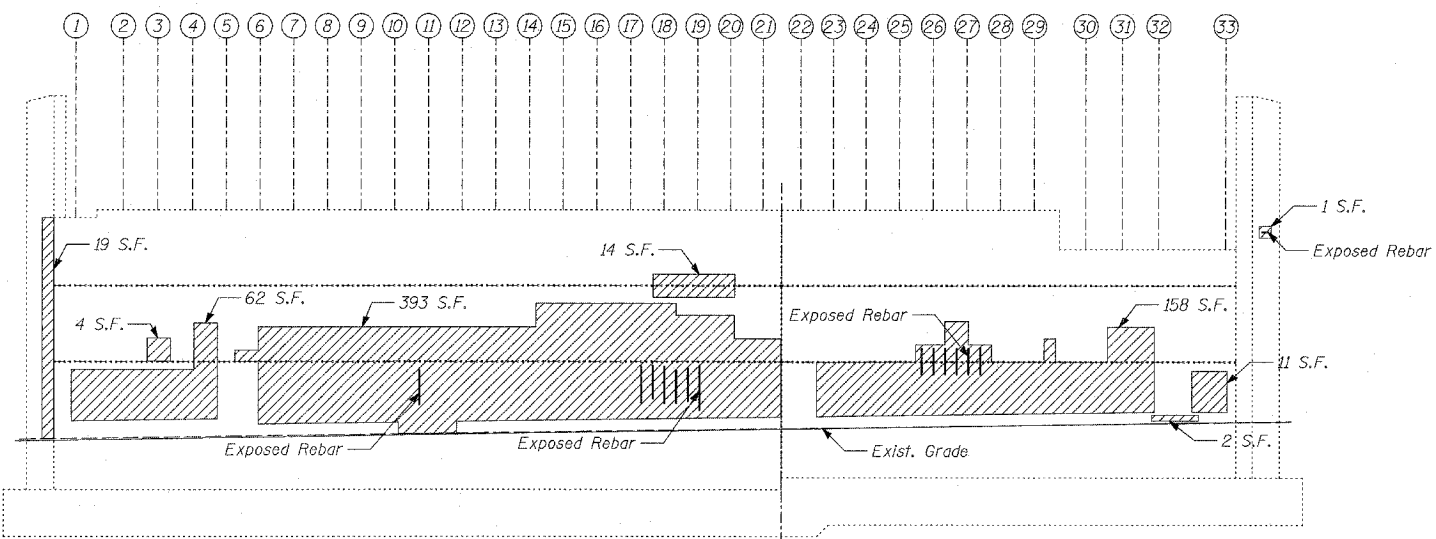

PIER 2 - ELEVATION
(Looking West)

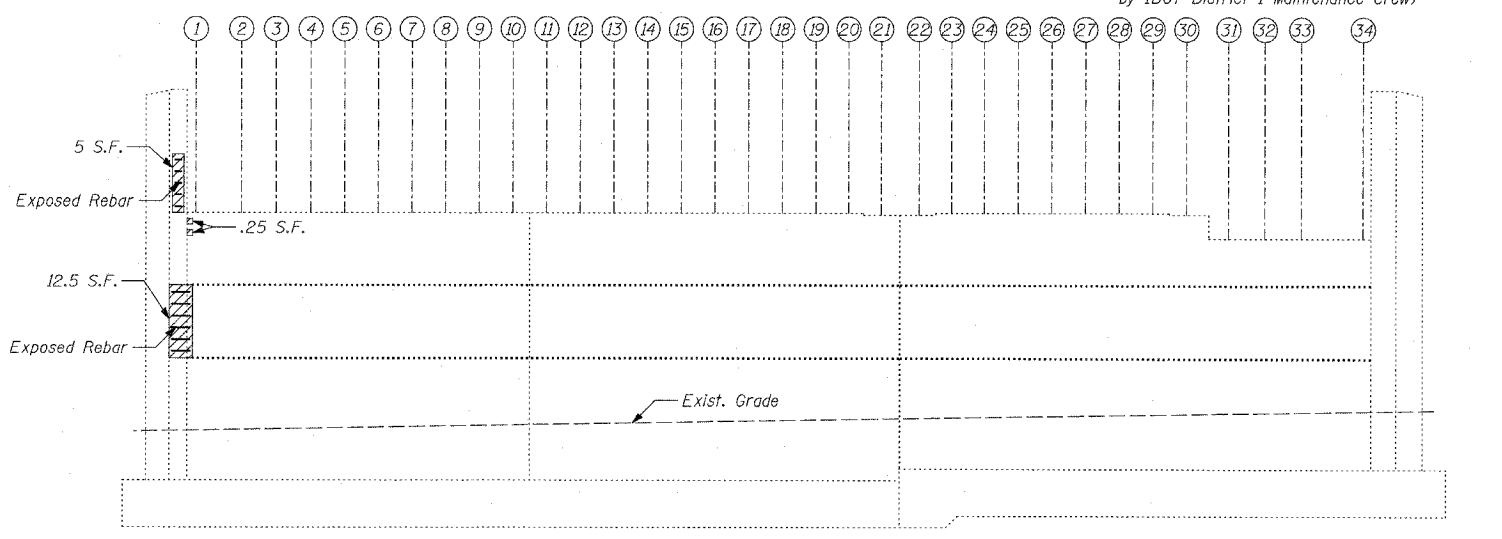

PIER 3 - ELEVATION
(Looking West)

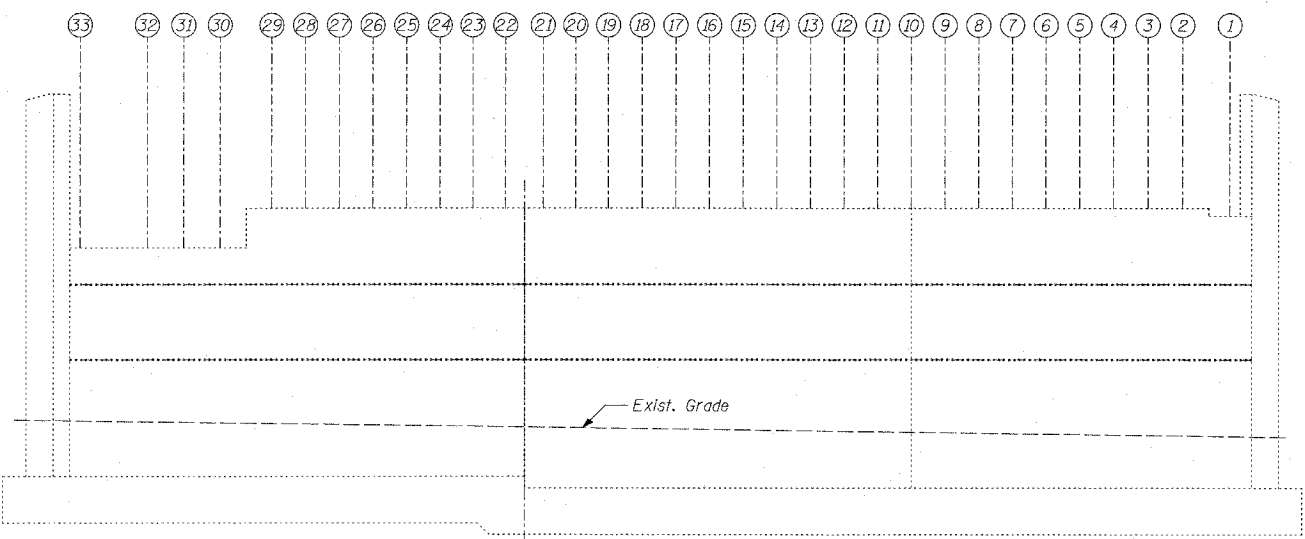

PIER 2 - ELEVATION
(Looking East)

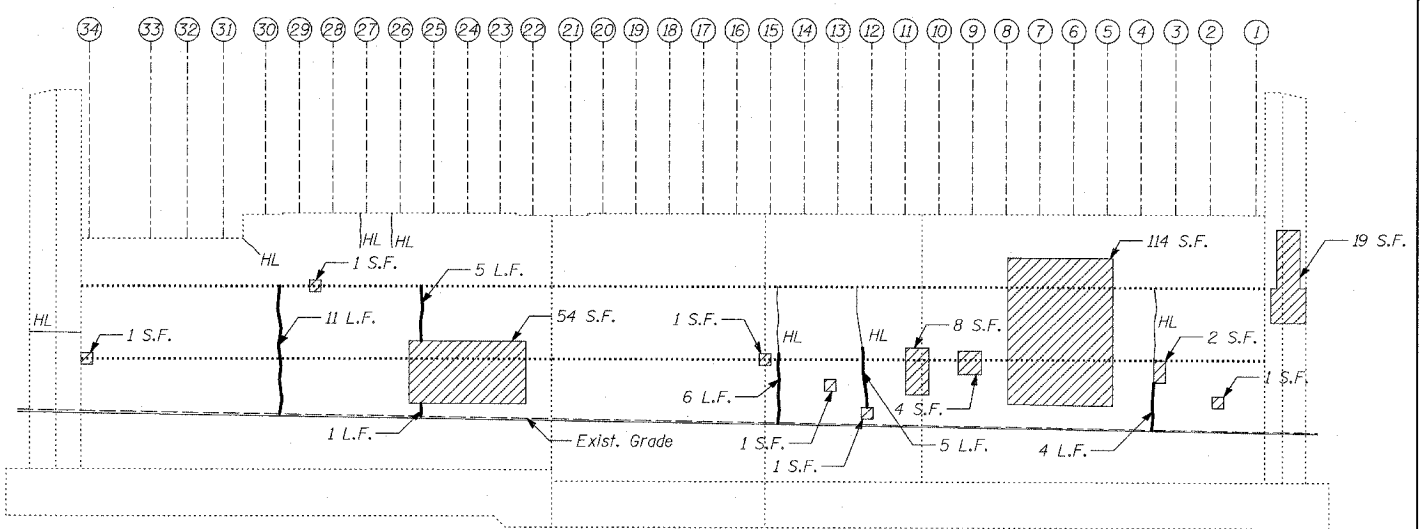

PIER 3 - ELEVATION
(Looking East)

LEGEND

- Formed Concrete Repair (Depth = < 5")
- Epoxy Crack Sealing
- Hair Line Crack

BILL OF MATERIAL

ITEM	UNIT	TOTAL
Epoxy Crack Sealing	FOOT	32
Formed Concrete Repair (Depth = < 5")	SQ FT	889

TYLIN INTERNATIONAL

REVISIONS	
NAME	DATE

ILLINOIS DEPARTMENT OF TRANSPORTATION
F.A.I. 94 (DAN RYAN EXPRESSWAY)
SUBSTRUCTURE REPAIR FOR BELT RAILWAY EXISTING PIER 2 & PIER 3

S.N. 016-0143 DESIGNED BY: MAF, DJR
SCALE: N.T.S. DRAWN BY: MAF, DJR
DATE: MARCH 1, 2006 CHECKED BY: MI