

02/24/2006 09:55:19 PM

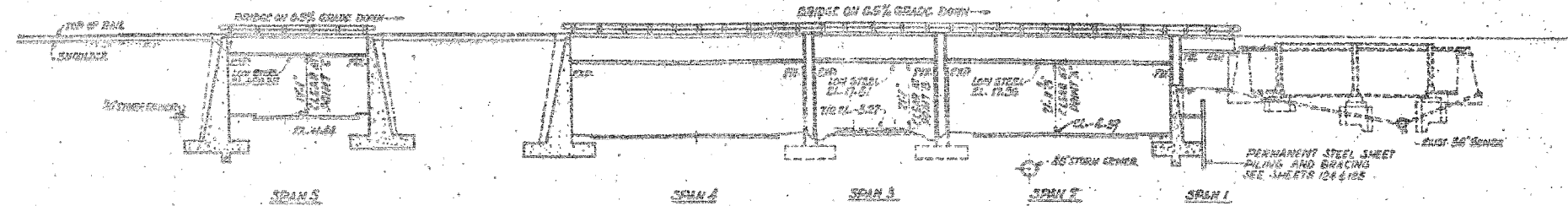

ELEVATION
SCALE: 1/8" = 1'-0"

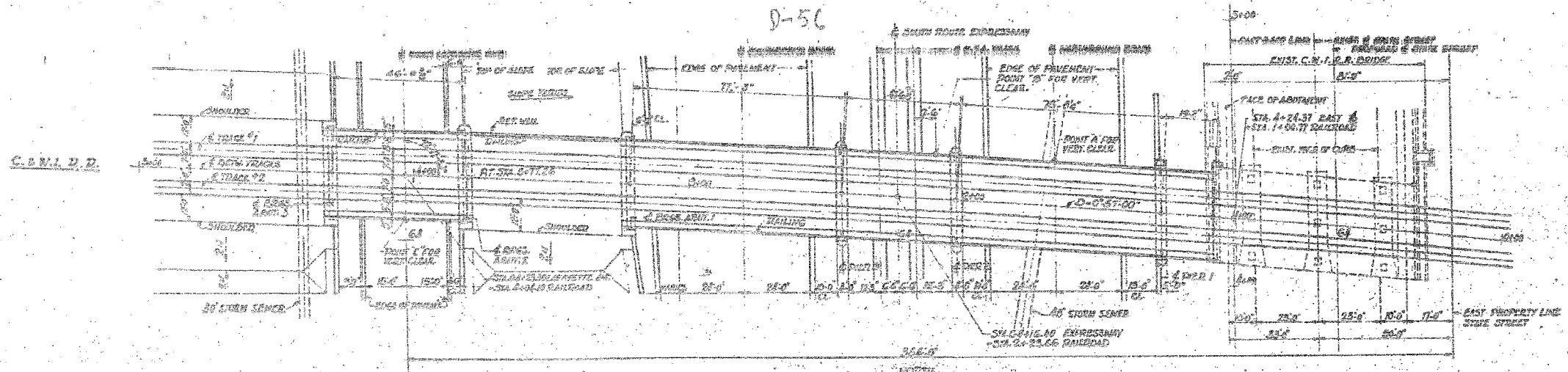

PLAN
SCALE: 1/8" = 1'-0"

DESIGN DATA

LIVE LOAD
CODRED E-72 PLUS DIESEL IMPACT

SPECIFICATIONS
DESIGN IN ACCORDANCE WITH A.R.E.A. SPECIFICATIONS FOR STEEL RAILWAY BRIDGES FOR YIKED SPANS NOT EXCEEDING 400 FT. IN LENGTH, DATED 1950

ALLOWABLE STRESSES

F_t (TENSION) STRUCTURAL CARBON STEEL	18,000 LB/IN^2
F_s (TENSION) REINFORCING BARS	20,000 LB/IN^2
F_c (FLEXURE) CONCRETE	3,500 LB/IN^2
F_c (FLEXURE) CONCRETE WITHOUT EARTH PRESSURE	1,800 LB/IN^2
F_c (FLEXURE) CONCRETE WITH EARTH PRESSURE	800 LB/IN^2
V (LOADINGS) = 75 LB/IN^2	$n = 10$

FOUNDATIONS
ABUTMENTS AND PIERS ON SPREAD FOOTINGS.
ALLOWABLE PRESSURE ON ABUTMENTS 1,200 $\%$
ALLOWABLE PRESSURE ON PIERS 1,200 $\%$

APPROVED BY C.B.N.R.D.
[Signature] CHIEF ENGINEER

DEPARTMENT OF HIGHWAYS COOK COUNTY, ILLINOIS	
ROBERT STAN	GALLAGHER J. HOFFMEYER
PLAN AND ELEVATION C.B.N.R.D., C.B.W.I.R.D. AND R.L.T. BY STRUCTURE SOUTH ROUTE EXPRESSWAY NORTH OF 91 ST STREET	
ALFRED BEMIS & ASSOCIATES Consulting Engineers	FORNOLD, BUEHLER & SCHMIDT SEAL
DATE: 10/11/05	BY: [Signature]
DATE: 03/01/06	BY: [Signature]
DATE: 03/01/06	BY: [Signature]
DATE: 03/01/06	BY: [Signature]

REVISIONS	
NAME	DATE

ILLINOIS DEPARTMENT OF TRANSPORTATION
F.A.I. 94 (DAN RYAN EXPRESSWAY)
EXISTING GENERAL PLAN AND ELEVATION
NORFOLK SOUTHERN

S.N. 016-0144 DESIGNED BY:
SCALE: N.T.S. DRAWN BY: MAJ, DJR
DATE: MARCH 1, 2006 CHECKED BY: MI

