

NOTES:

1. PROPOSED DETOUR TRAILBLAZER TO BE REMOVED AFTER APPROPRIATE ENTRANCE RAMP HAS BEEN OPENED. COST SHALL BE INCLUDED IN TEMPORARY INFORMATION SIGNING. SEE SHEET 1 OF STAGE 1 CONSTRUCTION SIGNING PLANS FOR TRAILBLAZER SIZE.
2. REMOVED SIGN PANEL SHALL BECOME THE PROPERTY OF CONTRACTOR AND BE DISPOSED OFFSITE.
3. RELOCATION OF SIGNS SHALL BE INCLUDED IN THE COST OF TEMPORARY INFORMATION SIGNING.

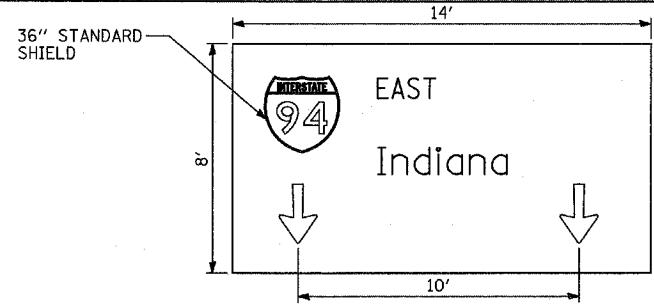

LEGEND - WHITE BACKGROUND - GREEN
10" E LETTERS
12" E LETTERS
STA. 149+87
TEMPORARY INFORMATION SIGNING - 112 SF

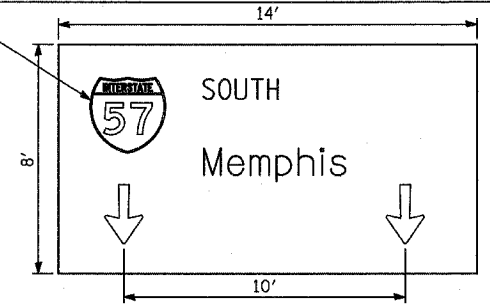

LEGEND - WHITE BACKGROUND - GREEN
10" E LETTERS
12" E LETTERS
STA. 149+87
TEMPORARY INFORMATION SIGNING - 112 SF

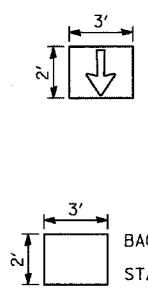

LEGEND - WHITE BACKGROUND - GREEN
STA. 149+87
TEMPORARY INFORMATION SIGNING - 6 SF

LEGEND - WHITE BACKGROUND - GREEN
STA. 149+87
TEMPORARY INFORMATION SIGNING - 12 SF

F.A.I. RTE.	SECTION	COUNTY	TOTAL SHEETS	SHEET NO.
94		COOK	764	251

STA. 88+60 (SB I-57) TO STA. 1313+00 (SB RYAN)
FED. ROAD DIST. NO. ILLINOIS FED. AID PROJECT
* (1516.1, 1717, & 1818) R-5 62593

SIGNING LEGEND:

- - - EXISTING GROUND MOUNTED SIGN
- - - EXISTING OVERHEAD TRUSS MOUNTED SIGN
- - - EXISTING OVERHEAD SIGN STRUCTURE-BRIDGE MOUNTED
- - - EXISTING OVERHEAD CANTILEVER MOUNTED SIGN
- - - PROPOSED GROUND MOUNTED SIGN
- - - PROPOSED OVERHEAD SIGN STRUCTURE - TRUSS
- ▨ CONSTRUCTION ZONE
- ◊ EXISTING SIGN
- ◊ EXISTING SIGN TO BE REMOVED
- ◊ PROPOSED SIGN

RELOCATE FROM STA. 1219+22 (STAGE 3A) TO STA. 148+05, 10.0' LT (STAGE 3B) (SKID MOUNT IN CENTER OF GORE)

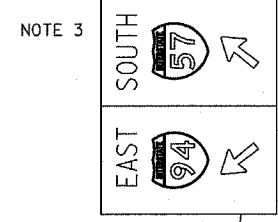

NOTE 3

REMOVE SIGN PANEL OVERLAY AND TEMPORARY SIGN PANEL.

MOUNT TEMPORARY SIGN ON EXISTING TRUSS AT STA. 149+87. SIGN SHALL BE PLACED AT CENTER OF APPROPRIATE LANES AS DIRECTED BY ENGINEER.

SEE DETAILS ON SAME SHEET. (STA. 149+87)

MOUNT TEMPORARY SIGN ON EXISTING TRUSS AT STA. 149+87. SIGN SHALL BE PLACED AT CENTER OF APPROPRIATE LANE AS DIRECTED BY ENGINEER.

COVER ARROWS WITH BLANK SIGN PANEL OVERLAY. PLACE DOWN ARROW AT CENTER OF SIGN.

SEE DETAILS ON SAME SHEET. (STA. 149+87)

EXISTING SIGN PANEL OVERLAYS TO REMAIN.

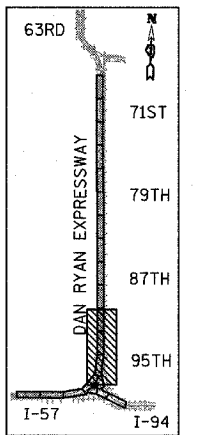
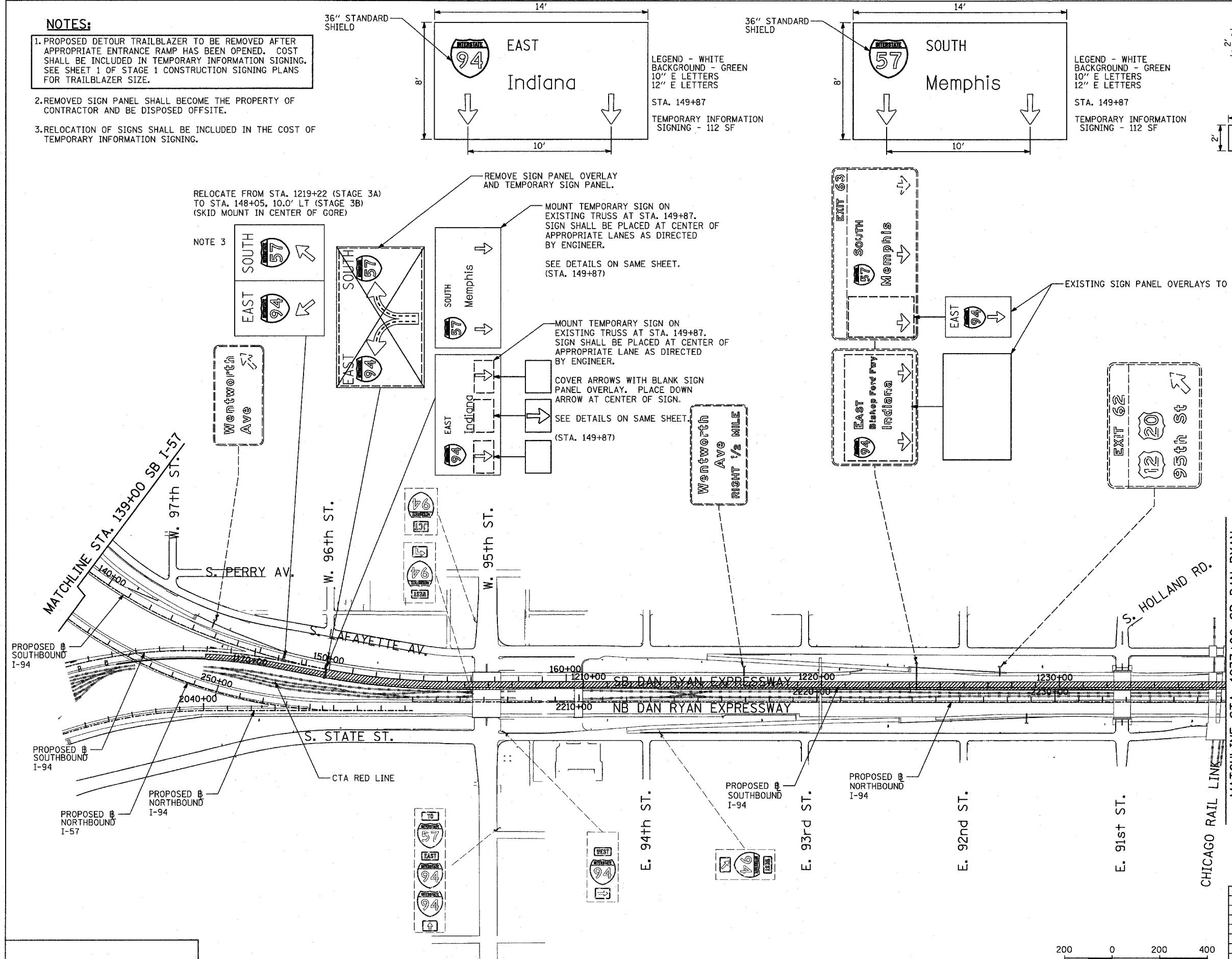

LOCATION MAP

TYLIN INTERNATIONAL

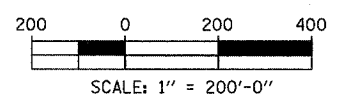

REVISIONS	
NAME	DATE

ILLINOIS DEPARTMENT OF TRANSPORTATION
F.A.I. 94 (DAN RYAN EXPRESSWAY)
CONSTRUCTION SIGNING-STAGE 3B
STA. 139+00 TO STA 1237+00
SHEET 2 OF 2

SCALE: 1" = 200'
DATE: MARCH 1, 2006
DRAWN BY: AMB
CHECKED BY: TGB