

STATE OF ILLINOIS
DEPARTMENT OF TRANSPORTATION
DIVISION OF HIGHWAYS

**PROPOSED
HIGHWAY PLANS**

FOR INDEX OF SHEETS, SEE SHEET NO. 2

TRAFFIC DATA - FROM HERMAN ST. IN GRANTFORK TO SILVER LAKE RD.

ADT 2015 = 2500 (ACTUAL)
ADT 2020 = 2650 (ESTIMATED)
SU = 6.8%
MU = 2.4%

FAP 692 (IL 160)
SECTION (12, 45)RS-3
3P - PATCHING, MILLING AND RESURFACING
MADISON COUNTY

C-98-016-16

ACSTP-0692 (012)

F.A.P. RTE.	SECTION	COUNTY	TOTAL SHEETS	SHEET NO.
692	(12,45)RS-3	MADISON	7	1
		ILLINOIS	CONTRACT NO. 76J42	

D-98-022-16

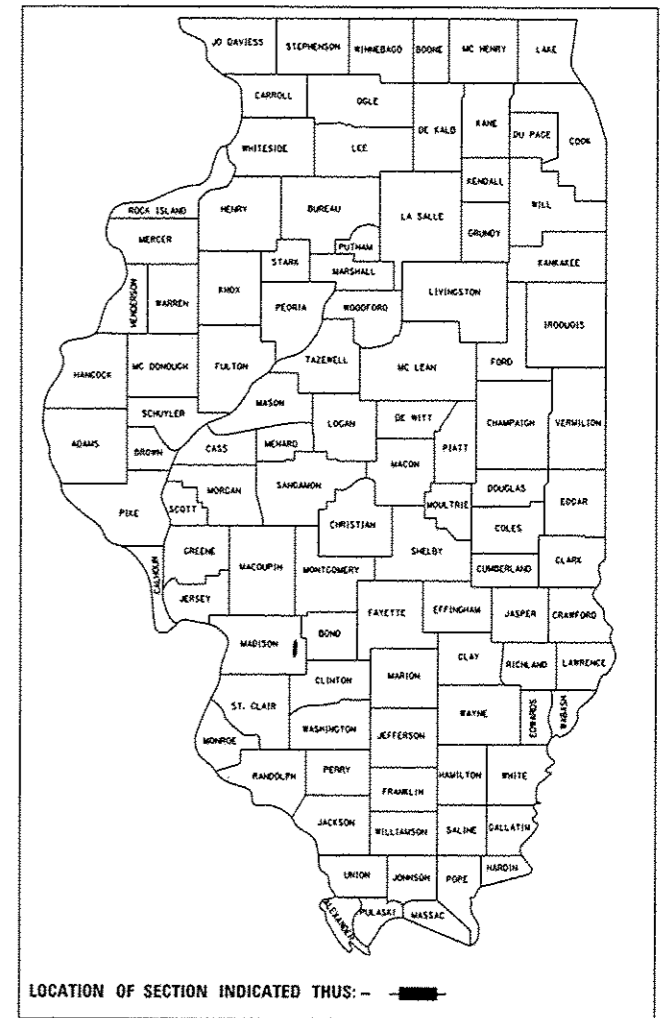

BEGIN PROJECT
M.P. 0.00
LAT: 38.832175
LONG: -89.668992

OMISSION
M.P. 0.66 - 0.70

END PROJECT
M.P. 2.68
LAT: 38.796500
LONG: -89.673164

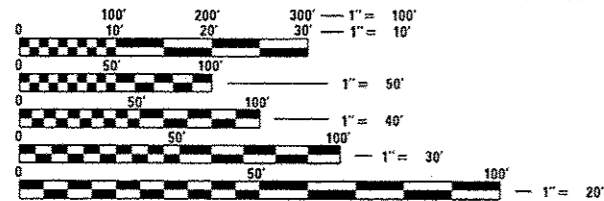

FULL SIZE PLANS HAVE BEEN PREPARED USING STANDARD ENGINEERING SCALES. REDUCED SIZED PLANS WILL NOT CONFORM TO STANDARD SCALES. IN MAKING MEASUREMENTS ON REDUCED PLANS, THE ABOVE SCALES MAY BE USED.

J.U.L.I.E.
JOINT UTILITY LOCATION INFORMATION FOR EXCAVATION
1-800-892-0123
OR 811

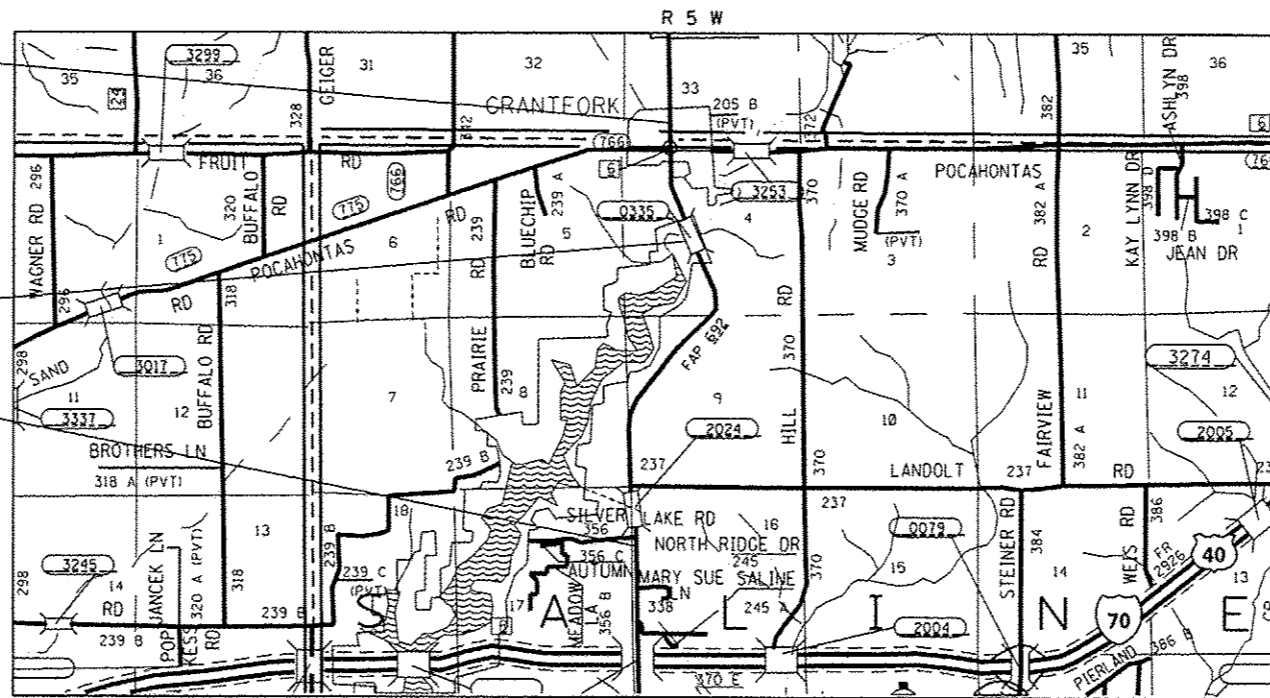

SALINE TOWNSHIP
HIGHLAND TOWNSHIP
NOT TO SCALE

GROSS LENGTH = 14,150.4 FT. = 2.68 MILE
NET LENGTH = 14,150.4 FT. = 2.64 MILE

PROJECT ENGINEER: TIM PADGETT (618) 346-3325
SENIOR DESIGNER: DIANA MURRAY (618) 346-3207

CONTRACT NO. 76J42

STATE OF ILLINOIS
DEPARTMENT OF TRANSPORTATION
DIVISION OF HIGHWAYS

SUBMITTED March 18, 2016
Jeffrey Z. K...
REGION 5 ENGINEER

May 6, 2016
Maurice M. Addis, P.E.
ENGINEER OF DESIGN AND ENVIRONMENT

May 6, 2016
Chris Osman, P.E.
DIRECTOR OF HIGHWAYS, CHIEF ENGINEER

**PRINTED BY THE AUTHORITY
OF THE STATE OF ILLINOIS**

INDEX OF SHEETS

1. COVER
2. INDEX OF SHEETS, STANDARDS, GENERAL NOTES & COMMITMENTS
3. SUMMARY OF QUANTITIES
4. TYPICAL SECTIONS
5. RESURFACING, PORTLAND CEMENT CONCRETE REMOVAL AND PATCHING SCHEDULE
6. PAVEMENT MARKING AND TEMPORARY RAMP SCHEDULE
7. LOCATION MAP

STANDARDS

000001-06	STANDARD SYMBOLS, ABBREVIATIONS AND PATTERNS
001006	DECIMAL OF AN INCH AND OF A FOOT
420001-08	PAVEMENT JOINTS
442201-03	CLASS C AND D PATCHES
701006-05	OFF-RD OPERATIONS, 2L, 2W, 15' (4.5M) TO 24" (600MM) FROM PAVEMENT EDGE
701011-04	OFF-RD MOVING OPERATIONS, 2L, 2W, DAY ONLY
701201-04	LANE CLOSURE, 2L, 2W, DAY ONLY, FOR SPEEDS > 45 MPH
701301-04	LANE CLOSURE, 2L, 2W SHORT TERM OPERATIONS
701306-03	LANE CLOSURE, 2L, 2W, SLOW MOVING OPERATIONS DAY ONLY, FOR SPEEDS > 45 MPH
701311-03	LANE CLOSURE, 2L, 2W, MOVING OPERATIONS - DAY ONLY
701336-06	LANE CLOSURE, 2L, 2W WORK AREAS IN SERIES, FOR SPEEDS > 45 MPH
701901-05	TRAFFIC CONTROL DEVICES
780001-05	TYPICAL PAVEMENT MARKINGS
781001-04	TYPICAL APPLICATIONS RAISED REFLECTIVE PAVEMENT MARKERS

GENERAL NOTES

1. THE STANDARDS AND REVISION NUMBERS SHALL APPLY TO THIS PROJECT.
2. ILLINOIS STATE LAW REQUIRES A 48-HOUR NOTICE TO BE GIVEN TO ALL UTILITIES WITHIN THE PROJECT AREA BEFORE DIGGING. FIELD MARKING OF FACILITIES MAY BE OBTAINED BY CONTACTING J.U.L.I.E. OR FOR NON-MEMBERS, THE UTILITY COMPANY DIRECTLY. AGENCIES KNOWN TO HAVE FACILITIES WITHIN THE PROJECT AREA ARE AS FOLLOWS:

UTILITY	ABOVE GROUND	BELOW GROUND
•ALHAMBRA-GRANTFORK TELEPHONE CO. (COMMUNICATIONS)	X	X
•AMEREN ILLINOIS (GAS & ELECTRIC)	X	X
•AT&T ILLINOIS (COMMUNICATIONS)	X	X
•CHARTER COMMUNICATIONS, INC. (CABLE TV)	X	X
•CLEARVISION CABLE SYSTEMS, INC. (CABLE TV)	X	X
•FRONTIER COMMUNICATIONS (COMMUNICATIONS)	X	X
•VILLAGE OF GRANTFORK (WATER & SANITARY SEWER)	X	X
•CITY OF HIGHLAND (COMMUNICATIONS)	X	X
•CITY OF HIGHLAND (ELECTRIC)	X	X
•CITY OF HIGHLAND (WATER & SANITARY SEWER)	X	X
•MARATHON PIPE LINE LLC		X
•PLAINS PIPELINE, L.P.		X
•TRANSCANADA KEYSTONE PIPELINE		X

MEMBERS OF J.U.L.I.E. (800-892-0123 OR 811) ARE INDICATED BY AN *. NON-JULIE MEMBERS MUST BE NOTIFIED INDIVIDUALLY.

3. THE CONTRACTOR AND THE ENGINEER SHALL BE AWARE THAT NO SURVEY WAS PERFORMED FOR THIS PROJECT, THE STATIONING, TOPOGRAPHY AND QUANTITIES SHOWN ON THESE PLANS WERE CREATED USING MICROFILM AND FIELD MEASUREMENTS. ALL SHALL BE ASSUMED TO BE APPROXIMATE. THE CONTRACTOR SHALL VERIFY DIMENSIONS AND CONDITIONS IN THE FIELD PRIOR TO CONSTRUCTION AND ORDERING OF MATERIALS.
4. PROPOSED PAVEMENT MARKING SHALL BE PLACED IN THE SAME LOCATION AS EXISTING AS DIRECTED BY THE RESIDENT ENGINEER.
5. THE CONTRACTOR SHALL POST AND MAINTAIN THE ROADWAY WITH "NO PASSING ZONES NOT STRIPED NEXT MILES" SIGNS UNTIL MARKINGS HAVE BEEN RESTORED IN ACCORDANCE WITH ARTICLE 701.17(C). THE COST SHALL BE INCLUDED IN THE TRAFFIC CONTROL ITEM.
6. NO OVERNIGHT LANE CLOSURES WILL BE PERMITTED.
7. SHORT TERM PAVEMENT MARKER REMOVAL AND PAVEMENT MARKING REMOVAL SHALL ONLY BE PAID FOR THE FINAL SURFACE.
8. THE THICKNESS OF HOT-MIX ASPHALT MIXTURE SHOWN ON THE PLANS IS THE NOMINAL THICKNESS. DEVIATIONS FROM THE NOMINAL THICKNESS WILL BE PERMITTED WHEN SUCH DEVIATIONS OCCUR DUE TO IRREGULARITIES IN THE EXISTING SURFACE OR BASE ON WHICH THE HOT-MIX ASPHALT MIXTURE IS PLACED.
9. THE VARIOUS THICKNESSES OF BITUMINOUS SURFACE REMOVAL SHOWN ON THE PLANS ARE THE AVERAGE THICKNESSES BASED UPON CONTROLLING THICKNESS AS INDICATED. DEVIATIONS FROM THE NOMINAL THICKNESS WILL BE PERMITTED WHEN SUCH DEVIATIONS OCCUR DUE TO IRREGULARITIES IN THE EXISTING SURFACE. BITUMINOUS SURFACE REMOVAL HAS BEEN INCLUDED IN THE PLANS FOR THE PURPOSE OF REMOVING HIGH IRREGULARITIES AND TO ESTABLISH CROSS SLOPE.

10. AN ESTIMATED QUANTITY OF 4163 TONS OF CUTTINGS FROM THE HOT-MIX ASPHALT SURFACE REMOVAL OPERATIONS IS ANTICIPATED.
11. THE DEPARTMENT STRONGLY ENCOURAGES THE PRIME CONTRACTOR AND THEIR APPROVED SUB-CONTRACTORS TO HIRE MINORITY, WOMEN AND DISADVANTAGED INDIVIDUALS FROM ITS FEDERALLY FUNDED HIGHWAY CONSTRUCTION CAREERS TRAINING PROGRAM (HCCTP) TO HELP MEET WORKFORCE AND TRAINEE GOALS. THIS PROGRAM IS TRAINING MINORITIES, WOMEN AND DISADVANTAGED INDIVIDUALS IN HIGHWAY CONSTRUCTION-RELATED SKILLS, E.G., MATH FOR THE TRADES, JOB READINESS, TECHNICAL SKILLS COURSEWORK (CARPENTRY, CONCRETE FLATWORK, BLUEPRINT READING, SITE PLANS, SITE WORK, TOOLS USE, ETC.) AND OSHA 10 HOUR CERTIFICATION, TO PREPARE THEM FOR A CAREER IN THE HIGHWAY CONSTRUCTION TRADES. GRADUATES ARE WELL-TRAINED AND READY TO BECOME PRODUCTIVE ENTRY-LEVEL CONSTRUCTION WORKERS. CONTACT THE DISTRICT 8 EEO OFFICE AT 618-346-3360 AND/OR THE HCCTP COORDINATOR AT 618-874-6528 TO LEARN MORE ABOUT THE PROGRAM AND FOR ASSISTANCE IN MEETING WORKFORCE AND TRAINEE GOALS.
12. THE CONTRACTOR SHALL ORGANIZE THE WORK IN THIS PROJECT TO AVOID A DROP-OFF AT THE CENTERLINE GREATER THAN 2" BETWEEN ADJACENT OPEN TRAFFIC LANES.
13. IN AREAS WHERE THE PCC GUTTER HAS BEEN FILLED IN TO PROVIDE FOR A 12 FT. DRIVING LANE, THE CONTRACTOR SHALL ADJUST THE MILLING DEPTH IN THESE AREAS TO AVOID HITTING THE PCC GUTTER WHEN PERFORMING THE HOT-MIX ASPHALT SURFACE REMOVAL.
14. THE TEMPORARY RAMPS USED ON ALL SIDE STREETS SHALL NOT INTERFERE WITH THRU TRAFFIC LANES.
15. THE OCP PAY ITEMS AND QUANTITIES ARE AS FOLLOWS:
 LEVELING BINDER - 1561 TONS
 HMA SURFACE COURSE - 3122 TONS

COMMITMENTS

NONE

MIXTURE REQUIREMENTS

ROUTE	FAP 692 (IL 160)
SECTION	(12,45)RS-3
COUNTY	MADISON
CONTRACT	76J42

DESCRIPTION:	3P - IL 160 FROM HERMAN ST. IN GRANTFORK TO SILVER LAKE RD.
--------------	---

MIXTURE USE	SURFACE	LEVEL BINDER	PATCHING
AC/PG	PG 64-22	PG 64-22	PG 64-22
RAP % (MAX)	SEE SPECIAL PROVISION	SEE SPECIAL PROVISION	SEE SPECIAL PROVISION
DESIGN AIR VOIDS	4.0% @ Ndes=70	4.0% @ Ndes=70	4.0% @ Ndes=70
MIX COMPOSITION (GRADATION MIXTURE)	IL 9.5	IL 9.5FG	IL 19.0
FRICTION AGG	MIXTURE "C"	MIXTURE "C"	MIXTURE "B"
QUALITY MGMT PROGRAM	OCP	OCP	QC/QA

PLAN QUANTITIES FOR HMA ITEMS ARE CALCULATED USING A UNIT WEIGHT OF 112 LB/SQ YD/IN (59.8 KG/SQ M/25 MM THICKNESS).

CODE NO.	ITEM	UNIT	TOTAL QUANTITY	CONSTR. CODE
				80% FEDERAL 20% STATE ROADWAY 0005
40600290	BITUMINOUS MATERIALS (TACK COAT)	POUND	25091	25091
40600637	LEVELING BINDER (MACHINE METHOD), IL-9.5FG, N70	TON	1561	1561
40600990	TEMPORARY RAMP	SQ YD	343	343
40603315	HOT-MIX ASPHALT SURFACE COURSE, MIX "C", N70	TON	3122	3122
44000157	HOT-MIX ASPHALT SURFACE REMOVAL, 2"	SQ YD	34074	34074
44200156	PAVEMENT PATCHING, TYPE II, 13 INCH	SQ YD	188	188
44200160	PAVEMENT PATCHING, TYPE III, 13 INCH	SQ YD	92	92
44200162	PAVEMENT PATCHING, TYPE IV, 13 INCH	SQ YD	88	88
44300200	STRIP REFLECTIVE CRACK CONTROL TREATMENT	FOOT	1162	1162
48102100	AGGREGATE WEDGE SHOULDER, TYPE B	TON	36	36
67100100	MOBILIZATION	LSUM	1	1
70100450	TRAFFIC CONTROL AND PROTECTION, STANDARD 701201	LSUM	1	1
70100460	TRAFFIC CONTROL AND PROTECTION, STANDARD 701306	LSUM	1	1
70100600	TRAFFIC CONTROL AND PROTECTION, STANDARD 701336	LSUM	1	1

CODE NO.	ITEM	UNIT	TOTAL QUANTITY	CONSTR. CODE
				80% FEDERAL 20% STATE ROADWAY 0005
70300100	SHORT TERM PAVEMENT MARKING	FOOT	5146	5146
70300150	SHORT TERM PAVEMENT MARKING REMOVAL	SQ FT	429	429
70300220	TEMPORARY PAVEMENT MARKING - LINE 4"	FOOT	45702	45702
* 78000200	THERMOPLASTIC PAVEMENT MARKING - LINE 4"	FOOT	45702	45702
* 78100100	RAISED REFLECTIVE PAVEMENT MARKER	EACH	177	177
78300100	PAVEMENT MARKING REMOVAL	SQ FT	15234	15234
78300200	RAISED REFLECTIVE PAVEMENT MARKER REMOVAL	EACH	177	177
Z0033700	LONGITUDINAL JOINT SEALANT	FOOT	27,879	27,879
Z0034105	MATERIAL TRANSFER DEVICE	TON	4683	4683
Z0038121	PORTLAND CEMENT CONCRETE SURFACE REMOVAL 2"	SQ YD	645	645
∅ Z0076604	TRAINEES TRAINING PROGRAM GRADUATE	HOUR	500	500
∅ Z0076600	TRAINEES	HOUR	500	500

* SPECIALTY ITEM
∅ 0042

FILE NAME *	USER NAME * ohidal	DESIGNED -	REVISED -	STATE OF ILLINOIS DEPARTMENT OF TRANSPORTATION	SUMMARY OF QUANTITIES				F.A.P. RTE. 692	SECTION (12,45)RS-3	COUNTY MADISON	TOTAL SHEETS 7	SHEET NO. 3
DRAWN BY: [unclear] DATE: [unclear]									SCALE: _____ SHEET _____ OF _____ SHEETS STA. _____ TO STA. _____				CONTRACT NO. 76J42
PLOT SCALE * 100,0000 1/ in.					CHECKED -				ILLINOIS FED. AID PROJECT				
PLOT DATE * 3/18/2016					DATE -								

PAVEMENT MARKING SCHEDULE

STATION TO STATION	LENGTH	NO PASSING ZONE	RAISED REFLECTIVE PAVEMENT MARKER REMOVAL	RAISED REFLECTIVE PAVEMENT MARKER	SHORT TERM PAVEMENT MARKING	TEMPORARY PAVEMENT MARKING			SHORT TERM PAVEMENT MARKING REMOVAL	PAVEMENT MARKING REMOVAL	THERMOPLASTIC PAVEMENT MARKING				
						4" SOLID YELLOW	4" SKIP-DASH YELLOW	4" SOLID WHITE			4" SOLID YELLOW	4" SKIP-DASH YELLOW	4" SOLID WHITE		
						FOOT	FOOT	FOOT			FOOT	FOOT	FOOT	SQ FT	SQ FT
0.000 - 0.018	95	SB	1	1	35	95	24	190	3	103	95	24	190		
0.018 - 0.026	42		1	1	15		11	85	1	32		11	85		
0.026 - 0.182	824	NB	10	10	300	824	206	824	25	618	824	206	824		
0.182 - 0.248	349	SB	4	4	127	349	87	697	11	378	349	87	697		
0.248 - 0.302	285		4	4	104		71	570	9	214		71	570		
0.302 - 0.430	676	NB	8	8	246	676		1352	20	676	676		1352		
0.430 - 0.596	877	NB	11	11	319	877	219	1753	27	950	877	219	1753		
0.596 - 0.833	1251		16	16	455		313	2503	38	939		313	2503		
0.833 - 0.967	708	SB	9	9	257	708	177	1415	21	767	708	177	1415		
0.967 - 2.010	5507	NB/SB	69	69	2003	11014		11014	167	7343	11014		11014		
2.010 - 2.200	1003	NB	13	13	365	1003	251	2006	30	1087	1003	251	2006		
2.200 - 2.550	1848		23	23	672		462	3696	56	1386		462	3696		
2.550 - 2.680	687	SB	9	9	250	687	172	1373	21	744	687	172	1373		
SUBTOTAL					177	177	5146	16231	1992	27478	429	15234	16231	1992	27478
TOTAL					177	177	5146	45702			429	15234	45702		

TEMPORARY RAMP SCHEDULE

DIR	LOCATION	LTH	WTH	AREA
		FT	FT	SQ YD
NB/SB	BEGINNING OF PROJECT	7	24	19
NB	BRIDGE OMISSION	7	24	19
SB	BRIDGE OMISSION	7	45	35
EB	MAIN ST.	7	67	52
WB	MAIN ST.	7	112	87
EB	NORTH OF SILVER LAKE RD.	7	100	78
WB	SILVER LAKE RD.	7	45	35
NB/SB	END OF PROJECT	7	24	19
TOTAL				343

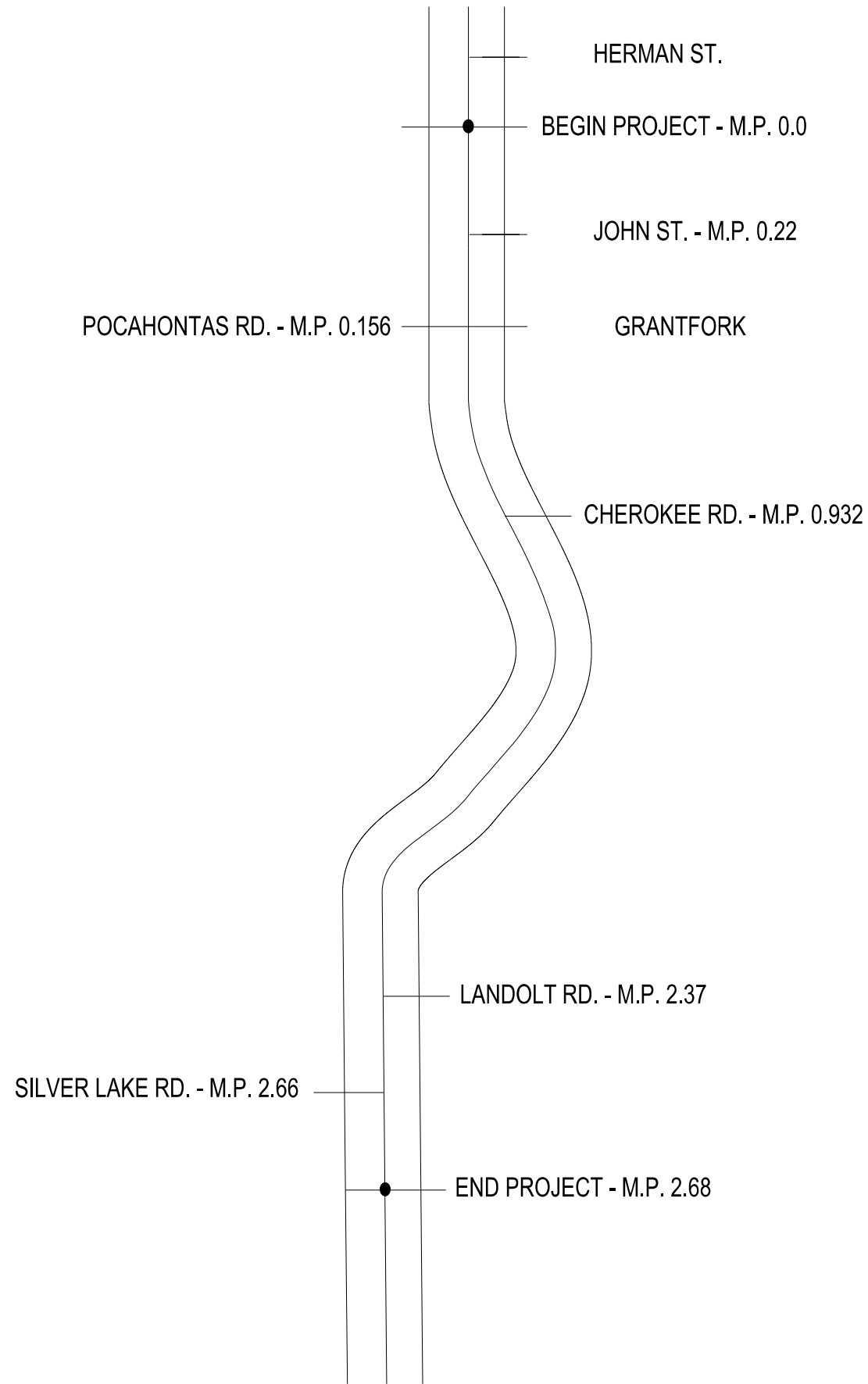

NOT TO SCALE

FILE NAME =	USER NAME = childsl	DESIGNED - _____	REVISED - _____
pw:\IL\084EBIDINTEG.illinois.gov\PWIDOT\Documents\DOT Offices\District 8\Projects\0875-DRAWING\DATA\EA0\Sheets\0875-3ht-plan.dwg		REVISION	REVISION
Default	PLOT SCALE = 100.0000' / in.	CHECKED - _____	REVISED - _____
	PLOT DATE = 3/18/2016	DATE - _____	REVISED - _____

**STATE OF ILLINOIS
DEPARTMENT OF TRANSPORTATION**

LOCATION MAP

SCALE: _____ SHEET ____ OF ____ SHEETS STA. _____ TO STA. _____

F.A.P. RTE.	SECTION	COUNTY	TOTAL SHEETS	SHEET NO.
692	(12.45)RS-3	MADISON	7	7
ILLINOIS FED. AID PROJECT			CONTRACT NO. 76J42	