

06-10-2016 LETTING ITEM 194

STATE OF ILLINOIS

DEPARTMENT OF TRANSPORTATION

DIVISION OF HIGHWAYS

SAFE ROUTES TO SCHOOL FUNDS CITY OF LAWRENCEVILLE

LAWRENCE COUNTY
SECTION 14-00044-00-SW
PROJECT SRTS-4009(312)
JOB NO. C-97-035-15

INDEX OF SHEETS

SHEET NO.	DESCRIPTION
1.	COVER SHEET
2.	GENERAL NOTES, SUMMARY OF QUANTITIES, AND DETAILS
3.	SCHEDULE OF QUANTITIES
4.-5.	PARKSIDE ENTRANCE SIDEWALK PLAN AND PROFILE
6.	CEDAR STREET SIDEWALK PLAN AND PROFILE
7.-8.	INTERSECTION DETAILS
9.-11.	CROSS SECTIONS

HIGHWAY STANDARDS: SEE SHEET #2

UTILITIES

CITY OF LAWRENCEVILLE
700 E. STATE STREET; LAWRENCEVILLE, IL 62439
PHONE: (618)-943-4946

AMEREN CIPS
4978 NORTH ILLINOIS 130; OLNEY, IL 62450
PHONE: (888)-789-2477

ILLINOIS GAS COMPANY
1927 MILLER DRIVE; OLNEY, IL 62450
PHONE: (618)-395-8588

FRONTIER COMMUNICATIONS
225 EAST CHESTNUT STREET; OLNEY, IL 62450
PHONE: (618)-395-6191

NEW WAVE COMMUNICATIONS
ONE MONTGOMERY PLAZA, 4TH FLOOR; SIKESTON, MO 63801
PHONE: (618)-283-9630



Know what's below.
Call before you dig.

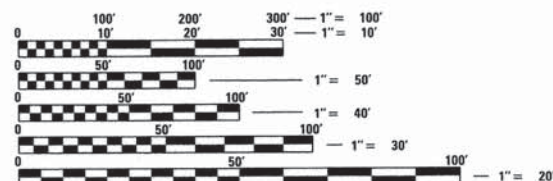

FULL SIZE PLANS HAVE BEEN PREPARED USING STANDARD ENGINEERING SCALES. REDUCED SIZED PLANS WILL NOT CONFORM TO STANDARD SCALES. IN MAKING MEASUREMENTS ON REDUCED PLANS, THE ABOVE SCALES MAY BE USED.

CONTRACT NO. 95794

PARKSIDE ENTRANCE BEGINS
STATION 0+32.5

PARKSIDE ENTRANCE ENDS
STATION 10+43.5

CEDAR STREET BEGINS
STATION 0+00

CEDAR STREET ENDS
STATION 5+83

PARKSIDE ENTRANCE = 1011 FEET (0.19 MILES)
CEDAR STREET = 583 FEET (0.11 MILES)
TOTAL LENGTH = 1594 FEET (0.30 MILES)

STREET	CITY	COUNTY	TOTAL SHEETS	SHEET NO.
VARIABLES	LAWRENCEVILLE	LAWRENCE	11	1
FED. ROAD DIST. NO.	ILLINOIS	VARIABLES		



APPROVED April 7 2016
Debra Wagner
MAYOR

PASSED 4-11-16
Maura E. Cox
DISTRICT SEVEN ENGINEER OF LOCAL ROADS & STREETS

Releasing For Bid Based on Limited Review 4-11-2016
John M. Smith
REGION FOUR ENGINEER

STATE OF ILLINOIS
DEPARTMENT OF TRANSPORTATION



LAMAC
ENGINEERING
A division of Hampton, Lenzini and Renwick, Inc.
323 W. 3RD ST.; P.O. BOX 160
MT. CARMEL, ILLINOIS 62863
184-000959 ILLINOIS PROFESSIONAL DESIGN FIRM LS / PE / SE CORP

DATE: 4-7-16
EXPIRES: 11/30/2017
PROJECT NUMBER: 15.1029.330
DATE: 1/07/16

HIGHWAY STANDARDS

- 000001-06 STANDARD SYMBOLS, ABBREVIATIONS, AND PATTERNS
- 424001-08 PERPENDICULAR CURB RAMPS FOR SIDEWALKS
- 606001-06 CONCRETE CURB TYPE B AND COMBINATION CONCRETE CURB AND GUTTER
- 701006-05 OFF-RD OPERATIONS, 2L, 2W, 15' TO 24" FROM PAVEMENT EDGE
- 701501-06 URBAN LANE CLOSURE, 2L, 2W, UNDIVIDED
- 701801-06 SIDEWALK, CORNER OR CROSSWALK CLOSURE
- 701901-05 TRAFFIC CONTROL DEVICES

GENERAL NOTES

- 1 THIS SECTION SHALL BE CONSTRUCTED IN ACCORDANCE WITH THE PLANS, SPECIAL PROVISIONS AND "STANDARD SPECIFICATIONS FOR ROAD AND BRIDGE CONSTRUCTION", ADOPTED APRIL 1, 2016.
- 2 UTILITIES SHOWN WERE LOCATED PER QUALITY LEVEL "C", A.S.C.E. STANDARD CI/38-02, STANDARD GUIDELINE FOR THE COLLECTION AND DEPICTION OF EXISTING SUBSURFACE UTILITY DATA FROM SURFACE MARKINGS ONLY. UTILITIES SHALL BE FIELD LOCATED HORIZONTALLY AND VERTICALLY PRIOR TO BEGINNING ANY WORK. THE CONTRACTOR IS RESPONSIBLE FOR THE FIELD LOCATION OF THESE UTILITIES.
- 3 IT SHALL BE THE CONTRACTORS RESPONSIBILITY TO VERIFY ALL EXISTING FIELD DIMENSIONS AND CONDITIONS PRIOR TO CONSTRUCTION AND ORDERING MATERIALS.
- 4 ANY REFERENCE TO A STANDARD IN THESE PLANS SHALL BE INTERPRETED TO MEAN THE EDITION AS INDICATED BY THE SUBNUMBER LISTED ON THE INDEX OF SHEETS OR THE COPY OF THE STANDARD INCLUDED IN THE PLANS.
- 5 EARTHWORK COMPACTION SHALL BE TO THE SATISFACTION OF THE ENGINEER.
- 6 CONTRACTOR SHALL BE RESPONSIBLE TO COORDINATE PROJECT ACTIVITIES WITH UTILITY COMPANIES TO "HOLD" UTILITY POLES AND PROTECT UTILITY COMPANY FACILITY DURING THE CONSTRUCTION ACTIVITIES.
- 7 EXCESS EXCAVATED MATERIAL SHALL BE HAULED TO THE CITY BARN ON 3RD STREET BY THE CONTRACTOR AND THIS SHALL BE INCLUDED IN THE COST OF THE PORTLAND CEMENT CONCRETE SIDEWALK.
- 8 THE SIDEWALK ALONG THE PARKSIDE ENTRANCE SHALL BE COMPLETED BEFORE THE SIDEWALK ALONG CEDAR STREET SHALL BEGIN.
- 9 CONTRACTOR SHALL MAINTAIN ACCESS TO ADJACENT HOMES, BUSINESSES AND SIDEROADS AT ALL TIMES, CONTRACTOR SHALL SCHEDULE WORK, PREPARE DETOURS, AND CONSTRUCT TEMPORARY RAMPS AS NECESSARY TO PROVIDE FOR ACCESS. THIS WORK SHALL BE CONSIDERED INCLUDED IN THE CONTRACT.
- 10 THE RELOCATION OF EXISTING SIGNS SHALL BE INCLUDED IN THE COST OF PORTLAND CEMENT CONCRETE SIDEWALK, 4 INCH.
- 11 A TURNING SPACE SHALL BE PROVIDED AT ALL TURNS IN THE SIDEWALK. THE TURNING SPACE SHALL BE A MINIMUM OF 5' X 5' AREA WITH GRADES IN ALL DIRECTIONS TO BE 2% OR LESS.

SUMMARY OF QUANTITIES				
TOTAL QUANTITY	UNIT	ITEM	PAY ITEM NUMBER	SP
218.0	SQ YD	WELDED WIRE REINFORCEMENT	42000060	
3,771.5	SQ FT	PORTLAND CEMENT CONCRETE SIDEWALK 4 INCH	42400100	
1,962	SQ FT	PORTLAND CEMENT CONCRETE SIDEWALK 6 INCH	42400300	
80	SQ FT	DETECTABLE WARNINGS	42400800	
6	FOOT	CURB REMOVAL	44000300	
6	FOOT	COMBINATION CURB AND GUTTER REMOVAL	44000500	
160	SQ FT	SIDEWALK REMOVAL	44000600	
1	L SUM	MOBILIZATION	67100100	
308	FOOT	THERMOPLASTIC PAVEMENT MARKING - LINE 6"	78000400	*
1	L SUM	TRAFFIC CONTROL AND PROTECTION, (SPECIAL)	X7010216	^
875	SQ FT	COMBINATION CONCRETE CURB AND SIDEWALK 4 INCH (SPECIAL)	XX006498	^

* SPECIALTY ITEMS

DATE	BY	REVIEWED	DATE
		IN COMPLIANCE WITH	
		NOTE BOOK	
		NO.	

DATE	BY	REVIEWED	DATE
		IN COMPLIANCE WITH	
		NOTE BOOK	
		NO.	

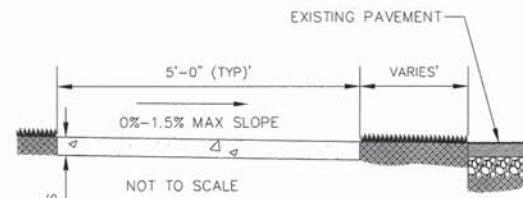

TYPICAL SIDEWALK SECTION
NOT TO SCALE

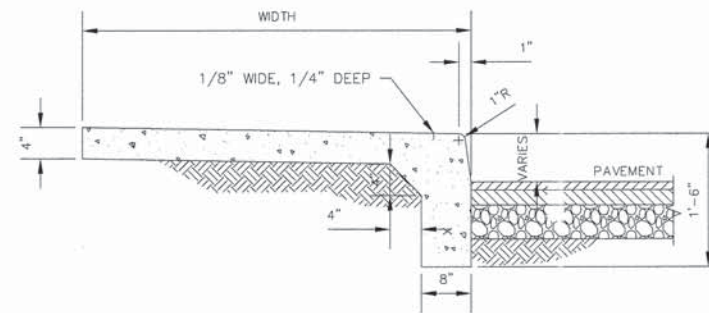

PORTLAND CEMENT CONCRETE SIDEWALK AND CURB WALL DETAIL
NOT TO SCALE

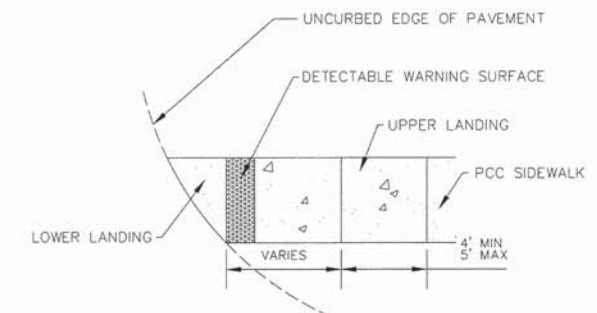

NOTE: 12:1 MAX (TRANSITION TO MATCH EXISTING PAVEMENT GRADE)
TYPE "A" RAMP (MODIFIED)
NOT TO SCALE



HLR JOB NO = 151829.330	DESIGNED - S.A.A.	REVISED -
LAMAC JOB = C141LB94LV	CHECKED - A.M.M.	REVISED -
PLOT SCALE =	DRAWN -	REVISED -
PLOT DATE =	CHECKED -	REVISED -

**CITY OF LAWRENCEVILLE
SAFE ROUTES TO SCHOOL
LAWRENCE COUNTY, ILLINOIS**

GENERAL NOTES, SUMMARY OF QUANTITIES, AND DETAILS

SCALE: SHEET 1 OF SHEETS STA. TO STA.

STREET	CITY	COUNTY	TOTAL SHEETS	SHEET NO.
VARIOUS	LAWRENCEVILLE	LAWRENCE	11	2
			CONTRACT NO. 95794	
ILLINOIS FED. AID PROJECT				

PLAN
 DATE: _____
 BY: _____
 SURVEYED: _____
 GRADES CHECKED: _____
 B.M. NOTED: _____
 NO. _____
 ALIGNED: _____
 CHECKED: _____
 NO. _____
 FILE NAME: _____

PROFILE
 DATE: _____
 BY: _____
 SURVEYED: _____
 GRADES CHECKED: _____
 B.M. NOTED: _____
 NO. _____
 ALIGNED: _____
 CHECKED: _____
 NO. _____
 FILE NAME: _____

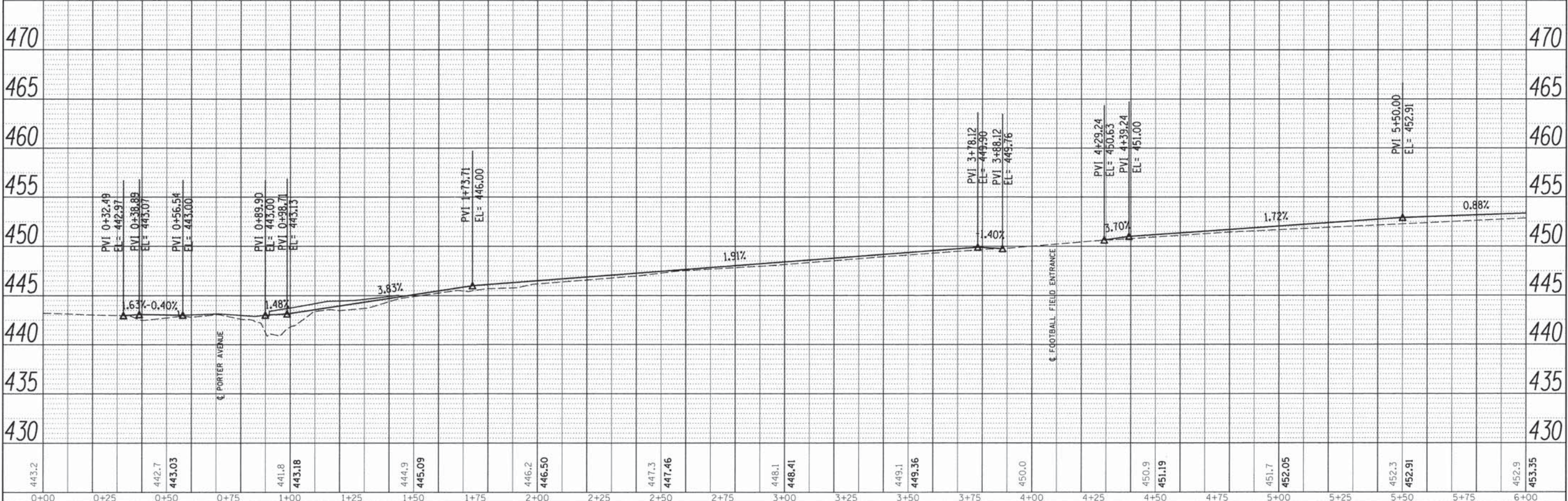
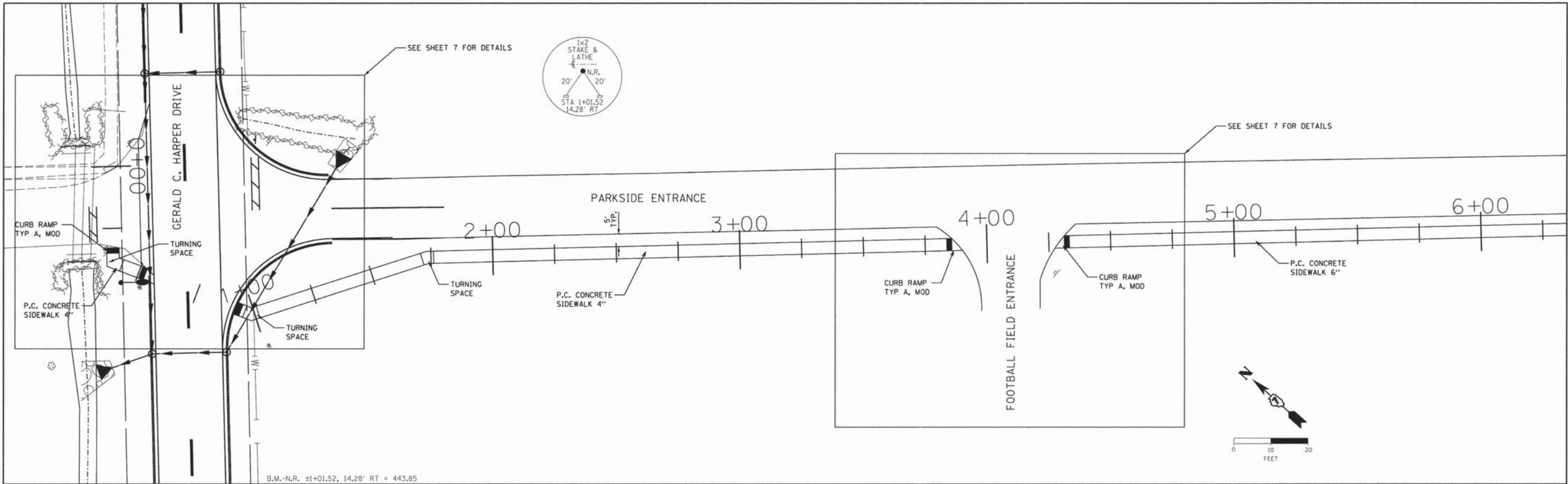

LAMAC ENGINEERING A Division of Heppner, Landry and Rasmussen, Inc. ILLINOIS PROFESSIONAL DESIGN FIRM LS / PE / SE CORP. 184000899		HLR JOB NO = 15.1029.330 LAMAC JOB = C141L889LV PLOT SCALE = PLOT DATE =		DESIGNED - S.A.A. CHECKED - A.M.M. DRAWN - S.A.A. CHECKED - A.M.M.		REVISED - REVISED - REVISED - REVISED -		CITY OF LAWRENCEVILLE SAFE ROUTE TO SCHOOL LAWRENCE COUNTY, ILLINOIS				PARKSIDE ENTRANCE SIDEWALK PLAN AND PROFILE				STREET: VARIOUS CITY: LAWRENCEVILLE COUNTY: LAWRENCE CONTRACT NO. 95794		TOTAL SHEETS: 11 SHEET NO.: 4	
SCALE:		SHEET 1		OF		SHEETS		STA.		TO STA.		ILLINOIS FED. AID PROJECT							

PLAN	SURVEYED	DATE
	NOTED	
	PLOTTED	
	CHECKED	
	BY	
	NO. OF WAY CHECKED	
	PLD FILE NAME	
	NO.	

PROFILE	SURVEYED	DATE
	NOTED	
	PLOTTED	
	CHECKED	
	BY	
	NO. OF WAY CHECKED	
	PLD FILE NAME	
	NO.	

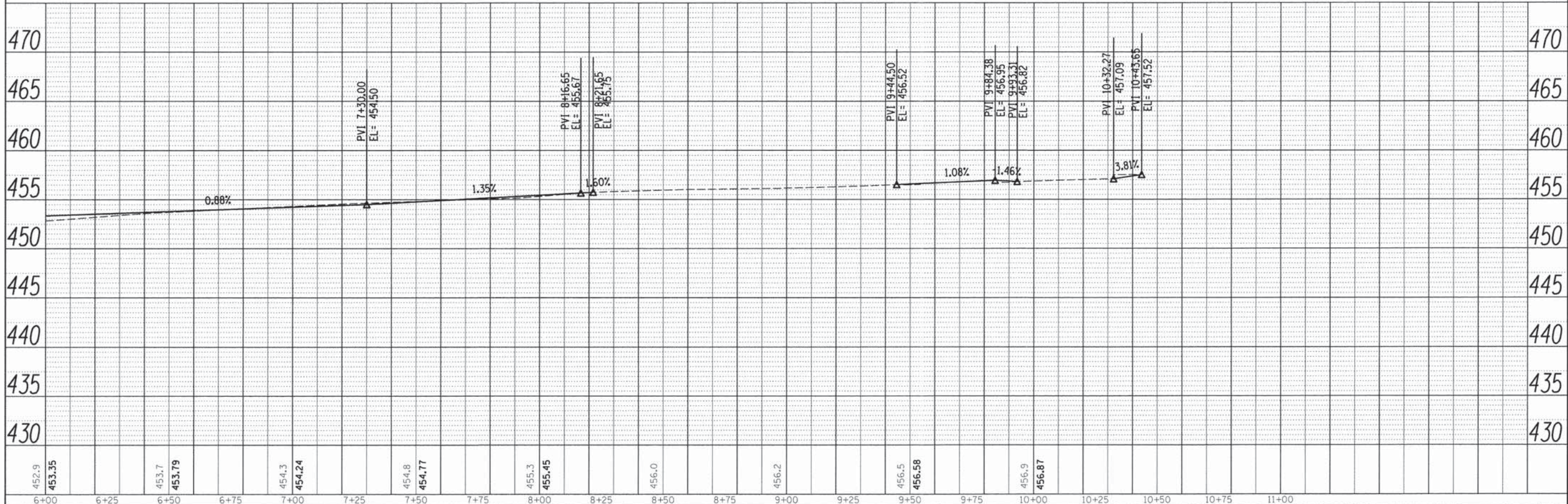
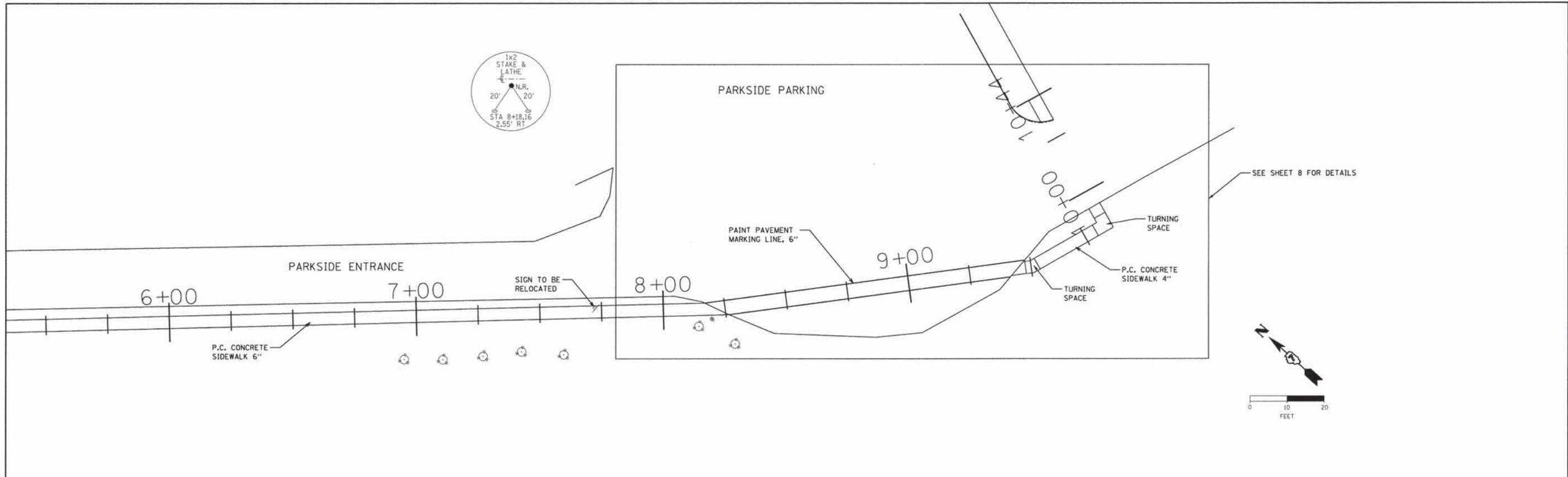

LAMAC ENGINEERING A Division of Hensley, Lenzini and Renwick, Inc. ILLINOIS PROFESSIONAL DESIGN FIRM LS / PE / SE CORP 18400969	HLR JOB NO = 15.1029.330 LAMAC JOB = C141L089LV PLOT SCALE = PLOT DATE =	DESIGNED - S.A.A. CHECKED - A.M.M. DRAWN - S.A.A. CHECKED - A.M.M.	REVISED - REVISED - REVISED - REVISED -	CITY OF LAWRENCEVILLE SAFE ROUTE TO SCHOOL LAWRENCE COUNTY, ILLINOIS	PARKSIDE ENTRANCE SIDEWALK PLAN AND PROFILE	STREET: VARIOUS CITY: LAWRENCEVILLE COUNTY: LAWRENCE ILLINOIS FED. AID PROJECT	TOTAL SHEETS: 11 SHEET NO.: 5 CONTRACT NO. 95794
	SCALE: SHEET 1 OF 11 SHEETS STA. TO STA.						

PLAN	SURVEYED	DATE
	PLOTTED	BY
	CHECKED	
	BY	
	DATE	
	NO.	
	FILE NAME	

PROFILE	SURVEYED	DATE
	PLOTTED	BY
	CHECKED	
	BY	
	DATE	
	NO.	
	FILE NAME	

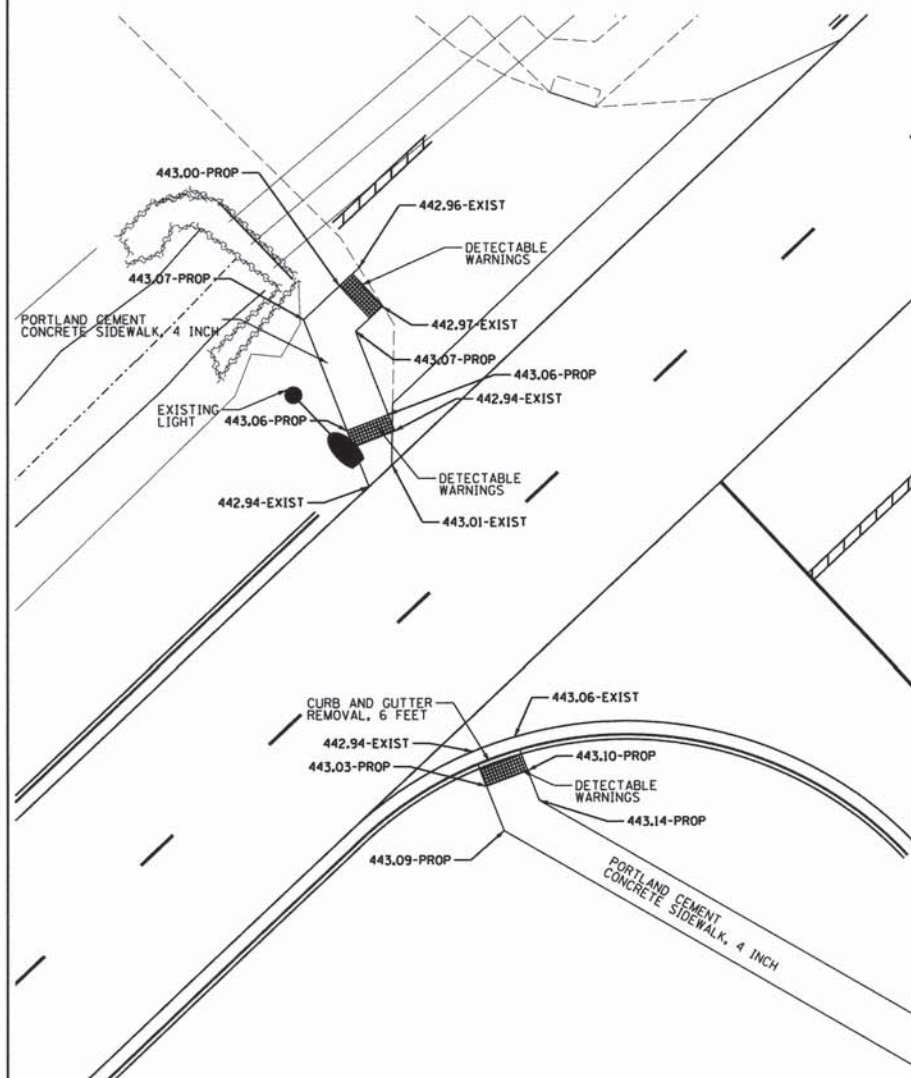

GERALD C. HARPER DRIVE AND PARKSIDE ENTRANCE
SHEET 4

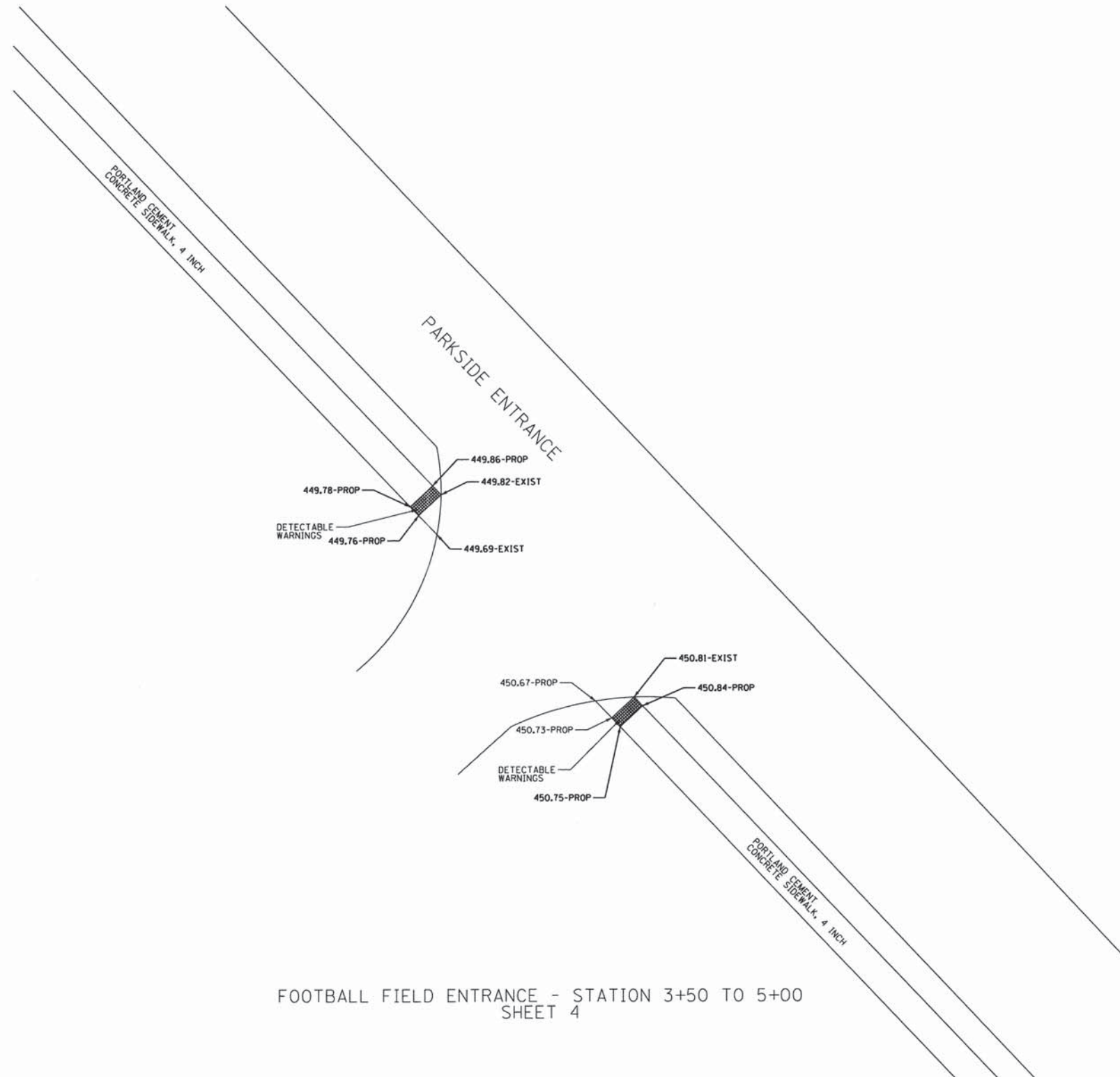

FOOTBALL FIELD ENTRANCE - STATION 3+50 TO 5+00
SHEET 4



303 W. 3RD ST.
P.O. BOX 100
MT. CARMEL, IL 62453
ILLINOIS PROFESSIONAL DESIGN FIRM LS / PE / SE CORP 18400099

HLR JOB NO = 15.1829.338	DESIGNED - S.A.A.	REVISED -
LAMAC JOB = C141LB94LY	CHECKED - A.M.M.	REVISED -
PLOT SCALE =	DRAWN -	REVISED -
PLOT DATE =	CHECKED -	REVISED -

**CITY OF LAWRENCEVILLE
SAFE ROUTES TO SCHOOL
LAWRENCE COUNTY, ILLINOIS**

INTERSECTION DETAILS

SCALE: SHEET 1 OF SHEETS STA. TO STA.

STREET	CITY	COUNTY	TOTAL SHEETS	SHEET NO.
VARIOUS	LAWRENCEVILLE	LAWRENCE	11	7
			CONTRACT NO. 95794	
ILLINOIS FED. AID PROJECT				

PLAN	SURVEYED	DATE
	ALIGNED	
	CHECKED	
	BY	
	NO.	

PROFILE	SURVEYED	DATE
	GRADES CHECKED	
	BY	
	NO.	

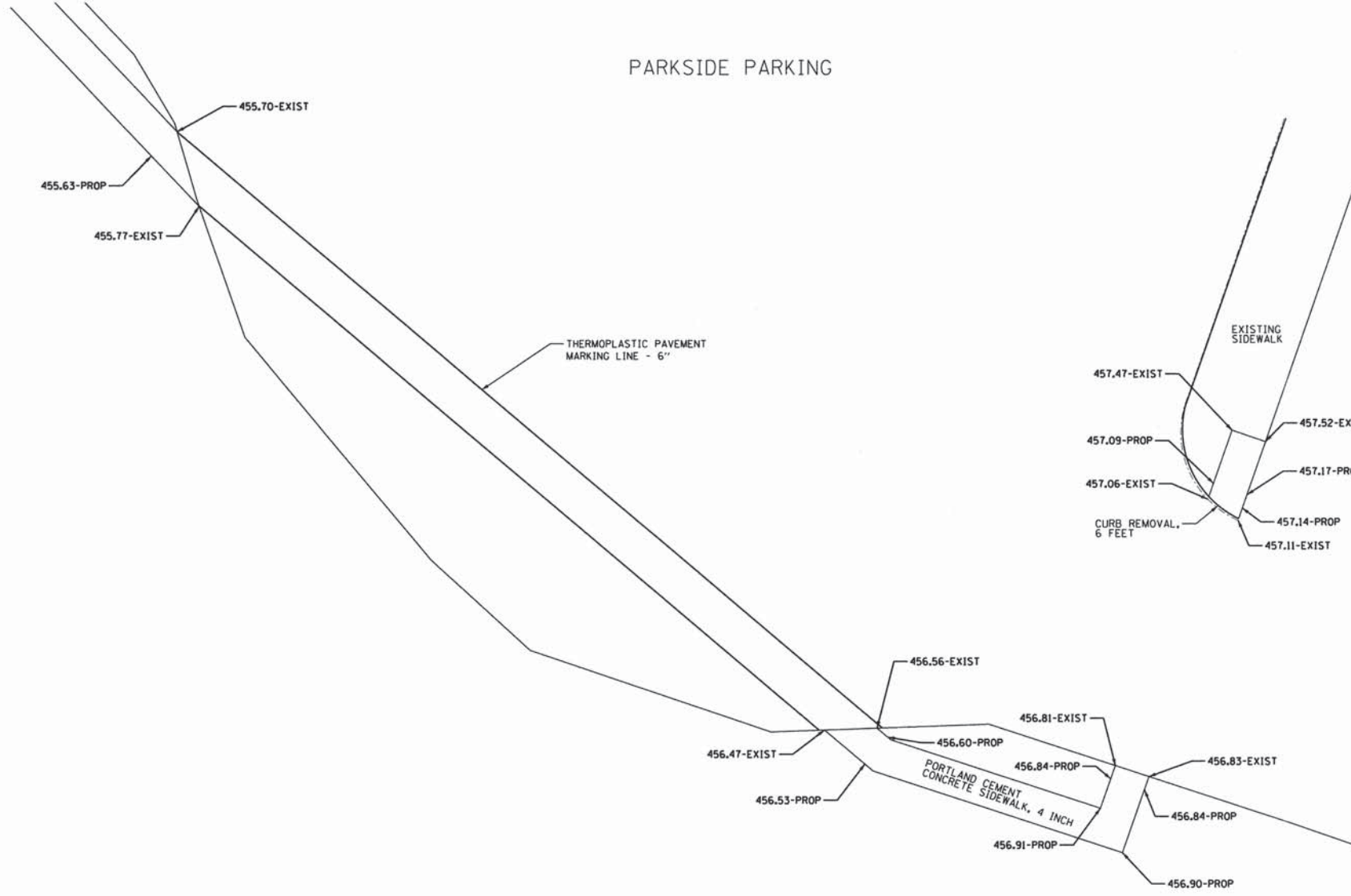

PARKSIDE ENTRANCE - STATION 9+50 TO 10+50
SHEET 5

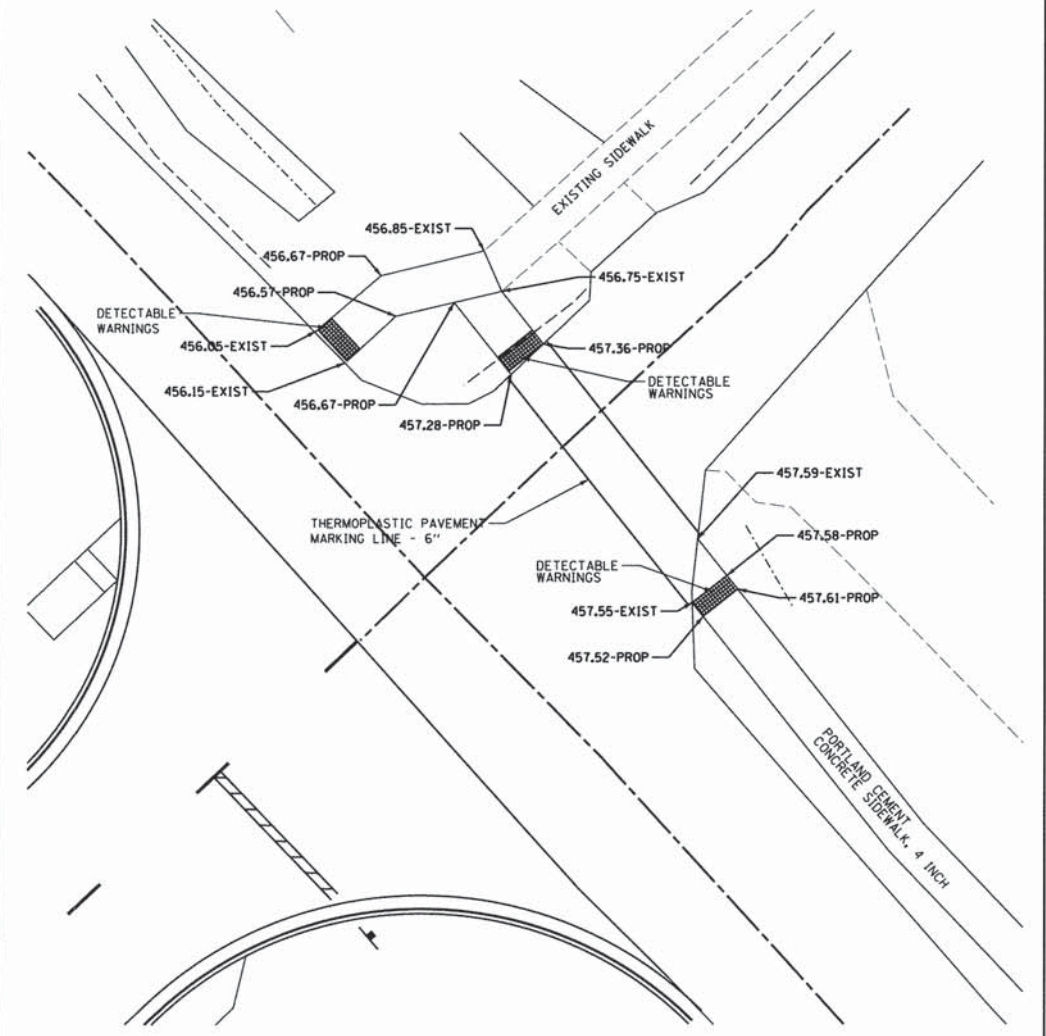

GERALD C. HARPER DRIVE AND CEDAR STREET
SHEET 6

LAMAC
ENGINEERING
A Division of Hampton, Lenz and Remick, Inc.
ILLINOIS PROFESSIONAL DESIGN FIRM LS / PE / SE CORP 184003559

323 W. 3RD ST.
P.O. BOX 180
MT. CARMEL, IL 62883
HLR JOB NO = 15.1029.330
LAMAC JOB = C141L089LV
PLOT SCALE =
PLOT DATE =

DESIGNED - S.A.A.
CHECKED - A.M.M.
DRAWN -
CHECKED -

REVISED -
REVISED -
REVISED -
REVISED -

**CITY OF LAWRENCEVILLE
SAFE ROUTES TO SCHOOL
LAWRENCE COUNTY, ILLINOIS**

INTERSECTION DETAILS

SCALE: SHEET 1 OF SHEETS STA. TO STA.

STREET	CITY	COUNTY	TOTAL SHEETS	SHEET NO.
VARIOUS	LAWRENCEVILLE	LAWRENCE	11	8
			CONTRACT NO. 95794	
ILLINOIS FED. AID PROJECT				

PLAN	DESIGNED	BY	DATE
NOTE BOOK NO.	ALIGNED		
	CHECKED		
	FILE NAME		

PROFILE	DESIGNED	BY	DATE
NOTE BOOK NO.	GRADES CHECKED		
	STRUCTURE NOTATIONS		

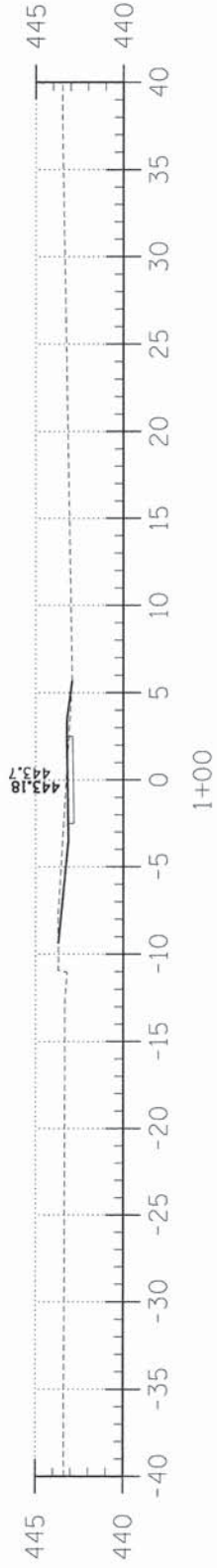
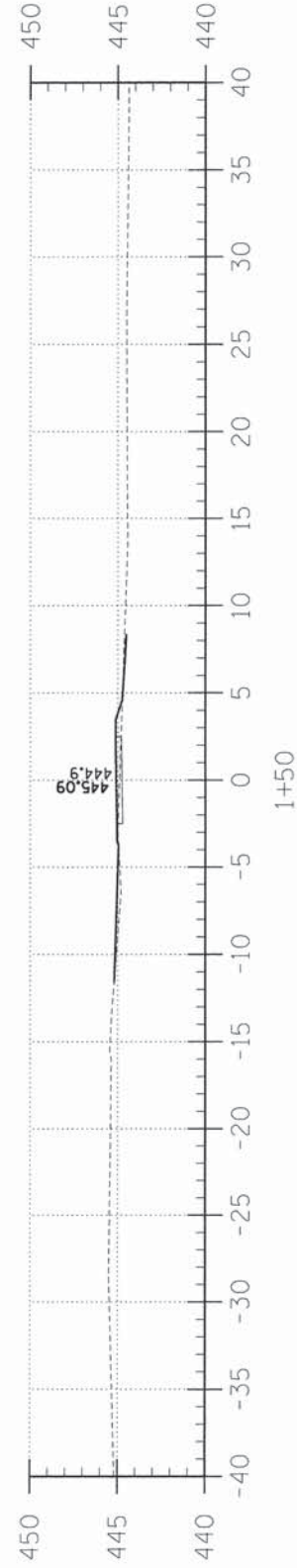
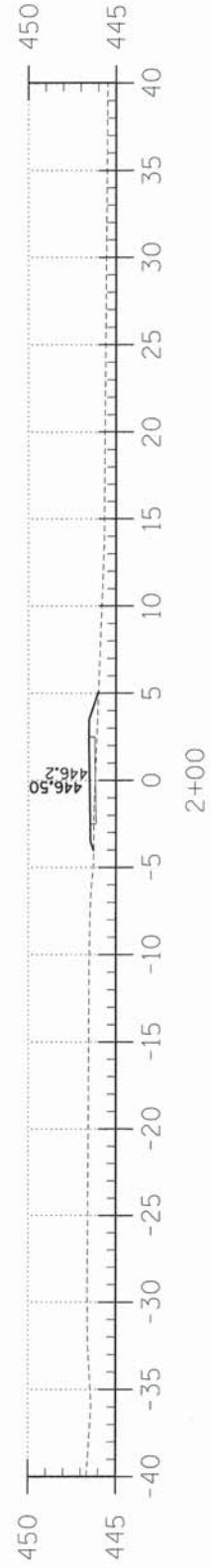
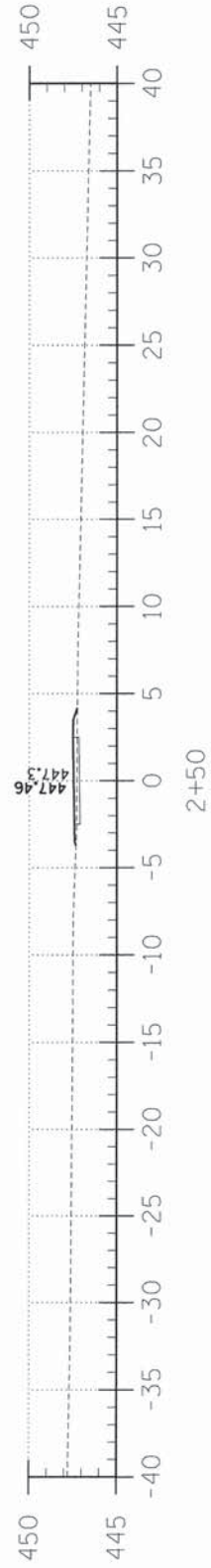
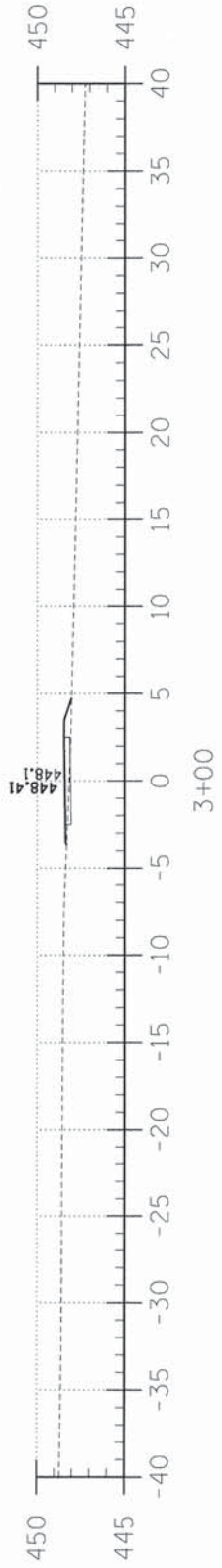
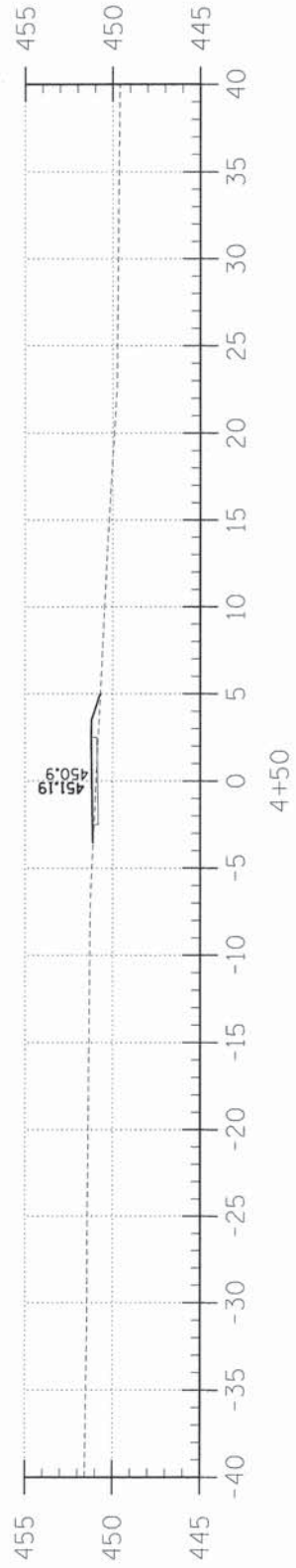
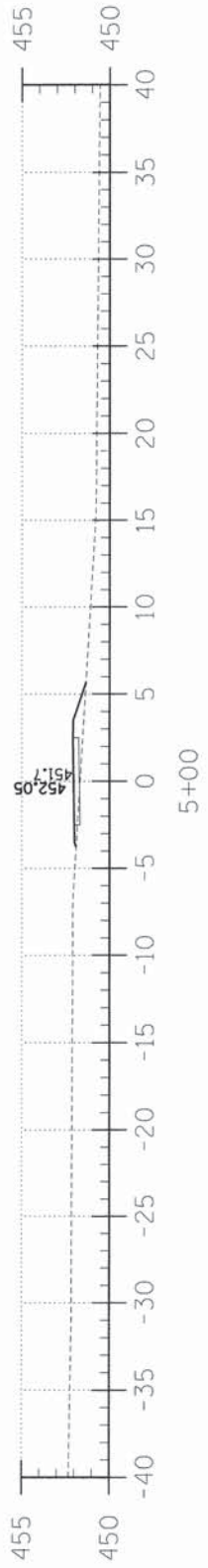
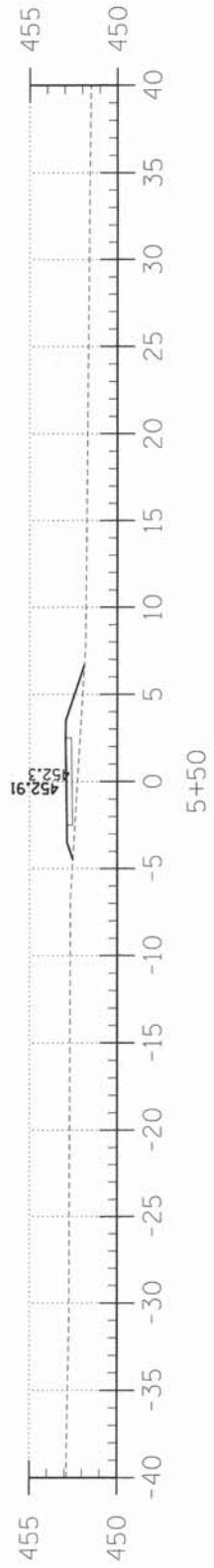

LAMAC ENGINEERING
 A Division of Hampton, Lenzini and Remick, Inc.
 ILLINOIS PROFESSIONAL DESIGN FIRM LS / PE / SE CORP. 184200939

HLR JOB NO = 15.1029.330
 LAMAC JOB = C141L089LV
 PLOT SCALE =
 PLOT DATE =

DESIGNED - S.A.A.
 CHECKED - A.M.M.
 DRAWN -
 CHECKED -

REVISED -
 REVISED -
 REVISED -
 REVISED -

**CITY OF LAWRENCEVILLE
 SAFE ROUTES TO SCHOOL
 LAWRENCE COUNTY, ILLINOIS**

**PARKSIDE ENTRANCE
 CROSS SECTIONS**

SCALE: SHEET 1 OF SHEETS STA. TO STA.

STREET	CITY	COUNTY	TOTAL SHEETS	SHEET NO.
VARIOUS	LAWRENCEVILLE	LAWRENCE	11	9
			CONTRACT NO. 95794	
ILLINOIS FED. AID PROJECT				

PLAN	SURVEYED	DATE
NO.	BY	
	NOTED	
	CHECKED	
	BY	
	FILE NAME	

PROFILE	SURVEYED	DATE
NO.	BY	
	NOTED	
	CHECKED	
	BY	
	FILE NAME	

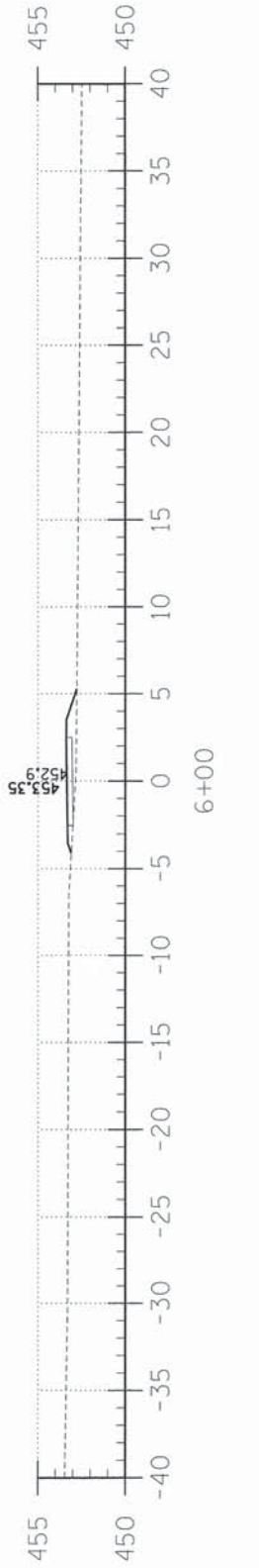
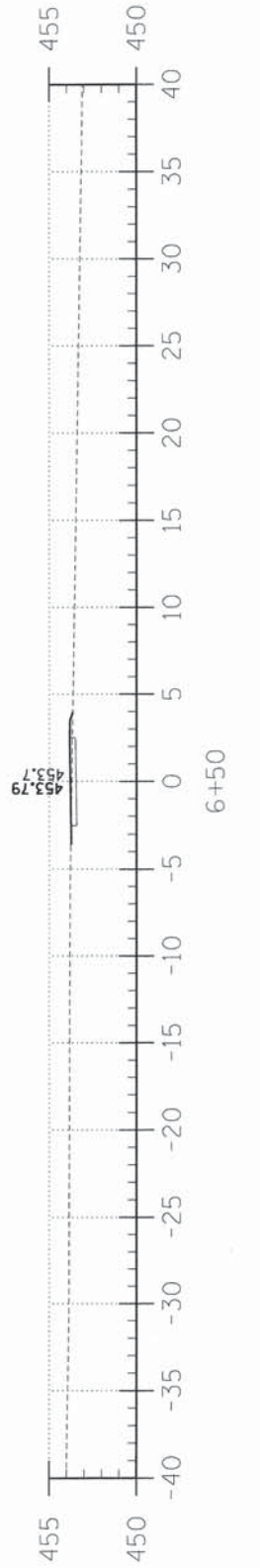
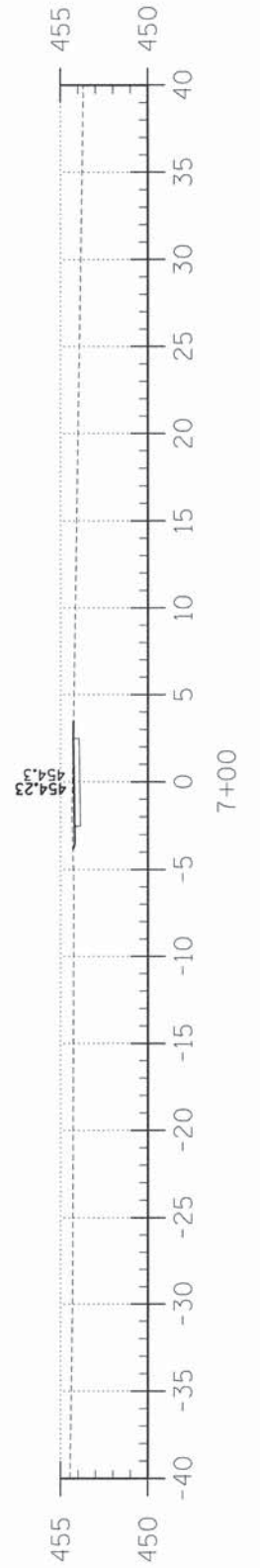
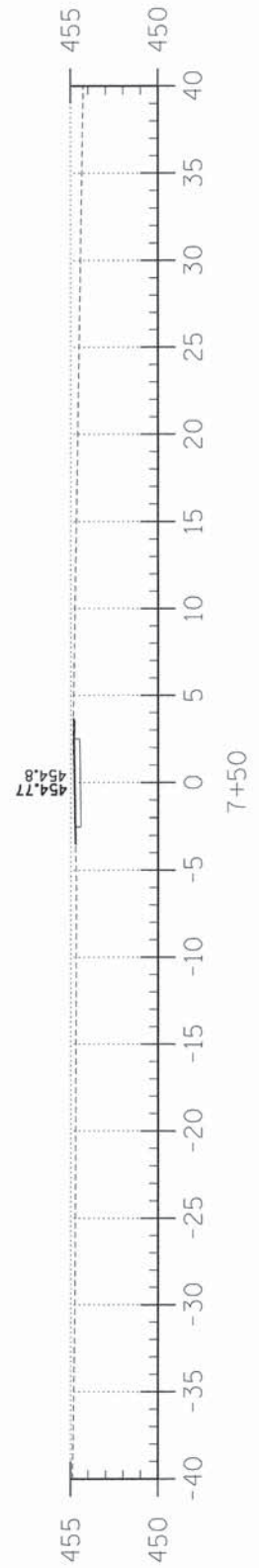
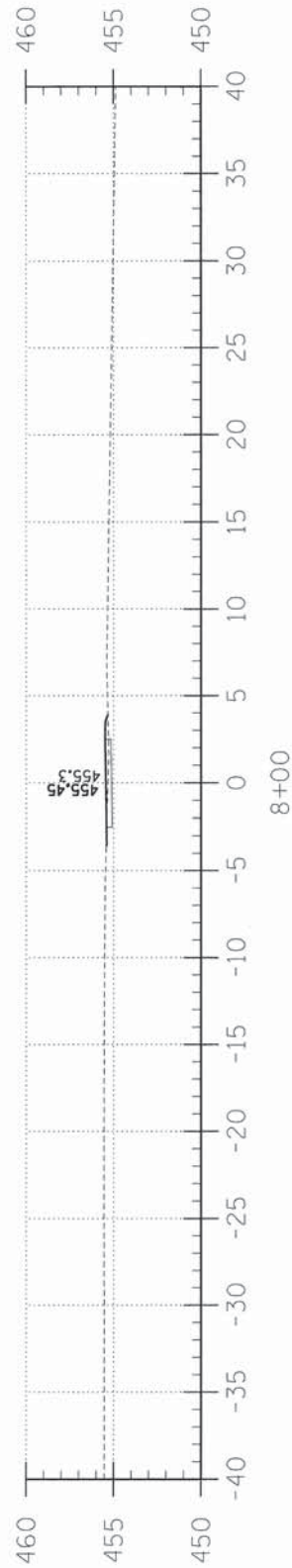

HLR JOB NO = 15.1029.338	DESIGNED - S.A.A.	REVISED -
LAMAC JOB = C141LB94LV	CHECKED - A.M.M.	REVISED -
PLOT SCALE =	DRAWN -	REVISED -
PLOT DATE =	CHECKED -	REVISED -

**CITY OF LAWRENCEVILLE
SAFE ROUTES TO SCHOOL
LAWRENCE COUNTY, ILLINOIS**

**PARKSIDE ENTRANCE
CROSS SECTIONS**

SCALE: SHEET 1 OF SHEETS STA. TO STA.

STREET	CITY	COUNTY	TOTAL SHEETS	SHEET NO.
VARIOUS	LAWRENCEVILLE	LAWRENCE	11	10
			CONTRACT NO. 95794	
ILLINOIS FED. AID PROJECT				

PLAN	SURVEYED	DATE
NOTE BOOK	ALTIMETER CHECKED	BY
NO.	PLS. FILE NAME	

PROFILE	SURVEYED	DATE
NOTE BOOK	GRADES CHECKED	BY
NO.	PROTOTYPE NOTATION	

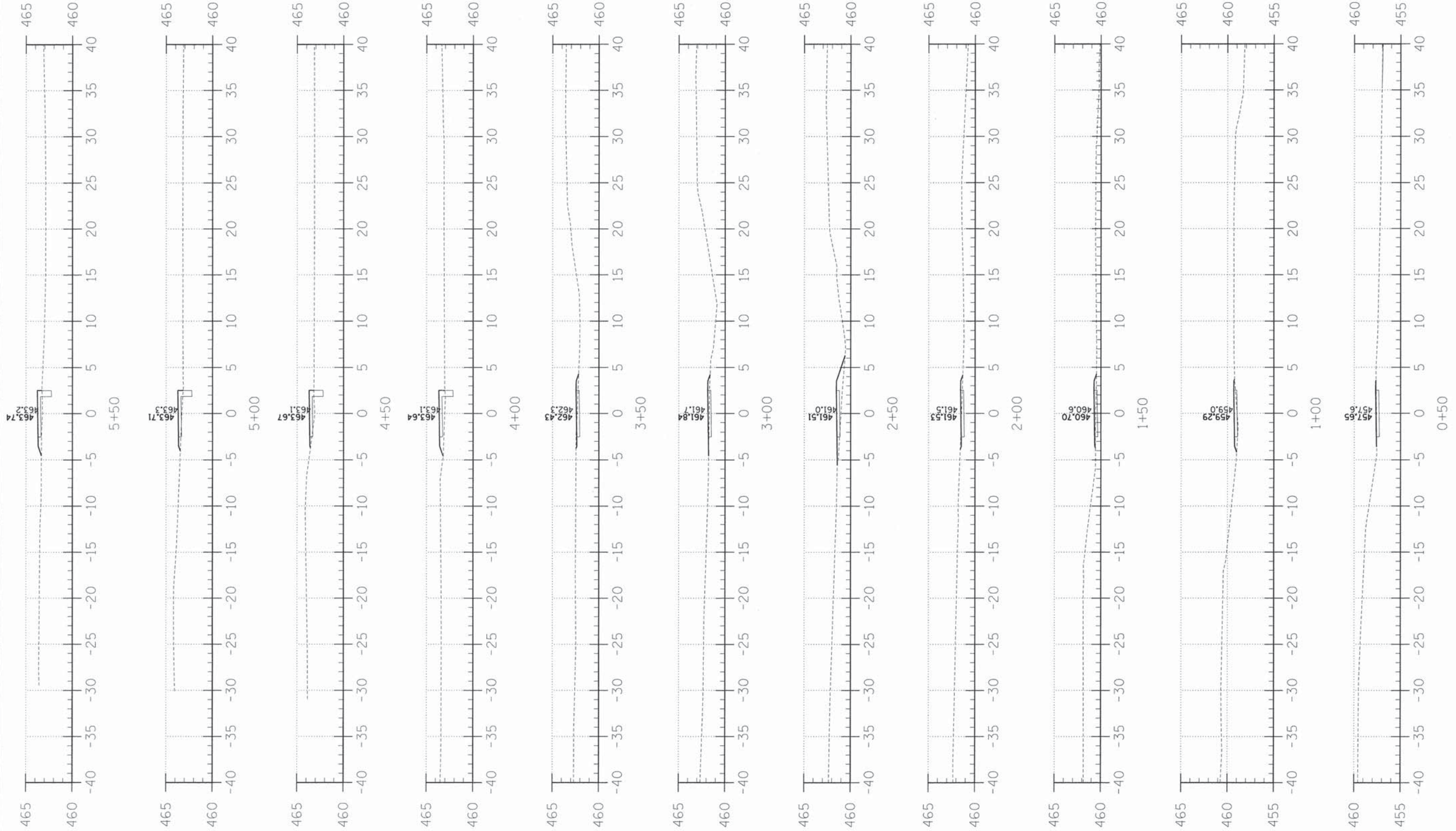

303 W. 9th St.
P.O. Box 180
Mt. Carmel, IL 62883

HLR JOB NO = 15.1029.330
LAMAC JOB = C14IL089LV
PLOT SCALE =
PLOT DATE =

DESIGNED - S.A.A.
CHECKED - A.M.M.
DRAWN -
CHECKED -

REVISED -
REVISED -
REVISED -
REVISED -

**CITY OF LAWRENCEVILLE
SAFE ROUTES TO SCHOOL
LAWRENCE COUNTY, ILLINOIS**

**CEDAR STREET
CROSS SECTIONS**

SCALE: SHEET 1 OF SHEETS STA. TO STA.

STREET	CITY	COUNTY	TOTAL SHEETS	SHEET NO.
VARIOUS	LAWRENCEVILLE	LAWRENCE	11	11
CONTRACT NO. 95794				
ILLINOIS FED. AID PROJECT				