

CP 216

N 1729135.49
 E 1022659.53
 STA 1101+17.33
 OFF 127.40' RT
 ELEV 550.56

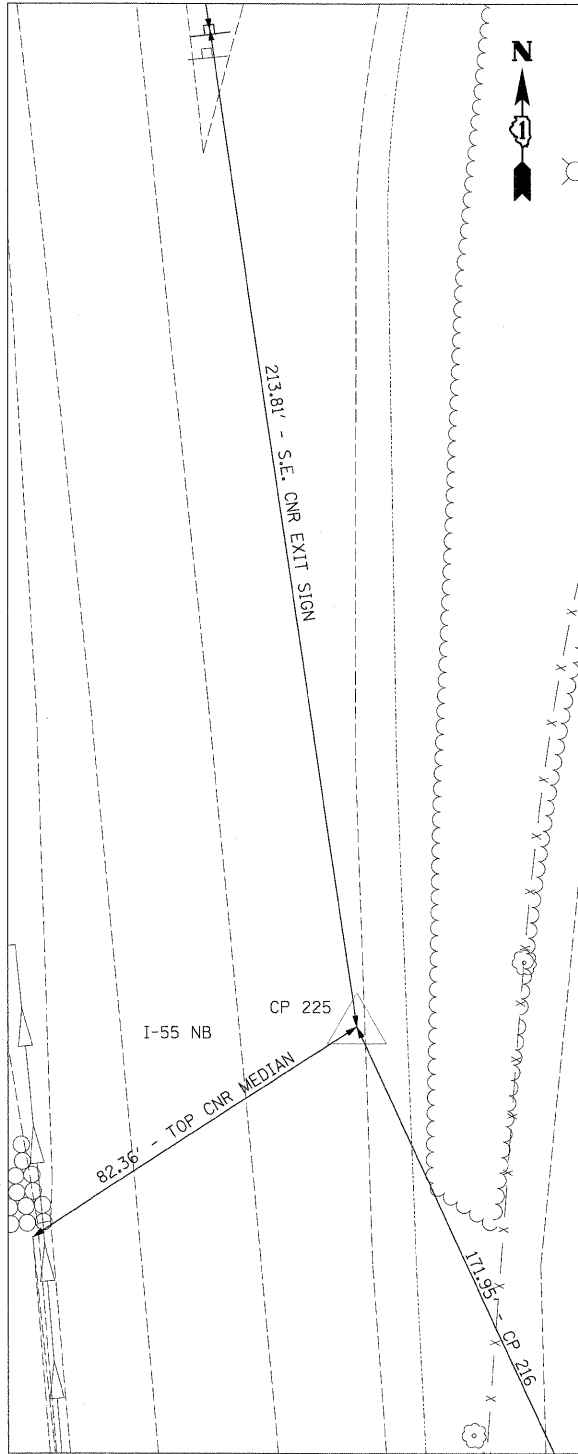

CP 225

N 1729291.64
 E 1022587.53
 STA 1102+78.21
 OFF 69.34' RT
 ELEV 549.30

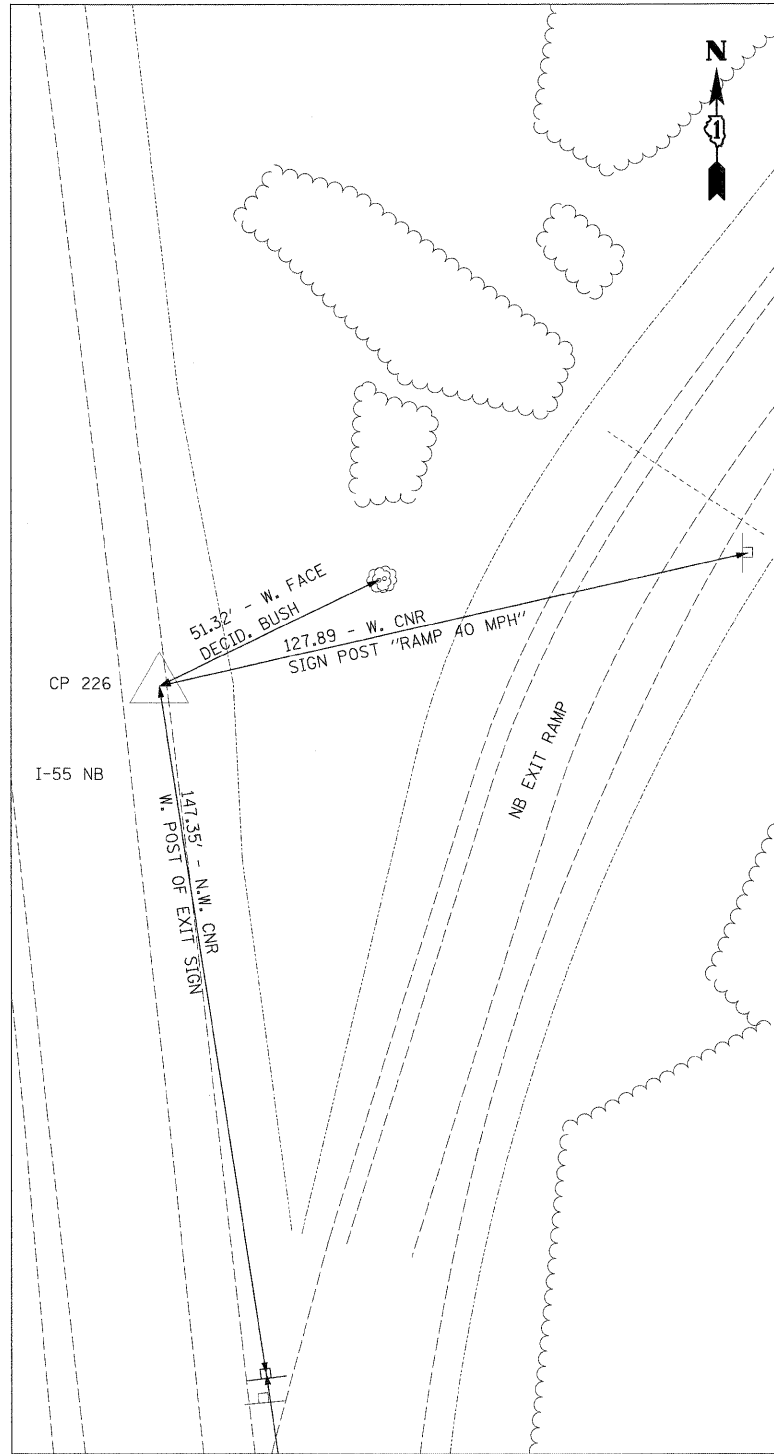

CP 226

N 1729649.45
 E 1022533.85
 STA 1106+38.31
 OFF 53.00' RT
 ELEV 548.92

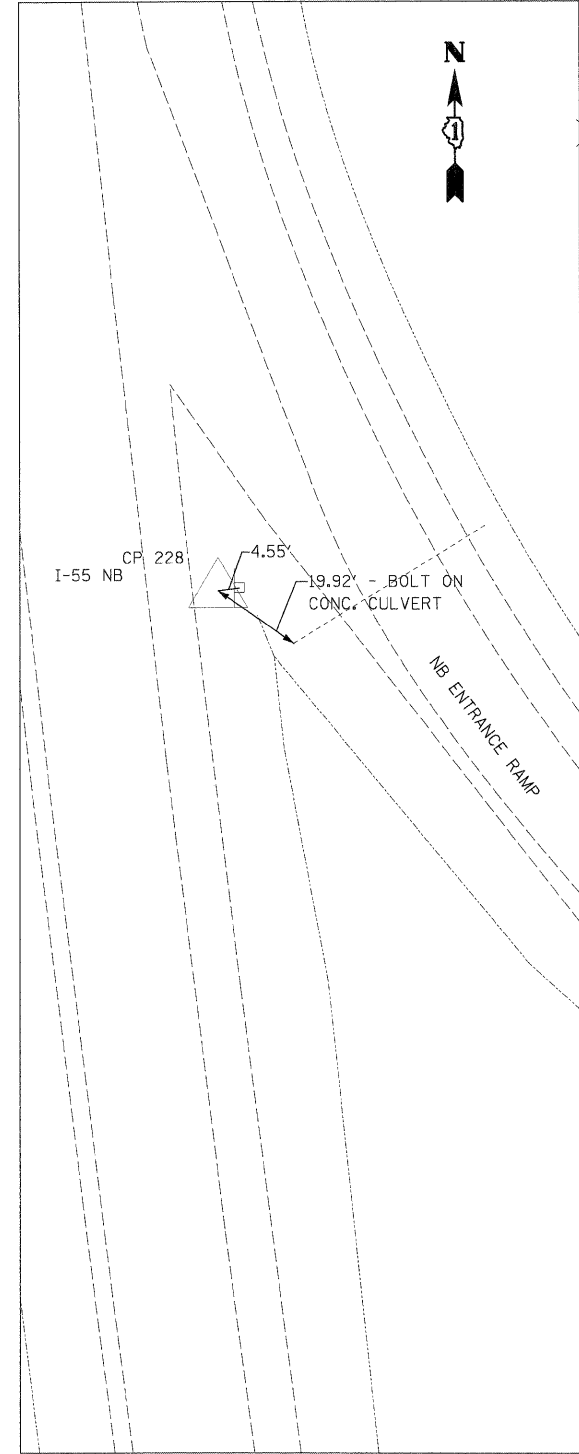

CP 228

N 1730192.79
 E 1022473.00
 STA 1111+85.14
 OFF 59.54' RT
 ELEV 545.76

FILE NAME = D160C31-SHT-ATB08.dgn	USER NAME = TKLuegal	DESIGNED - TRK	REVISED -
		DRAWN - TRK	REVISED -
		CHECKED - DLT	REVISED -
		DATE - 12/18/09	REVISED -

**STATE OF ILLINOIS
 DEPARTMENT OF TRANSPORTATION**

ALIGNMENTS, TIES, AND BENCHMARKS

SCALE: 1"=20' SHEET NO. 8 OF 9 SHEETS STA. TO STA.

F.A.I. RTE.	SECTION	COUNTY	TOTAL SHEETS	SHEET NO.
55	(99-1&2)AC-3	WILL	524	36
FED. ROAD DIST. NO. 1 ILLINOIS FED. AID PROJECT			CONTRACT NO. 60C31	

FINAL