

PLAN	REVISIONS	BY	DATE
NO.	NO.		
NO.	NO.		
NO.	NO.		

PROFILE	REVISIONS	BY	DATE
NO.	NO.		
NO.	NO.		
NO.	NO.		

300 W. ADAMS ST.  
CHICAGO, IL 60606  
TEL: (312) 629-0240  
SINGH & ASSOCIATES, INC.  
CONSULTING ENGINEERS  
FAX: (312) 629-8449

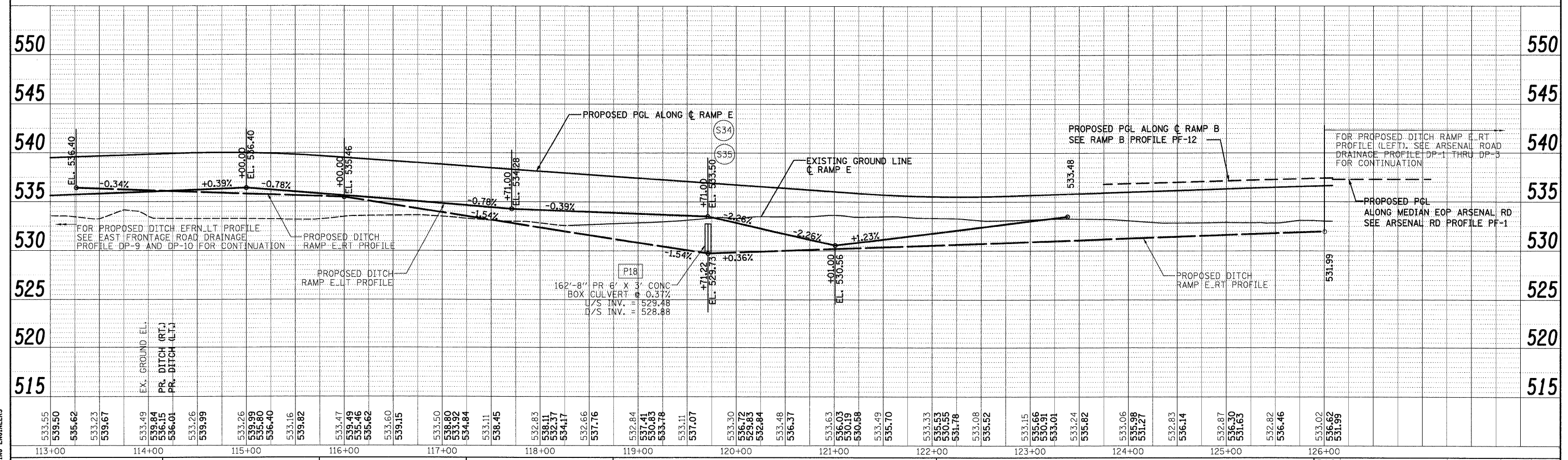
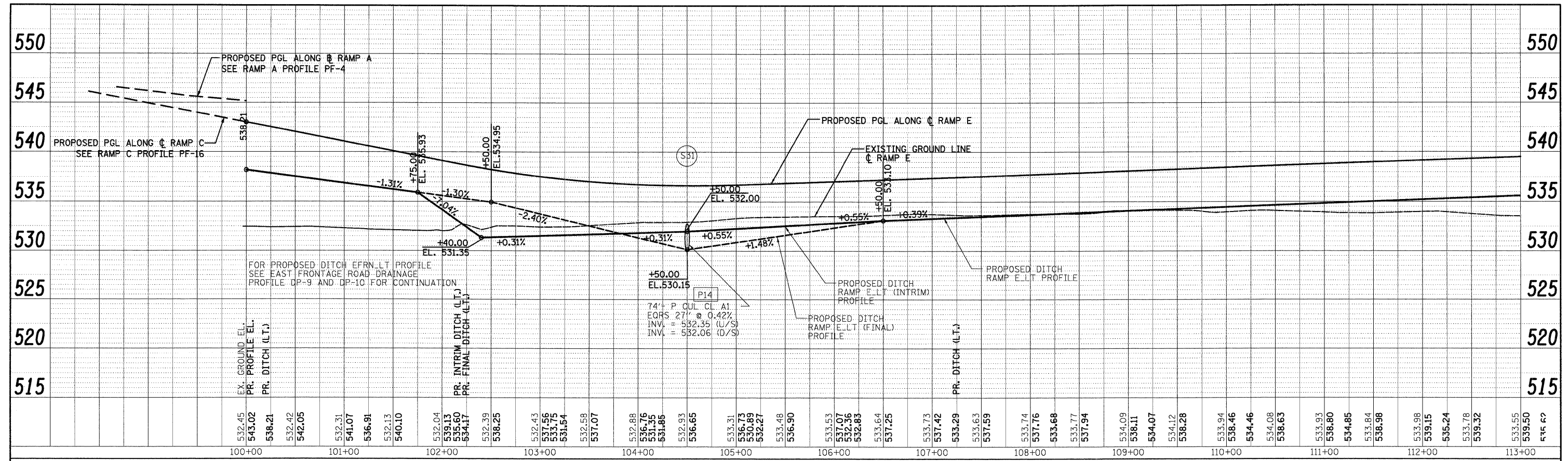

FILE NAME = D:\6033-SHT-DRAINPROFILE18.dgn	USER NAME = TKLuogel	DESIGNED - PTK/VP	REVISED -	<p style="text-align: center;"><b>STATE OF ILLINOIS DEPARTMENT OF TRANSPORTATION</b></p> <p style="text-align: center;"><b>RAMP E DRAINAGE PROFILE</b></p> <p>SCALE: 1"=50' HORIZ. 1"=5' VERT. SHEET NO. 18 OF 18 SHEETS STA. TO STA.</p>	F.A.I. RTE. = 55	SECTION = (99-1&2)AC-3	COUNTY = WILL	TOTAL SHEETS = 524	SHEET NO. = 183
PLOT SCALE = 1:50	CHECKED - CL	DATE = 12/18/09	REVISED -		CONTRACT NO. = 60C31				
PLOT DATE = 12/11/2009	DATE = 12/18/09	REVISED -			FED. ROAD DIST. NO. 1 ILLINOIS FED. AID PROJECT				

FINAL