

Bench Marks:
RR spike in 2nd power pole N. of CPT 207, 1 ft. above ground, Elev. 534.690
Existing structure : None

STATE OF ILLINOIS
DEPARTMENT OF TRANSPORTATION

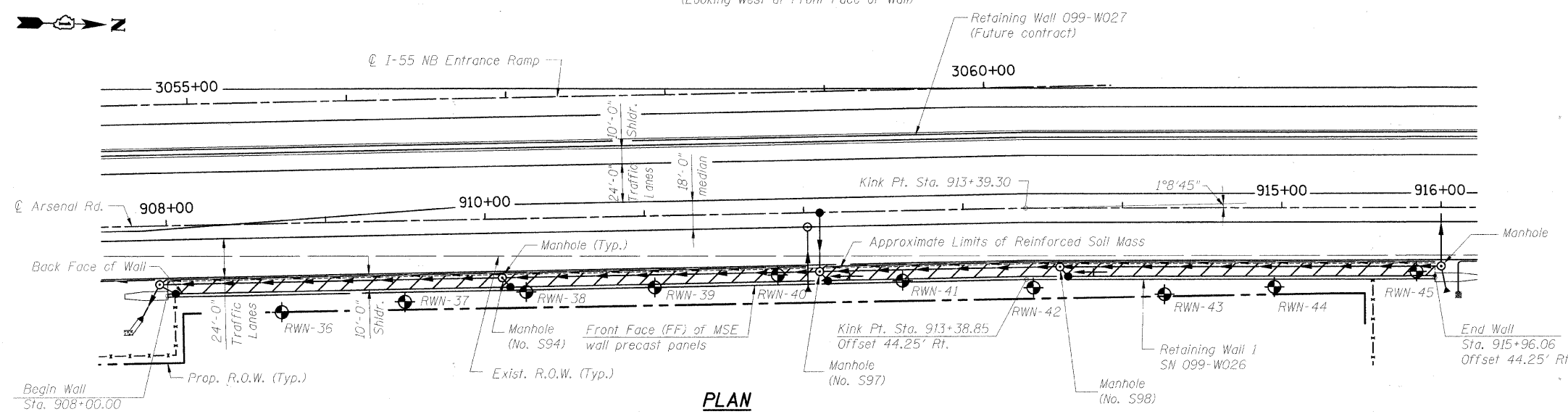
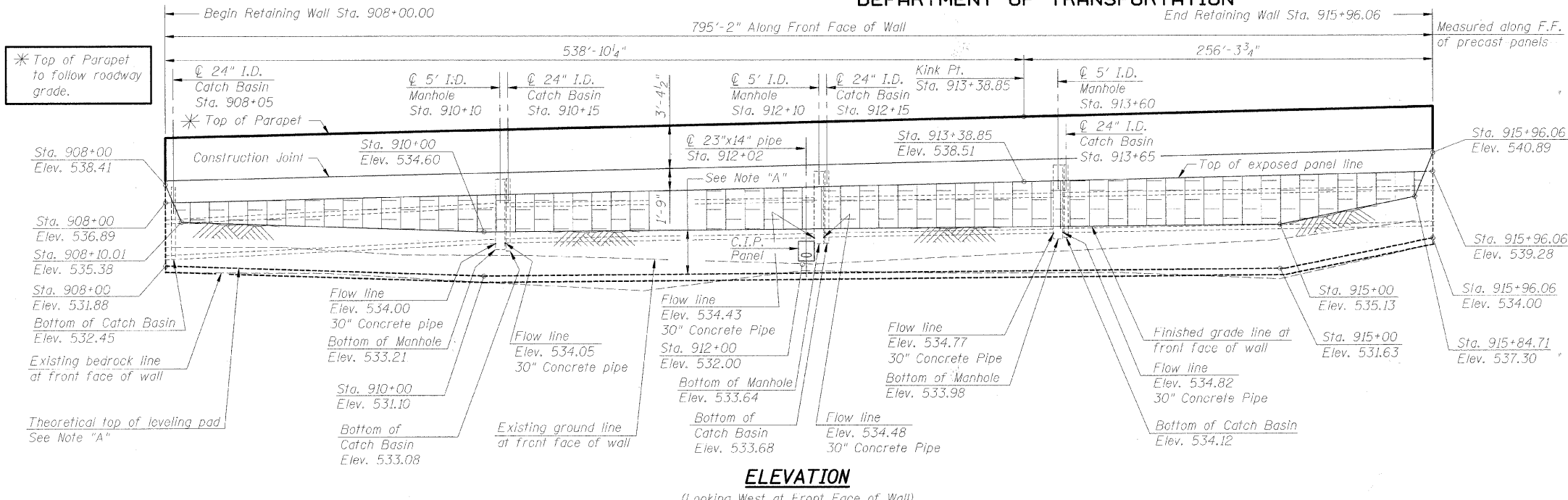

- LEGEND**
- Manhole
 - Catch Basin
 - ⊙ Soil Boring
 - F.F.=Front Face
 - B.F.=Back Face
 - E.F.=Each Face
 - I.F.=Inside Face
 - O.F.=Outside Face

DESIGNED	PMH
CHECKED	MJL
DRAWN	MH/RJ
CHECKED	BKB

Notes:
Wall offsets are measured from the @ Arsenal Rd. to the front face of precast panels.
For locations and sizes of manholes and pipes see drainage and utility plans.

DESIGN STRESSES

FIELD UNITS
f'c = 3,500 psi
fy = 60,000 psi (Reinforcement)

PRECAST UNITS

f'c = 4,500 psi (pre-cast units)

DESIGN SPECIFICATIONS

2002 AASHTO Standard Specifications

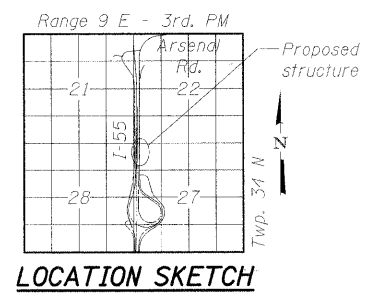
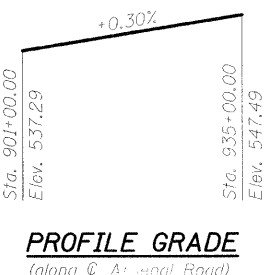

McDonough Associates Inc.
Engineers / Architects
130 East Randolph Street
Chicago, Illinois 60601
(312) 946-8600

INDEX OF SHEETS

1. General Plan & Elevation
2. MSE Wall-Plan & Elevation
3. MSE Wall-Plan & Elevation
4. Sections and Details
5. Sections and Details
6. Soil Boring Data
7. Soil Boring Data
8. Soil Boring Data
9. Soil Boring Data

GENERAL NOTES

1. Reinforcement bars shall conform to the requirements of ASTM A 706 Gr 60 (IL Modified). See Special Provisions.
2. Reinforcement bars designated (E) shall be epoxy coated.
3. Verify all drainage information shown on these plans regarding catch basins, manholes & pipes with drainage plans prior to fabrication or construction.
4. Sawcut or formed contraction joints shall be placed in the anchorage slab at every 15 ft. intervals Parapet joints shall be located at each anchorage slab joint. Pavement transverse joints to match anchorage slab joints.
5. The anchorage slab and parapet shall not be placed until the MSE wall has been erected and allowed to settle for at least thirty calendar days.

Note "A":
The top of levelling pad shall be established at minimum depth of 3.5 ft. below finished grade unless sound bed rock is encountered higher. When sound bed rock is encountered less than 1 foot below finished grade, the minimum embedment depth below the finished grade shall be 1 foot.

TOTAL BILL OF MATERIAL

ITEM	UNIT	TOTAL
Structure Excavation	Cu. Yds.	675
Concrete Structures	Cu. Yds.	400
Reinforcement Bars, Epoxy Coated	Lbs.	54,104
Mechanically Stabilized Earth Retaining Wall	Sq. Ft.	6,580
Removal and Disposal of Unsuitable Material for Structures	Cu. Yds.	278
Rock Excavation for Structures	Cu. Yds.	30.0

APPROVED
FOR STRUCTURAL ADEQUACY ONLY

Ralph E. Anderson (TIN)
ENGINEER OF BRIDGES AND STRUCTURES

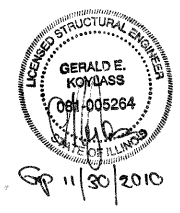

GENERAL PLAN & ELEVATION
ARSENAL ROAD
F.A.I. RTE. 55 - SEC. 46-2
WILL COUNTY
STATION 908+00.00 TO 915+96.06
STRUCTURE NO. 099-W026

SHEET NO. RW1-1 SHEETS RW1-9	F.A.I. RTE.	SECTION	COUNTY	TOTAL SHEETS	SHEET NO.
	55	(99-1&2) AC-3	WILL	524	302
FED. ROAD DIST. NO. 1 ILLINOIS FED. AID PROJECT				CONTRACT NO. 60C31	