

F.A.U. RTE.	SECTION	COUNTY	TOTAL SHEETS	SHEET NO.
1285	0507 RS-1	COOK	19	1
		ILLINOIS	CONTRACT NO. 60108	

STATE OF ILLINOIS
DEPARTMENT OF TRANSPORTATION
DIVISION OF HIGHWAYS

**PROPOSED
HIGHWAY PLANS**

FAU ROUTE 1285: PALATINE RD
ROSELLE RD TO QUENTIN RD
SECTION 0507 RS-1
RESURFACING
COOK COUNTY
C-91-848-09

FOR INDEX OF SHEETS, SEE SHEET NO. 2

THIS IMPROVEMENT IS LOCATED
IN THE VILLAGE OF PALATINE

D-91-848-09

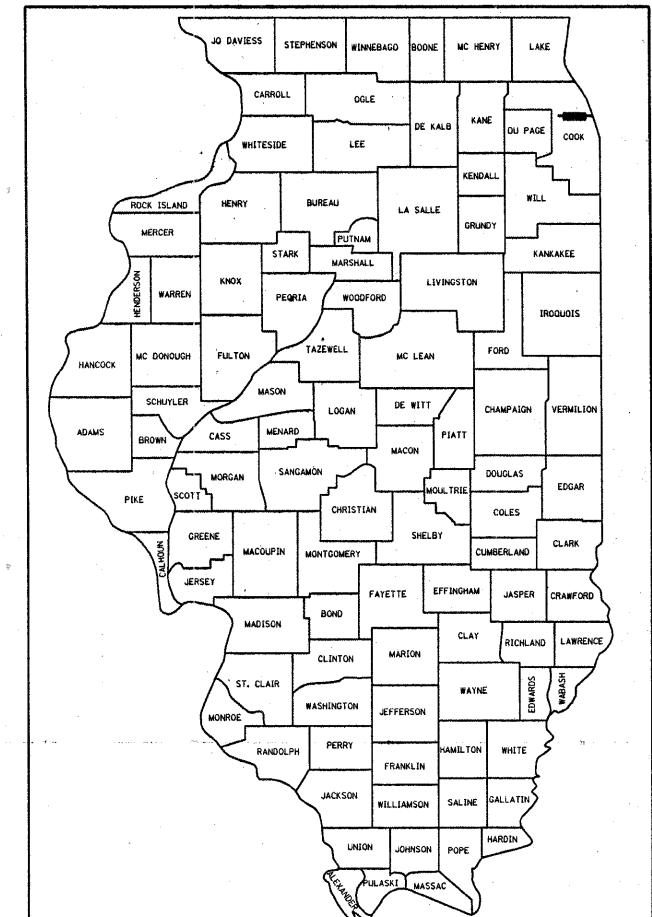

LOCATION OF SECTION INDICATED THUS: - ■ -

TRAFFIC DATA

2006 ADT = 14600
POSTED SPEED LIMIT = 35 MPH

FULL SIZE PLANS HAVE BEEN PREPARED USING STANDARD
ENGINEERING SCALES. REDUCED SIZED PLANS WILL NOT
CONFORM TO STANDARD SCALES. IN MAKING MEASUREMENTS
ON REDUCED PLANS, THE ABOVE SCALES MAY BE USED.

J.U.L.I.E.
JOINT UTILITY LOCATION INFORMATION FOR EXCAVATION
1-800-892-0123
OR 811

PROJECT ENGINEER ROBERT BORO (847) 705-4178
PROJECT MANAGER KEN ENG

CONTRACT NO. 60108

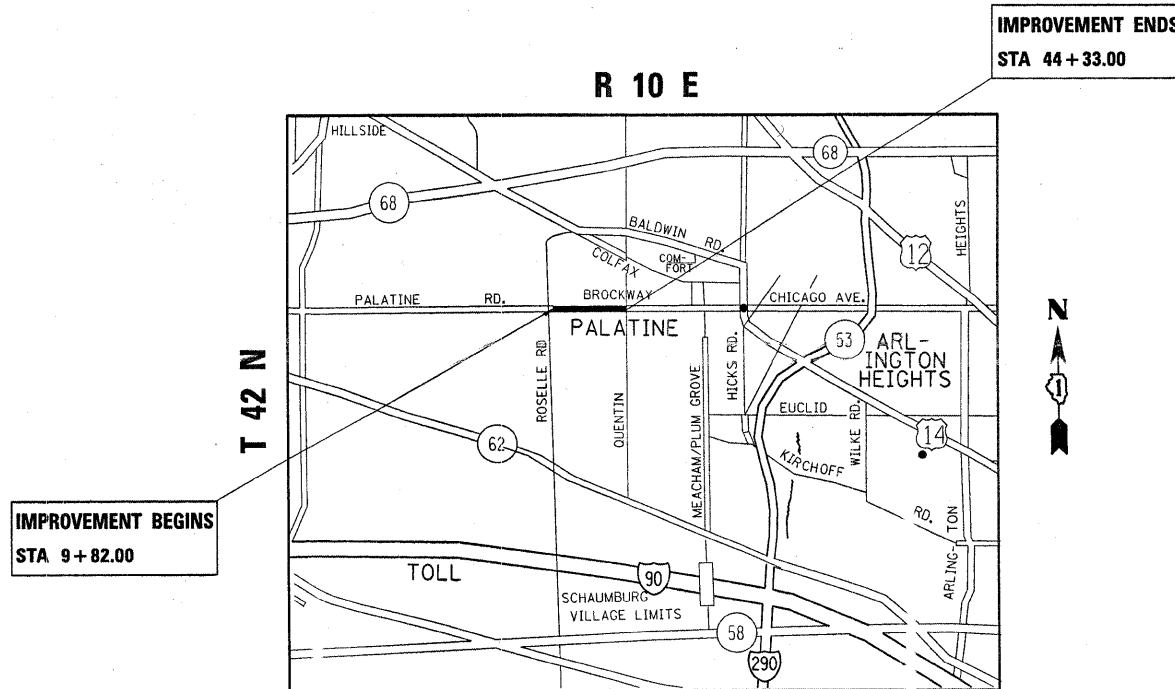

PALATINE TOWNSHIP

GROSS AND NET LENGTH OF IMPROVEMENT = 3451 FT = 0.654 MILE

STATE OF ILLINOIS
DEPARTMENT OF TRANSPORTATION
DIVISION OF HIGHWAYS

SUBMITTED March 22, 2010
Don Okin
DEPUTY DIRECTOR OF HIGHWAYS, REGION ENGINEER

May 7, 2010
Scott E. Stitt P.E./e
ENGINEER OF DESIGN AND ENVIRONMENT

May 7, 2010
Christina M. Reed/e
DIRECTOR OF HIGHWAYS, CHIEF ENGINEER

PRINTED BY THE AUTHORITY
OF THE STATE OF ILLINOIS