

STATE OF ILLINOIS
DEPARTMENT OF TRANSPORTATION

- Notes:
1. See sheet 32 of 68 for Sections C-C & D-D and View E-E.
2. $a_{33}(E)$ and $a_{34}(E)$ bar spacings measured along ϕ Rdwy.
3. Bars indicated thus 20x3-#5 etc. indicates 20 lines of bars with 3 lengths per line.

*** Cost included with Concrete Superstructure.

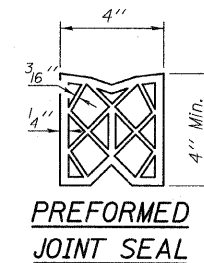
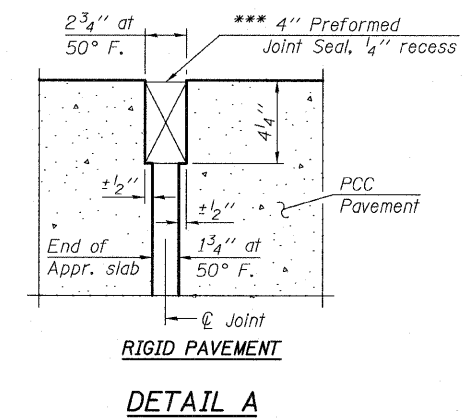

Minimum Bar Laps

- #4 Bar 2'-11"
#5 Bar 3'-3"

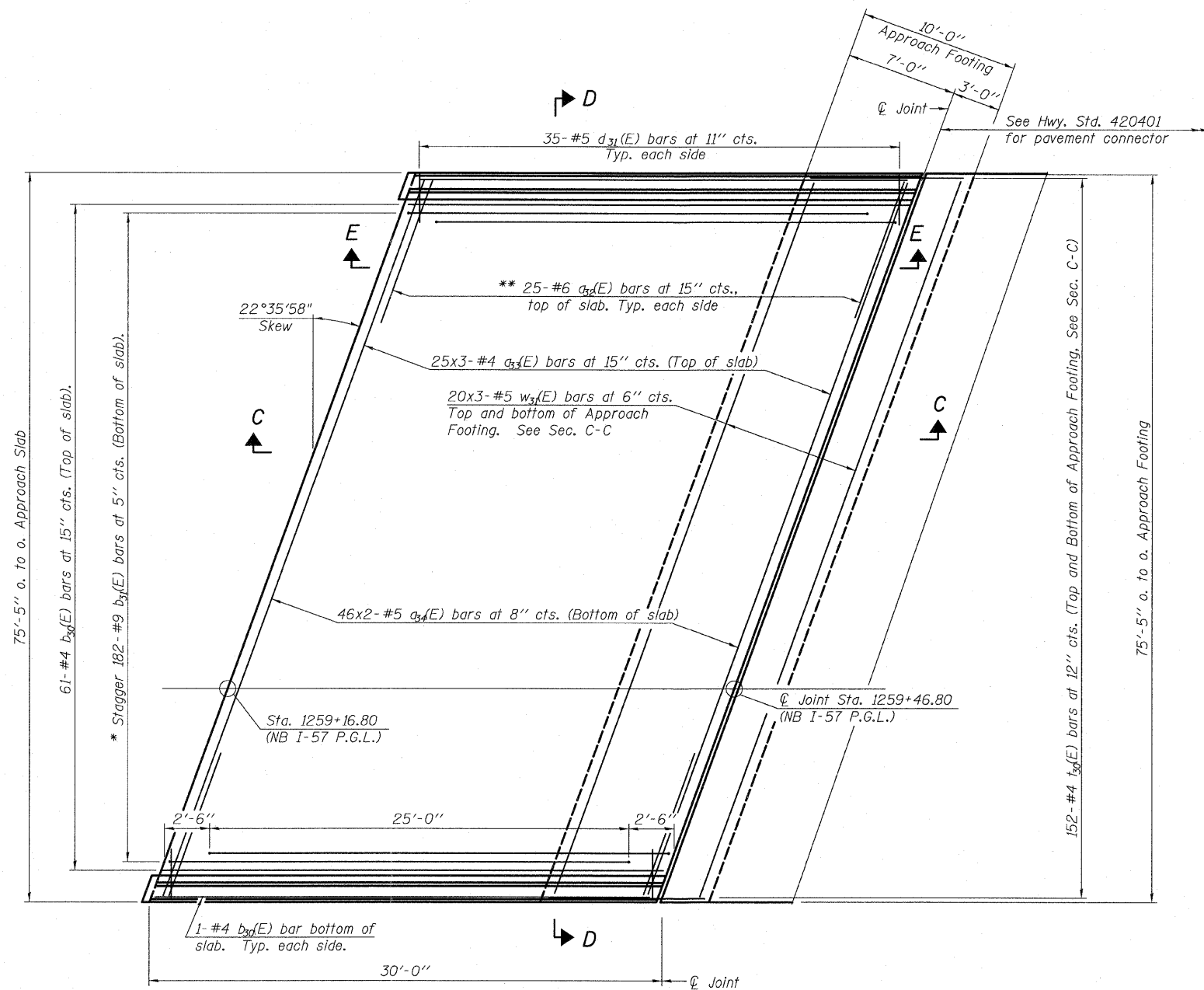

PLAN

- * Tilt #9 $b_{33}(E)$ bars as required to maintain clearance.
** Space between $a_{33}(E)$ bars, typ. each parapet.

**EAST APPROACH SLAB NB I-57 - 1
STRUCTURE NO. 016-1251**

TYLIN INTERNATIONAL	DESIGNED - JMA	REVISIONS		SHEET NO. 31	F.A.I RTE. 57	SECTION 1414.2B	COUNTY COOK	TOTAL SHEETS 516	SHEET NO. 276
	CHECKED - SP,	NAME	DATE						
	DRAWN - JMA								
	CHECKED - SP,PDF								
	DATE - 03/18/10								
				68 SHEETS	CONTRACT NO. 60J27		FED. ROAD DIST. NO. 1 ILLINOIS FED. AID PROJECT		