

DATE	
BY	
FINAL SURVEY	
PLOTTED	
NOTE BOOK	
AREAS CHECKED	
NO.	

DATE	
BY	
ORIGINAL SURVEY	
PLOTTED	
NOTE BOOK	
AREAS CHECKED	
NO.	

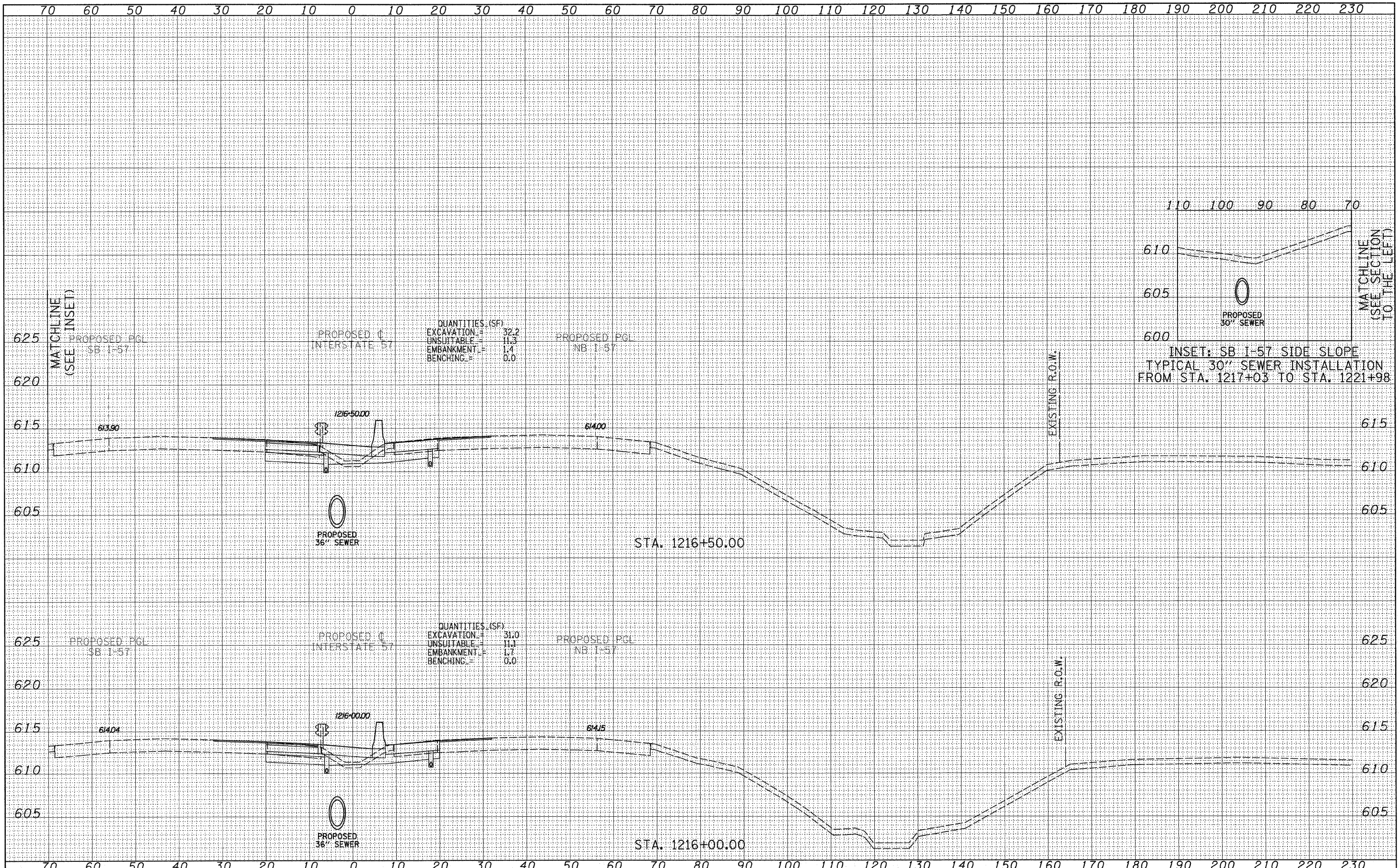

QUANTITIES (SF)
 EXCAVATION = 32.2
 UNSUITABLE = 11.3
 EMBANKMENT = 1.4
 BENCHING = 0.0

QUANTITIES (SF)
 EXCAVATION = 31.0
 UNSUITABLE = 11.1
 EMBANKMENT = 1.7
 BENCHING = 0.0

INSET: SB I-57 SIDE SLOPE
 TYPICAL 30" SEWER INSTALLATION
 FROM STA. 1217+03 TO STA. 1221+98

TYLIN INTERNATIONAL

USER NAME =	DESIGNED - JDF	REVISED -
PLLOT SCALE =	DRAWN - JDF	REVISED -
PLLOT DATE =	CHECKED - JPM	REVISED -
	DATE - 3/18/2010	REVISED -

STATE OF ILLINOIS
 DEPARTMENT OF TRANSPORTATION

I-57 AT I-294 INTERCHANGE PROJECT			
PROPOSED I-57 CROSS SECTIONS			
SCALE: 1" = 10' H	SHEET NO. OF	SHEETS	STA. 1216+00.00 TO STA. 1216+50.00

F.A.I. RTE.	SECTION	COUNTY	TOTAL SHEETS	SHEET NO.
57	1414.2B	COOK	516	453
FED. ROAD DIST. NO.			ILLINOIS FED. AID PROJECT	
			CONTRACT NO. 60J27	