

DATE	
BY	
SURVEYED	
PLotted	
NOTE BOOK	
AREAS CHECKED	
NO.	

DATE	
BY	
SURVEYED	
PLotted	
NOTE BOOK	
AREAS CHECKED	
NO.	

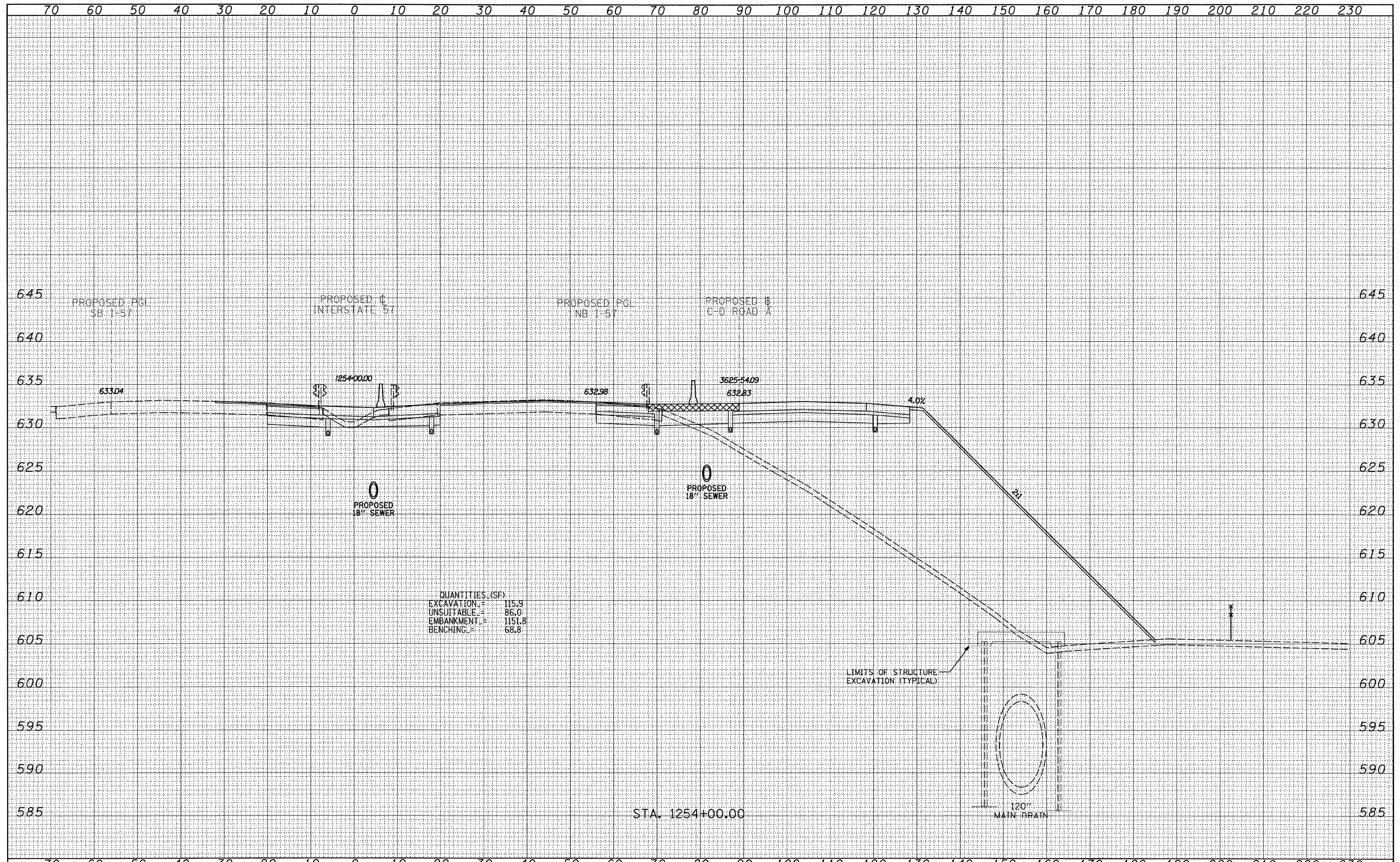

QUANTITIES (SF)

EXCAVATION	=	115.9
UNSUITABLE	=	86.0
EMBANKMENT	=	1151.8
BENCHING	=	68.8

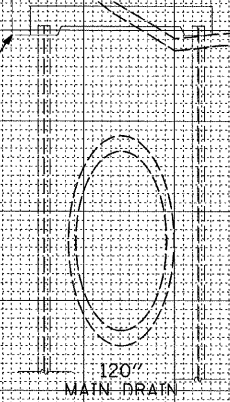

LIMITS OF STRUCTURE
EXCAVATION (TYPICAL)

STA. 1254+00.00

TYLIN INTERNATIONAL USER NAME - PLOT SCALE - PLOT DATE -	DESIGNED - JDF	REVISED - 4/29/2010	STATE OF ILLINOIS DEPARTMENT OF TRANSPORTATION	I-57 AT I-294 INTERCHANGE PROJECT PROPOSED I-57 CROSS SECTIONS		F.A.I. RTE. 57	SECTION 1414.2B	COUNTY COOK	TOTAL SHEETS 516	SHEET NO. 499	
	DRAWN - JDF	REVISED -		SCALE: 1" = 10' H	SHEET NO. OF SHEETS	STA. 1254+00.00 TO STA. 1254+00.00	FED. ROAD DIST. NO.	ILLINOIS	FED. AID PROJECT	CONTRACT NO. 60J27	
	CHECKED - JPM	REVISED -									
	DATE - 3/18/2010	REVISED -									