

FINAL SURVEY	DATE
SURVEYED	BY
PLU ID	
NOTE BOOK	
NO.	
AREAS CHECKED	

ORIGINAL SURVEY	DATE
SURVEYED	BY
PLU ID	
NOTE BOOK	
NO.	
AREAS CHECKED	

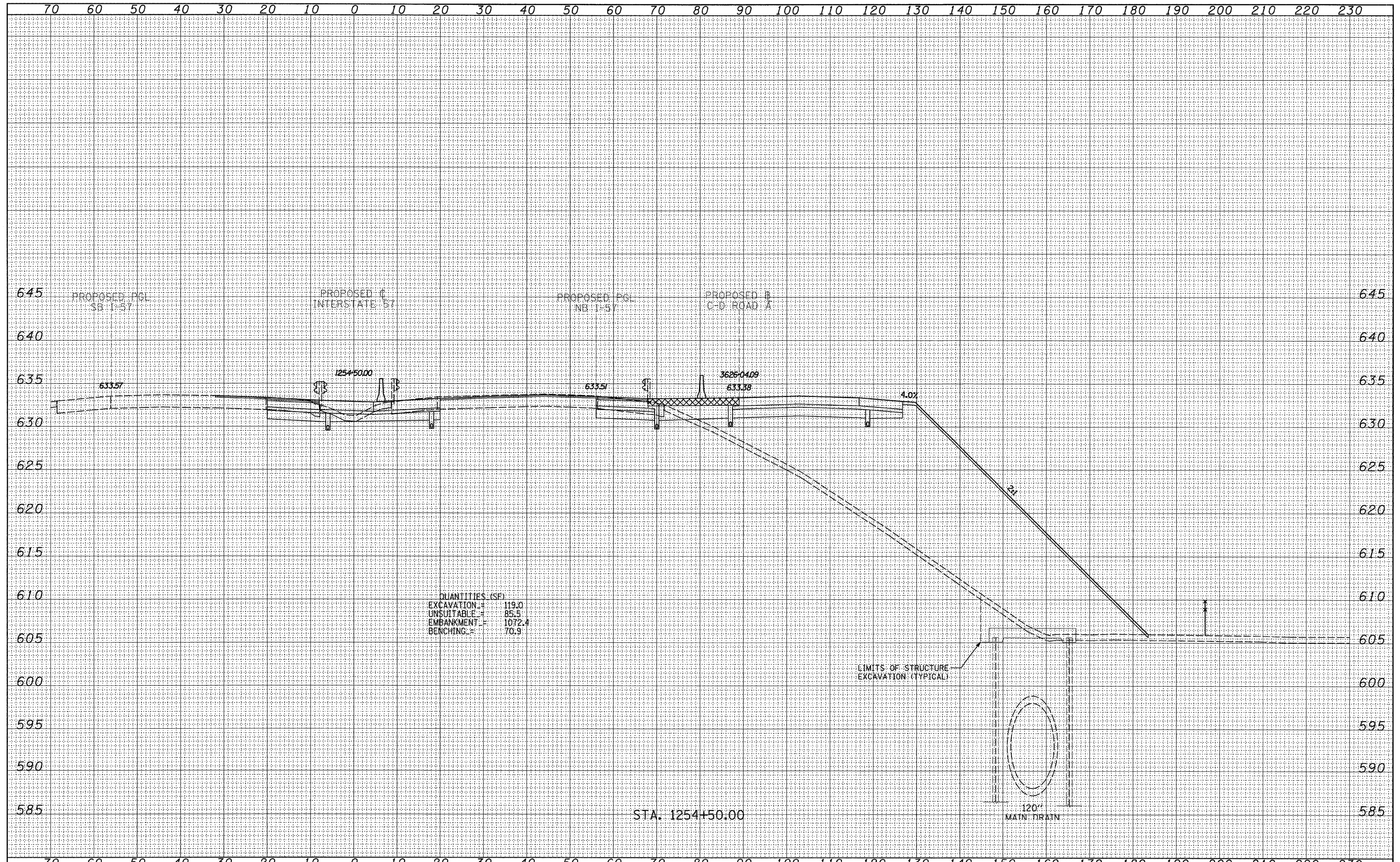

TYLIN INTERNATIONAL	USER NAME =	DESIGNED - JDF	REVISED - 4/29/2010	STATE OF ILLINOIS DEPARTMENT OF TRANSPORTATION	I-57 AT I-294 INTERCHANGE PROJECT		F.A.I. RTE.	SECTION	COUNTY	TOTAL SHEETS	SHEET NO.
	PLOT SCALE =	DRAWN - JDF	REVISED -		57	1414.2B	COOK	516	500		
	PLOT DATE =	CHECKED - JPM	REVISED -		SCALE: 1/4" = 10' H	SHEET NO. OF SHEETS	STA. 1254+50.00 TO STA. 1254+50.00	CONTRACT NO. 60J27			
		DATE - 3/18/2010	REVISED -				FED. ROAD DIST. NO. ILLINOIS FED. AID PROJECT				