

INDEX OF SHEETS

1. COVER SHEET
2. INDEX OF SHEETS, STATE STANDARDS, & GENERAL NOTES
3. SUMMARY OF QUANTITIES
4. TYPICAL SECTIONS
- 5-7. ROADWAY & PAVEMENT MARKING PLANS
8. PAVEMENT PATCHING FOR HMA SURFACED PAVEMENT
9. CURB OR CURB AND GUTTER REMOVAL AND REPLACEMENT
10. BUTT JOINT AND HMA TAPER DETAILS
11. TRAFFIC CONTROL AND PROTECTION FOR SIDE ROADS, INTERSECTIONS, AND DRIVEWAYS
12. TYPICAL APPLICATIONS RAISED REFLECTIVE PAVEMENT MARKERS (SNOW-PLOW RESISTANT)
13. DISTRICT ONE TYPICAL PAVEMENT MARKINGS
14. PAVEMENT MARKING LETTERS AND SYMBOLS FOR TRAFFIC STAGING
15. ARTERIAL ROAD INFORMATION SIGN

STATE STANDARDS

- 000001-05 STANDARD SYMBOLS, ABBREVIATIONS, & PATTERNS
- 442201-03 CLASS C & D PATCHES
- 606001-04 CONCRETE CURB TYPE B AND COMBINATION
CONCRETE CURB AND GUTTER
- 701201-03 LANE CLOSURE, 2L, 2W, DAY ONLY, FOR SPEEDS > 45 MPH
- 701301-03 LANE CLOSURE, 2L, 2W, SHORT TIME OPERATIONS
- 701306-02 LANE CLOSURE, 2L, 2W, SLOW MOVING OPERATIONS DAY ONLY,
FOR SPEEDS > 45 MPH
- 701311-03 LANE CLOSURE, 2L, 2W, MOVING OPERATIONS-DAY ONLY
- 701901-01 TRAFFIC CONTROL DEVICES
- 780001-02 TYPICAL PAVEMENT MARKINGS

GENERAL NOTES

BEFORE STARTING ANY EXCAVATION, THE CONTRACTOR SHALL CALL "JULIE" AT 1-800-892-0123 FOR FIELD LOCATIONS OF BURIED ELECTRIC, TELEPHONE AND GAS FACILITIES. (48 HOUR NOTIFICATION IS REQUIRED)

10' (3M) TRANSITIONS SHALL BE USED TO MATCH PROPOSED CURB & GUTTER AND MEDIAN ITEMS OF WORK TO EXISTING CURB & GUTTERS AND MEDIANS IN THE FIELD, UNLESS OTHERWISE SHOWN. THE TRANSITIONS SHALL BE PAID FOR AT THE CONTRACT UNIT PRICE FOR THE PROPOSED ITEMS OF WORK SPECIFIED.

THE CONTRACTOR SHALL COORDINATE CONSTRUCTION ACTIVITIES WITH UTILITY COMPANIES AND THE VILLAGE OF SHOREWOOD.

CONTRACTOR WILL NOT BE ALLOWED TO SET UP A YARD OR FIELD OFFICE ON STATE PROPERTY WITHOUT WRITTEN PERMISSION FROM THE DEPARTMENT.

WHEN MILLED PAVEMENT IS OPEN TO TRAFFIC, THE MAXIMUM GRADE DIFFERENTIAL BETWEEN PASSES OF THE MILLING MACHINE SHALL NOT EXCEED 1/2" (40 MM) WHERE THE SPEED LIMIT IS 45 MPH (80KM/H) OR LESS AND 1" (25 MM) WHERE THE SPEED LIMIT IS GREATER THAN 45 MPH (80 KM/H). WITH WRITTEN APPROVAL FROM THE ENGINEER, A MAXIMUM GRADE DIFFERENTIAL OF 3" (75MM) MAY BE ALLOWED IF THE EDGE OF THE MILLING IS SLOPED AT A MINIMUM 1:3 (V:H).

BUTT JOINTS WILL BE INSTALLED AT THE ENDS OF ALL RESURFACING (WHERE RESURFACING MEETS EXISTING PAVEMENT) IN ACCORDANCE WITH THE "BUTT JOINT AND HMA TAPER DETAILS" SHEET, WHICH IS INCLUDED IN THE PLANS. UNLESS OTHERWISE SPECIFIED.

THE RESIDENT ENGINEER SHALL CONTACT THE TRAFFIC CONTROL SUPERVISOR AT (815) 705-4470 A MINIMUM OF 72 HOURS PRIOR TO THE PLACEMENT OF ANY TEMPORARY TRAFFIC CONTROL DEVICES.

LOCATIONS OF COMBINATION CONCRETE CURB AND GUTTER REMOVAL AND REPLACEMENT OF THE TYPE SPECIFIED ON THE PLANS, WILL BE DETERMINED IN THE FIELD BY THE ENGINEER.

ALL PAVEMENT PATCHING LOCATIONS WILL BE DETERMINED IN THE FIELD BY THE ENGINEER.

DRAINAGE ADJUSTMENT OR RECONSTRUCTION WILL BE DETERMINED IN HE FIELD BY THE ENGINEER.

THE RESIDENT ENGINEER SHALL CONTACT MS. CORA MATHIS, AREA TRAFFIC FIELD ENGINEER AT (815) 715-8428 AT LEAST 72 HOURS PRIOR TO FINAL PAVEMENT MARKING INSTALLATION.

BEFORE BEGINNING ANY WORK, THE CONTRACTOR SHALL RETAIN AND RECORD FOR FUTURE REFERENCE, ALL EXISTING PAVEMENT MARKING LINES (AND RAISED REFLECTIVE MARKINGS) IN ORDER THAT THESE LOCATIONS CAN BE RE-ESTABLISHED FOR STRIPING. EXACT LOCATIONS OF ALL PAVEMENT MARKINGS SHALL BE AS DIRECTED BY THE ENGINEER.

△ Rev. Sheet 5-27-10

FILE NAME =	USER NAME = qureshiya	DESIGNED -	REVISED -	STATE OF ILLINOIS DEPARTMENT OF TRANSPORTATION	F.A.I. RTE.	SECTION	COUNTY	TOTAL SHEETS	SHEET NO.	
c:\pw_work\pwidot\qureshiya\d0185933\014	310-sht-plan.dgn	DRAWN -	REVISED -		55	99-2AC-3-RS-2	WILL	15	2	
	PLOT SCALE = 50,0000' / IN.	CHECKED -	REVISED -		CONTRACT NO. 60K25					
	PLOT DATE = 5/4/2010	DATE -	REVISED -		ILLINOIS FED. AID PROJECT					
					SCALE:	SHEET NO.	OF	SHEETS	STA.	TO STA.

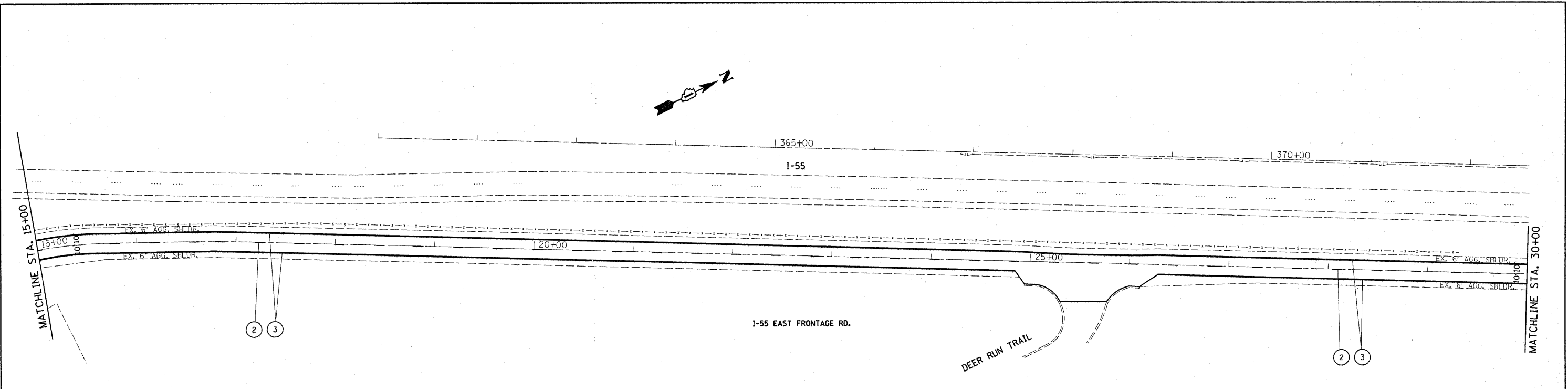

- LEGEND**
- ① THPL PAVT MK LINE, CENTERLINE DOUBLE SOLID YELLOW, 4", 11" C-C
 - ② THPL PAVT MK LINE, CENTERLINE SKIP DASH YELLOW 40'-10', 4"
 - ③ THPL PAVT MK LINE, SOLID WHITE EDGELINE, 4"
 - ④ THPL PAVT MK LINE, SOLID WHITE STOP BAR, 24"
 - ⑤ THPL PAVT MK LINE, SOLID WHITE LANE LINE, 6"
 - ⑥ THPL PAVT MK LINE, SOLID WHITE CROSSWALK, 8' C-C, 6"
 - ⑦ THPL PAVT MK LINE, SOLID WHITE DIAGONAL 45°, 4' C-C, 6"
 - ⑧ THPL PAVT MK LINE, LETTERS & SYMBOLS

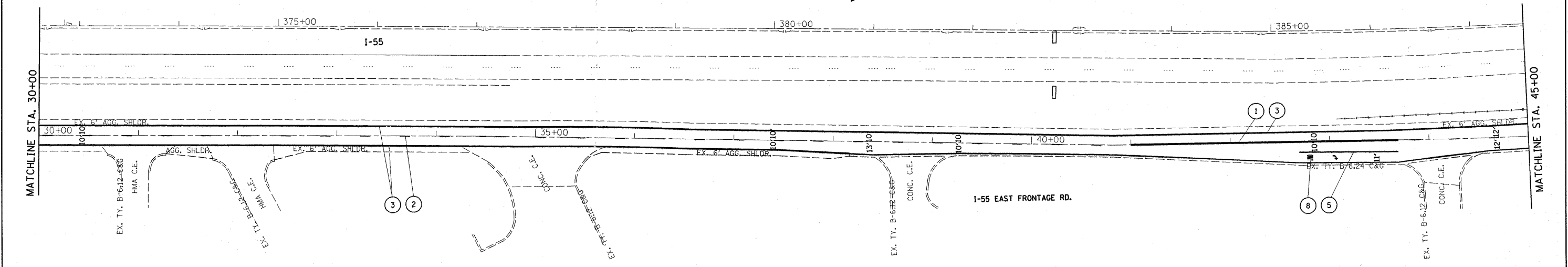

Rev. Sheet 5-27-10

FILE NAME = c:\pwork\pwork\qureshiya\d0185933\0145310-ah-tp-plan.dgn	USER NAME = qureshiya	DESIGNED -	REVISED -	STATE OF ILLINOIS DEPARTMENT OF TRANSPORTATION	I-55 FRONTAGE ROAD U.S. RTE. 52 TO BLACK ROAD		F.A.I. RTE. 55	SECTION 99-2AC-3-RS-2	COUNTY WILL	TOTAL SHEETS 15	SHEET NO. 6
	PLOT SCALE = 50.0000' / IN.	CHECKED -	REVISED -		SCALE:	SHEET NO. OF SHEETS	STA. 15+00 TO STA.	CONTRACT NO. 60K25 [ILLINOIS] FED. AID PROJECT			
PLOT DATE = 5/4/2010	DATE -	REVISED -	REVISED -								