

STATE OF ILLINOIS
DEPARTMENT OF TRANSPORTATION
DIVISION OF HIGHWAYS

PROPOSED
HIGHWAY PLANS

F.A.I. ROUTE 55 / I-55 E FRONTAGE RD. (NB)

US 52 TO BLACK RD.

SECTION: 99-2AC-3-RS-2

RESURFACING (3P)

WILL COUNTY

C-91-453-10

F.A.I. RTE.	SECTION	COUNTY	TOTAL SHEETS	SHEET NO.
55	99-2AC-3-RS-2	WILL	15	1
		ILLINOIS	CONTRACT NO. 60K25	

D-91-453-10

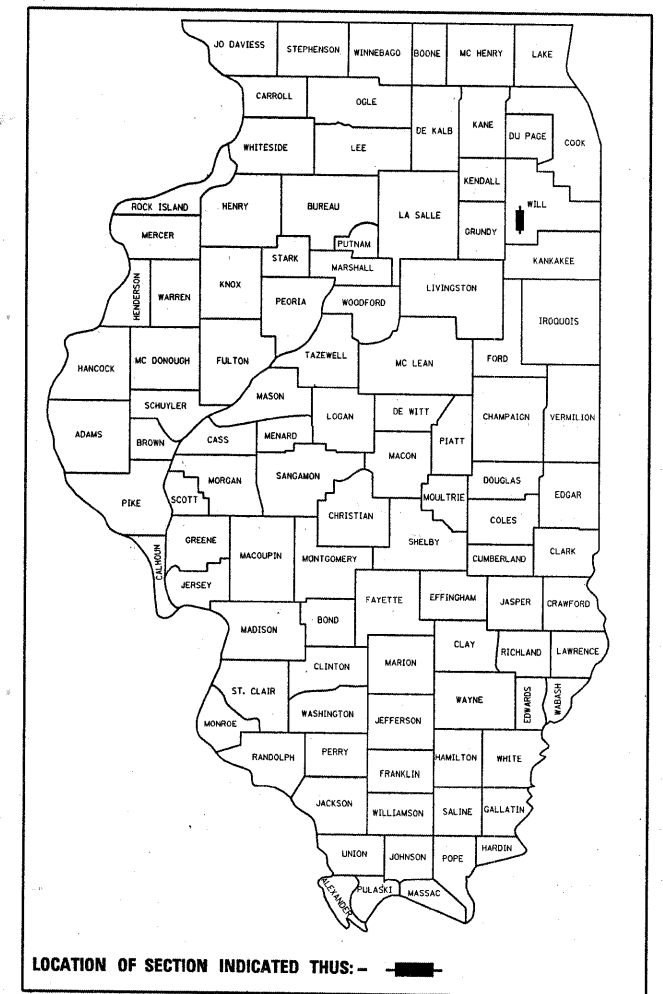

FOR INDEX OF SHEETS, SEE SHEET NO. 2

IMPROVEMENT IS LOCATED IN THE VILLAGE OF SHOREWOOD

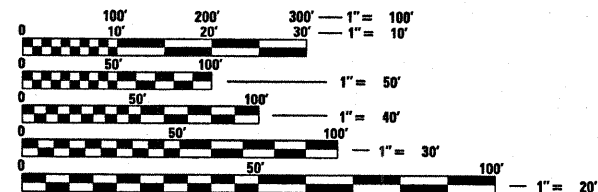

FULL SIZE PLANS HAVE BEEN PREPARED USING STANDARD ENGINEERING SCALES. REDUCED SIZED PLANS WILL NOT CONFORM TO STANDARD SCALES. IN MAKING MEASUREMENTS ON REDUCED PLANS, THE ABOVE SCALES MAY BE USED.

J.U.L.I.E.
JOINT UTILITY LOCATION INFORMATION FOR EXCAVATION
1-800-892-0123
OR 811

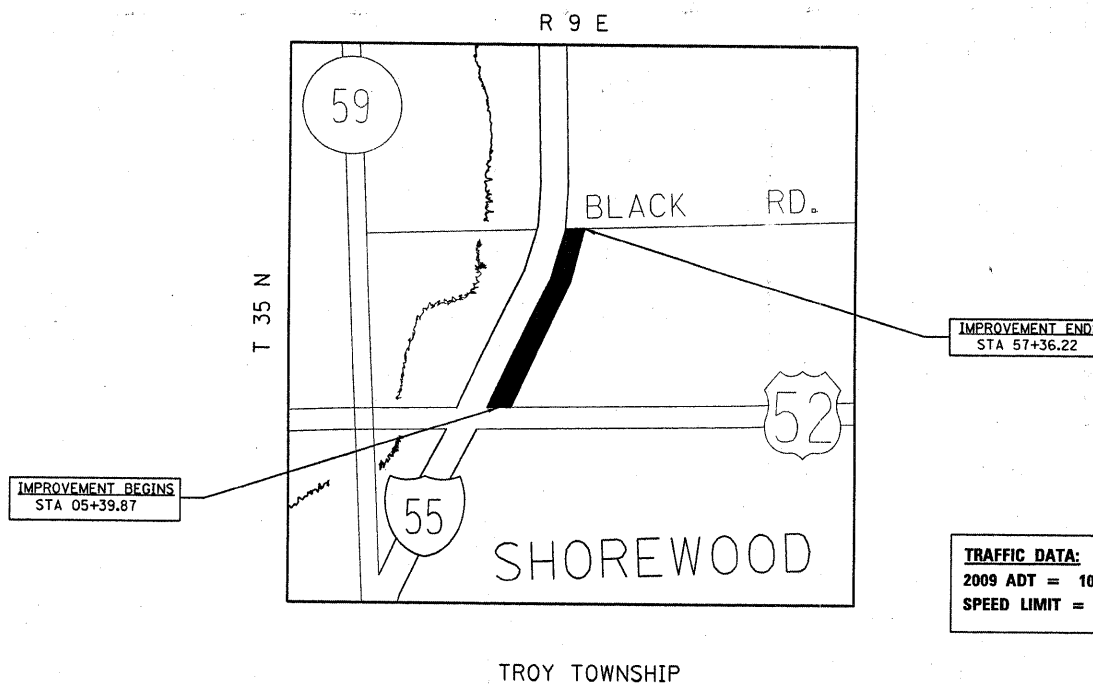

PROJECT ENGINEER: J.P. CHANG (847) 705-4432
PROJECT MANAGER: KEN ENG

CONTRACT NO. 60K25

GROSS AND NET LENGTH OF IMPROVEMENT = 5,196.35 FT. = 0.98 MILE

STATE OF ILLINOIS
DEPARTMENT OF TRANSPORTATION
DIVISION OF HIGHWAYS

SUBMITTED MARCH 25, 2010

Diana M. O'Keefe DEPUTY DIRECTOR OF HIGHWAYS, REGION ENGINEER

May 7, 2010
Scott E. Stitt, P.E. ENGINEER OF DESIGN AND ENVIRONMENT

May 7, 2010
Christine M. Reed DIRECTOR OF HIGHWAYS, CHIEF ENGINEER

PRINTED BY THE AUTHORITY
OF THE STATE OF ILLINOIS

INDEX OF SHEETS

1. COVER SHEET
2. INDEX OF SHEETS, STATE STANDARDS, & GENERAL NOTES
3. SUMMARY OF QUANTITIES
4. TYPICAL SECTIONS
- 5-7. ROADWAY & PAVEMENT MARKING PLANS
8. PAVEMENT PATCHING FOR HMA SURFACED PAVEMENT
9. CURB OR CURB AND GUTTER REMOVAL AND REPLACEMENT
10. BUTT JOINT AND HMA TAPER DETAILS
11. TRAFFIC CONTROL AND PROTECTION FOR SIDE ROADS, INTERSECTIONS, AND DRIVEWAYS
12. TYPICAL APPLICATIONS RAISED REFLECTIVE PAVEMENT MARKERS (SNOW-PLOW RESISTANT)
13. DISTRICT ONE TYPICAL PAVEMENT MARKINGS
14. PAVEMENT MARKING LETTERS AND SYMBOLS FOR TRAFFIC STAGING
15. ARTERIAL ROAD INFORMATION SIGN

STATE STANDARDS

- 000001-05 STANDARD SYMBOLS, ABBREVIATIONS, & PATTERNS
- 442201-03 CLASS C & D PATCHES
- 606001-04 CONCRETE CURB TYPE B AND COMBINATION
CONCRETE CURB AND GUTTER
- 701201-03 LANE CLOSURE, 2L, 2W, DAY ONLY, FOR SPEEDS > 45 MPH
- 701301-03 LANE CLOSURE, 2L, 2W, SHORT TIME OPERATIONS
- 701306-02 LANE CLOSURE, 2L, 2W, SLOW MOVING OPERATIONS DAY ONLY,
FOR SPEEDS > 45 MPH
- 701311-03 LANE CLOSURE, 2L, 2W, MOVING OPERATIONS-DAY ONLY
- 701901-01 TRAFFIC CONTROL DEVICES
- 780001-02 TYPICAL PAVEMENT MARKINGS

GENERAL NOTES

BEFORE STARTING ANY EXCAVATION, THE CONTRACTOR SHALL CALL "JULIE" AT 1-800-892-0123 FOR FIELD LOCATIONS OF BURIED ELECTRIC, TELEPHONE AND GAS FACILITIES. (48 HOUR NOTIFICATION IS REQUIRED)

10' (3M) TRANSITIONS SHALL BE USED TO MATCH PROPOSED CURB & GUTTER AND MEDIAN ITEMS OF WORK TO EXISTING CURB & GUTTERS AND MEDIANS IN THE FIELD, UNLESS OTHERWISE SHOWN. THE TRANSITIONS SHALL BE PAID FOR AT THE CONTRACT UNIT PRICE FOR THE PROPOSED ITEMS OF WORK SPECIFIED.

THE CONTRACTOR SHALL COORDINATE CONSTRUCTION ACTIVITIES WITH UTILITY COMPANIES AND THE VILLAGE OF SHOREWOOD.

CONTRACTOR WILL NOT BE ALLOWED TO SET UP A YARD OR FIELD OFFICE ON STATE PROPERTY WITHOUT WRITTEN PERMISSION FROM THE DEPARTMENT.

WHEN MILLED PAVEMENT IS OPEN TO TRAFFIC, THE MAXIMUM GRADE DIFFERENTIAL BETWEEN PASSES OF THE MILLING MACHINE SHALL NOT EXCEED 1/2" (40 MM) WHERE THE SPEED LIMIT IS 45 MPH (80KM/H) OR LESS AND 1" (25 MM) WHERE THE SPEED LIMIT IS GREATER THAN 45 MPH (80 KM/H). WITH WRITTEN APPROVAL FROM THE ENGINEER, A MAXIMUM GRADE DIFFERENTIAL OF 3" (75MM) MAY BE ALLOWED IF THE EDGE OF THE MILLING IS SLOPED AT A MINIMUM 1:3 (V:H).

BUTT JOINTS WILL BE INSTALLED AT THE ENDS OF ALL RESURFACING (WHERE RESURFACING MEETS EXISTING PAVEMENT) IN ACCORDANCE WITH THE "BUTT JOINT AND HMA TAPER DETAILS" SHEET, WHICH IS INCLUDED IN THE PLANS. UNLESS OTHERWISE SPECIFIED.

THE RESIDENT ENGINEER SHALL CONTACT CORA MATHIS, THE TRAFFIC CONTROL SUPERVISOR AT (815) 485-6475 A MINIMUM OF 72 HOURS PRIOR TO THE PLACEMENT OF ANY TEMPORARY TRAFFIC CONTROL DEVICES.

LOCATIONS OF COMBINATION CONCRETE CURB AND GUTTER REMOVAL AND REPLACEMENT OF THE TYPE SPECIFIED ON THE PLANS, WILL BE DETERMINED IN THE FIELD BY THE ENGINEER.

ALL PAVEMENT PATCHING LOCATIONS WILL BE DETERMINED IN THE FIELD BY THE ENGINEER.

DRAINAGE ADJUSTMENT OR RECONSTRUCTION WILL BE DETERMINED IN HE FIELD BY THE ENGINEER.

FILE NAME =	USER NAME = mosse	DESIGNED -	REVISED -	STATE OF ILLINOIS DEPARTMENT OF TRANSPORTATION	SCALE:	SHEET NO. OF SHEETS STA. TO STA.	F.A.I. RTE.	SECTION	COUNTY	TOTAL SHEETS	SHEET NO.
ca:\pwork\PWIDOT\MOSSE\0185933\014530-sht-plan.dgn	DRAWN -	REVISED -	55				99-2AC-3-RS-2	WILL	15	2	
PLOT SCALE = 50,0000' / IN.	CHECKED -	REVISED -	CONTRACT NO. 60K25								
PLOT DATE = 3/25/2010	DATE -	REVISED -	ILLINOIS FED. AID PROJECT								

SUMMARY OF QUANTITIES			CONSTRUCTION TYPE CODE						SUMMARY OF QUANTITIES			CONSTRUCTION TYPE CODE							
CODE NO	ITEM	UNIT	URBAN 100% STATE TOTAL QUANTITIES	1000						CODE NO	ITEM	UNIT	URBAN 100% STATE TOTAL QUANTITIES	1000					
20201006	GRADING AND SHAPING SHOULDERS	UNIT	107	107						*78100100	RAISED REFLECTIVE PAVEMENT MARKER	EACH	135	135					
21101615	TOPSOIL FURNISH AND PLACE, 4"	SO YD	32	32						X0322256	TEMPORARY INFORMATION SIGNING	SO FT	52	52					
25200110	SODDING, SALT TOLERANT	SO YD	32	32						Z0018500	DRAINAGE STRUCTURES TO BE CLEANED	EACH	5	5					
40600200	BITUMINOUS MATERIALS (PRIME COAT)	TON	10	10															
40600300	AGGREGATE (PRIME COAT)	TON	51	51															
40600400	MIXTURE FOR CRACKS, JOINTS, AND FLANGWAYS	TON	19	19															
40600826	POLYMERIZED LEVELING BINDER (MACHINE METHOD), IL-4, 75, N50	TON	500	500															
40600895	CONSTRUCTING TEST STRIP	EACH	1	1															
40600982	HOT-MIX ASPHALT SURFACE REMOVAL - BUTT JOINT	SO YD	46	46															
40603340	HOT-MIX ASPHALT SURFACE COURSE, MIX "D", N70	TON	1065	1065															
42001300	PROTECTIVE COAT	SO YD	63	63															
44000158	HOT-MIX ASPHALT SURFACE REMOVAL, 2 1/4"	SO YD	12350	12350															
44001700	COMBINATION CONCRETE CURB AND GUTTER REMOVAL AND REPLACEMENT	FOOT	185	185															
44201705	CLASS D PATCHES, TYPE II, 5 INCH	SO YD	278	278															
44201709	CLASS D PATCHES, TYPE III, 5 INCH	SO YD	247	247															
44201711	CLASS D PATCHES, TYPE IV, 5 INCH	SO YD	93	93															
48102100	AGGREGATE WEDGE SHOULDER, TYPE B	TON	212	212															
67000400	ENGINEER'S FIELD OFFICE, TYPE A	CAL MO	6	6															
67100100	MOBILIZATION	L SUM	1	1															
70100450	TRAFFIC CONTROL AND PROTECTION, STANDARD 701201	L SUM	1	1															
70100460	TRAFFIC CONTROL AND PROTECTION, STANDARD 701306	L SUM	1	1															
70300100	SHORT-TERM PAVEMENT MARKING	FOOT	34500	34500															
70300210	TEMPORARY PAVEMENT MARKING - LETTERS AND SYMBOLS	SO FT	37	37															
70300220	TEMPORARY PAVEMENT MARKING - LINE 4"	FOOT	5780	5780															
70300240	TEMPORARY PAVEMENT MARKING - LINE 6"	FOOT	105	105															
70301000	WORK ZONE PAVEMENT MARKING REMOVAL	SO FT	11500	11500															
*78000100	THERMOPLASTIC PAVEMENT MARKING - LETTERS AND SYMBOLS	SO FT	37	37															
*78000200	THERMOPLASTIC PAVEMENT MARKING - LINE 4"	FOOT	5780	5780															
*78000400	THERMOPLASTIC PAVEMENT MARKING - LINE 6"	FOOT	105	105															

* SPECIALTY ITEMS

EXISTING TYPICAL CROSS SECTION

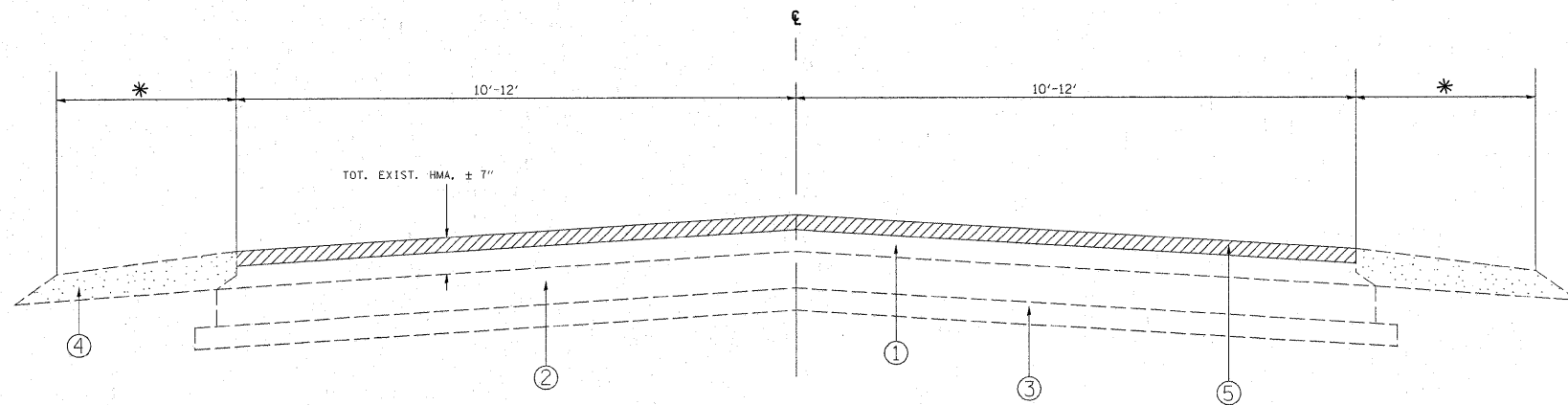

LEGEND

- ① EXISTING HMA SURFACE COURSE ± 4 3/4" (AFTER MILLING)
- ② EXISTING COMPACTED GRAVEL/CRUSHED STONE BASE COURSE, (± 7")
- ③ EXISTING SUB-BASE GRANULAR MATERIAL, (± 4")
- ④ EXISTING AGGREGATE SHOULDERS
- ⑤ PROPOSED HMA SURFACE REMOVAL, 2 1/4"
- ⑥ PROPOSED POLYMERIZED LEVELING BINDER (MM), IL-4.75, N50, 3/4"
- ⑦ PROPOSED HMA SURFACE COURSE, MIX "D", N70, (1 1/2")
- ⑧ PROPOSED AGGREGATE WEDGE SHOULDERS, TYPE B
- ⑨ PROPOSED GRADING & SHAPING SHOULDERS

REMOVAL ITEM

* WIDTHS OF HMA AND AGGREGATE SHOULDERS MAY VARY

PROPOSED TYPICAL CROSS SECTION

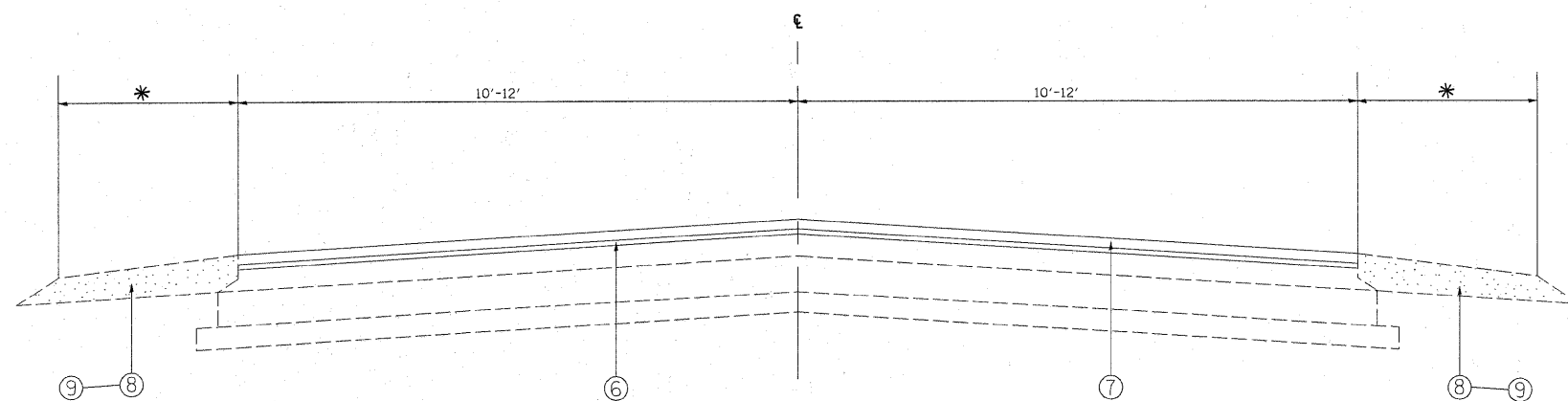

HMA MIXTURE REQUIREMENTS

MIXTURE USES	% VOIDS @ Ndes
HMA SURFACE COURSE, MIX "D", N70 (IL 9.5 mm)	4% @ 70 GYR.
POLY. LEVELING BINDER (MM), IL-4.75, N50	4% @ 50 GYR.
CLASS D PATCHES (HMA BINDER IL-19 mm)	4% @ 70 GYR.

- THE UNIT WEIGHT USED TO CALCULATE ALL HMA SURFACE MIXTURES IS 112 LBS/SQ YD/IN
- THE "AC TYPE" FOR POLYMERIZED HMA MIXES SHALL BE "SBS/SBR PG 70 -22" AND FOR NON-POLYMERIZED HMA THE "AC TYPE" SHALL BE "PG 64-22" UNLESS MODIFIED BY DISTRICT ONE SPECIAL PROVISIONS. FOR "PERCENT OF RAP" SEE DISTRICT ONE SPECIAL PROVISIONS.

NOTE:

THE CONTRACTOR SHALL MILL FIRST BEFORE PATCHING

CURB & GUTTER IS PRESENT FROM: STA 12+59.75 TO STA 14+34.4

FILE NAME =	USER NAME = mosse	DESIGNED -	REVISED -	STATE OF ILLINOIS DEPARTMENT OF TRANSPORTATION	TYPICAL SECTIONS		F.A.I. RTE.	SECTION	COUNTY	TOTAL SHEETS	SHEET NO.		
ct:\pwork\FWIDOT\MOSSE\j0185933\145310-shit-plan.dgn	DRAWN -	REVISED -	REVISED -		SCALE:	SHEET NO. 1 OF 1 SHEETS	STA.	TO STA.	55	99-2AC-3-RS-2	WILL	15	4
PLOT SCALE = 50.0000 ' / IN.	CHECKED -	REVISED -	REVISED -		CONTRACT NO. 60K25								
PLOT DATE = 3/25/2010	DATE -	REVISED -	REVISED -		FED. ROAD DIST. NO. ILLINOIS FED. AID PROJECT								

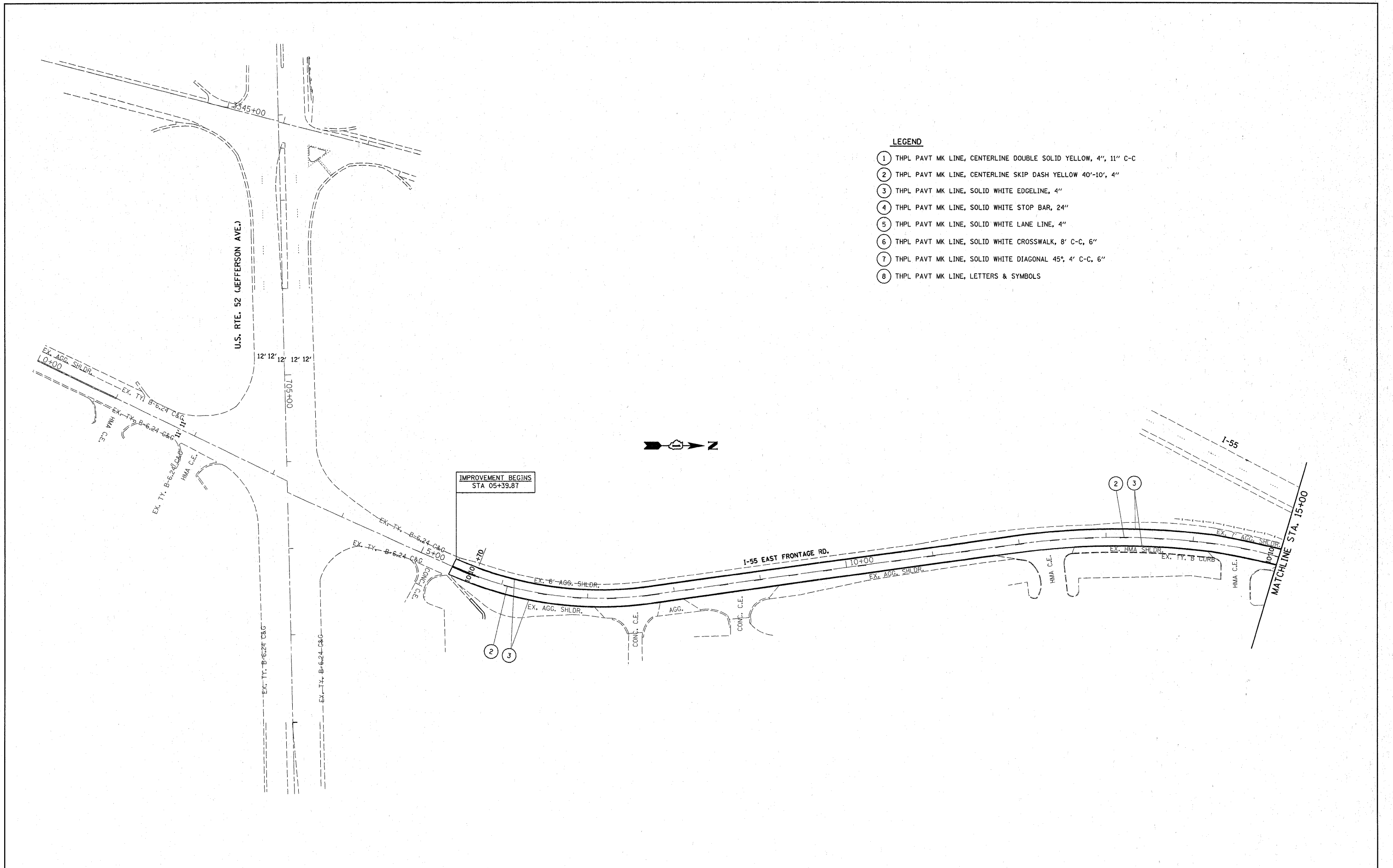

LEGEND

- ① THPL PAVT MK LINE, CENTERLINE DOUBLE SOLID YELLOW, 4", 11" C-C
- ② THPL PAVT MK LINE, CENTERLINE SKIP DASH YELLOW 40'-10', 4"
- ③ THPL PAVT MK LINE, SOLID WHITE EDGELINE, 4"
- ④ THPL PAVT MK LINE, SOLID WHITE STOP BAR, 24"
- ⑤ THPL PAVT MK LINE, SOLID WHITE LANE LINE, 4"
- ⑥ THPL PAVT MK LINE, SOLID WHITE CROSSWALK, 8' C-C, 6"
- ⑦ THPL PAVT MK LINE, SOLID WHITE DIAGONAL 45°, 4' C-C, 6"
- ⑧ THPL PAVT MK LINE, LETTERS & SYMBOLS

FILE NAME =	USER NAME = mossse	DESIGNED -	REVISED -	STATE OF ILLINOIS DEPARTMENT OF TRANSPORTATION	I-55 FRONTAGE ROAD U.S. RTE. 52 TO BLACK ROAD				F.A.I RTE.	SECTION	COUNTY	TOTAL SHEETS	SHEET NO.
ci:\pw\work\PWIDOT\MOSSSE\d0185933\014530-sht-plan.dgn	0-sht-plan.dgn	DRAWN -	REVISED -		55	99-2AC-3-RS-2	WILL.	15	5				
PLOT SCALE = 50.0000' / IN.		CHECKED -	REVISED -		CONTRACT NO. 60K25								
PLOT DATE = 3/25/2010		DATE -	REVISED -		ILLINOIS FED. AID PROJECT								
				SCALE:	SHEET NO.	OF	SHEETS	STA. 0+00	TO STA. 15+00				

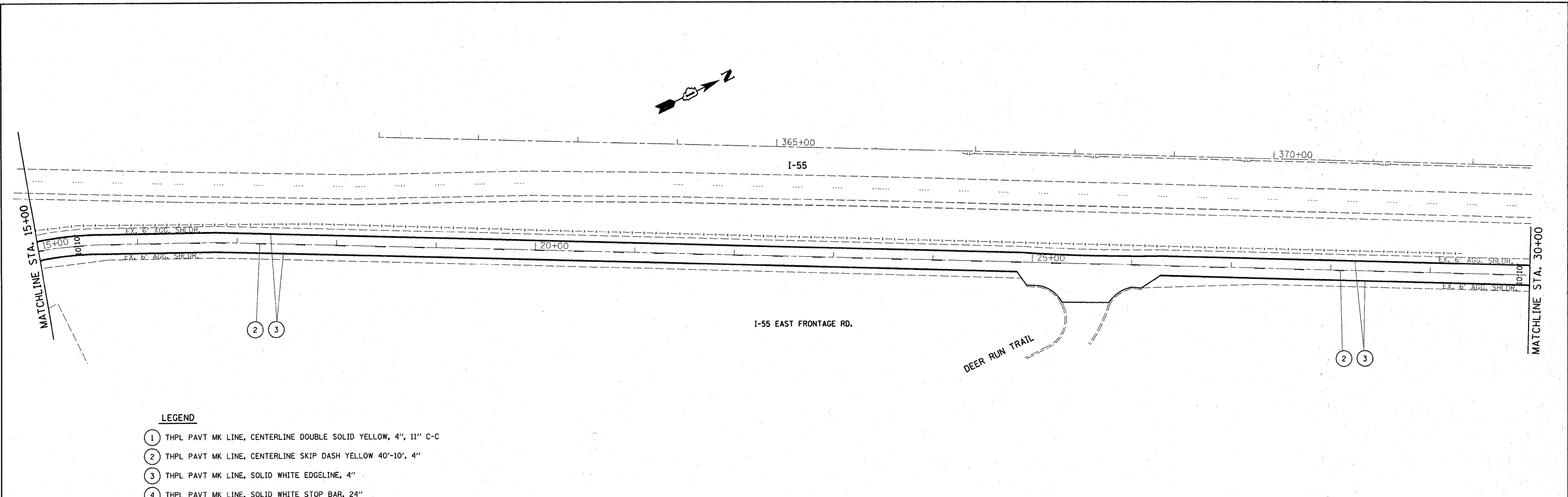

LEGEND

- ① THPL PAVT MK LINE, CENTERLINE DOUBLE SOLID YELLOW, 4", 11" C-C
- ② THPL PAVT MK LINE, CENTERLINE SKIP DASH YELLOW 40'-10', 4"
- ③ THPL PAVT MK LINE, SOLID WHITE EDGELINE, 4"
- ④ THPL PAVT MK LINE, SOLID WHITE STOP BAR, 24"
- ⑤ THPL PAVT MK LINE, SOLID WHITE LANE LINE, 4"
- ⑥ THPL PAVT MK LINE, SOLID WHITE CROSSWALK, 8' C-C, 6"
- ⑦ THPL PAVT MK LINE, SOLID WHITE DIAGONAL 45°, 4' C-C, 6"
- ⑧ THPL PAVT MK LINE, LETTERS & SYMBOLS

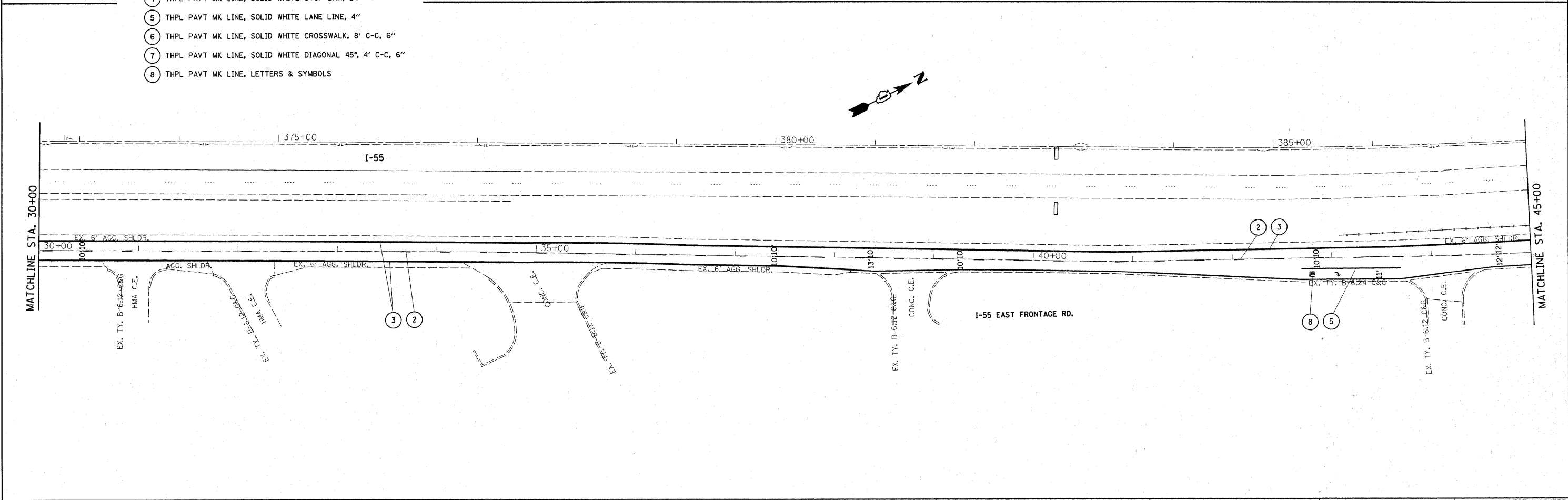

FILE NAME = c:\pwwork\p\1007\MOSSSE\0185933\0145330-sh1-plan.dgn	USER NAME = mossse	DESIGNED -	REVISED -	STATE OF ILLINOIS DEPARTMENT OF TRANSPORTATION	I-55 FRONTAGE ROAD U.S. RTE. 52 TO BLACK ROAD			F.A.I. RTE. 55	SECTION 99-2AC-3-RS-2	COUNTY WILL	TOTAL SHEETS 15	SHEET NO. 6	
	PLOT SCALE = 60.0000' / IN.	CHECKED -	REVISED -		SCALE:	SHEET NO. OF SHEETS	STA. 15+00 TO STA.	CONTRACT NO. 60K25					
	PLOT DATE = 3/25/2010	DATE -	REVISED -		ILLINOIS FED. AID PROJECT								

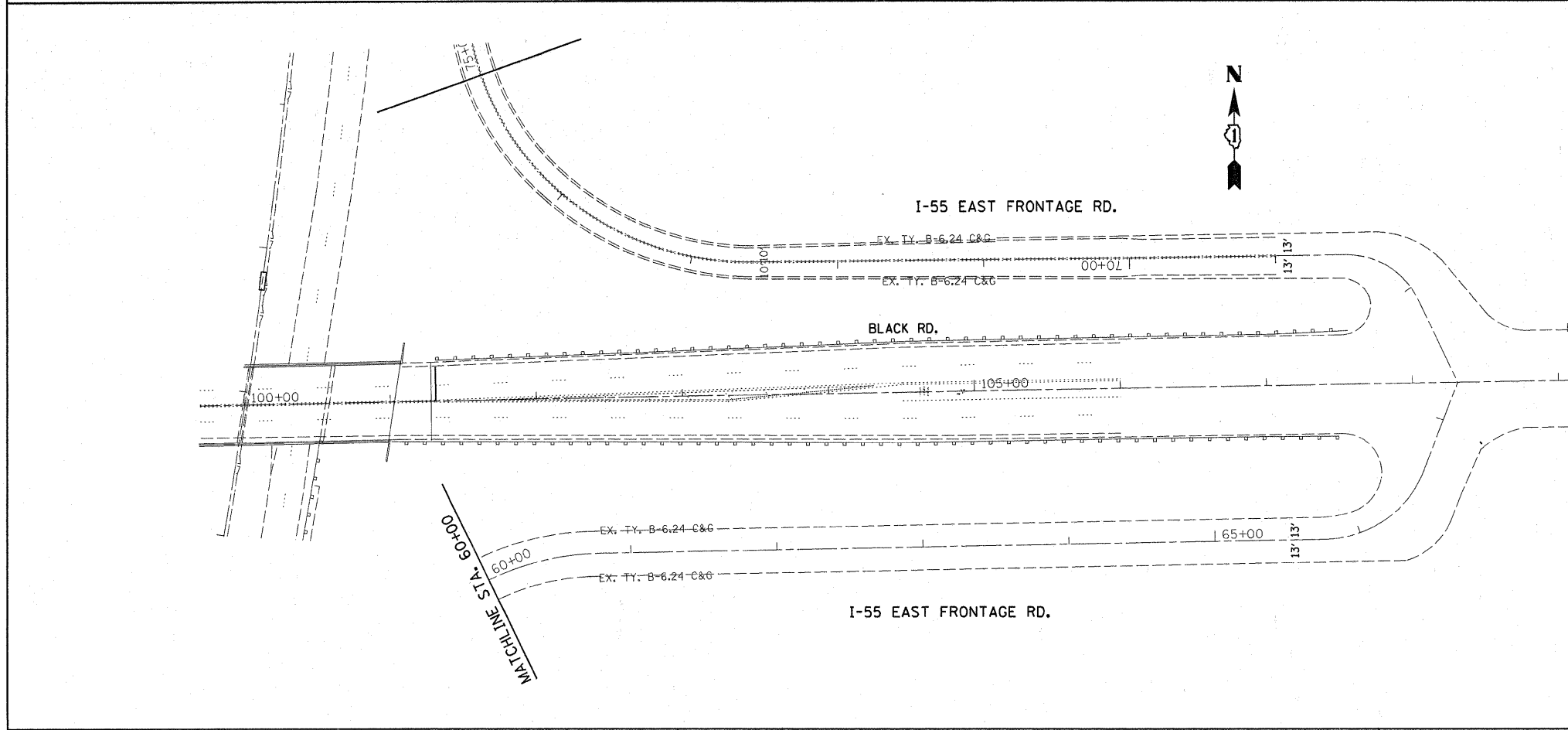
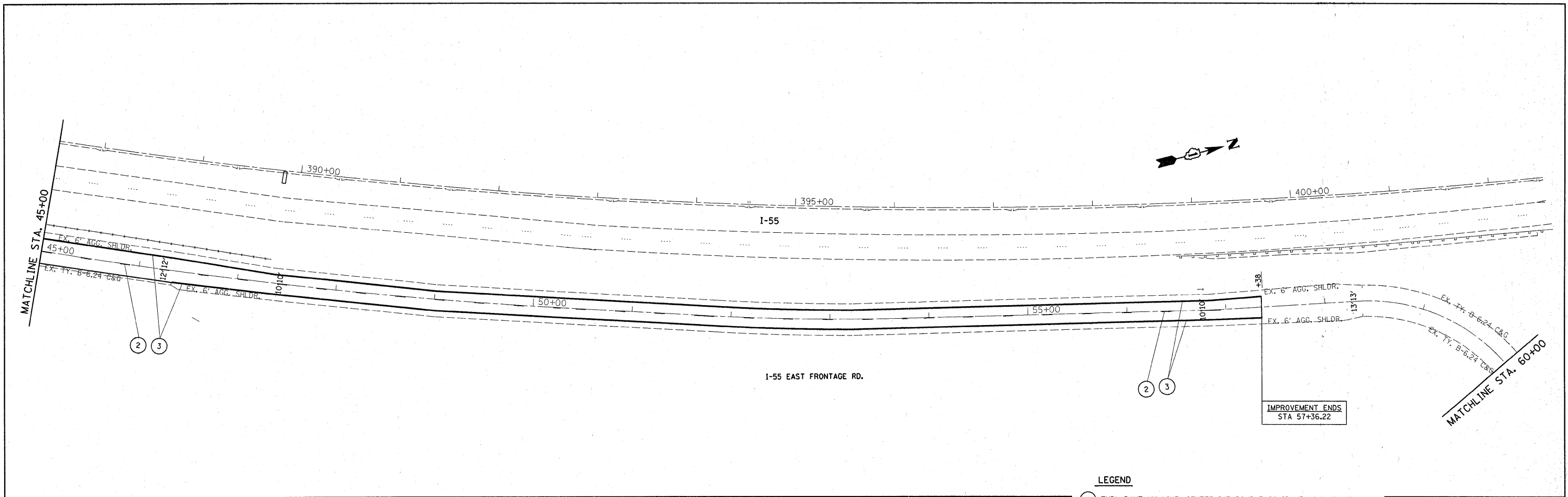

- LEGEND**
- ① THPL PAVT MK LINE, CENTERLINE DOUBLE SOLID YELLOW, 4", 11" C-C
 - ② THPL PAVT MK LINE, CENTERLINE SKIP DASH YELLOW 40'-10', 4"
 - ③ THPL PAVT MK LINE, SOLID WHITE EDGELINE, 4"
 - ④ THPL PAVT MK LINE, SOLID WHITE STOP BAR, 24"
 - ⑤ THPL PAVT MK LINE, SOLID WHITE LANE LINE, 4"
 - ⑥ THPL PAVT MK LINE, SOLID WHITE CROSSWALK, 8' C-C, 6"
 - ⑦ THPL PAVT MK LINE, SOLID WHITE DIAGONAL 45°, 4' C-C, 6"
 - ⑧ THPL PAVT MK LINE, LETTERS & SYMBOLS

FILE NAME =
 c:\pwork\pwi001\MOSSSE\00185933\014530-sh-t-plen.dgn

USER NAME = mossse
 DESIGNED -
 DRAWN -
 CHECKED -
 DATE = 3/25/2010

REVIS
 REVISE
 REVISE
 REVISE

REVIS
 REVISE
 REVISE
 REVISE

**STATE OF ILLINOIS
 DEPARTMENT OF TRANSPORTATION**

**I-55 FRONTAGE ROAD
 U.S. RTE. 52 TO BLACK ROAD**

SCALE: SHEET NO. OF SHEETS STA. TO STA.

F.A.I. RTE.	SECTION	COUNTY	TOTAL SHEETS	SHEET NO.
55	99-2AC-3-RS-2	WILL	15	7
CONTRACT NO. 60K25				
ILLINOIS FED. AID PROJECT				

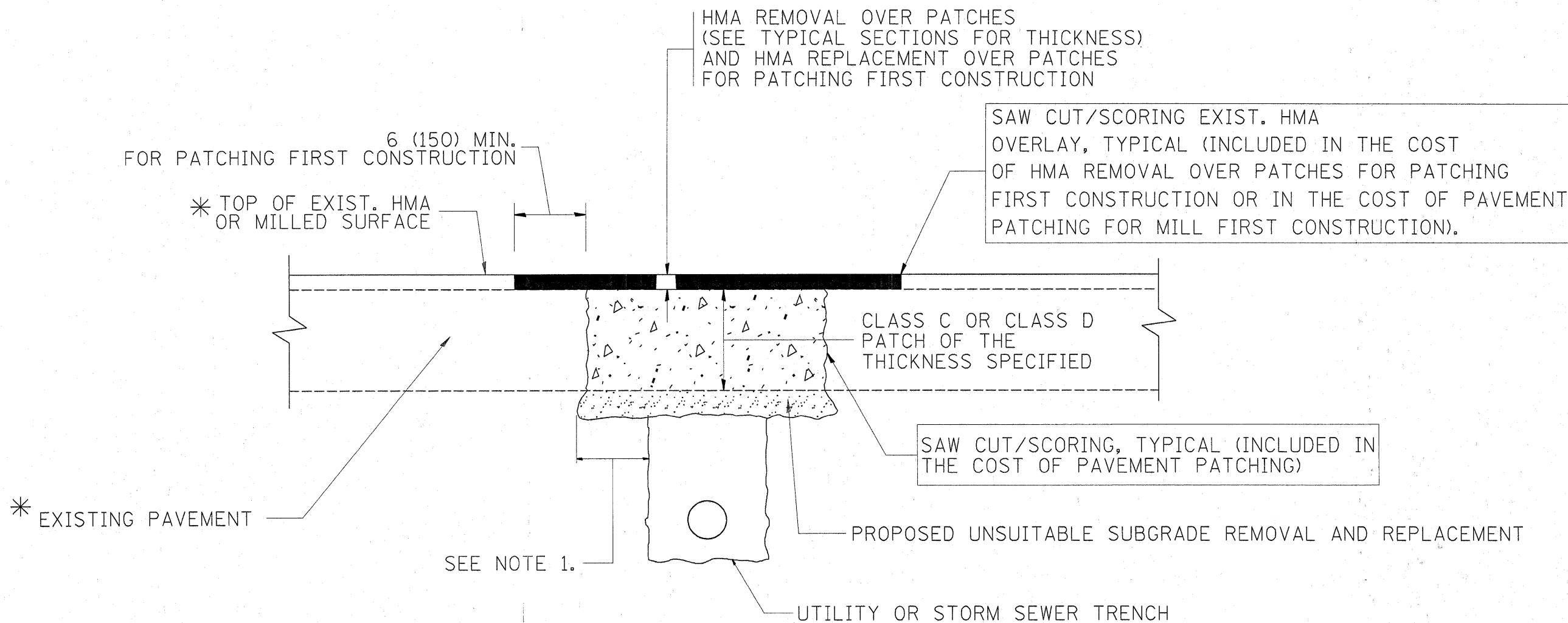

* SEE TYPICAL SECTIONS FOR THICKNESS AND MATERIALS

NOTES:

1. THE WIDTH OF THE FULL DEPTH PATCH OVER A TRENCH SHALL BE 12 (300) WIDER ON EACH SIDE OF THE TRENCH.
2. FOR METHOD OF MEASUREMENT AND BASIS OF PAYMENT, SEE RECURRING SPECIAL PROVISION "PATCHING WITH HOT-MIX ASPHALT OVERLAY REMOVAL".

SEQUENCE OF CONSTRUCTION (PATCHING FIRST)

1. REMOVE THE EXISTING HMA MATERIAL OVER THE AREA TO BE PATCHED.
2. REMOVE AND REPLACE WITH CLASS C OR D PATCH.
3. REPLACE HMA MATERIAL OVER THE AREA TO BE PATCHED.

SEQUENCE OF CONSTRUCTION (MILLING FIRST)

1. MILL HMA FIRST IF THERE IS AT LEAST 4 1/2 INCHES OR MORE OF HMA MATERIAL ON TOP OF THE EXISTING PAVEMENT OR IF THE PAVEMENT IS FULL DEPTH HMA. A MINIMUM OF 2 INCHES OF HMA MATERIAL SHALL BE IN PLACE AFTER MILLING.
2. REMOVE AND REPLACE WITH FULL DEPTH CLASS D PATCHES TO TOP OF MILLED SURFACE.

ALL DIMENSIONS ARE IN INCHES (MILLIMETERS) UNLESS OTHERWISE SHOWN.

FILE NAME =	USER NAME = mossse	DESIGNED - R. SHAH	REVISED - A. ABBAS 04-27-98	STATE OF ILLINOIS DEPARTMENT OF TRANSPORTATION	PAVEMENT PATCHING FOR HMA SURFACED PAVEMENT			F.A.I. RTE.	SECTION	COUNTY	TOTAL SHEETS	SHEET NO.	
c:\pwork\PWIDOT\MOSSSE\g0186933\DistS.dgn		DRAWN -	REVISED - R. BORO 01-01-07		SCALE: NONE	SHEET NO. 1 OF 1 SHEETS	STA.	TO STA.	55	99-2AC-3-RS-2	WILL	15	8
		CHECKED -	REVISED - R. BORO 09-04-07						BD400-04 (BD-22)				
		DATE - 10-25-94	REVISED - K. ENG 10-27-08						CONTRACT NO. 60K25				
								FED. ROAD DIST. NO. 1 [ILLINOIS] FED. AID PROJECT					

VARIABLE - TO MEET EXISTING DIMENSIONS AND FIELD CONDITIONS (SEE NOTE ②)

PROP. CONC. CURB OR CURB AND GUTTER REPLACEMENT IN ACCORDANCE WITH STATE STANDARD 606001. (SEE NOTE ②)

SAW CUT FULL DEPTH - INCLUDED IN THE COST OF SIDEWALK, DRIVEWAY OR MEDIAN SURFACE REMOVAL PAY ITEM.

SEE STATE STANDARD 606001
EXISTING OR PROPOSED HMA SURFACE (IF APPLICABLE)

1/4" (5) **

18" (450) MAX.

EXISTING SIDEWALK, DRIVEWAY, MEDIAN SURFACE, SOD OR GROUND.

PROPOSED SIDEWALK, DRIVEWAY PAVEMENT, MEDIAN SURFACE OR SODDING SALT TOLERANT WITH TOP SOIL, 4" (100) SOD RESTORATION (SEE NOTE ①).

SUITABLE BACKFILL MATERIAL (INCLUDED IN THE COST OF CURB OR CURB AND GUTTER REMOVAL AND REPLACEMENT)

3" (75) MIN.

PROPOSED 3/4" (20) PREFORMED EXPANSION JOINT AT CONCRETE SIDEWALKS, DRIVEWAYS, AND MEDIANS. (INCLUDED IN THE COST OF CURB OR CURB AND GUTTER REMOVAL AND REPLACEMENT.)

UNSUITABLE SUB-BASE MATERIAL TO BE REMOVED, IF DIRECTED BY THE ENGINEER, SHALL BE REPLACED WITH EITHER SUB-BASE GRANULAR MATERIAL, TYPE B OR ADDITIONAL THICKNESS OF CONCRETE.

REMOVAL AND REPLACEMENT 4" (100) OR LESS IS INCLUDED IN THE COST OF CURB OR CURB AND GUTTER REMOVAL AND REPLACEMENT.

REMOVAL AND REPLACEMENT IN EXCESS OF 4" (100) WILL BE PAID FOR IN ACCORDANCE WITH ARTICLE 109.04 OF THE STANDARD SPECIFICATIONS.

PROPOSED #6 (20) EPOXY COATED TIE BARS 24" (600) LONG AT 24" (600) CENTERS WILL NOT BE PAID FOR SEPARATELY. DELETE EPOXY COATED TIE BARS IF EXISTING TIE BARS ARE USABLE AS DETERMINED BY THE ENGINEER. (SEE NOTE ③).

BASIS OF PAYMENT:

THIS WORK WILL BE PAID FOR AT THE CONTRACT UNIT PRICE PER FOOT (METER) FOR "CURB REMOVAL AND REPLACEMENT" OR "COMBINATION CONCRETE CURB AND GUTTER REMOVAL AND REPLACEMENT".

* 3" (75) MINIMUM FROM TOP AND BOTTOM OF THE CONCRETE PAVEMENT OR BASE COURSE.

** IF THE FINAL SURFACE OF THE PAVEMENT IS CONCRETE, THE GUTTER IS TO BE FLUSH WITH THE PAVEMENT.

NOTE: ① SIDEWALK, DRIVEWAY PAVEMENT OR MEDIAN SURFACE SHALL BE SIMILAR TO THE MATERIAL BEING REMOVED AND WILL BE PAID FOR SEPARATELY.

SODDING, SALT TOLERANT AND TOP SOIL, FURNISH AND PLACE 4" WILL BE PAID FOR SEPARATELY,

② FERTILIZER FOR THE PLACEMENT OF THE SOD IS NOT REQUIRED

③ CURB OR CURB AND GUTTER REPLACEMENT SHALL MATCH THE SHAPE OF THE EXISTING CURB OR CURB AND GUTTER UNLESS OTHERWISE SPECIFIED.

④ FOR CURB OR CURB AND GUTTER REMOVAL AND REPLACEMENT ADJACENT TO FLEXIBLE PAVEMENT DELETE EPOXY COATED TIE BARS.

⑤ LONGITUDINAL BARS, IF ENCOUNTERED IN THE EXISTING CURB OR CURB AND GUTTER, ARE NOT TO BE REPLACED. CUTTING AND REMOVING LONGITUDINAL BARS SHALL BE INCLUDED IN THE COST OF CURB OR CURB AND GUTTER REMOVAL AND REPLACEMENT.

⑥ THE COST OF HMA SURFACE REMOVAL IN THE EXISTING GUTTER FLAG SHALL BE INCLUDED IN THE COST OF THE CURB AND GUTTER REMOVAL AND REPLACEMENT.

⑦ THE REMOVAL AND REPLACEMENT OF THE EXISTING CURB OR CURB AND GUTTER SHALL BE DONE IN ACCORDANCE WITH THE APPLICABLE PORTIONS OF SECTION 440 AND 606 OF THE STANDARD SPECIFICATIONS.

⑧ THE LOCATIONS OF REMOVAL AND REPLACEMENT OF EXISTING CURB OR CURB AND GUTTER SHALL BE DETERMINED BY THE RESIDENT ENGINEER AT THE TIME OF CONSTRUCTION.

CURB OR CURB AND GUTTER REMOVAL AND REPLACEMENT

ALL DIMENSIONS ARE IN INCHES (MILLIMETERS) UNLESS OTHERWISE SHOWN.

FILE NAME =	USER NAME = mossse	DESIGNED - A. HOUSEH	REVISED - R. SHAH 10-03-96	STATE OF ILLINOIS DEPARTMENT OF TRANSPORTATION	CURB OR CURB AND GUTTER REMOVAL AND REPLACEMENT			F.A.I. RTE.	SECTION	COUNTY	TOTAL SHEETS	SHEET NO.
cd\pw_work\PW100T\MOSSSE\d0185933\DistS	sd.dgn	DRAWN -	REVISED - A. ABBAS 03-21-97		55	99-2AC-3-RS-2	WILL	15	9			
PLOT SCALE = 50.0000' / IN.	CHECKED -	REVISED - M. GOMEZ 01-22-01			BD600-06 (BD-24)			CONTRACT NO. 60K25				
PLOT DATE = 3/25/2010	DATE - 03-11-94	REVISED - R. BORO 12-15-09			SCALE: NONE	SHEET NO. 1 OF 1 SHEETS	STA. TO STA.	FED. ROAD DIST. NO. 1 ILLINOIS FED. AID PROJECT				

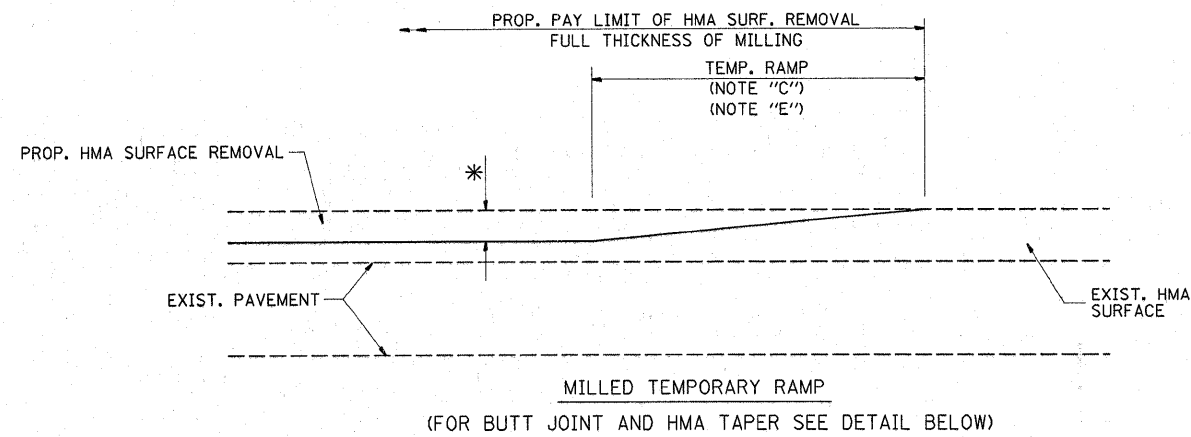

OPTION 1

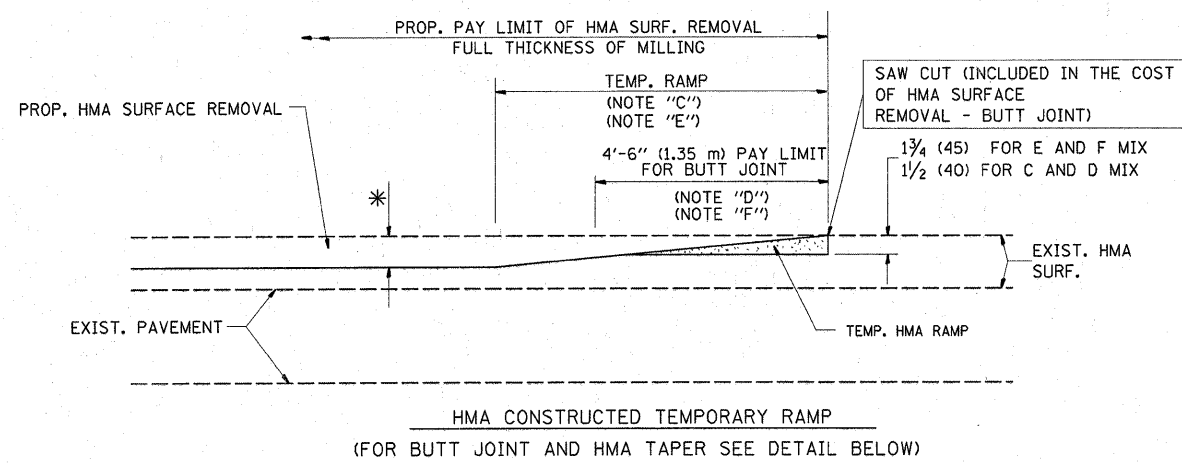

**OPTION 2
TYPICAL TEMPORARY RAMP**

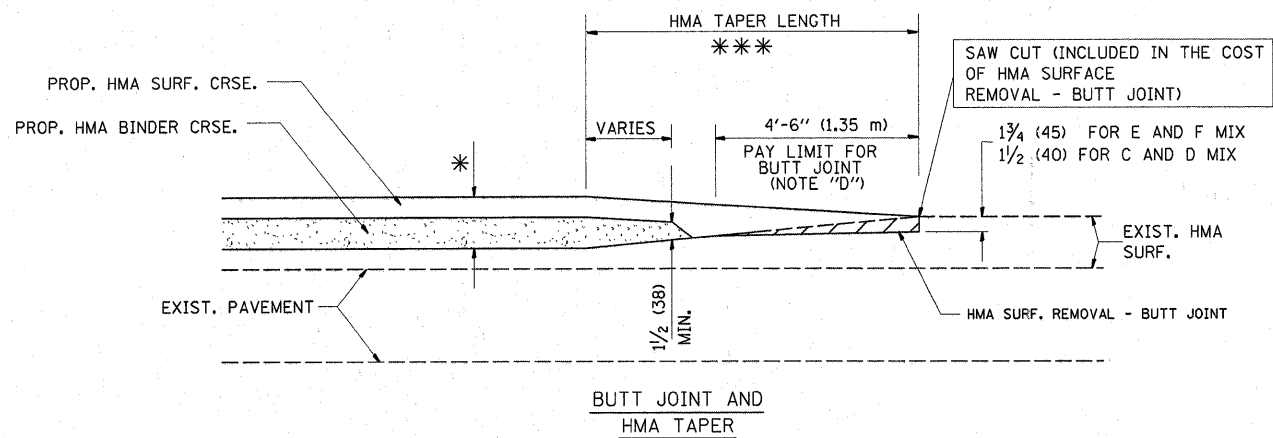

**TYPICAL BUTT JOINT AND HMA TAPER
FOR MILLING AND RESURFACING**

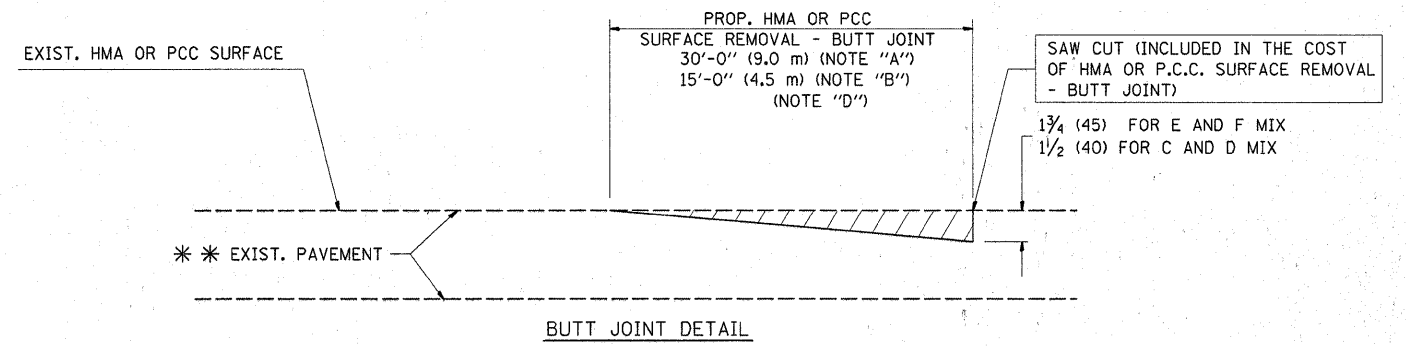

BUTT JOINT DETAIL

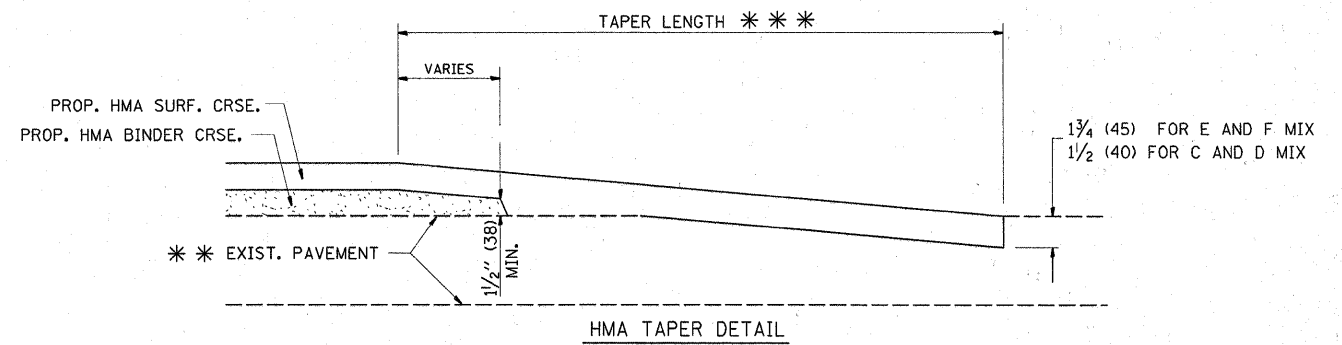

**TYPICAL BUTT JOINT AND HMA TAPER
FOR RESURFACING ONLY**

*** PC CONCRETE, HMA OR HMA RESURFACED PAVEMENT.

NOTES

- A: MAINLINE ROADWAYS AND MAJOR SIDE ROADS.
 - B: MINOR SIDE ROADS.
 - C: THE TEMP. RAMP SHALL BE CONSTRUCTED IMMEDIATELY UPON REMOVAL OF THE EXISTING HMA SURFACE.
 - D: THE BUTT JOINT SHALL BE CONSTRUCTED IMMEDIATELY PRIOR TO PLACING THE PROPOSED HMA COURSES.
 - E: TAPER THE TEMP. RAMP AT A RATE OF 3'-0" (900 mm) PER 1 INCH (25 mm) OF MILLING THICKNESS.
 - F: INSTALLATION AND REMOVAL OF THE 4'-6" (1.35 m) TEMP. RAMP IS INCLUDED IN COST OF HMA SURFACE REMOVAL - BUTT JOINT
 - G: SEE ARTICLE 406.08 AND 406.14 OF THE STANDARD SPECIFICATIONS FOR "HMA AND/OR PCC SURFACE REMOVAL, BUTT JOINT".
- *** SEE TYPICAL SECTIONS FOR MILLING THICKNESS.
- *** 20'-0" (6.1 m) PER 1 (25) RESURFACING (NOTE "A")
10'-0" (3.0 m) PER 1 (25) RESURFACING (NOTE "B")

BASIS OF PAYMENT:

THE BUTT JOINT WILL BE PAID FOR AT THE CONTRACT UNIT PRICE PER SQUARE YARD (SQUARE METER) FOR "HOT-MIX ASPHALT SURFACE REMOVAL - BUTT JOINT" OR FOR "PORTLAND CEMENT CONCRETE SURFACE REMOVAL - BUTT JOINT".

ALL DIMENSIONS ARE IN INCHES (MILLIMETERS) UNLESS OTHERWISE SHOWN.

FILE NAME =	USER NAME = mossse	DESIGNED - M. DE YONG	REVISED - R. SHAH 10-25-94
ca:\pwork\PWID01\MOSSSE\d0185933\01stS.dgn		DRAWN -	REVISED - A. ABBAS 03-21-97
	PLOT SCALE = 50.0000' / IN.	CHECKED -	REVISED - M. GOMEZ 04-06-01
	PLOT DATE = 3/25/2010	DATE - 06-13-90	REVISED - R. BORO 01-01-07

**STATE OF ILLINOIS
DEPARTMENT OF TRANSPORTATION**

**BUTT JOINT AND
HMA TAPER DETAILS**

SCALE: NONE SHEET NO. 1 OF 1 SHEETS STA. TO STA.

F.A.I. RTE.	SECTION	COUNTY	TOTAL SHEETS	SHEET NO.
55	99-2AC-3-RS-2	WILL	15	10
BD400-05 BD32			CONTRACT NO. 60K25	
FED. ROAD DIST. NO. 1 ILLINOIS FED. AID PROJECT				

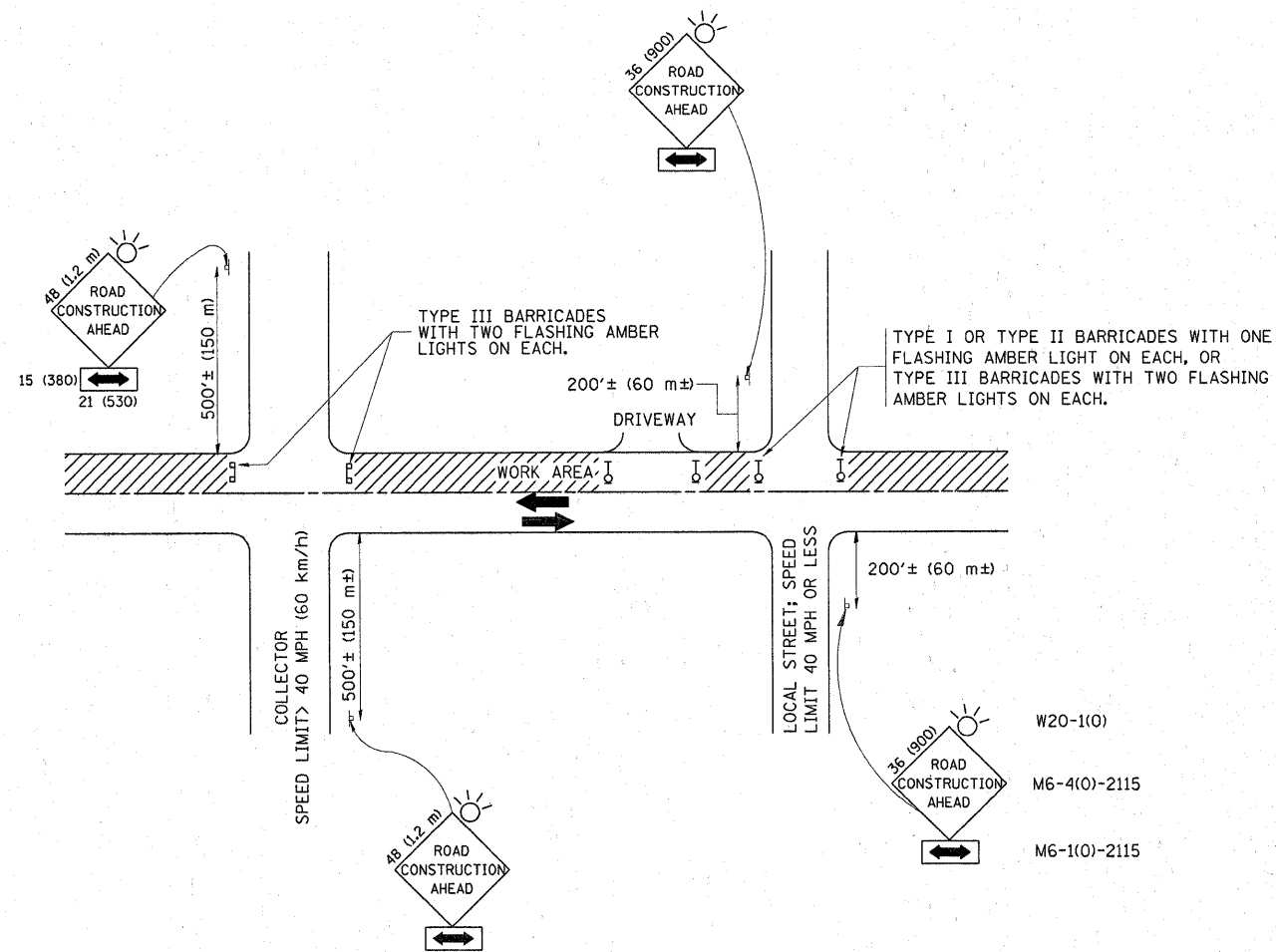

TRAFFIC CONTROL AND PROTECTION FOR SIDE ROADS, INTERSECTIONS, AND DRIVEWAYS

NOTES:

A. FOR NO LANE RESTRICTION ON THE SIDE ROAD OR DRIVEWAYS

1. SIDE ROAD WITH A SPEED LIMIT OF 40 MPH (60 km/h) OR LESS AS SHOWN ON THE DRAWING AND AS DIRECTED BY THE ENGINEER:
 - a) ONE ROAD CONSTRUCTION AHEAD SIGN 36 x 36 (900x900) WITH A FLASHER AND FLAG MOUNTED ON IT APPROXIMATELY 200' (60 m) IN ADVANCE OF THE MAIN ROUTE.
 - b) THE CLOSED PORTION OF THE MAIN ROUTE SHALL BE PROTECTED BY BLOCKING WITH TYPE I, TYPE II OR TYPE III BARRICADES, 1/3 OF THE CROSS SECTION OF THE CLOSED PORTION.
2. SIDE ROAD WITH A SPEED LIMIT GREATER THAN 40 MPH (60 km/h) AS SHOWN ON THE DRAWING AND AS DIRECTED BY THE ENGINEER:
 - a) ONE ROAD CONSTRUCTION AHEAD SIGN 48 x 48 (1.2 m x 1.2 m) WITH A FLASHER MOUNTED ON IT APPROXIMATELY 500' (150 m) IN ADVANCE OF THE MAIN ROUTE.
 - b) THE CLOSED PORTION OF THE MAIN ROUTE SHALL BE PROTECTED BY BLOCKING WITH TYPE III BARRICADES, 1/2 OF THE CROSS SECTION OF THE CLOSED PORTION.
3. WHEN THE SIDE ROAD LIES BETWEEN THE BEGINNING OF THE MAINLINE SIGNING AND THE WORK ZONE, A SINGLE HEADED ARROW (M6-1) SHALL BE USED IN LIEU OF THE DOUBLE HEADED ARROW (M6-4).

B. FOR A LANE CLOSURE ON A SIDE ROAD OR DRIVEWAY:

USE APPLICABLE PORTIONS OF THE TYPICAL APPLICATION OF TRAFFIC CONTROL DEVICES (STD. 701501, STD. 701606 OR THE APPROPRIATE STANDARD). THE SPACING OF SIGNS AND BARRICADES SHALL BE ADJUSTED FOR FIELD CONDITIONS AS DIRECTED BY THE ENGINEER. THE DIRECTIONAL ARROW SHALL BE COVERED OR REMOVED WHEN NO LONGER CONSISTENT WITH THE SIDE ROAD LANE CLOSURE.

C. ADVANCE WARNING SIGNS ARE TO BE OMITTED ON DRIVEWAY UNLESS OTHERWISE NOTED.

D. THE TRAFFIC CONTROL AND PROTECTION FOR SIDE ROADS, INTERSECTIONS, AND DRIVEWAYS SHALL BE INCIDENTAL TO THE COST OF SPECIFIED TRAFFIC CONTROL STANDARDS OR ITEMS.

All dimensions are in millimeters (Inches) unless otherwise shown.

FILE NAME =	USER NAME = mossse	DESIGNED - LHA	REVISED - J. OBERLE 10-18-95
c:\pw_work\PW1001\MOSSSE\d0185933\Dist.dgn		DRAWN -	REVISED - A. HOUSEH 03-06-96
	PLOT SCALE = 50.0000 / IN.	CHECKED -	REVISED - A. HOUSEH 10-15-96
	PLOT DATE = 3/25/2010	DATE - 06-89	REVISED - T. RAMMACHER 01-06-00

STATE OF ILLINOIS
DEPARTMENT OF TRANSPORTATION

TRAFFIC CONTROL AND PROTECTION FOR
SIDE ROADS, INTERSECTIONS, AND DRIVEWAYS

SCALE: NONE SHEET NO. 1 OF 1 SHEETS STA. TO STA.

F.A.I. RTE.	SECTION	COUNTY	TOTAL SHEETS	SHEET NO.
55	99-2AC-3-RS-2	WILL	15	11
TC-10			CONTRACT NO. 60K25	
FED. ROAD DIST. NO. 1 [ILLINOIS] FED. AID PROJECT				

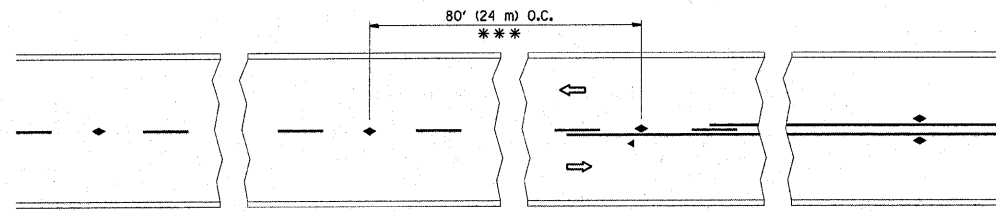

*** REDUCE TO 40' (12 m) O.C. ON CURVES WITH POSTED OR ADVISORY SPEED 45 M.P.H. (70 km/h) OR LESS.

TWO-LANE/TWO-WAY

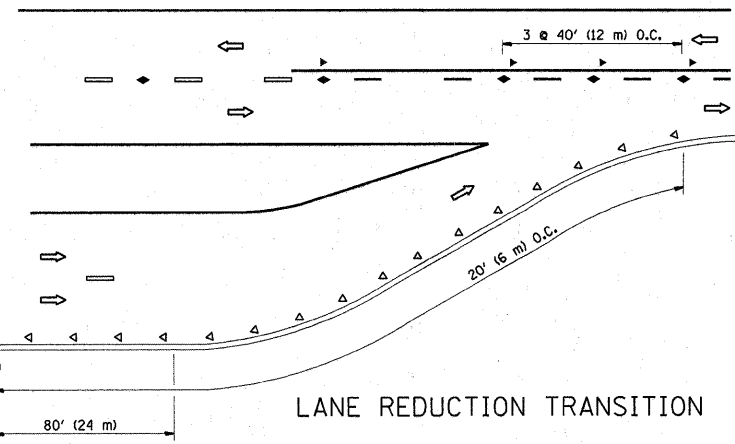

LANE REDUCTION TRANSITION

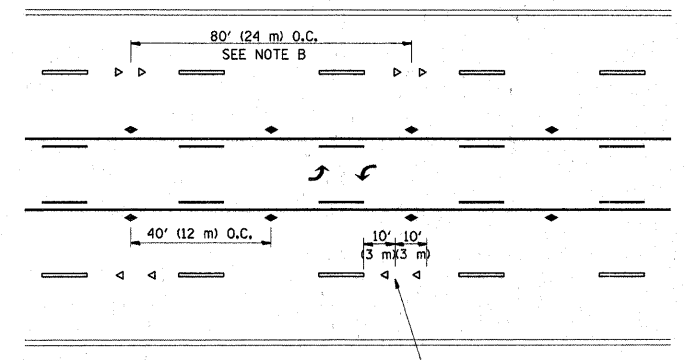

TWO-WAY LEFT TURN

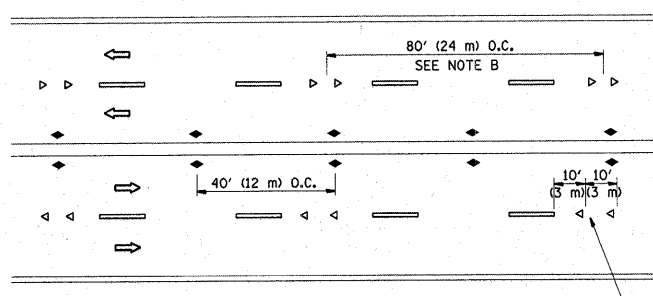

MULTI-LANE/UNDIVIDED

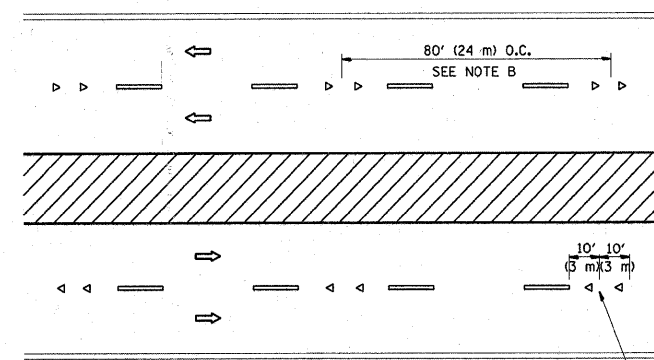

MULTI-LANE/DIVIDED

GENERAL NOTES

1. MARKERS USED WITH DASHED LINES SHALL BE CENTERED IN THE GAP BETWEEN SEGMENTS.
2. MARKERS USED ADJACENT TO SOLID LINES SHALL BE OFFSET 2 TO 3 (50 TO 75) TOWARD TRAFFIC AS SHOWN.
3. MARKERS THROUGH TANGENTS LESS THAN 500' (150 m) IN LENGTH BETWEEN CURVES SHALL BE INSTALLED AT THE LESSER OF THE TWO CURVE SPACINGS.

SYMBOLS

- YELLOW STRIPE
- WHITE STRIPE
- ◀ ONE-WAY AMBER MARKER
- ◀ ONE-WAY CRYSTAL MARKER (W/O)
- ◆ TWO-WAY AMBER MARKER

LANE MARKER NOTES

- A. USE DOUBLE LANE LINE MARKERS SPACED AS SHOWN.
- B. REDUCE TO 40' (12 m) O.C. ON CURVES WHERE ADVISORY SPEEDS ARE 10 M.P.H (20 km/h) LOWER THAN POSTED SPEEDS.

DESIGN NOTES

1. DOUBLE LANE LINE MARKERS SHALL BE USED UNLESS SPECIFIED OTHERWISE.
2. EXCEPT AS SHOWN ON THE LANE REDUCTION TRANSITION AND FREEWAY EXIT RAMP DETAIL, MARKERS ARE NOT TO BE SPECIFIED ON RIGHT EDGE LINES.
3. THE EXACT MARKER LIMITS, SPACING, AND COLOR SHOULD BE INCLUDED IN THE PLANS.
4. MARKERS SHOULD NOT BE USED ALONGSIDE CURBS EXCEPT FOR EXTREMELY SHORT SECTIONS OF CURBS WHERE NOT MORE THAN TWO MARKERS WOULD BE INVOLVED.

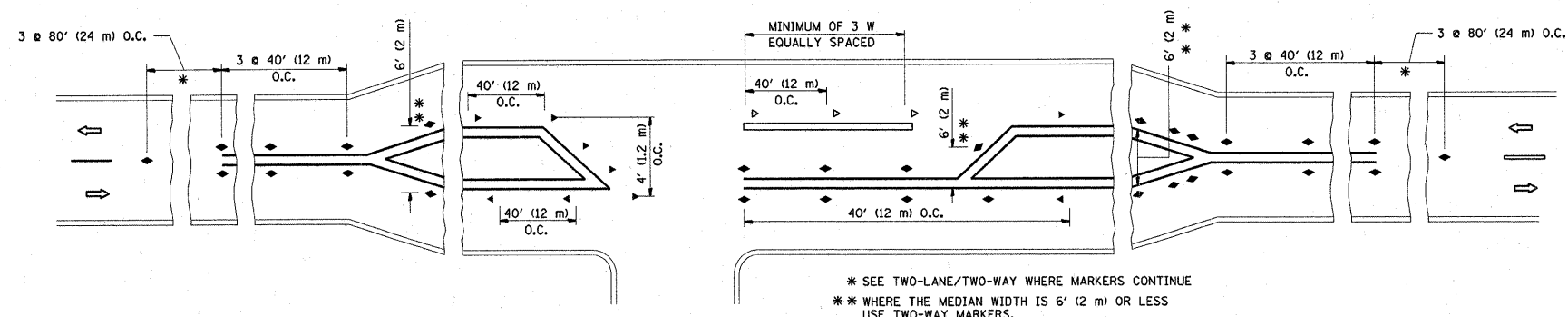

LEFT TURN

* SEE TWO-LANE/TWO-WAY WHERE MARKERS CONTINUE
 ** WHERE THE MEDIAN WIDTH IS 6' (2 m) OR LESS USE TWO-WAY MARKERS.

All dimensions are in inches (millimeters) unless otherwise shown.

FILE NAME =	USER NAME = mossse	DESIGNED -	REVISED - T. RAMMACHER 09-19-94	STATE OF ILLINOIS DEPARTMENT OF TRANSPORTATION	TYPICAL APPLICATIONS			F.A.I. RTE.	SECTION	COUNTY	TOTAL SHEETS	SHEET NO.	
cs:\pw_work\PWIDOT\MOSSSE\0185933\01st.dgn		DRAWN -	REVISED - T. RAMMACHER 03-12-99		RAISED REFLECTIVE PAVEMENT MARKERS (SNOW-PLOW RESISTANT)			55	99-2AC-3-RS-2	WILL	15	12	
		PLOT SCALE = 50.0000' / IN.	REVISED - T. RAMMACHER 01-06-00		SCALE: NONE	SHEET NO. 1	OF 1 SHEETS	STA.	TO STA.	TC-11			CONTRACT NO. 60K25
		PLOT DATE = 3/25/2010	REVISED - C. JUCIUS 09-09-09		FED. ROAD DIST. NO. 1 (ILLINOIS) FED. AID PROJECT								

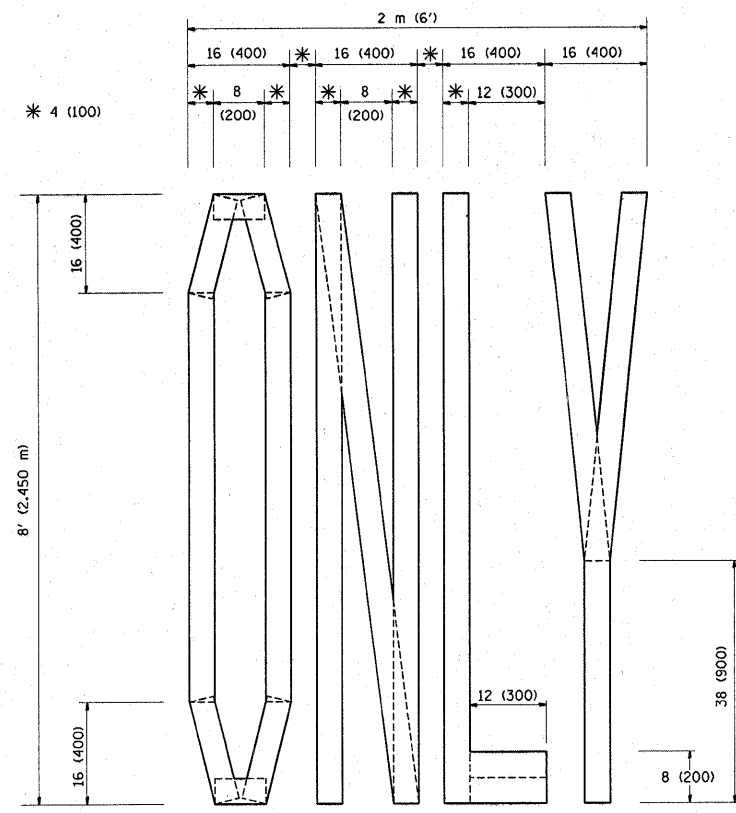

QUANTITY
 4 (100) LINE = 64.1 ft. (19.7 m)
 21.1 sq. ft. (1.97 sq. m)

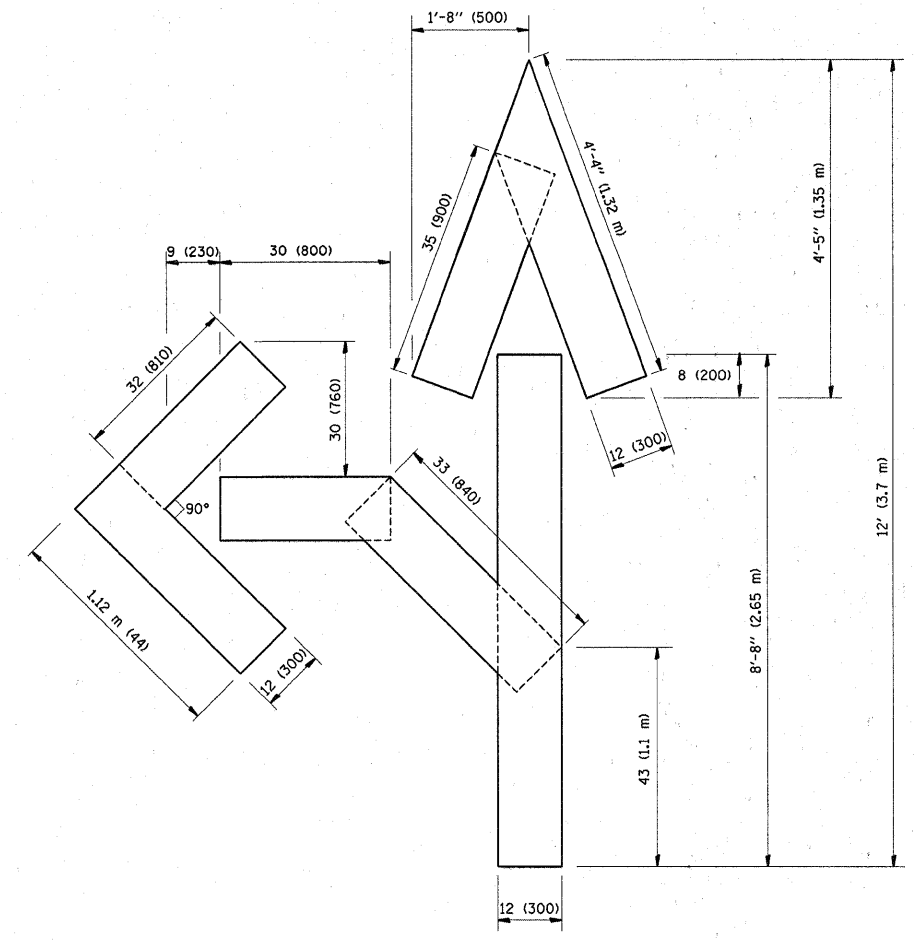

QUANTITY
 4 (100) LINE = 82.5 ft. (25.3 m)
 27.5 sq. ft. (2.53 sq. m)

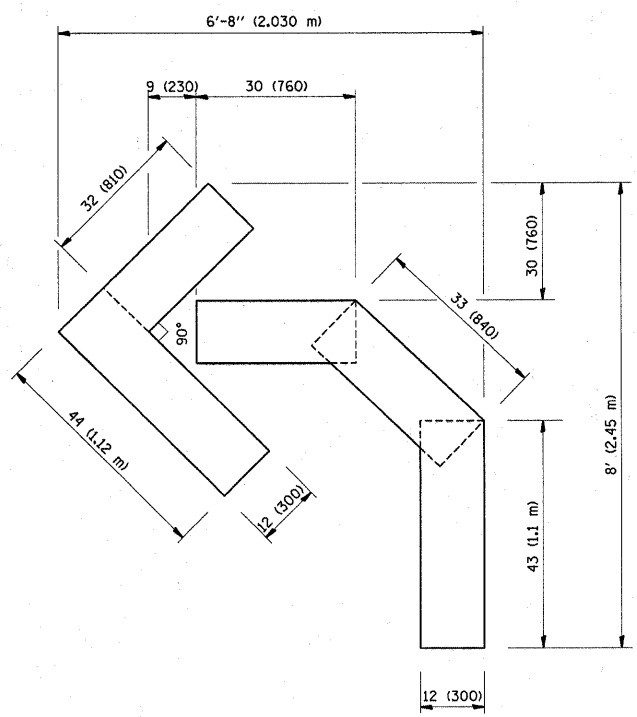

QUANTITY
 4 (100) LINE = 45.5 ft. (13.9 m)
 15.2 sq. ft. (1.39 sq. m)

All dimensions are in inches (millimeters) unless otherwise shown.

FILE NAME =	USER NAME = mossse	DESIGNED -	REVISED -T. RAMMACHER 06-05-96	STATE OF ILLINOIS DEPARTMENT OF TRANSPORTATION	PAVEMENT MARKING LETTERS AND SYMBOLS FOR TRAFFIC STAGING			F.A.I. RTE.	SECTION	COUNTY	TOTAL SHEETS	SHEET NO.
alpha_work\FWIDOT\MOSSSE\08185933\Dist5.dgn		DRAWN -	REVISED -T. RAMMACHER 11-04-97		55	99-2AC-3-RS-2	WILL	15	14			
	PLDT SCALE = 50.0000' / IN.	CHECKED -	REVISED -T. RAMMACHER 03-02-98		TC-16			CONTRACT NO. 60K25				
	PLDT DATE = 3/25/2010	DATE - 09-18-94	REVISED -E. GOMEZ 08-28-00		SCALE: NONE	SHEET NO. 1 OF 1 SHEETS	STA. TO STA.	FED. ROAD DIST. NO. 1 [ILLINOIS] FED. AID PROJECT				

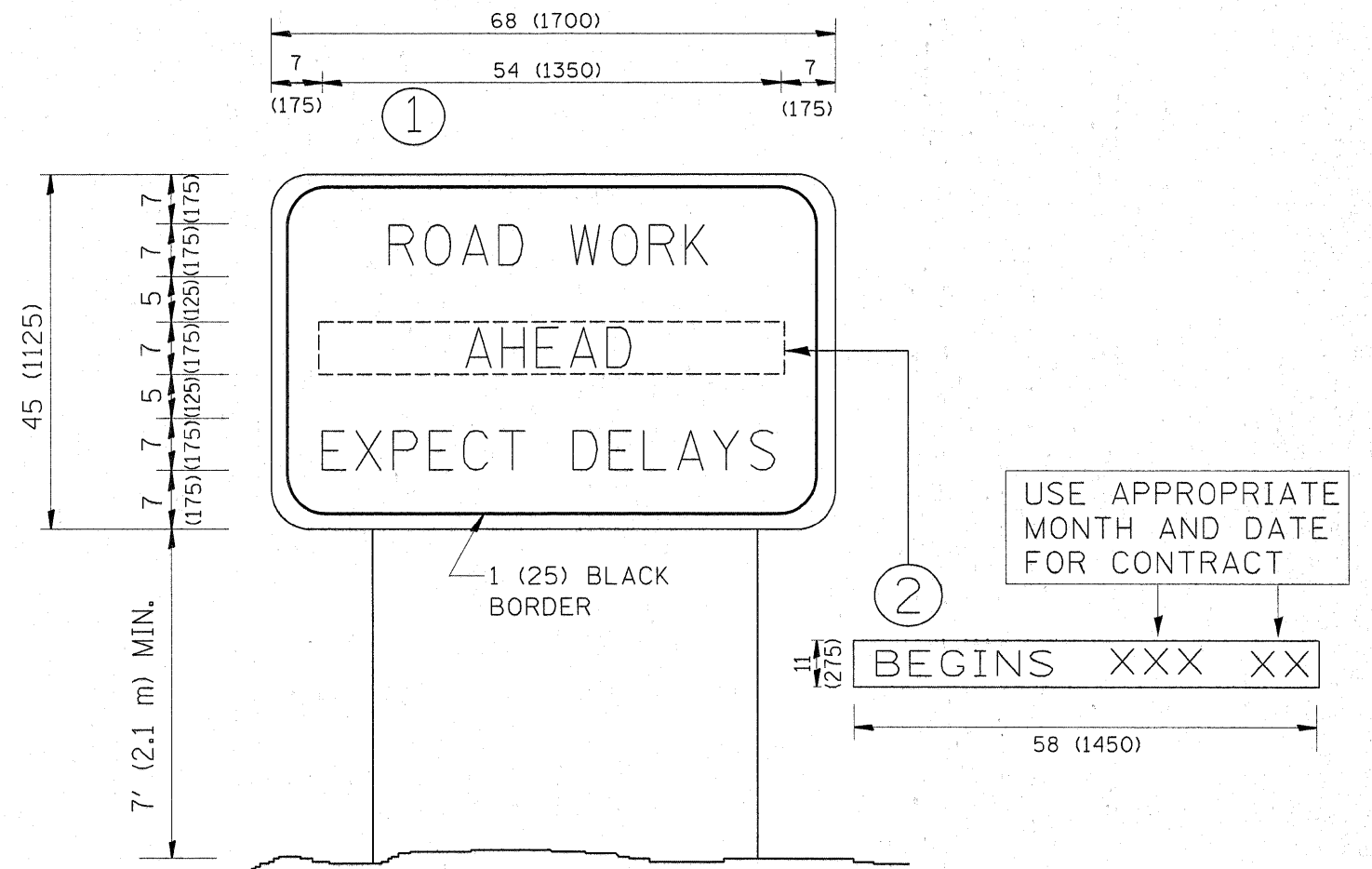

NOTES:

1. USE BLACK LETTERING ON ORANGE BACKGROUND.
2. ERECT SIGNS IN ADVANCE OF THE LOCATION FOR THE "ROAD CONSTRUCTION AHEAD" SIGN AT LOCATIONS AS DIRECTED BY THE ENGINEER.
3. ERECT SIGN ① WITH INSTALLED PANEL ② ONE WEEK PRIOR TO THE START OF CONSTRUCTION.
4. REMOVE PANEL ② SOON AFTER THE START OF CONSTRUCTION.
5. SEE SPECIAL PROVISION FOR "TEMPORARY INFORMATION SIGNING" FOR ADDITIONAL INFORMATION.
6. ONE SIGN ASSEMBLY EQUALS 25.70 SQ. FT. (2.3 SQ. M.)
7. SHALL BE PAID FOR AS TEMPORARY INFORMATION SIGNING.

ALL DIMENSIONS ARE IN INCHES (MILLIMETERS) UNLESS OTHERWISE SHOWN.

FILE NAME =	USER NAME = mossse	DESIGNED -	REVISED - R. MIRS 09-15-97
cr\p\work\PWIDOT\MOSSSE\d0105933\DistS	d.dgn	DRAWN -	REVISED - R. MIRS 12-11-97
	PLOT SCALE = 50.0000" / IN.	CHECKED -	REVISED - T. RAMMACHER 02-02-99
	PLOT DATE = 3/25/2010	DATE -	REVISED - C. JUCIUS 01-31-07

**STATE OF ILLINOIS
DEPARTMENT OF TRANSPORTATION**

**ARTERIAL ROAD
INFORMATION SIGN**

SCALE: NONE SHEET NO. 1 OF 1 SHEETS STA. TO STA.

F.A.I. RTE.	SECTION	COUNTY	TOTAL SHEETS	SHEET NO.
55	99-2AC-3-RS-2	WILL	15	15
TC-22			CONTRACT NO. 60K25	
FED. ROAD DIST. NO. 1 ILLINOIS FED. AID PROJECT				