

LC. 4-21-2010

FILE NAME = P:\2009\ME\09006_Var-Var_Phil\CADD\W05_US20\Shas\0162529-ah-MOT11.dgn
 PLOT SCALE = 50.0000' / IN.
 USER NAME = Millennium Professional Services

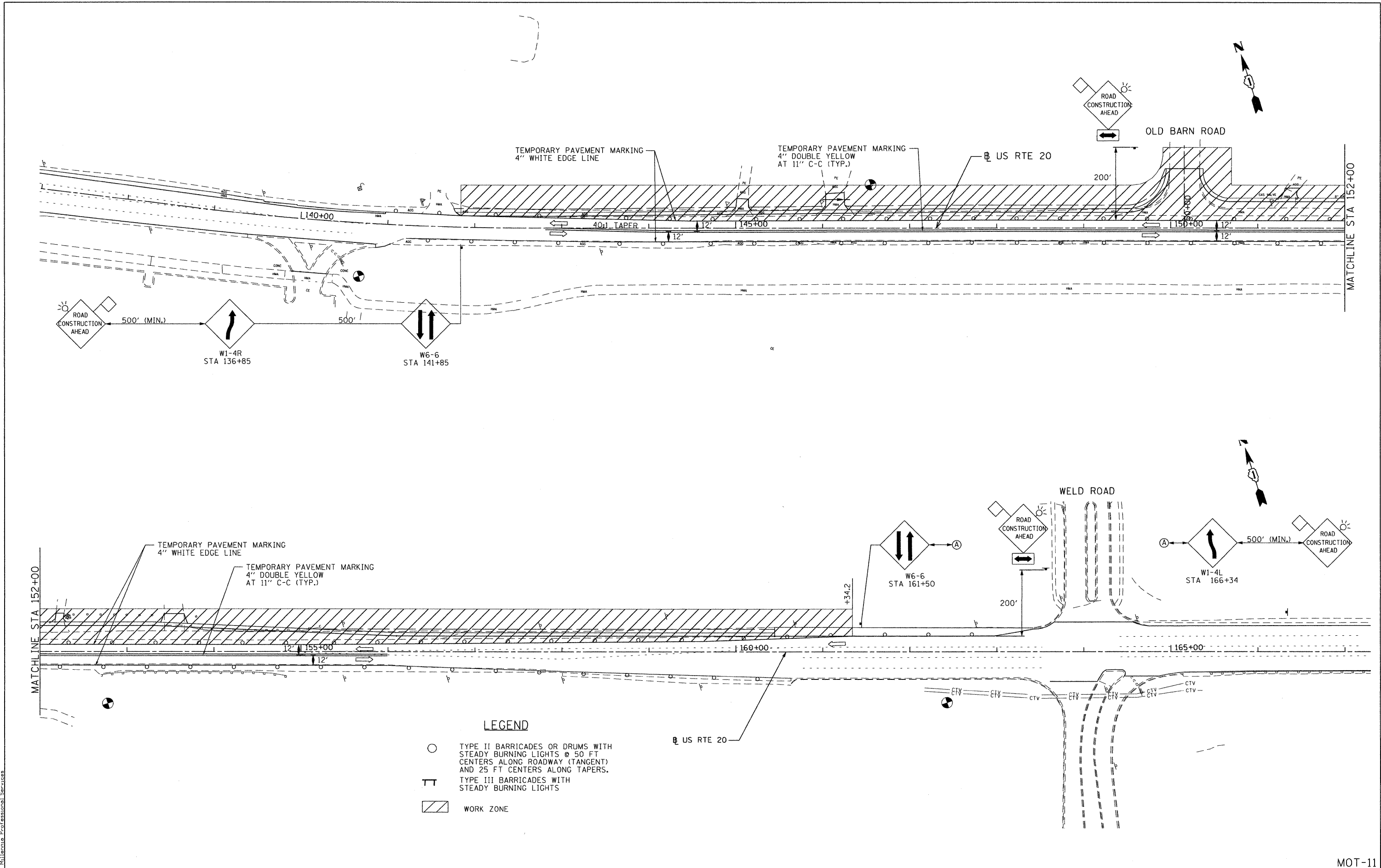

LEGEND

- TYPE II BARRICADES OR DRUMS WITH STEADY BURNING LIGHTS @ 50 FT CENTERS ALONG ROADWAY (TANGENT) AND 25 FT CENTERS ALONG TAPERS.
- ⊥ TYPE III BARRICADES WITH STEADY BURNING LIGHTS
- ▨ WORK ZONE

MILLENNIA PROFESSIONAL SERVICES
 200 22ND Street, Suite 216, Lombard, IL 60148
 630.705.0110 voice, 630.839.2566 fax
 WWW.MPS-IL.COM

DESIGNED - TVN	REVISED -
DRAWN - TVN	REVISED -
CHECKED - RPD	REVISED -
DATE - 4/20/2010	REVISED -

**STATE OF ILLINOIS
 DEPARTMENT OF TRANSPORTATION**

**U.S. ROUTE 20
 EAST OF PLANK ROAD TO WELD ROAD**

**SUGGESTED STAGES OF CONSTRUCTION
 AND TRAFFIC CONTROL
 STAGE - 1**

SCALE: SHEET NO. OF SHEETS STA. TO STA.

F.A.P. RTE.	SECTION	COUNTY	TOTAL SHEETS	SHEET NO.
345	8WRS-2	KANE	72	20
CONTRACT NO. 62529				

MOT-11

F:\2009\ME\09006_Var-Var_Phil\CADD\W05_US20\Shas\0162529-ah-MOT11.dgn