

THE TRAFFIC SIGNAL CONTROL EQUIPMENT FOR THIS SYSTEM SHALL BE "EAGLE" TO MATCH THE EXISTING ADJACENT SYSTEM.

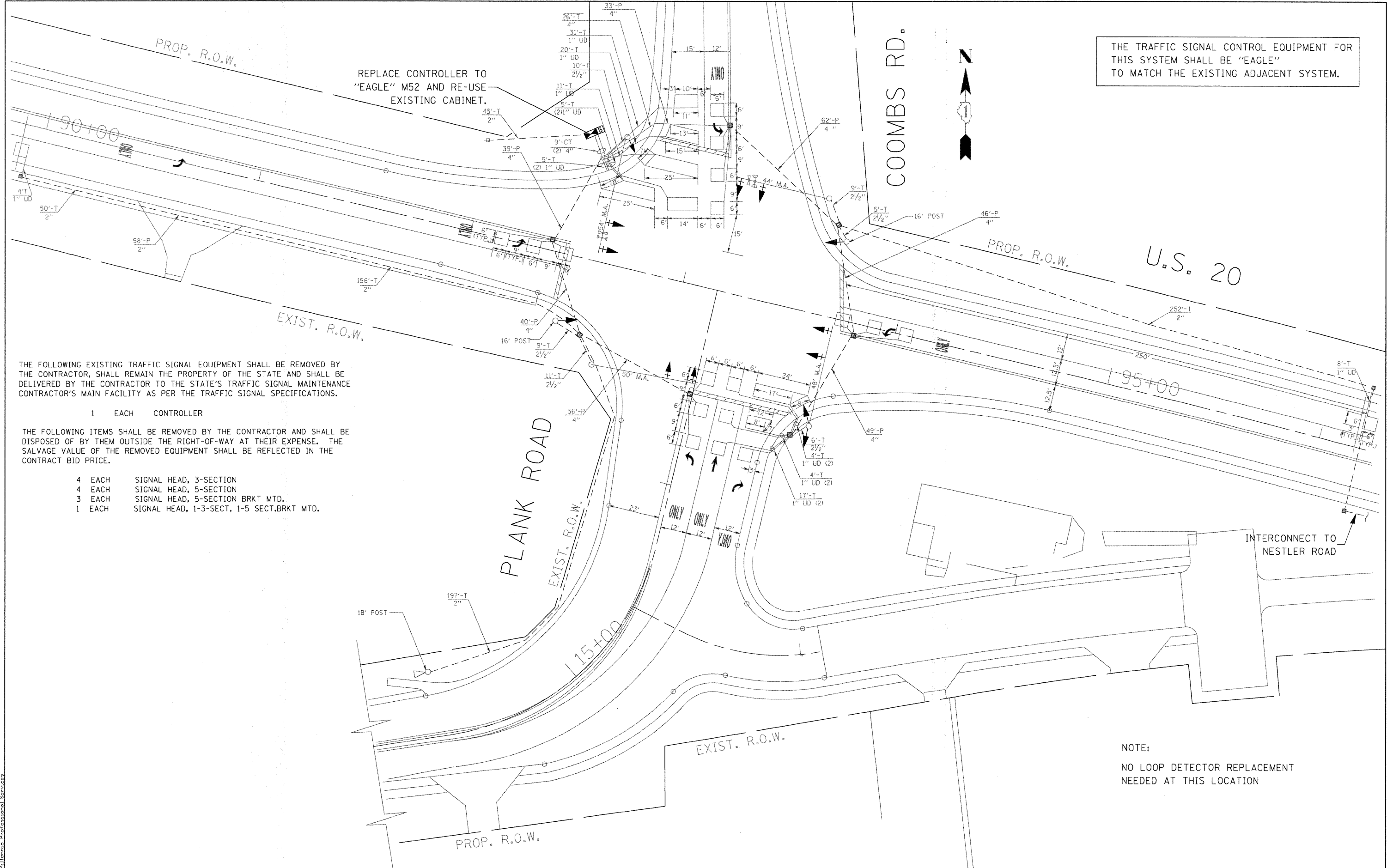

THE FOLLOWING EXISTING TRAFFIC SIGNAL EQUIPMENT SHALL BE REMOVED BY THE CONTRACTOR, SHALL REMAIN THE PROPERTY OF THE STATE AND SHALL BE DELIVERED BY THE CONTRACTOR TO THE STATE'S TRAFFIC SIGNAL MAINTENANCE CONTRACTOR'S MAIN FACILITY AS PER THE TRAFFIC SIGNAL SPECIFICATIONS.

1 EACH CONTROLLER

THE FOLLOWING ITEMS SHALL BE REMOVED BY THE CONTRACTOR AND SHALL BE DISPOSED OF BY THEM OUTSIDE THE RIGHT-OF-WAY AT THEIR EXPENSE. THE SALVAGE VALUE OF THE REMOVED EQUIPMENT SHALL BE REFLECTED IN THE CONTRACT BID PRICE.

- 4 EACH SIGNAL HEAD, 3-SECTION
- 4 EACH SIGNAL HEAD, 5-SECTION
- 3 EACH SIGNAL HEAD, 5-SECTION BRKT MTD.
- 1 EACH SIGNAL HEAD, 1-3-SECT, 1-5 SECT. BRKT MTD.

NOTE:
NO LOOP DETECTOR REPLACEMENT NEEDED AT THIS LOCATION

FILE NAME: P:\2009\ME090086_Ver-Yor-Ph1\CAD\W05\US20\Shets\0162529-ah-t-TS01-Plank.dgn
 USER: MPE
 PLOT DATE: 4/9/2010 10:51:10 AM
 PLOT SCALE: 1/8"=1'-0"



200 22ND Street, Suite 216, Lombard, IL 60148
 630.705.8110 voice, 630.839.2566 fax
 WWW.MPS-IL.COM
MILLENNIA PROFESSIONAL SERVICES

DESIGNED	- TVN	REVISED	-
DRAWN	- TVN	REVISED	-
CHECKED	- RPD	REVISED	-
DATE	- 4/9/2010	REVISED	-

STATE OF ILLINOIS
DEPARTMENT OF TRANSPORTATION

TRAFFIC SIGNAL INSTALLATION PLAN
US 20 AT PLANK/COOMBS ROAD

SCALE: SHEET NO. OF SHEETS STA. TO STA.

F.A.P. RTE.	SECTION	COUNTY	TOTAL SHEETS	SHEET NO.
345	BWRS-2	KANE	72	38
CONTRACT NO. 62529				

FED. ROAD DIST. NO. 1 [ILLINOIS] FED. AID PROJECT
P:\2009\ME090086_Ver-Yor-Ph1\CAD\W05\US20\Shets\0162529-ah-t-TS01-Plank.dgn