

SURVEYED
 PLOTTED
 CHECKED
 REL. OF FILE CHECKED
 CAD FILE NAME
 NO.

SURVEYED
 PLOTTED
 CHECKED
 REL. OF FILE CHECKED
 CAD FILE NAME
 NO.

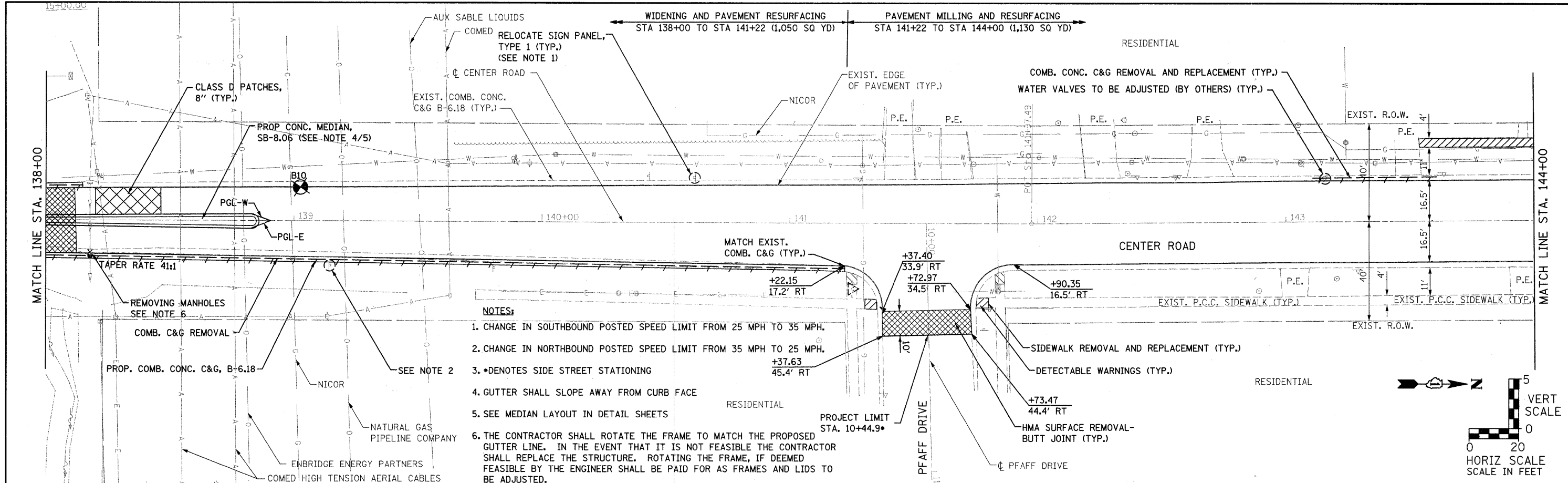

- NOTES:**
- CHANGE IN SOUTHBOUND POSTED SPEED LIMIT FROM 25 MPH TO 35 MPH.
 - CHANGE IN NORTHBOUND POSTED SPEED LIMIT FROM 35 MPH TO 25 MPH.
 - DENOTES SIDE STREET STATIONING
 - GUTTER SHALL SLOPE AWAY FROM CURB FACE
 - SEE MEDIAN LAYOUT IN DETAIL SHEETS
 - THE CONTRACTOR SHALL ROTATE THE FRAME TO MATCH THE PROPOSED GUTTER LINE. IN THE EVENT THAT IT IS NOT FEASIBLE THE CONTRACTOR SHALL REPLACE THE STRUCTURE. ROTATING THE FRAME, IF DEEMED FEASIBLE BY THE ENGINEER SHALL BE PAID FOR AS FRAMES AND LIDS TO BE ADJUSTED.

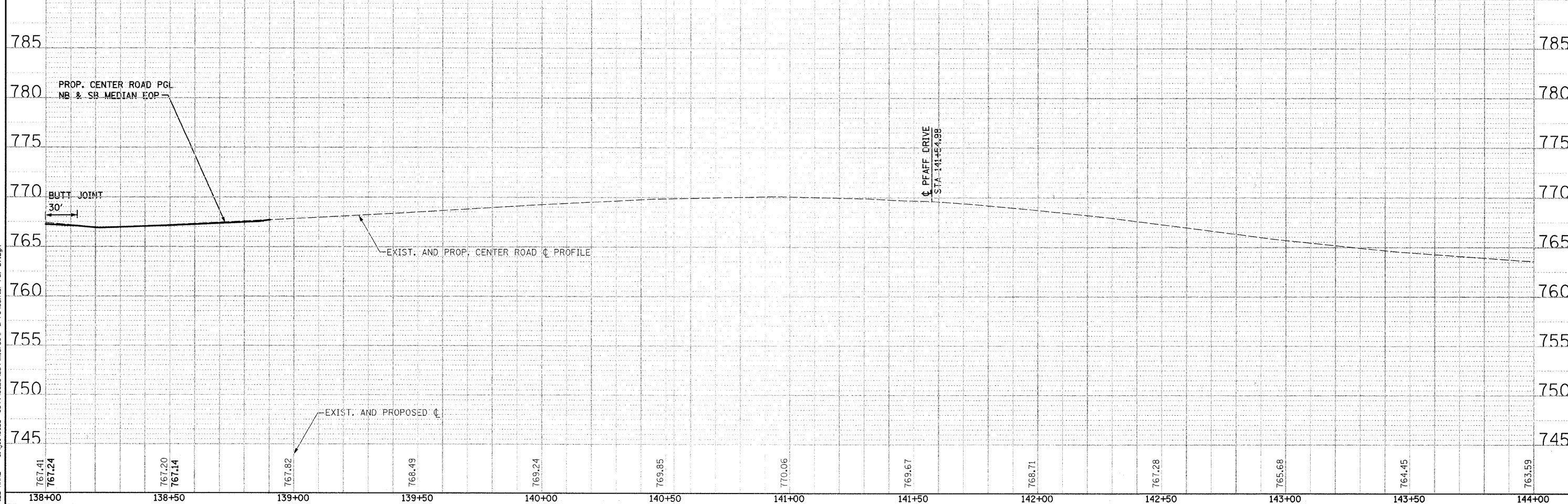
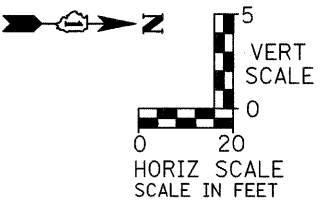

767.41	767.24	767.20	767.14	767.82	768.49	769.24	769.85	770.06	769.67	768.71	767.28	765.68	764.45	763.59
138+00	138+50	139+00	139+50	140+00	140+50	141+00	141+50	142+00	142+50	143+00	143+50	144+00		

1170 SOUTH HOUBOLT ROAD
 JOLIET, ILLINOIS 60431
 (815) 744-4200
STRAND
 ASSOCIATES, INC.
 ENGINEERS

USER NAME = edamm
 DESIGNED - ARM
 CHECKED - RKK
 DRAWN - KAS
 CHECKED - RKK
 REVISED -
 REVISED -
 REVISED -
 REVISED -
 PLOT SCALE = 20.0000' / IN.
 PLOT DATE = 3/31/2012

STATE OF ILLINOIS
DEPARTMENT OF TRANSPORTATION

CENTER ROAD PLAN AND PROFILE
 SCALE: AS SHOWN SHEET NO. OF SHEETS STA. 138+00 TO STA. 144+00

F.A.U. RTE. 3759	SECTION 04-00038-00-WR	COUNTY WILL	TOTAL SHEETS 165	SHEET NO. 25
CONTRACT NO. 63248			ILLINOIS FED. AID PROJECT	