

QUANTITY  
 4 (100) LINE = 64.1 ft. (19.7 m)  
 21.1 sq. ft. (1.97 sq. m)

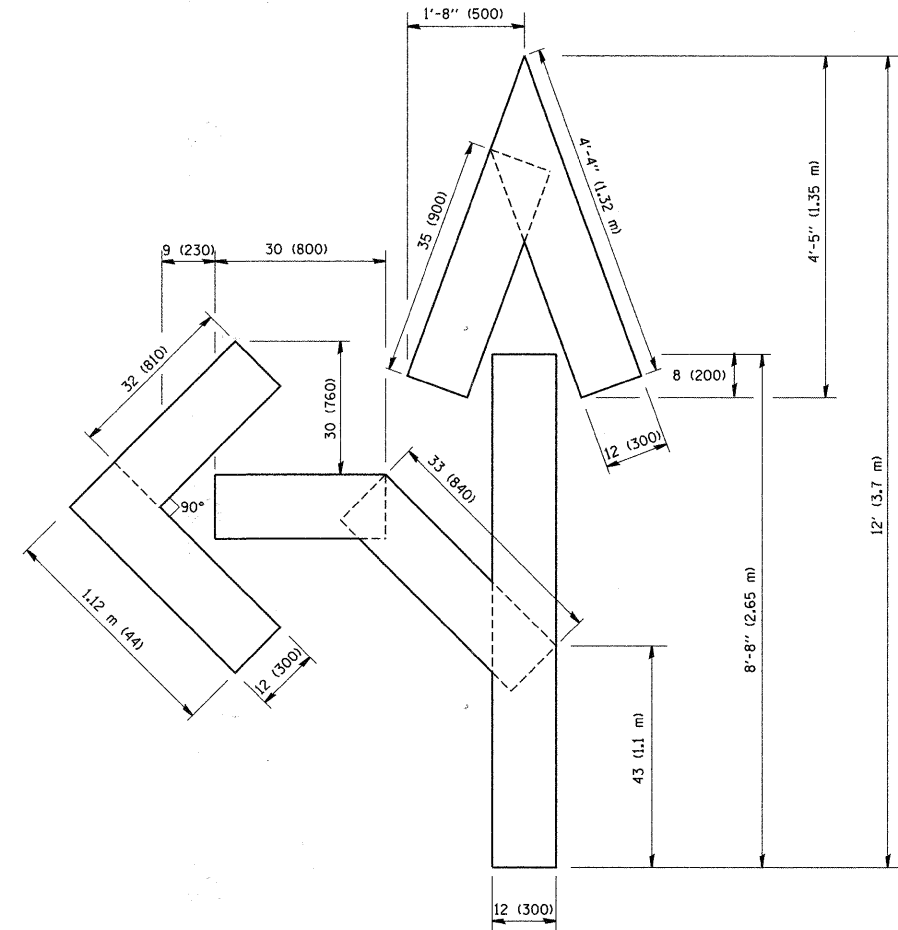

QUANTITY  
 4 (100) LINE = 82.5 ft. (25.3 m)  
 27.5 sq. ft. (2.53 sq. m)

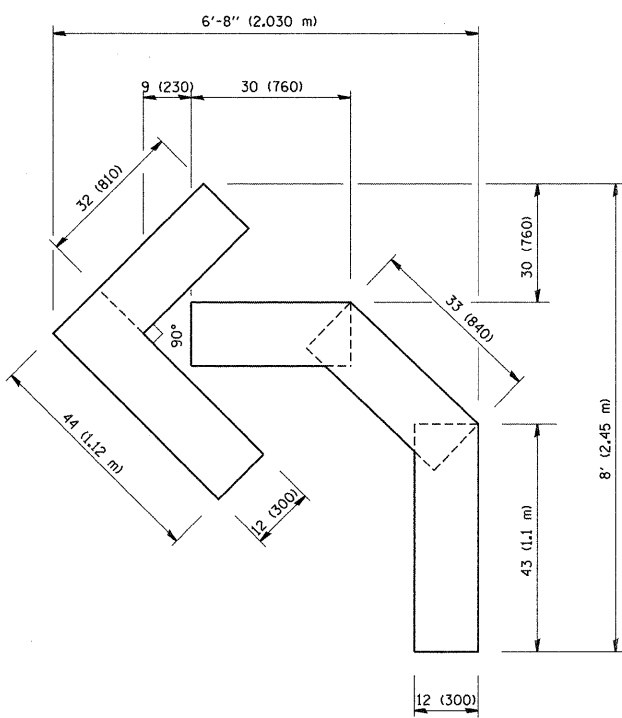

QUANTITY  
 4 (100) LINE = 45.5 ft. (13.9 m)  
 15.2 sq. ft. (1.39 sq. m)

All dimensions are in inches (millimeters) unless otherwise shown.

FILE NAME =  
 W:\diststd\22x34\tcl6.dgn

USER NAME = geglionobt  
 PLOT SCALE = 50,0000 "/ IN.  
 PLOT DATE = 1/4/2008

DESIGNED -  
 DRAWN -  
 CHECKED -  
 DATE - 09-18-94

REVISED -T. RAMMACHER 06-05-96  
 REVISED -T. RAMMACHER 11-04-97  
 REVISED -T. RAMMACHER 03-02-98  
 REVISED -E. GOMEZ 08-28-00

**STATE OF ILLINOIS  
 DEPARTMENT OF TRANSPORTATION**

**PAVEMENT MARKING LETTERS AND SYMBOLS  
 FOR TRAFFIC STAGING**

SCALE: NONE SHEET NO. 1 OF 1 SHEETS STA. TO STA.

F.A.U. RTE. 2534	SECTION 09-00077-00-RS	COUNTY DUPAGE	TOTAL SHEETS 13	SHEET NO. 13
TC-16			CONTRACT NO. 63345	
FED. ROAD DIST. NO. 1 ILLINOIS FED. AID PROJECT ARA-9003(406)				