

THREE OAKS ROAD

STORM PIPES					
NO.	TYPE	DIA	LENGTH	SLOPE	TBF (CY)
P-9	RCP, CL A, T-1	12"	4'	0.78%	0.5

STORM STRUCTURES						
NO.	STATION	OFFSET	TYPE	FRAME TYPE	RIM/EP EL	INVERT
ST-10	26+28	21.5' RT	CATCH BASIN, TYPE C	TY 11V F&G	821.14 EP	818.41 12" N&S

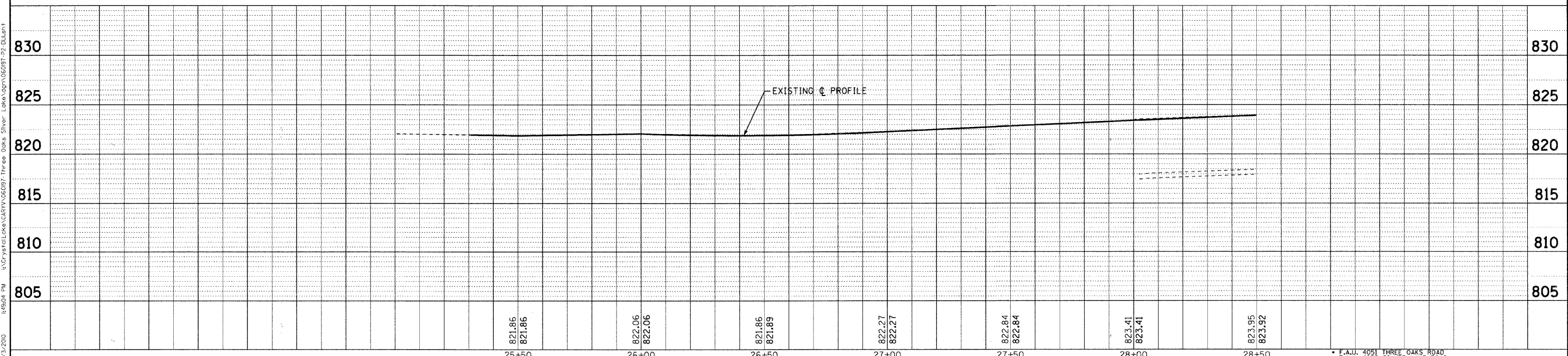

COPYRIGHT © 2010 BY BAXTER & WOODMAN, INC.
 STATE OF ILLINOIS - PROFESSIONAL DESIGN FIRM
 3/2/2010 10:09:04 AM
 ...Baxter\new\p22x24.dwg
 C:\crystal\lakesilver\ARRA\060197-P2-DUI.dwg



DESIGNED - MWP/DSH	REVISED - 01-04-10 PER 100T
DRAWN - MAC	REVISED -
CHECKED - RWL	REVISED -
DATE - 03-01-10	FILE - 060197-P2-DUI.sht

VILLAGE OF CARY, ILLINOIS
THREE OAKS ROAD AND SILVER LAKE ROAD
ARRA INTERSECTION IMPROVEMENTS

DRAINAGE AND UTILITIES	
THREE OAKS ROAD	
SCALE: H: 1"=20' V: 1"=5'	STA. 24+00 TO STA. 28+50

F.A.U. RTE.	SECTION	COUNTY	TOTAL SHEETS	SHEET NO.
	09-00058-00-CH	MCHENRY	53	19
C-91-511-10		CONTRACT NO. 63381		
FED. ROAD DIST. NO. 1 ILLINOIS		FED. AID PROJECT: ARA-90031635		