

COPYRIGHT © 2005 BY BAXTER & WOODMAN, INC.
 10000 W. 110th St., Suite 100, Overland Park, KS 66211
 LICENSE NO. 94-000791 - EXPIRES 4/30/2010
 3/1/2010 15:47 PM
 I:\CrystalLake\CARY\06097-Three Oaks Silver Lake.dgn\06097-P2-XS-SilverLake.dwt

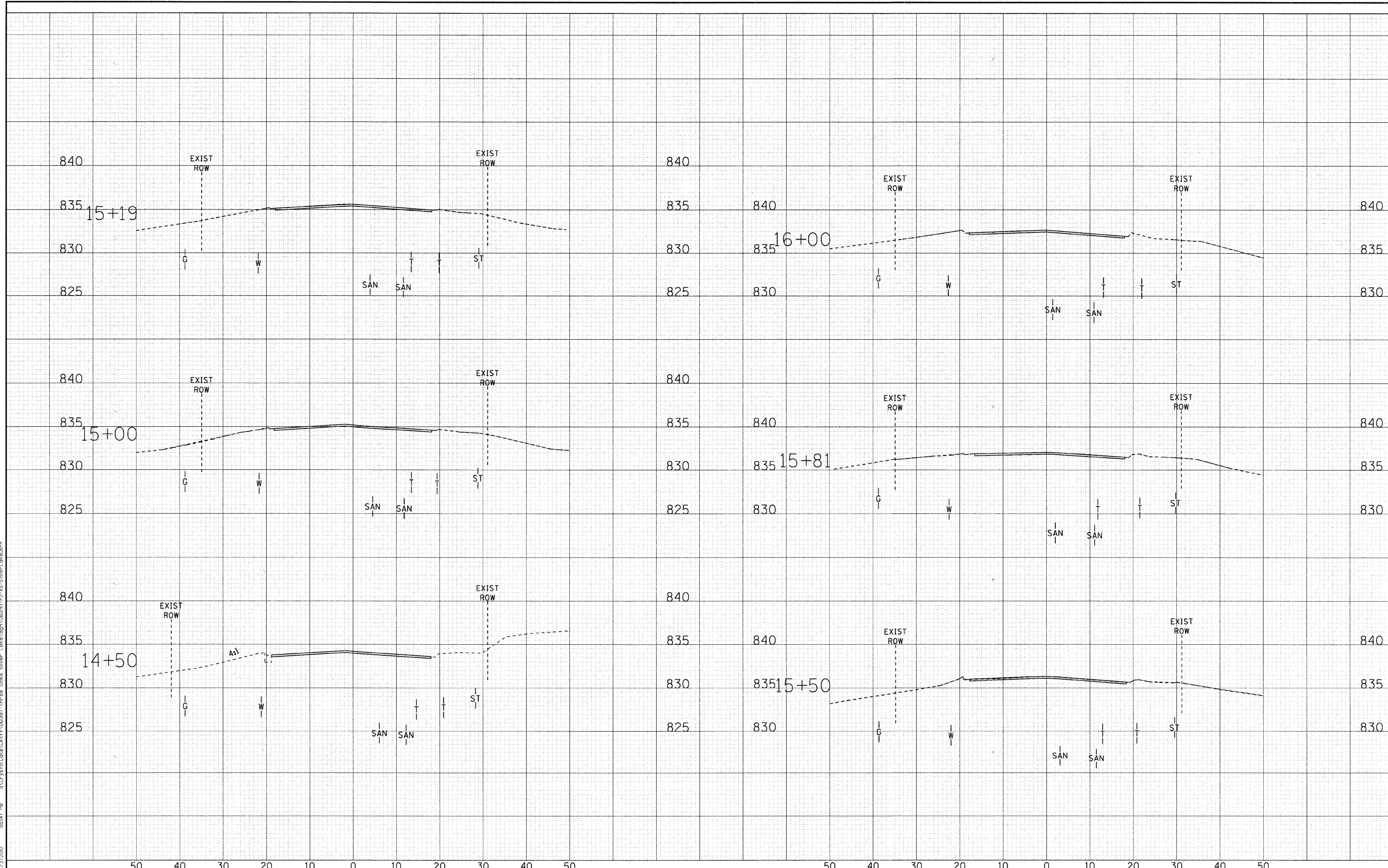

| | |
|--------------------|-----------------------------|
| DESIGNED - MWP/DSH | REVISED - 03-01-10 PER IDOT |
| DRAWN - MAC | REVISED - |
| CHECKED - RWL | REVISED - |
| DATE - 03-01-10 | REVISED - |

VILLAGE OF CARY, ILLINOIS
THREE OAKS ROAD AND SILVER LAKE ROAD
ARRA INTERSECTION IMPROVEMENTS

CROSS SECTIONS
SILVER LAKE ROAD
 STA. 14+50 TO STA. 16+00
 SCALE: H: 1"=10' V: 1"=5'

| F.A.U. RTE. | SECTION | COUNTY | TOTAL SHEETS | SHEET NO. |
|---|----------------|---------|--------------------|-----------|
| • | 09-00058-00-CH | McHENRY | 53 | 53 |
| | C-91-511-10 | | CONTRACT NO. 63381 | |
| FED. ROAD DIST. NO. ILLINOIS FED. AID PROJECT ARA-9003635 | | | | |