

REMOVAL PLAN

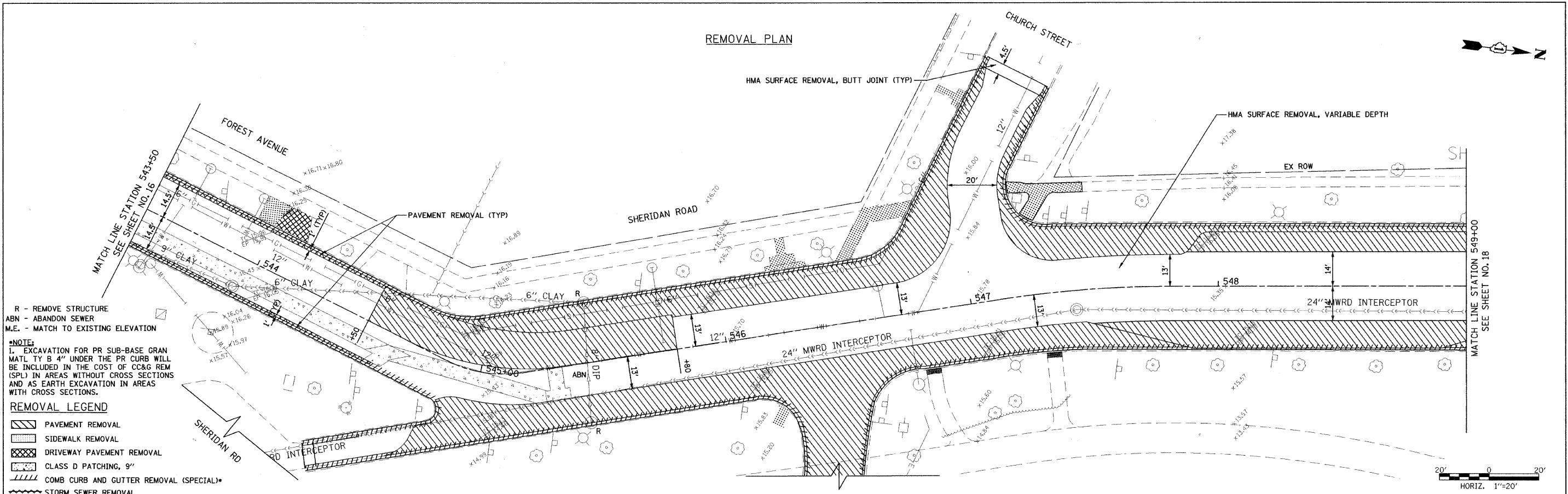

R - REMOVE STRUCTURE
 ABN - ABANDON SEWER
 M.E. - MATCH TO EXISTING ELEVATION

*NOTE:
 1. EXCAVATION FOR PR SUB-BASE GRAN MATL TY B 4" UNDER THE PR CURB WILL BE INCLUDED IN THE COST OF CC&G REM (SPL) IN AREAS WITHOUT CROSS SECTIONS AND AS EARTH EXCAVATION IN AREAS WITH CROSS SECTIONS.

REMOVAL LEGEND

- PAVEMENT REMOVAL
- SIDEWALK REMOVAL
- DRIVEWAY PAVEMENT REMOVAL
- CLASS D PATCHING, 9"
- COMB CURB AND GUTTER REMOVAL (SPECIAL)*
- STORM SEWER REMOVAL

IMPROVEMENT LEGEND

- PCC DRIVEWAY PAVEMENT, 6" OR 8" (RESIDENTIAL APRONS 6" / ALLEYS 8")
- HMA DRIVEWAY PAVEMENT, 6"
- PCC SIDEWALK 5", SPECIAL
- REMOVE AND RELAY BRICK SIDEWALK
- BRICK DRIVEWAY REMOVAL AND REPLACEMENT
- DETECTABLE WARNINGS
- DEPRESSED COMB. CONCRETE CURB AND GUTTER

NOTE:
 1. 5' TRANSITION FROM B-6.12 C&G TO MATCH EX TO BE PAID FOR AS COMB CONC C&G TY B-6.12 (SPECIAL)

2. SEE PAVING DETAILS FOR MILLING DEPTHS AND HMA LEVEL BINDER AND BINDER DEPTHS (SHEETS 40 AND 41)

3. INSTALL STRIP REFLECTIVE CRACK CONTROL TREATMENT ALONG EXISTING LONGITUDINAL PAVEMENT JOINTS

IMPROVEMENT PLAN

PROP. CURVE SHER3-3
 PI STA. = 545+01.75
 $\Delta = 35^\circ 37' 13''$ (LT)
 $D = 114^\circ 35' 30''$
 $R = 50.00'$
 $T = 16.06'$
 $L = 31.08'$
 $E = 2.52'$
 $\theta = \text{---}$
 $T.R. = \text{---}$
 $S.E. RUN = \text{---}$
 $P.C. STA = 544+85.69$
 $P.T. STA = 545+16.78$

HMA SURFACE COURSE, MIX "D" N70, 1 1/2"
 HMA BINDER COURSE, IL-19.0, N70 (2 1/4" & VAR)
 LEVELING BINDER (MACHINE METHOD), N70 (3/4" & VAR)

RECONSTRUCT FROM STA. 544+50 TO 545+80 LT
 HMA PAVEMENT (FULL DEPTH) 10.5"
 HMA SURFACE COURSE, MIX "D", N70, 1 1/2"
 HMA BINDER COURSE, IL-19.0, N70, 9"
 AGGREGATE SUBGRADE 12"

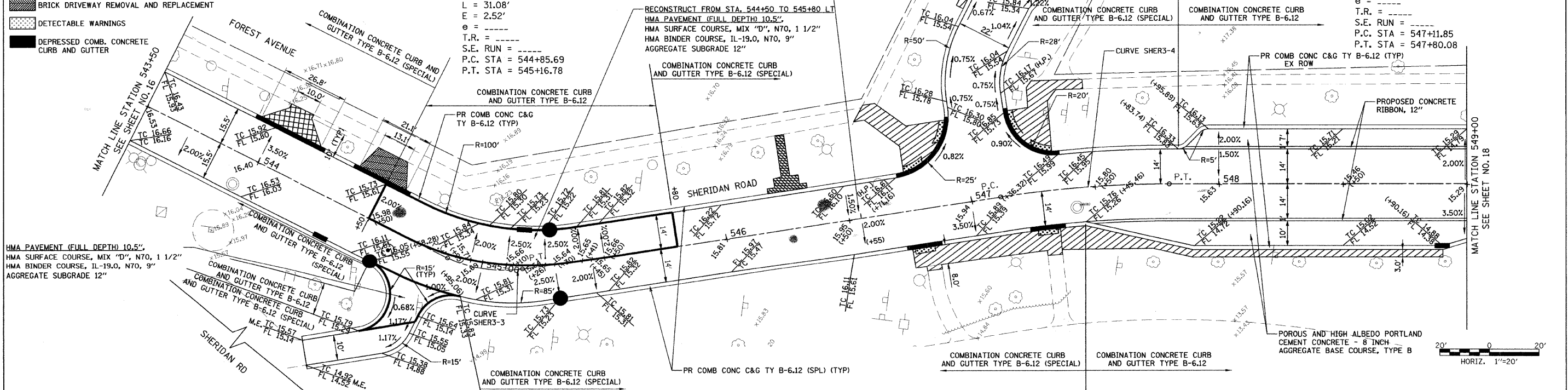

PROP. CURVE SHER3-4
 PI STA. = 547+46.03
 $\Delta = 8^\circ 41' 16''$ (RT)
 $D = 12^\circ 43' 57''$
 $R = 450.00'$
 $T = 34.18'$
 $L = 68.23'$
 $E = 1.30'$
 $\theta = \text{---}$
 $T.R. = \text{---}$
 $S.E. RUN = \text{---}$
 $P.C. STA = 547+11.85$
 $P.T. STA = 547+80.08$

FILE NAME = #FILE#	USER NAME = #USER#	DESIGNED - CEC	REVISIONS	STATE OF ILLINOIS DEPARTMENT OF TRANSPORTATION	SHERIDAN ROAD / FOREST AVENUE REMOVAL AND IMPROVEMENT PLAN	F.A.U. RTE. 2865	SECTION 08-00250-02-PV	COUNTY COOK	TOTAL SHEETS 79	SHEET NO. 17	
	PLOT SCALE = #SCALE#	DRAWN - NFT	REVISED -			SCALE: SHEET NO. 5 OF 10 SHEETS STA. TO STA.	FED. ROAD DIST. NO.	ILLINOIS FED. AID PROJECT	CONTRACT NO. 63417		
	PLOT DATE = #DATE#	CHECKED - DWB	REVISED -								
		DATE - 04/09/2010	REVISED -								