

F.A. RTE.	SECTION	COUNTY	TOTAL SHEETS	SHEET NO.
09-00099-00-BT	DUPAGE	30	1	

STATE OF ILLINOIS
DEPARTMENT OF TRANSPORTATION
DIVISION OF HIGHWAYS
**PLANS FOR PROPOSED
FEDERAL AID HIGHWAY**

**BIKE PATH CONSTRUCTION
SECTION NO. 09-00099-00-BT
PROJECT NO. CMM-9003 (650)
JOB NO. C-91-715-09
VILLAGE OF DOWNERS GROVE
DuPAGE COUNTY**

INDEX OF SHEETS

DESCRIPTION

DESCRIPTION	SHEET NO.
TITLE SHEET	1
GENERAL NOTES AND IDOT STANDARDS	2
SUMMARY OF QUANTITIES	3
PROPOSED AND EXISTING TYPICAL SECTIONS	4
ALIGNMENT, TIES AND BENCHMARKS	5-6
EARTHWORK SCHEDULE	7
BIKE PLAN SIGNAGE	8-14
BIKE PATH PLAN AND PROFILE	15-19
CONSTRUCTION DETAILS	20
TRAFFIC CONTROL AND PROTECTION FOR SIDE ROADS, INTERSECTIONS, AND DRIVEWAYS	21
CURB OR CURB AND GUTTER REMOVAL AND REPLACEMENT	22
CROSS SECTIONS	23-30

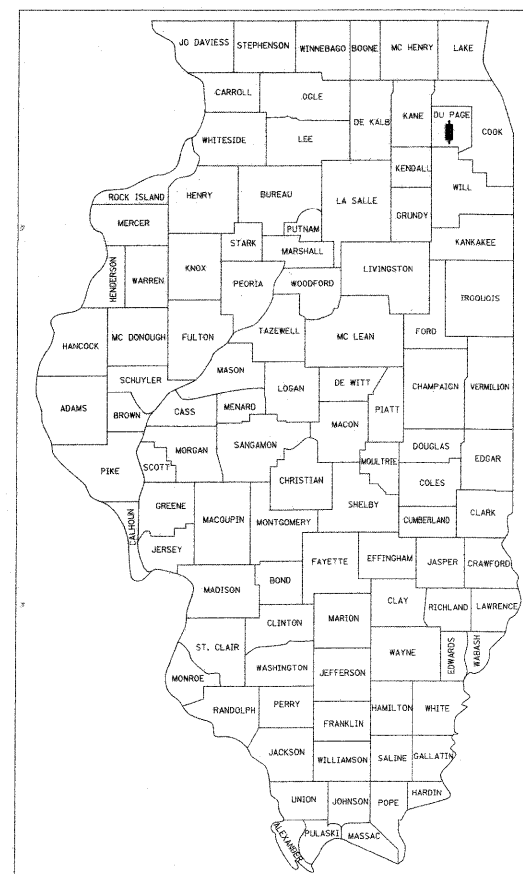

LOCATION OF SECTION INDICATED THIS: - [Black Rectangle]

STATE OF ILLINOIS
DEPARTMENT OF TRANSPORTATION
DIVISION OF HIGHWAYS

APPROVED *Daniel Newton* 3/17, 2010
VILLAGE OF DOWNERS GROVE, DIRECTOR OF PUBLIC WORKS

PASSED *March 31* 2010
Chris Heibel
DISTRICT 1 ENGINEER OF LOCAL ROADS AND STREETS
RELEASING FOR BID
BASED ON LIMITED
REVIEW *April 2* 2010
Diane M. O'Keefe
DEPUTY DIRECTOR OF HIGHWAYS, REGION 1 ENGINEER



Jonathan O'Connell 3/17/2010
ENGINEER DATE
JONATHAN O'CONNELL
ILLINOIS REGISTRATION No. 062-059191
EXPIRATION DATE: 11/30/2011

FIELD ENGINEER: MARILYN SOLOMON
201 W. CENTER COURT
SCHAMBURG, ILLINOIS 60196-1096
(847) 705-4407

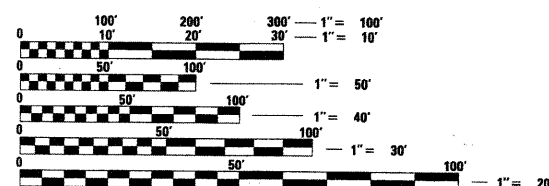

FULL SIZE PLANS HAVE BEEN PREPARED USING STANDARD ENGINEERING SCALES. REDUCED SIZED PLANS WILL NOT CONFORM TO STANDARD SCALES. IN MAKING MEASUREMENTS ON REDUCED PLANS, THE ABOVE SCALES MAY BE USED.

J.U.L.I.E.
JOINT UTILITY LOCATION INFORMATION FOR EXCAVATION
8-1-1 OR 1-800-892-0123

CB CHRISTOPHER B. BURKE ENGINEERING LTD.
9575 West Higgins Road, Suite 600
Rosemont, Illinois 60018 (847) 823-0500

CONTRACT NO. 63451

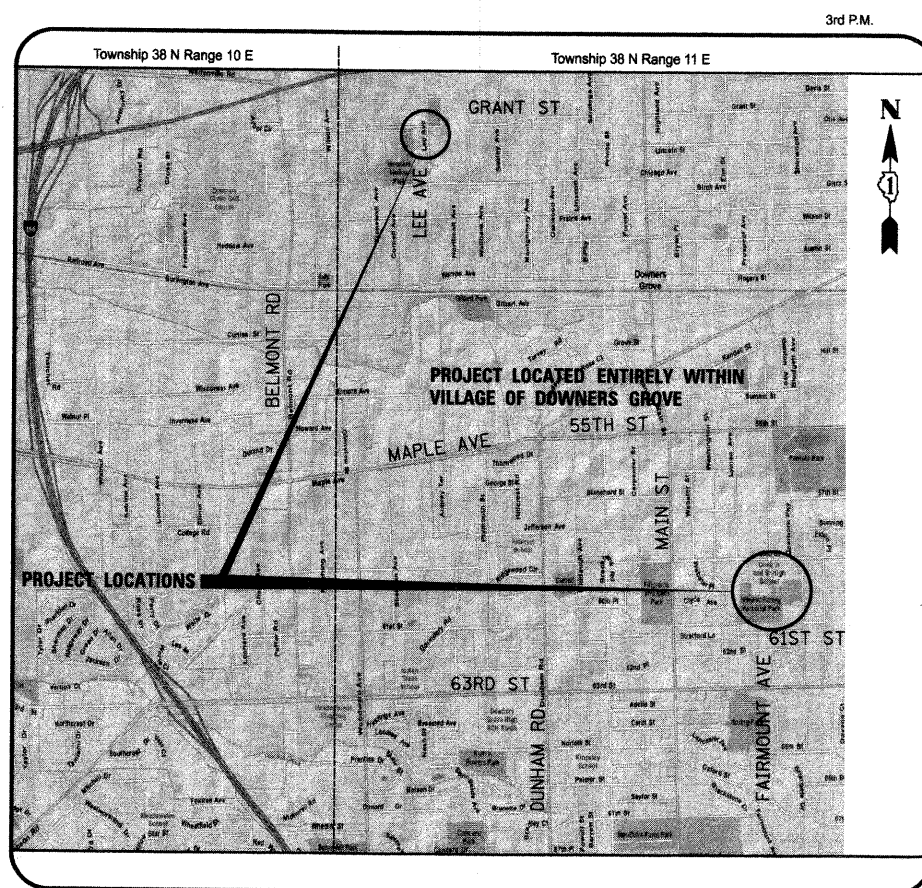

LOCATION MAP

N.T.S.
GROSS LENGTH OF PROJECT = 35,578 FEET (6.74 MI)
NET LENGTH OF PROJECT = 35,578 FEET (6.74 MI)
THIS IS THE COMBINED LENGTH OF ALL PROPOSED
BIKE PATHS AND THE STREETS THAT WILL BE SIGNED.