

EXISTING TOPOGRAPHY

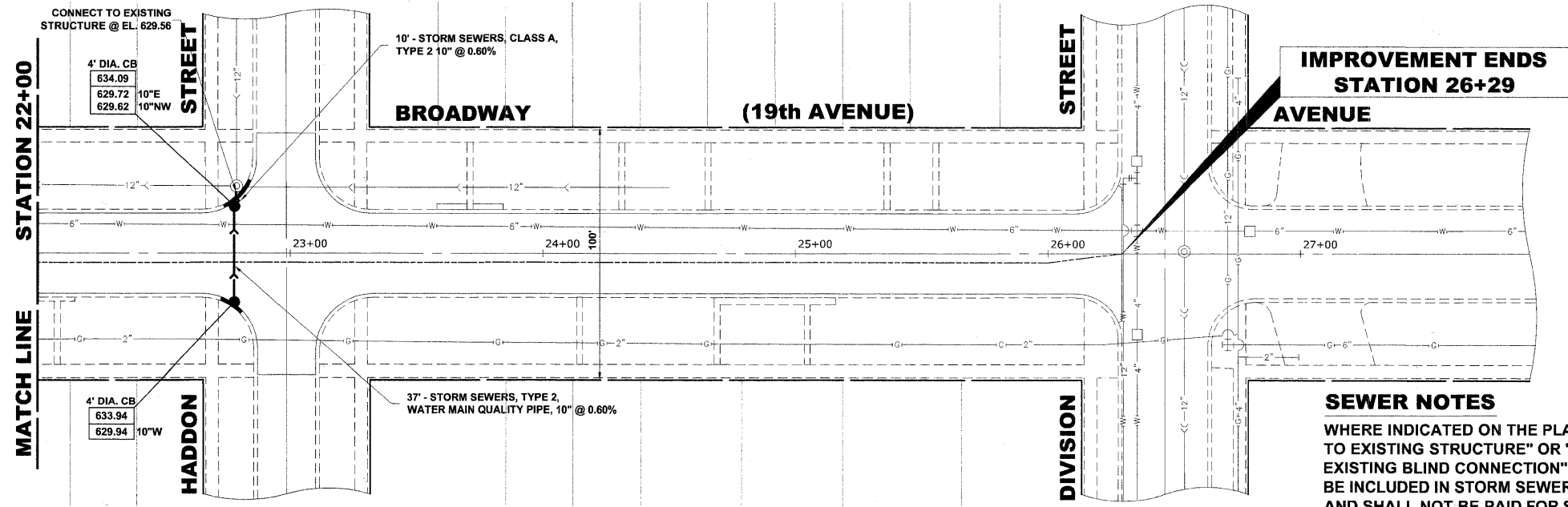

SEWER NOTES
 WHERE INDICATED ON THE PLANS AS "CONNECT TO EXISTING STRUCTURE" OR "CONNECT TO EXISTING BLIND CONNECTION", THE COST SHALL BE INCLUDED IN STORM SEWERS, CLASS A, TYPE 2 10" AND SHALL NOT BE PAID FOR SEPARATELY.

PROPOSED IMPROVEMENT

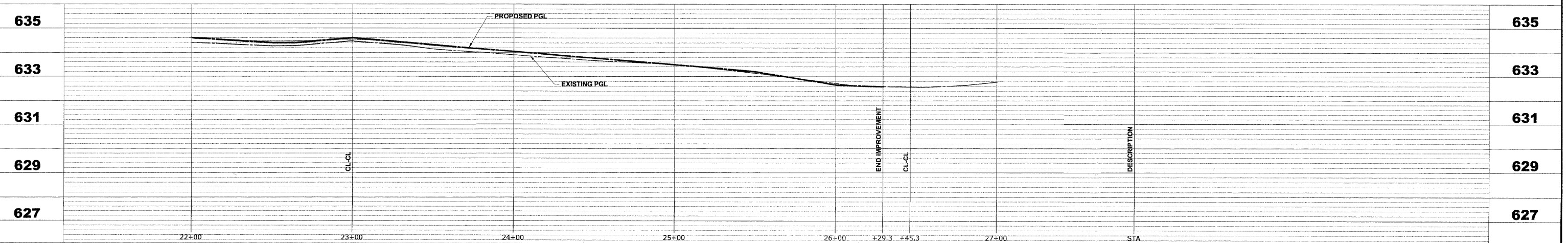

C:\projects\60090001 - Broadway Ave Reconstruction\BROADWAY AVE_BROADWAY AVE.dwg Apr 19, 2010 - 11:57am

HANCOCK ENGINEERING
 CH2Hill Engineers
 Municipal Consultants
 Established 1911

| | | |
|--------------|--------------------|-----------|
| USER NAME - | DESIGNED - WOP | REVISED - |
| PLOT SCALE - | DRAWN - MK/LEV/DMM | REVISED - |
| PLOT DATE - | CHECKED - WOP | REVISED - |
| | DATE - 3-29-10 | REVISED - |

**STATE OF ILLINOIS
 DEPARTMENT OF TRANSPORTATION**

**BROADWAY AVENUE (19th AVENUE)
 DRAINAGE AND UTILITIES PLAN AND PROFILE**
 SCALE: 1"=30'H. & 1"=2'V. SHEET NO. 4 OF 4 SHEETS STA. 22+00 TO STA. 26+29

| | | | | |
|--------------------------------|---------------------------|--|--------------------|-----------------|
| ROUTE NO. 2406 | SECTION 09-00114-00-FP | COUNTY COOK | TOTAL SHEETS 33 | SHEET NO. 19 |
| FIELD BOOK NO. 1588/AERIALS/LL | | CONTRACT NO. 63455 | | |
| FED. ROAD DIST. NO. 1 | | ILLINOIS FED. AID PROJECT ARA-M-9003 (S16) | | |

E.H.E. PROJECT NO. 600-09-00101