

SN 052-0051
 EXSITING VERTICAL CLEARANCE
 SB - 16'-05"
 NB - 16'-07"
 PROPOSED VERTICAL CLEARANCE
 SB - 16'-00"
 NB - 16'-02"

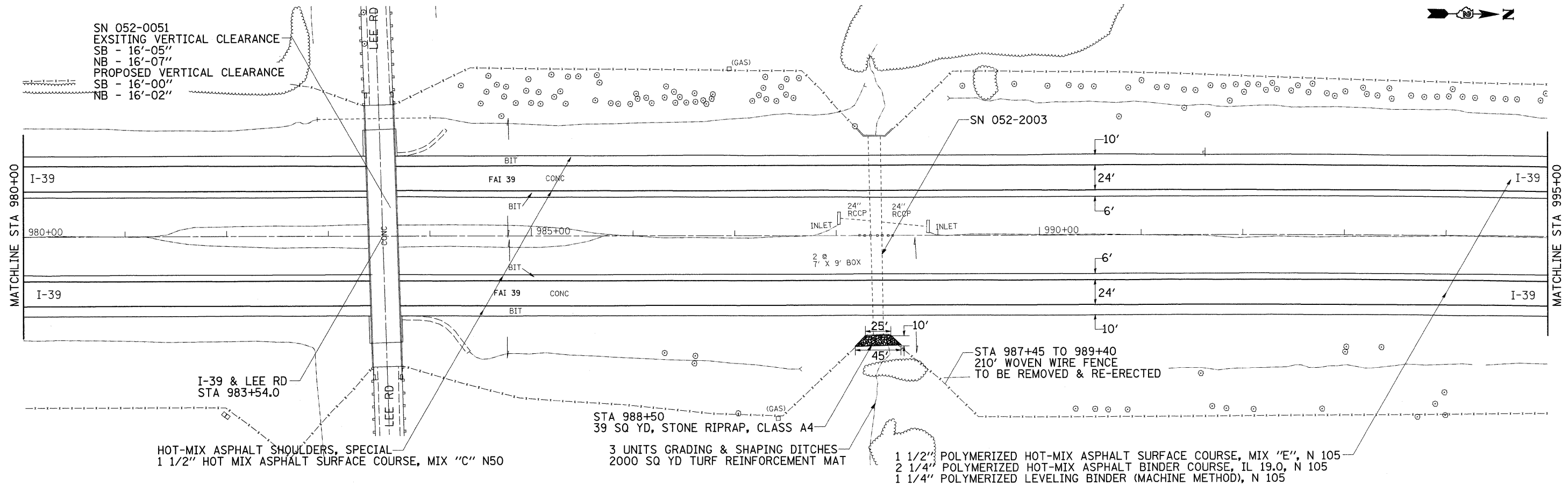

HOT-MIX ASPHALT SHOULDERS, SPECIAL
 1 1/2" HOT MIX ASPHALT SURFACE COURSE, MIX "C" N50

STA 988+50
 39 SQ YD, STONE RIPRAP, CLASS A4
 3 UNITS GRADING & SHAPING DITCHES
 2000 SQ YD TURF REINFORCEMENT MAT

1 1/2" POLYMERIZED HOT-MIX ASPHALT SURFACE COURSE, MIX "E", N 105
 2 1/4" POLYMERIZED HOT-MIX ASPHALT BINDER COURSE, IL 19.0, N 105
 1 1/4" POLYMERIZED LEVELING BINDER (MACHINE METHOD), N 105

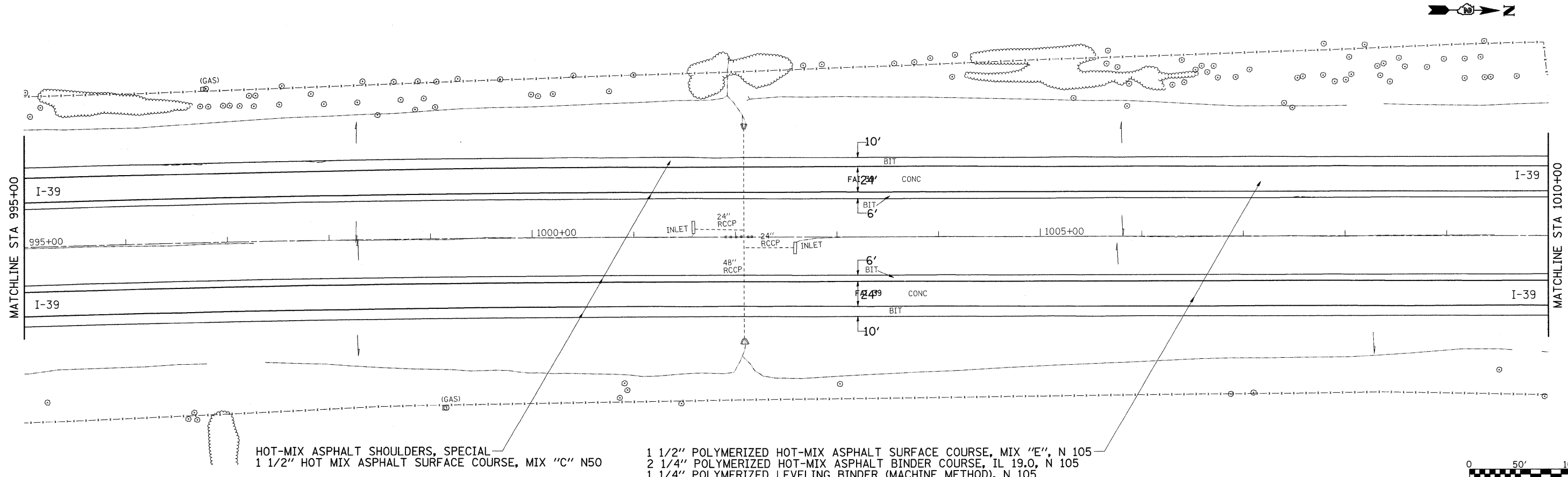

HOT-MIX ASPHALT SHOULDERS, SPECIAL
 1 1/2" HOT MIX ASPHALT SURFACE COURSE, MIX "C" N50

1 1/2" POLYMERIZED HOT-MIX ASPHALT SURFACE COURSE, MIX "E", N 105
 2 1/4" POLYMERIZED HOT-MIX ASPHALT BINDER COURSE, IL 19.0, N 105
 1 1/4" POLYMERIZED LEVELING BINDER (MACHINE METHOD), N 105

FILE NAME =	USER NAME = dossed	DESIGNED -	REVISED -
ct:\pwork\PIWIDOT\DOSSDD\0149531\0205609-ahh-plm.dgn		DRAWN -	REVISED -
PLOT SCALE = 50.0000' / IN.		CHECKED -	REVISED -
PLOT DATE = Fri Mar 26 08:31:24 2010		DATE -	REVISED -

**STATE OF ILLINOIS
 DEPARTMENT OF TRANSPORTATION**

I-39 PLAN SHEET			
SCALE:	SHEET NO.	OF SHEETS	STA. TO STA.

F.A.I. RTE.	SECTION	COUNTY	TOTAL SHEETS	SHEET NO.
39	(103-1, 103-2)RS	LEE	313	115
CONTRACT NO. 64E97				
ILLINOIS FED. AID PROJECT				

