

TRAFFIC CONTROL PLAN

Structure 071-0015 STAGE I

Refer to Standard 701321 for additional signs, details & devices

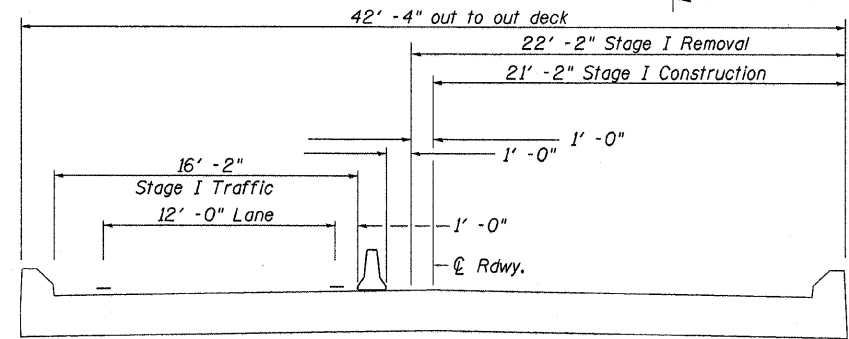
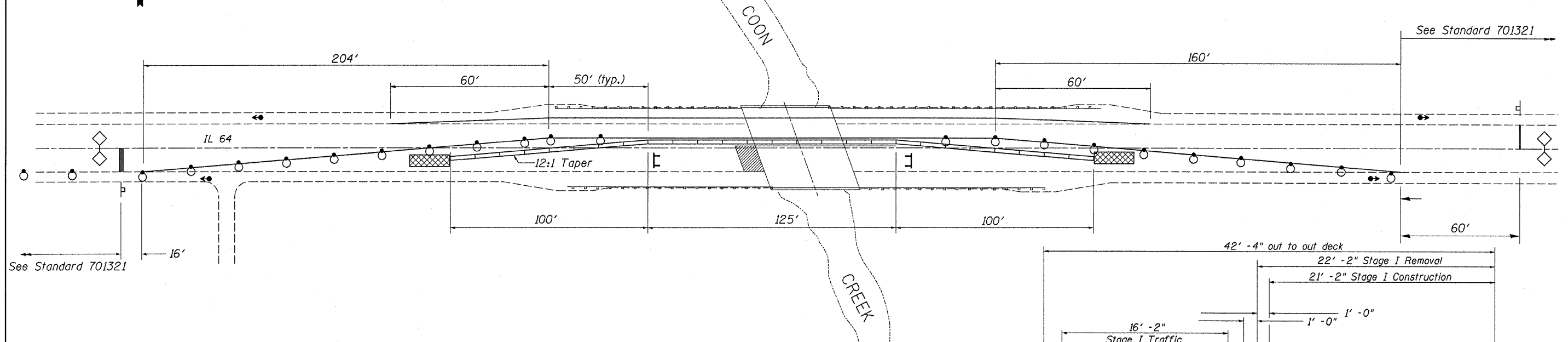

CROSS SECTION
Looking East

Temporary Pavement Marking Line 4"

Stage I	Feet
South edgeline	
West Taper	204
Bridge Tangent	225
East Taper	160
North edgeline	
West Taper	60
Bridge Tangent	225
East Taper	60
Stage II	
South edgeline	
West Taper	60
Bridge Tangent	225
East Taper	60
North edgeline	
West Taper	160
Bridge Tangent	225
East Taper	204
Total	1868 Feet

Temporary Pavement Marking Line 24"

Stop Bars	Feet
IL 64 EB	12
IL 64 WB	12
Total	24 Feet

Temporary Concrete Barrier

Stage I	Feet
West Taper	100
Bridge Tangent	125
East Taper	100
Total	325 Feet

Pavement Marking Removal

	Feet
Stage I	345
Stage II	345
∅	100
Total	790 Feet

Temporary Impact Attenuator

Stage I	Each
West	1
East	1
Total	2 Each

Temporary Bridge Traffic Signals

Stage I & II	Each
	1
Total	1 Each

Temporary Rumble Strips

Stage I & II	Each
East	3
West	3
Total	6 Each