

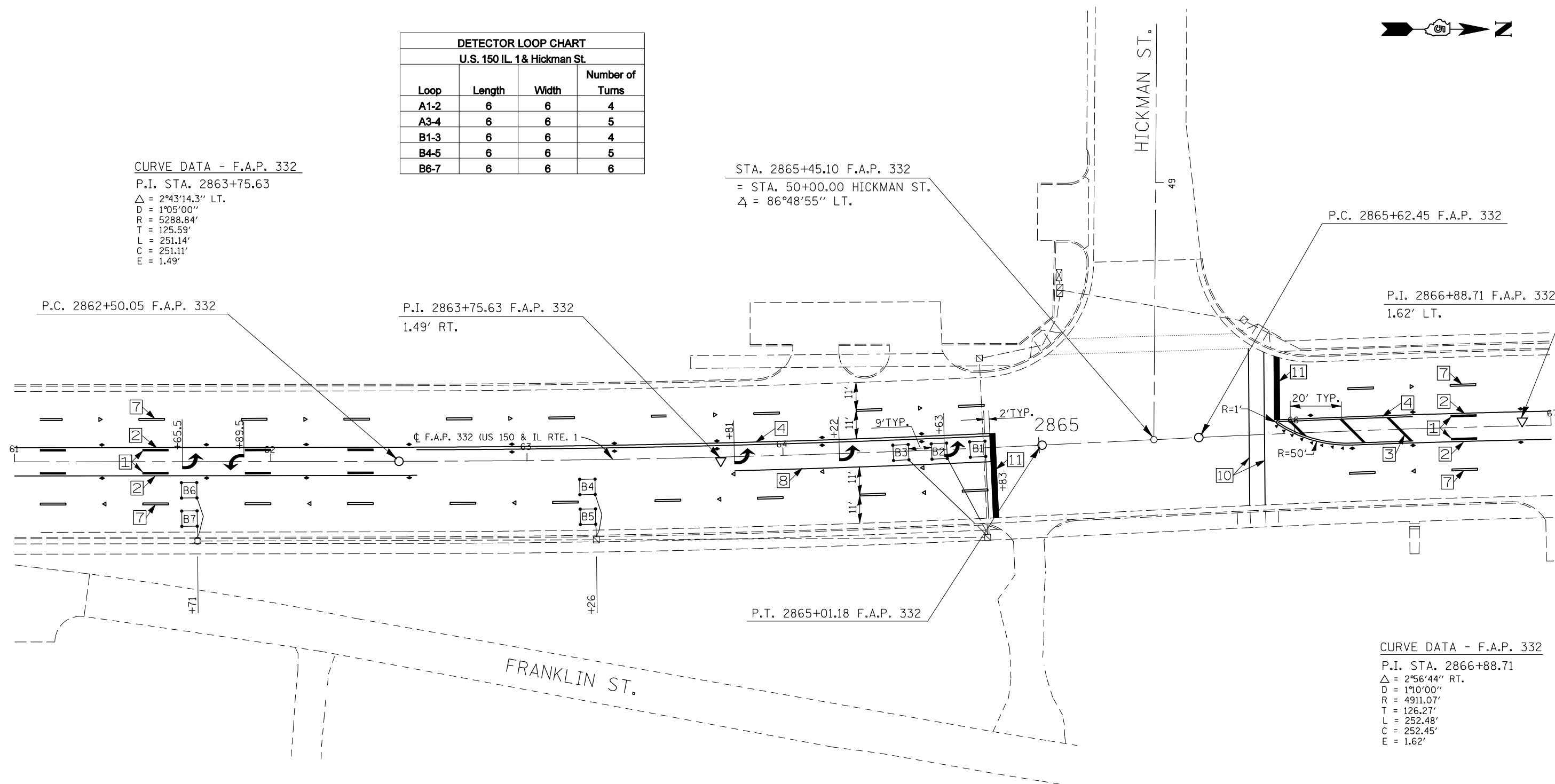

DETECTOR LOOP CHART			
U.S. 150 IL. 1 & Hickman St.			
Loop	Length	Width	Number of Turns
A1-2	6	6	4
A3-4	6	6	5
B1-3	6	6	4
B4-5	6	6	5
B6-7	6	6	6

CURVE DATA - F.A.P. 332
 P.I. STA. 2863+75.63
 $\Delta = 2^{\circ}43'14.3''$ LT.
 $D = 1^{\circ}05'00''$
 $R = 5288.84'$
 $T = 125.59'$
 $L = 251.14'$
 $C = 251.11'$
 $E = 1.49'$

STA. 2865+45.10 F.A.P. 332
 = STA. 50+00.00 HICKMAN ST.
 $\Delta = 86^{\circ}48'55''$ LT.



CURVE DATA - F.A.P. 332
 P.I. STA. 2866+88.71
 $\Delta = 2^{\circ}56'44''$ RT.
 $D = 1^{\circ}10'00''$
 $R = 4911.07'$
 $T = 126.27'$
 $L = 252.48'$
 $C = 252.45'$
 $E = 1.62'$

TYPICAL PAVEMENT MARKING LEGEND

- | | |
|-----------------------------|-------------------------|
| 1 4" SKIP-DASH (YELLOW) | 7 4" SKIP-DASH (WHITE) |
| 2 4" SOLID (YELLOW) | 8 4" SOLID (WHITE) |
| 3 12" DIAGONAL (YELLOW) | 9 12" DIAGONAL (WHITE) |
| 4 4" DOUBLE YELLOW (NARROW) | 10 6" SOLID (WHITE) |
| 5 4" DOUBLE YELLOW (WIDE) | 11 24" STOP BAR (WHITE) |
| 6 | 12 8" SOLID (WHITE) |
- ◆ AMBER TWO-WAY MARKER ◁ CRYSTAL ONE-WAY MARKER
 ◀ AMBER ONE-WAY MARKER

FILE NAME =	USER NAME = hoganbj	DESIGNED -	REVISED -
et\p\work\PWIDOT\HOGANBJ\d0185087\d574709.sht\pmk.dgn		DRAWN -	REVISED -
PLOT SCALE = 40.0000' / IN.		CHECKED -	REVISED -
PLOT DATE = 3/15/2010		DATE -	REVISED -

**STATE OF ILLINOIS
 DEPARTMENT OF TRANSPORTATION**

PLAN SHEETS

SCALE: SHEET NO. 21 OF 29 SHEETS STA. 2861+00 TO STA. 2867+00

F.A.P. RTE.	SECTION	COUNTY	TOTAL SHEETS	SHEET NO.
332	47RS-11	VERMILION	56	40
CONTRACT NO. 70709				
ILLINOIS FED. AID PROJECT				