

F.A. RTE.	SECTION	COUNTY	TOTAL SHEETS	SHEET NO.
*	**	SANGAMON	363	113
STA. 23+00.00		TO STA. 29+00.00		
FED. ROAD DIST. NO.		ILLINOIS FED. AID PROJECT		
CONTRACT NO. 72088				
* F.A.I. 72, F.A.P. 67, F.A.P. 75 & F.A.P. 668				
** D-6 SPFLD-CLRLAKE DIRKSEN 2002				

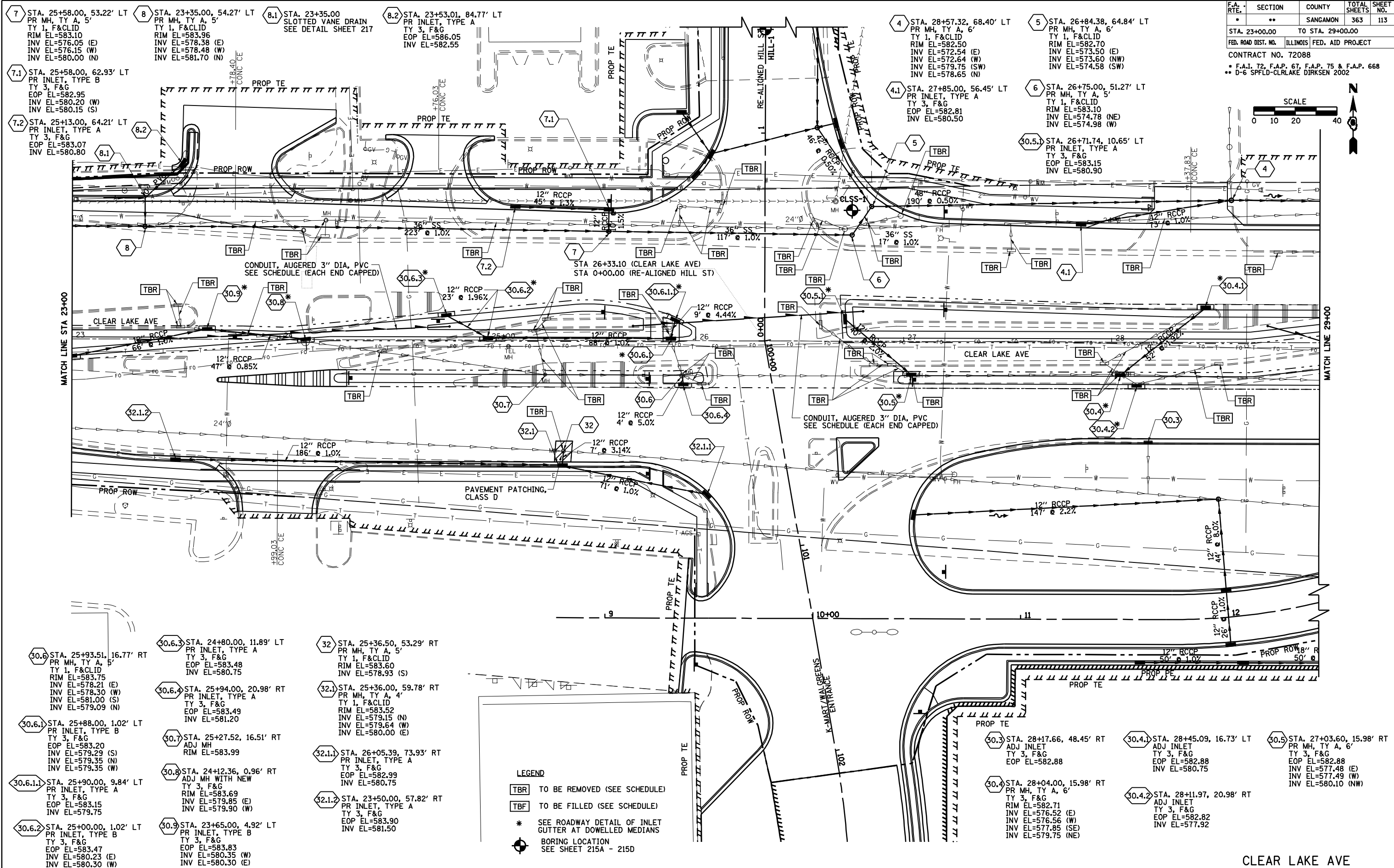

LEGEND

TBR TO BE REMOVED (SEE SCHEDULE)

TBF TO BE FILLED (SEE SCHEDULE)

* SEE ROADWAY DETAIL OF INLET GUTTER AT DOWELLED MEDIANS

⊙ BORING LOCATION SEE SHEET 215A - 215D

7 STA. 25+58.00, 53.22' LT
PR MH, TY A, 5'
TY 1, F&CLID
RIM EL=583.10
INV EL=576.05 (E)
INV EL=576.15 (W)
INV EL=580.00 (N)

7.1 STA. 25+58.00, 62.93' LT
PR INLET, TYPE B
TY 3, F&G
EOP EL=582.95
INV EL=580.20 (W)
INV EL=580.15 (S)

7.2 STA. 25+13.00, 64.21' LT
PR INLET, TYPE A
TY 3, F&G
EOP EL=583.07
INV EL=580.80

8 STA. 23+35.00, 54.27' LT
PR MH, TY A, 5'
TY 1, F&CLID
RIM EL=583.96
INV EL=578.38 (E)
INV EL=578.48 (W)
INV EL=581.70 (N)

8.1 STA. 23+35.00
SLOTTED VANE DRAIN
SEE DETAIL SHEET 217

8.2 STA. 23+53.01, 84.77' LT
PR INLET, TYPE A
TY 3, F&G
EOP EL=586.05
INV EL=582.55

4 STA. 28+57.32, 68.40' LT
PR MH, TY A, 6'
TY 1, F&CLID
RIM EL=582.50
INV EL=572.54 (E)
INV EL=572.64 (W)
INV EL=579.75 (SW)
INV EL=578.65 (N)

5 STA. 26+84.38, 64.84' LT
PR MH, TY A, 6'
TY 1, F&CLID
RIM EL=582.70
INV EL=573.50 (E)
INV EL=573.60 (NW)
INV EL=574.58 (SW)

4.1 STA. 27+85.00, 56.45' LT
PR INLET, TYPE A
TY 3, F&G
EOP EL=582.81
INV EL=580.50

6 STA. 26+75.00, 51.27' LT
PR MH, TY A, 5'
TY 1, F&CLID
RIM EL=583.10
INV EL=574.78 (NE)
INV EL=574.98 (W)

30.5.1 STA. 26+71.74, 10.65' LT
PR INLET, TYPE A
TY 3, F&G
EOP EL=583.15
INV EL=580.90

30.6 STA. 25+93.51, 16.77' RT
PR MH, TY A, 5'
TY 1, F&CLID
RIM EL=583.75
INV EL=578.21 (E)
INV EL=578.30 (W)
INV EL=581.00 (S)
INV EL=579.09 (N)

30.6.1 STA. 25+88.00, 1.02' LT
PR INLET, TYPE B
TY 3, F&G
EOP EL=583.20
INV EL=579.29 (S)
INV EL=579.35 (N)
INV EL=579.35 (W)

30.6.1.1 STA. 25+90.00, 9.84' LT
PR INLET, TYPE A
TY 3, F&G
EOP EL=583.15
INV EL=579.75

30.6.2 STA. 25+00.00, 1.02' LT
PR INLET, TYPE B
TY 3, F&G
EOP EL=583.47
INV EL=580.23 (E)
INV EL=580.30 (W)

30.6.3 STA. 24+80.00, 11.89' LT
PR INLET, TYPE A
TY 3, F&G
EOP EL=583.48
INV EL=580.75

30.6.4 STA. 25+94.00, 20.98' RT
PR INLET, TYPE A
TY 3, F&G
EOP EL=583.49
INV EL=581.20

30.7 STA. 25+27.52, 16.51' RT
ADJ MH
RIM EL=583.99

30.8 STA. 24+12.36, 0.96' RT
ADJ MH WITH NEW
TY 3, F&G
RIM EL=583.69
INV EL=579.85 (E)
INV EL=579.90 (W)

30.9 STA. 23+65.00, 4.92' LT
PR INLET, TYPE B
TY 3, F&G
EOP EL=583.83
INV EL=580.35 (W)
INV EL=580.30 (E)

32 STA. 25+36.50, 53.29' RT
PR MH, TY A, 5'
TY 1, F&CLID
RIM EL=583.60
INV EL=578.93 (S)

32.1 STA. 25+36.00, 59.78' RT
PR MH, TY A, 4'
TY 1, F&CLID
RIM EL=583.52
INV EL=579.15 (N)
INV EL=579.64 (E)
INV EL=580.00 (E)

32.1.1 STA. 26+05.39, 73.93' RT
PR INLET, TYPE A
TY 3, F&G
EOP EL=582.99
INV EL=580.75

32.1.2 STA. 23+50.00, 57.82' RT
PR INLET, TYPE A
TY 3, F&G
EOP EL=583.90
INV EL=581.50