

F.A.P. 72, F.A.P. 67, F.A.P. 75 & F.A.P. 668
 ** D-6 SPFLD-CLRLAKE DIRKSEN 2002

F.A.P. RTE.	SECTION	COUNTY	TOTAL SHEETS	SHEET NO.
*	**	SANGAMON	363	159
STA.		TO STA.		
FED. ROAD DIST. NO.	ILLINOIS	FED. AID PROJECT		
CONTRACT NO. 72088				

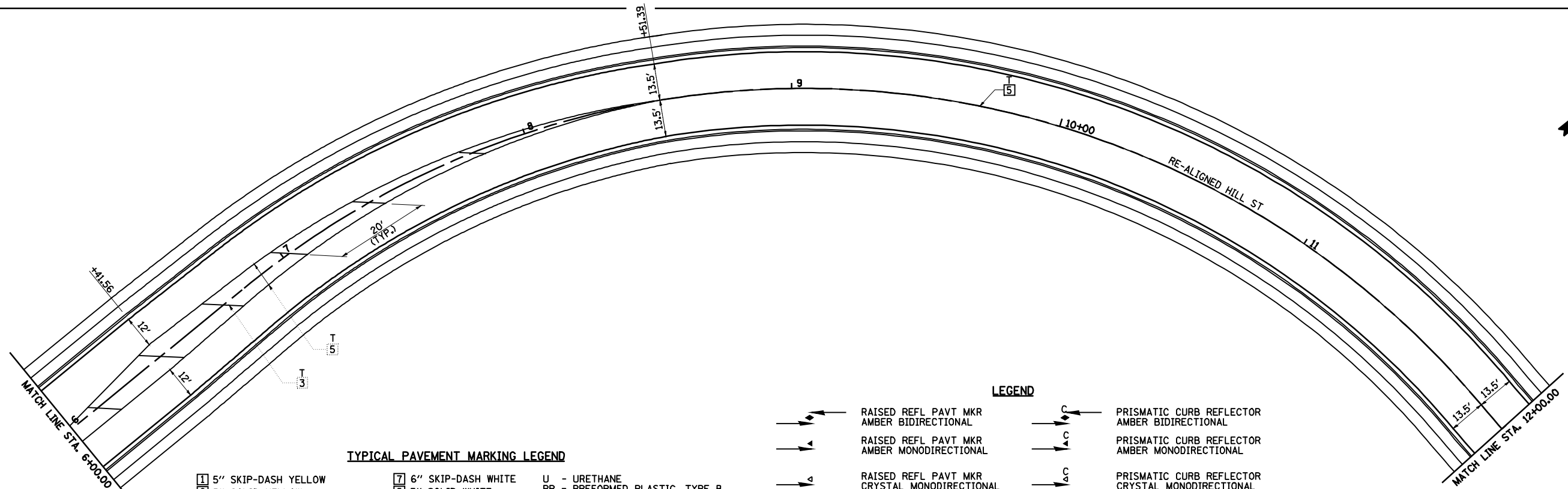
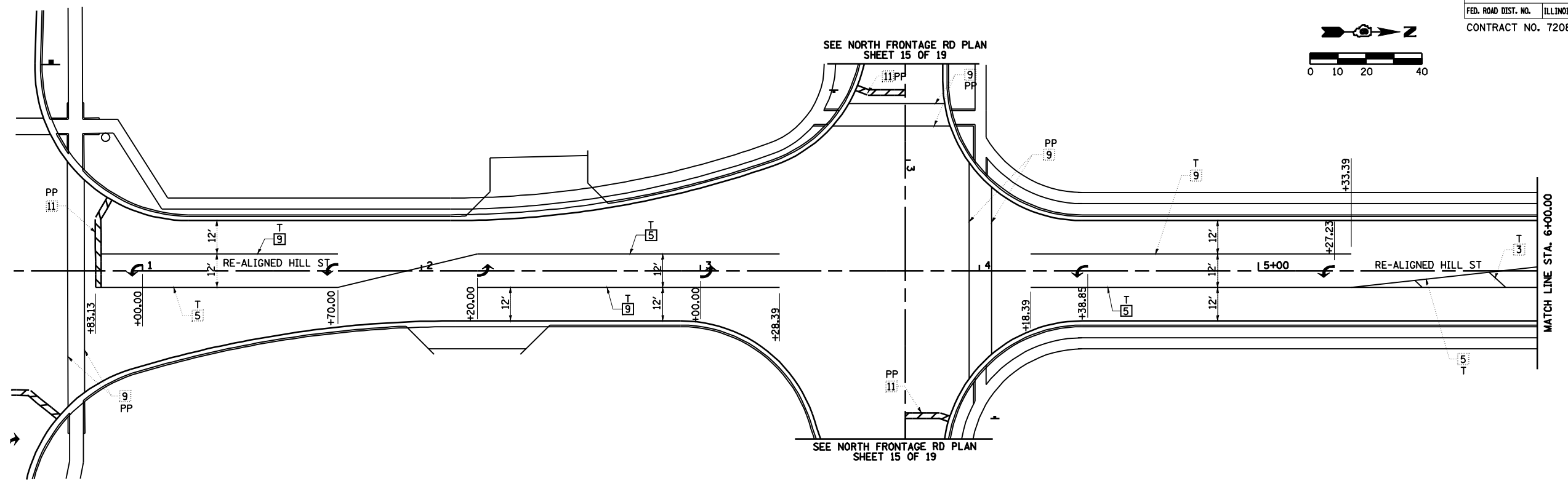
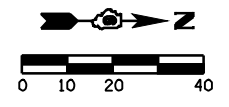

TYPICAL PAVEMENT MARKING LEGEND

1 5" SKIP-DASH YELLOW	7 6" SKIP-DASH WHITE
2 5" SOLID YELLOW	8 5" SOLID WHITE
3 12" DIAGONAL YELLOW	9 6" SOLID WHITE
4 5" DOUBLE YELLOW NARROW	10 8" SOLID WHITE
5 5" DOUBLE YELLOW WIDE	11 24" STOP BAR WHITE
6 5" SKIP-DASH WHITE	12 12" DIAGONAL WHITE

U - URETHANE
 PP - PREFORMED PLASTIC, TYPE B
 T - THERMOPLASTIC
 P - PAINT
 ALL TRAFFIC ARROWS ARE "PP"

LEGEND



SEE STANDARDS 780001 & 781001 AND DISTRICT PAVEMENT MARKING DETAILS FOR ADDITIONAL DETAILS FOR PAVEMENT MARKING AND RAISED REFLECTIVE PAVEMENT MARKERS.

REVISIONS	
NAME	DATE

ILLINOIS DEPARTMENT OF TRANSPORTATION

**PAVEMENT MARKING PLAN
HILL STREET**

SCALE: VERT. 1"=10'
 HORIZ. 1"=40'
 DATE 08/05

DRAWN BY MLO
 CHECKED BY SJK