

TRAFFIC SIGNAL QUANTITIES

LOCATION:	QUANTITY	UNIT	ITEM
CLEAR LAKE & DIRKSEN	52.5	SQ FT	SIGN PANEL, TYPE II
	1	EACH	SERVICE INSTALLATION, TYPE A
	1	EACH	LIGHT POLE, 25 FT., CLASS 4
	1156.0	FOOT	CONDUIT IN TRENCH, 1 1/2" DIA., PVC
	3.0	FOOT	CONDUIT IN TRENCH, 2" DIA., PVC
	52.0	FOOT	CONDUIT IN TRENCH, 3" DIA., PVC
	24.0	FOOT	CONDUIT IN TRENCH, 4" DIA., PVC
	524.0	FOOT	CONDUIT, AUGERED, 1 1/2" DIA., PVC
	50.0	FOOT	CONDUIT, AUGERED, 2" DIA., PVC
	198.0	FOOT	CONDUIT, AUGERED, 3" DIA., PVC
	160.0	FOOT	CONDUIT, AUGERED, 4" DIA., PVC
	4	EACH	JUNCTION BOX (SPECIAL)
	5	EACH	HANDHOLE
	1	EACH	DOUBLE HANDHOLE
	1235.0	FOOT	TRENCH AND BACKFILL FOR ELECTRICAL WORK
	925.0	FOOT	ELECTRIC CABLE IN CONDUIT, 600V (XLP-TYPE USE), 3-1/C #12
	4	EACH	LUMINAIRE, SODIUM VAPOR, HORIZONTAL MOUNT, PHOTOCELL CONTROL, 400 WATT
	1	EACH	FULL ACTUATED CONTROLLER AND TYPE IV CABINET
	1	EACH	UNINTERRUPTIBLE POWER SUPPLY, STANDARD

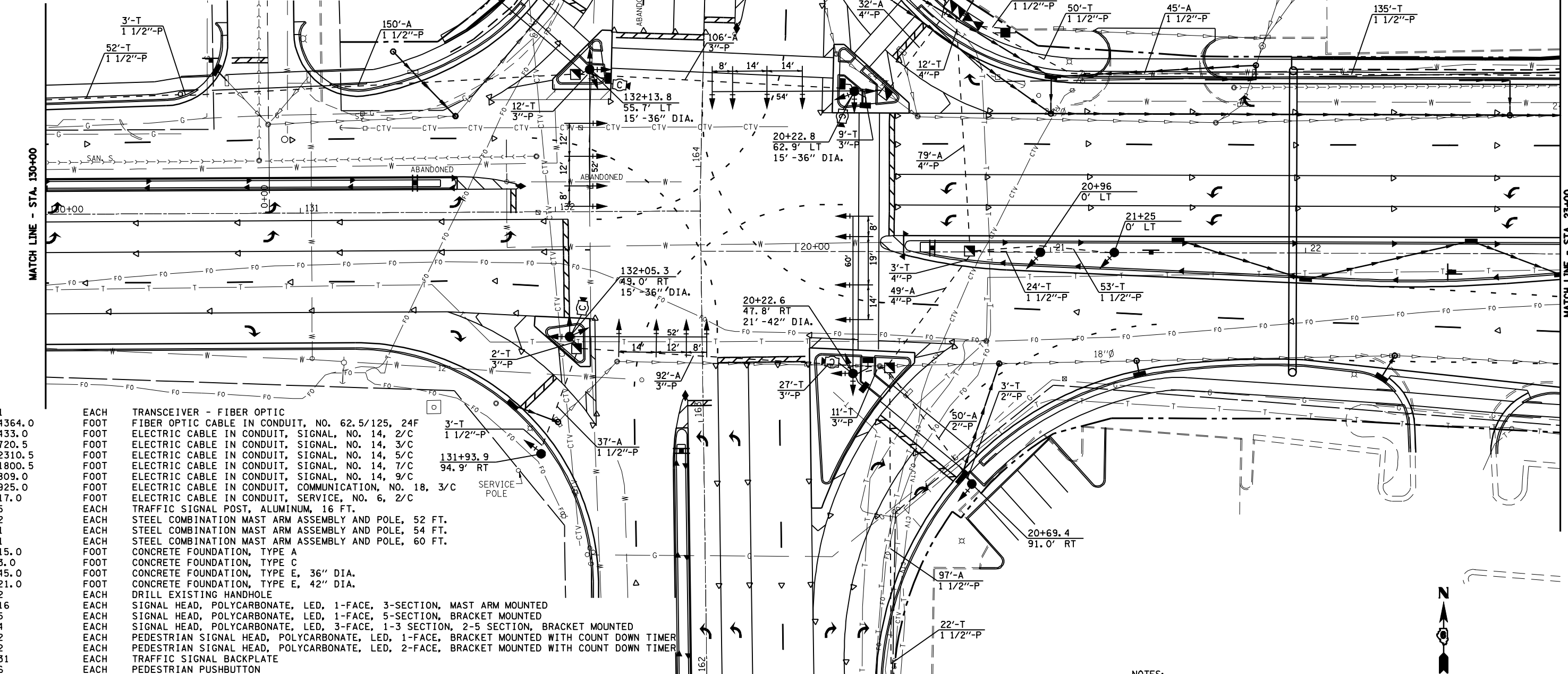

1	EACH	TRANSCEIVER - FIBER OPTIC
4364.0	FOOT	FIBER OPTIC CABLE IN CONDUIT, NO. 62.5/125, 24F
433.0	FOOT	ELECTRIC CABLE IN CONDUIT, SIGNAL, NO. 14, 2/C
720.5	FOOT	ELECTRIC CABLE IN CONDUIT, SIGNAL, NO. 14, 3/C
2310.5	FOOT	ELECTRIC CABLE IN CONDUIT, SIGNAL, NO. 14, 5/C
1800.5	FOOT	ELECTRIC CABLE IN CONDUIT, SIGNAL, NO. 14, 7/C
809.0	FOOT	ELECTRIC CABLE IN CONDUIT, SIGNAL, NO. 14, 9/C
925.0	FOOT	ELECTRIC CABLE IN CONDUIT, COMMUNICATION, NO. 18, 3/C
17.0	FOOT	ELECTRIC CABLE IN CONDUIT, SERVICE, NO. 6, 2/C
5	EACH	TRAFFIC SIGNAL POST, ALUMINUM, 16 FT.
2	EACH	STEEL COMBINATION MAST ARM ASSEMBLY AND POLE, 52 FT.
1	EACH	STEEL COMBINATION MAST ARM ASSEMBLY AND POLE, 54 FT.
1	EACH	STEEL COMBINATION MAST ARM ASSEMBLY AND POLE, 60 FT.
15.0	FOOT	CONCRETE FOUNDATION, TYPE A
3.0	FOOT	CONCRETE FOUNDATION, TYPE C
45.0	FOOT	CONCRETE FOUNDATION, TYPE E, 36" DIA.
21.0	FOOT	CONCRETE FOUNDATION, TYPE E, 42" DIA.
2	EACH	DRILL EXISTING HANDHOLE
16	EACH	SIGNAL HEAD, POLYCARBONATE, LED, 1-FACE, 3-SECTION, MAST ARM MOUNTED
5	EACH	SIGNAL HEAD, POLYCARBONATE, LED, 1-FACE, 5-SECTION, BRACKET MOUNTED
4	EACH	SIGNAL HEAD, POLYCARBONATE, LED, 3-FACE, 1-3 SECTION, 2-5 SECTION, BRACKET MOUNTED
2	EACH	PEDESTRIAN SIGNAL HEAD, POLYCARBONATE, LED, 1-FACE, BRACKET MOUNTED WITH COUNT DOWN TIMER
2	EACH	PEDESTRIAN SIGNAL HEAD, POLYCARBONATE, LED, 2-FACE, BRACKET MOUNTED WITH COUNT DOWN TIMER
31	EACH	TRAFFIC SIGNAL BACKPLATE
6	EACH	PEDESTRIAN PUSHBUTTON
1	EACH	TEMPORARY TRAFFIC SIGNAL INSTALLATION
2694.0	FOOT	REMOVE ELECTRIC CABLE FROM CONDUIT
1	EACH	REMOVE EXISTING TRAFFIC SIGNAL EQUIPMENT
8	EACH	REMOVE EXISTING HANDHOLE
8	EACH	REMOVE EXISTING CONCRETE FOUNDATION
1	EACH	VIDEO VEHICLE DETECTION SYSTEM
683.5	FOOT	ELECTRIC CABLE IN CONDUIT, GROUND, #6 1/C (GREEN)

NOTES:
 1.) TRAFFIC SIGNAL MAST ARM ASSEMBLIES SHALL BE DESIGNED FOR THE LOADINGS SHOWN ON THE HIGHWAY STANDARDS OR THESE SIGNAL PLANS WHICHEVER IS GREATER

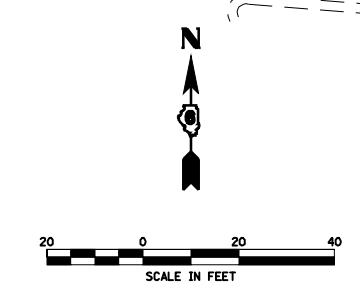

FILE NAME =	USER NAME = laughlinr1	DESIGNED -	REVISED -	STATE OF ILLINOIS DEPARTMENT OF TRANSPORTATION	SCALE:	SHEET NO.	OF SHEETS	STA.	TO STA.	F.A. RTE.	SECTION	COUNTY	TOTAL SHEETS	SHEET NO.
es:\pwwork\pwwd001\LAUGHLINRL\20204163\T.S.Sheets.dgn	DRAWN -	REVISED -	*							**	SANGAMON	363	180	
PLOT SCALE = 40.0000' / IN.	CHECKED -	REVISED -	CONTRACT NO. 72088											
PLOT DATE = Apr-15-2010 11:54:35AM	DATE -	REVISED -	FED. ROAD DIST. NO. ILLINOIS FED. AID PROJECT											