

**TYPICAL SECTION #17**  
**FAP 317 (US 24)**  
 STA. 465+55.3 TO STA. 466+54.41

**LEGEND**

- ① EXIST. SUB-BASE GRANULAR MATERIAL (VAR. 4"-10")
- ② EXIST. PCC PAVEMENT, 8"
- ③ EXIST. BASE COURSE WIDENING, 8"
- ④ EXIST. PCC PAVEMENT 9"-6"-9"
- ⑤ EXIST. NO. 4 TIE BAR
- ⑥ EXIST. HMA SURFACE (3 3/4")
- ⑦ EXIST. HMA SURFACE 2 1/4"
- ⑧ EXIST. HMA OVERLAY 6"
- ⑨ EXIST. LEVELING BINDER (VARIABLE DEPTH)
- ⑩ EXIST. STRIP REFLECTIVE CRACK CONTROL
- ⑪ EXIST. HMA SHOULDERS 6"
- ⑫ EXIST. HMA SHOULDERS 8"
- ⑬ EXIST. AGGREGATE SHOULDER, TYPE A
- ⑭ EXIST. AGGREGATE SHOULDER, TYPE B
- ⑮ EXIST. PCC GUTTER, TYPE B
- ⑯ EXIST. COMBINATION CONCRETE CURB AND GUTTER, TO BE REMOVED
- ⑰ PROP. HOT-MIX ASPHALT SURFACE REMOVAL (VARIABLE DEPTH)
- ⑱ PROP. HOT-MIX ASPHALT SURFACE REMOVAL 2 1/4"
- ⑲ PROP. LEVEL BINDER (MACHINE METHOD), N50 (3/4")
- ⑳ PROP. HOT-MIX ASPHALT SURFACE COURSE, MIX "C", N50 (1 1/2")
- ㉑ PROP. SAFETY SHOULDER - 1'-6" (HOT-MIX ASPHALT SHOULDER 6")
- ㉒ PROP. HOT-MIX ASPHALT SHOULDER - 2 1/4"
- ㉓ PROP. HOT-MIX ASPHALT SHOULDER - 8"
- ㉔ PROP. EXCAVATING AND GRADING EXSITING SHOULDERS
- ㉕ PROP. AGGREGATE SHOULDERS, TYPE B
- ㉖ PROP. HOT-MIX ASPHALT BASE COURSE, 11 1/4"
- ㉗ PROP. SUB-BASE GRANULAR MATERIAL, TYPE A 8"
- ㉘ PROP. PAVEMENT REMOVAL
- ㉙ PROP. COMBINATION CONCRETE CURB & GUTTER, TYPE B-6.24
- ㉚ PROP. PAINT PAVEMENT MARKING LINE 5"

**NOTES**

1. MILL 1/2" MIN. AT  $\bar{C}$  AND MAINTAIN 1.5% SLOPE ON TANGENT SECTIONS.
2. EXISTING AGGREGATE & EARTH SHOULDERS FROM STA. 459+53 TO STA. 463+00. EXISTING RIGHT TURN LANE FROM STA. 463+00 TO STA. 465+55.30
3. PROPOSED SHOULDERS FROM RT. STA. 459+53 TO RT. STA. 461+12.90 SEE DETAIL "A" THIS SHEET FOR DETAILS. PROPOSED RIGHT TURN LANE FROM STA. 460+53.3 TO STA. 465+55.3

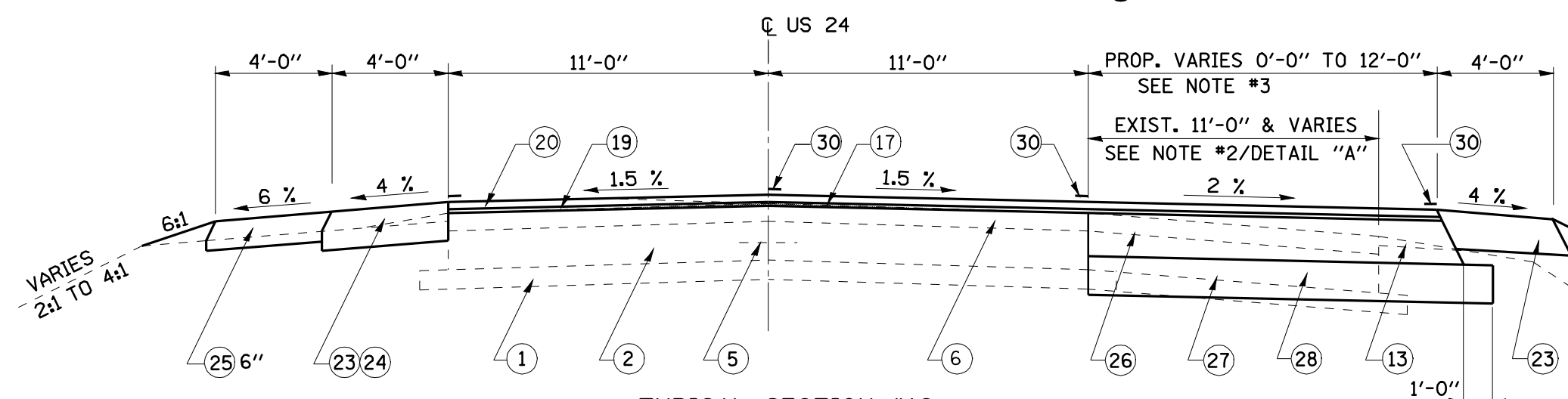

**TYPICAL SECTION #16**  
**FAP 317 (US 24)**  
 STA. 459+53 TO STA. 465+55.30

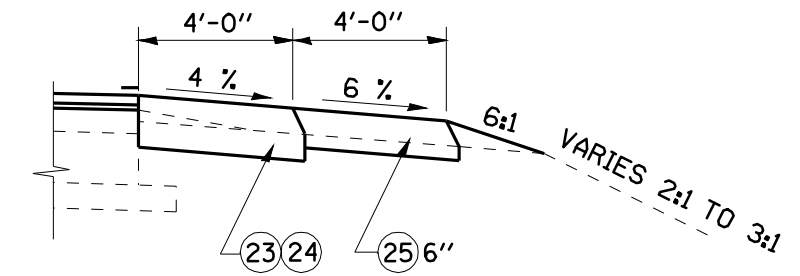

**DETAIL "A"**  
 RT. STA. 459+53.00 TO RT. STA. 460+53.08  
 RT. STA. 468+14.70 TO RT. STA. 469+00.00

FILE NAME =	USER NAME = laughlinr1	DESIGNED -	REVISED -	<b>STATE OF ILLINOIS DEPARTMENT OF TRANSPORTATION</b>	<b>TYPICAL SECTION</b>			F.A.P. RTE. 317	SECTION *	COUNTY **	TOTAL SHEETS 196	SHEET NO. 17
es:\pwork\PWIDOT\LAUGHLINRL\dms20637\0672432-ah-t-typico1.s.dgn		DRAWN -	REVISED -		SCALE:	SHEET NO. OF SHEETS	STA. TO STA.	FED. ROAD DIST. NO.	ILLINOIS FED. AID PROJECT	CONTRACT NO. 72432		
PLOT SCALE = 100.0000' / IN.		CHECKED -	REVISED -									
PLOT DATE = Mar-23-2010 01:59:20PM		DATE -	REVISED -									

• 9RS-4,(10,11)RS-3; (10B-1)R  
 \*\* BROWN & SCHUYLER COUNTIES