

CURVE DATA
 EXIST. CURVE 312
 PI STA. 227+10.38
 $\Delta = 10^\circ 02' 40''$ (LT)
 $D = 1^\circ 59' 30''$
 $R = 2,876.64'$
 $T = 252.80'$
 $L = 504.30'$
 $E = 11.09'$
 $e = \text{-----}$
 $T.R. = \text{-----}$
 $S.E. \text{ RUN} = \text{-----}$
 P.C. STA. = 224+57.58
 P.T. STA. = 229+61.89

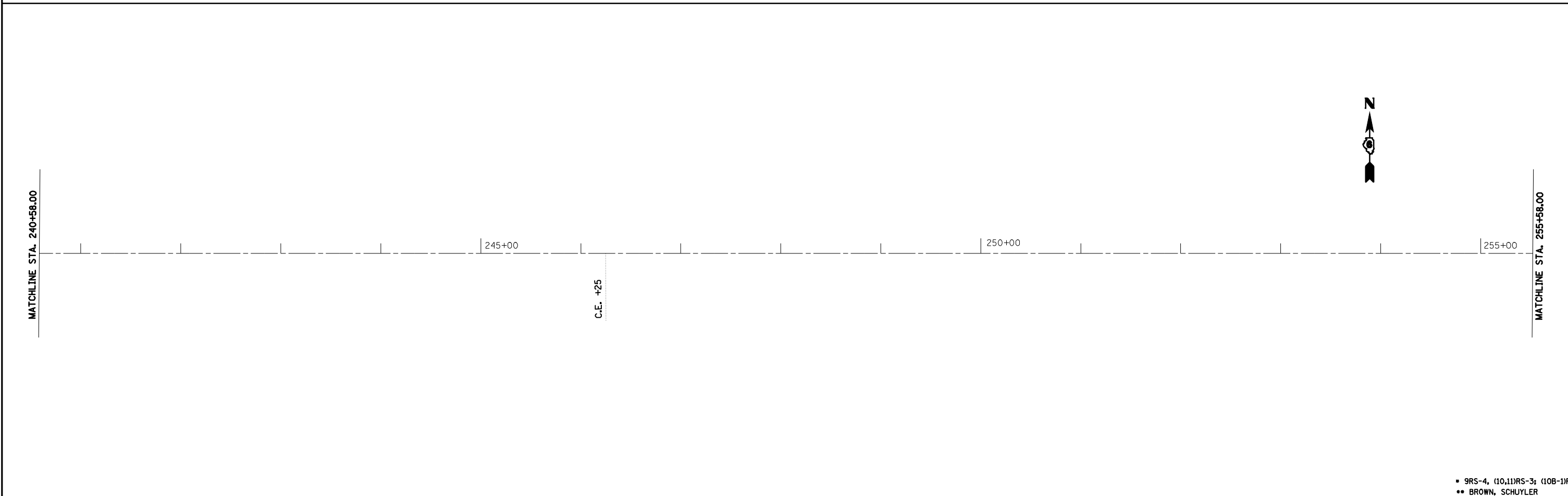

FILE NAME = e:\pwork\PWIDOT\LAUGHLINRL\dms20637\672432-ah-t-plan.dgn USER NAME = laughlinr1		DESIGNED - DRAWN -	REVISED - REVISED -	STATE OF ILLINOIS DEPARTMENT OF TRANSPORTATION	US 24 LINE DIAGRAM			F.A.P. RTE. 317	SECTION .	COUNTY **	TOTAL SHEETS 196	SHEET NO. 43
PLOT SCALE = 100.0000' / IN. PLOT DATE = Mar-23-2010 02:00:14PM		CHECKED - DATE -	REVISED - REVISED -		SCALE:	SHEET NO. OF SHEETS	STA. TO STA.	CONTRACT NO. 72432 ILLINOIS FED. AID PROJECT				
9RS-4, (10.11)RS-3, (10B-1)R BROWN, SCHUYLER												