

EXIST. CURVE 54  
 PI STA. = 2+77.01  
 $\Delta = 13^\circ 23' 26''$  (LT)  
 $D = 5^\circ 24' 00''$   
 $R = 1,061.02'$   
 $T = 124.55'$   
 $L = 247.97'$   
 $E = 7.29'$   
 $e = \text{---}$   
 $T.R. = \text{---}$   
 $S.E. \text{ RUN} = \text{---}$   
 $P.C. \text{ STA.} = 1+52.46$   
 $P.T. \text{ STA.} = 4+00.43$

INSTALL SOLAR POWERED  
 FLASHING BEACON (YELLOW)  
 (STOP AHEAD SIGN)

INSTALL SOLAR POWERED  
 FLASHING BEACON (RED)  
 STOP SIGN SHALL BE INSTALLED  
 ON TELESCOPING STEEL SIGN SUPPORT

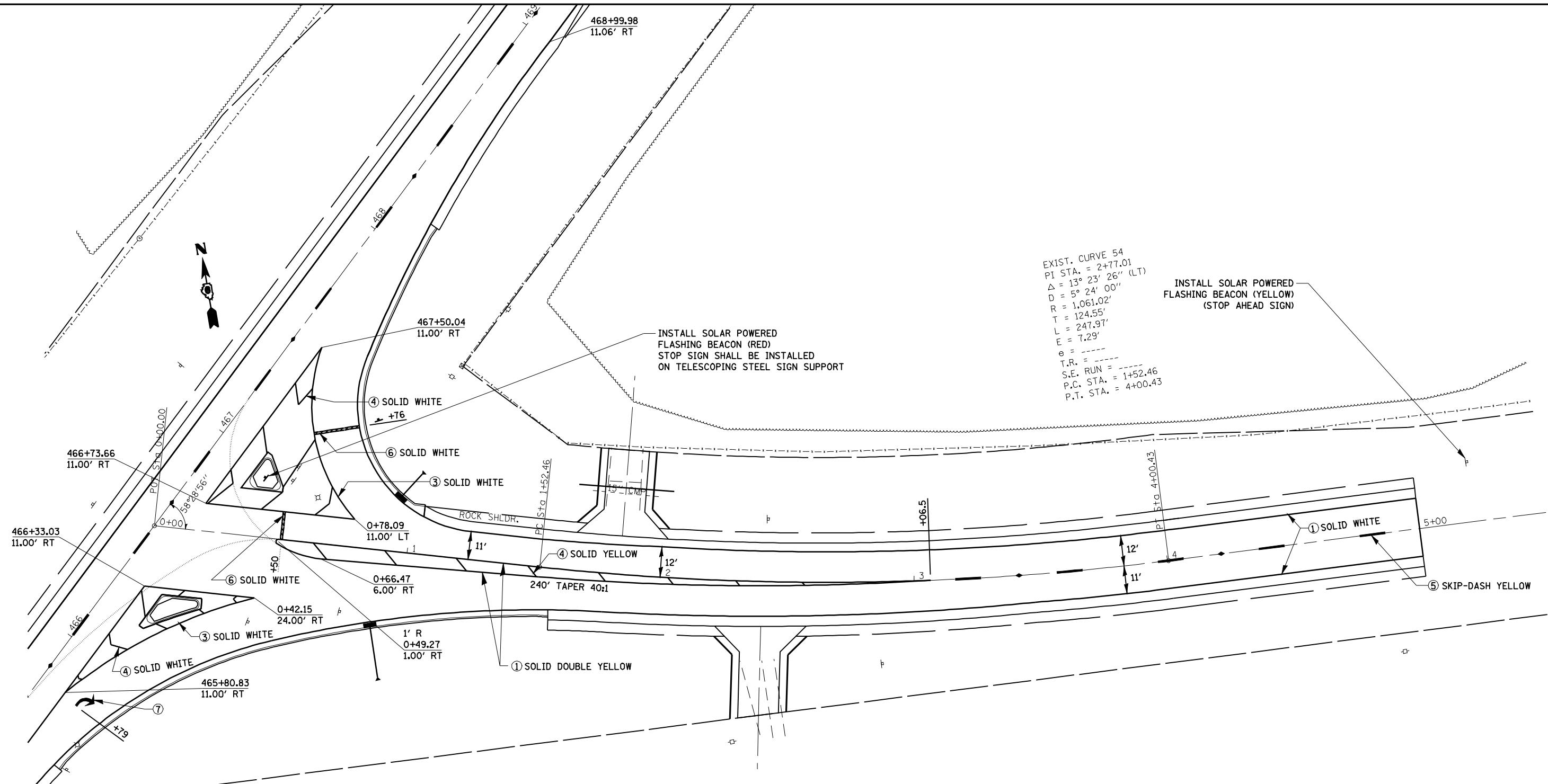

**LEGEND**

- ① THERMOPLASTIC PAVEMENT MARKING - LINE 5"
- ② THERMOPLASTIC PAVEMENT MARKING - LINE 6"
- ③ THERMOPLASTIC PAVEMENT MARKING - LINE 8"
- ④ THERMOPLASTIC PAVEMENT MARKING - LINE 12"
- ⑤ PREFORMED PLASTIC PAVEMENT MARKING, TYPE B - INLAID - LINE 5"
- ⑥ PREFORMED PLASTIC PAVEMENT MARKING, TYPE B - INLAID - LINE 24"
- ⑦ PREFORMED PLASTIC PAVEMENT MARKING, TYPE B - INLAID - LETTERS & SYMBOLS
- ⑧ PREFORMED PLASTIC PAVEMENT MARKING, TYPE B - INLAID - LINE 6"

• 9RS-4,(10,11)RS-3; (10B-1)R  
 \*\* BROWN & SCHUYLER COUNTIES

FILE NAME =	USER NAME = laughlinr1	DESIGNED -	REVISED -	<b>STATE OF ILLINOIS DEPARTMENT OF TRANSPORTATION</b>	<b>IL 103 PAVEMENT MARKING</b>				F.A.P. RTE.	SECTION	COUNTY	TOTAL SHEETS	SHEET NO.
er:\pwork\PWIDOT\LAUGHLINRL\dms21580\0672432-ah-t-pmk.dgn		DRAWN -	REVISED -		317	.	**	196	57				
PLOT SCALE = 48.0001" / IN.		CHECKED -	REVISED -		CONTRACT NO. 72432								
PLOT DATE = Mar-23-2010 02:00:55PM		DATE -	REVISED -		FED. ROAD DIST. NO.	ILLINOIS FED. AID PROJECT							