

STATE OF ILLINOIS  
DEPARTMENT OF TRANSPORTATION

Notes:  
See sheet 11 of 29 for Sections C-C & D-D.  
 $a_6(E)$  and  $a_7(E)$  bar spacings measured along  $\varnothing$  Rdwy.  
See sheet 18 thru 21 of 29 for Wingwall details.

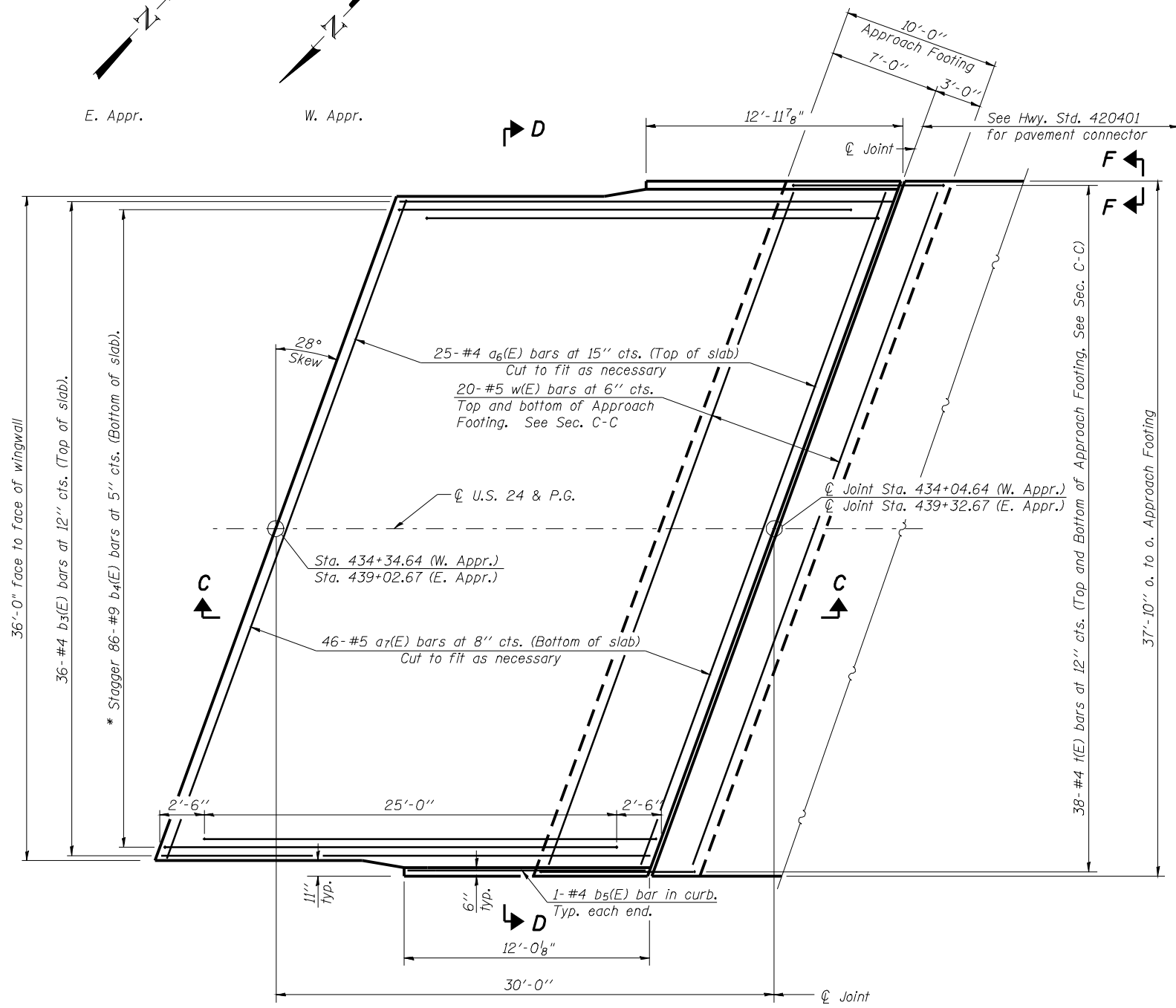

PLAN

\* Tilt #9  $b_4(E)$  bars as required to maintain clearance.

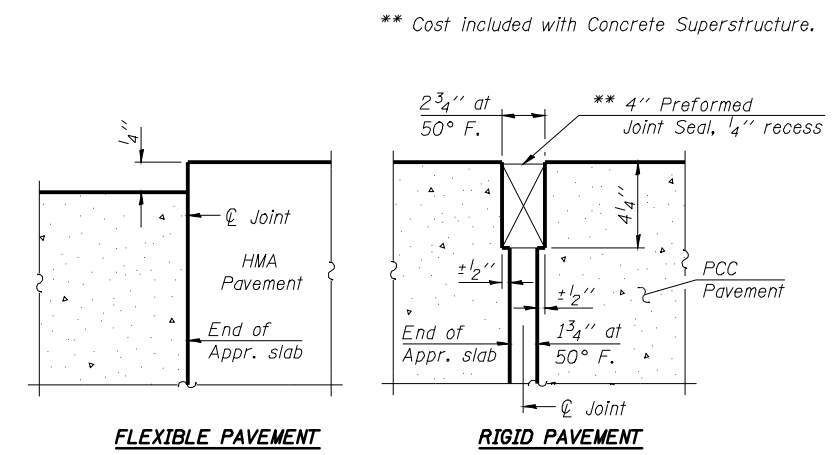

DETAIL A

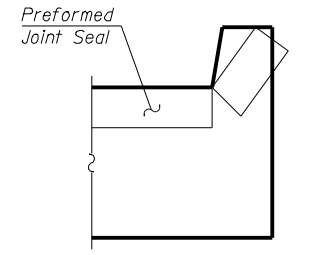
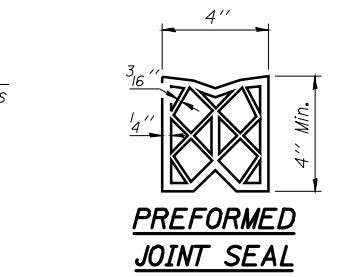

VIEW F-F

Angle Preformed Joint Seal at 45° at curbs when req'd for drainage.

**BRIDGE APPROACH SLAB DETAILS-1**  
**STRUCTURE NO. 005-0500**

<p>LIN ENGINEERING, LTD. Consulting Engineers Chatham, Illinois</p> <p>Designed By: ADB Date: 06/2009</p> <p>Checked By: MTH File: 005-0500.DGN</p> <p>Drawn By: A.J.F.</p>	SHEET NO. 10	F.A.P. RTE.	SECTION	COUNTY	TOTAL SHEETS	SHEET NO.
	29 SHEETS	317	(10B-1)R	BROWN/SCHUYLER	196	129
CONTRACT NO. 72432					ILLINOIS FED. AID PROJECT	