

F.A.P. RTE.	SECTION	COUNTY	TOTAL SHEETS	SHEET NO.
322	11-12	CHRISTIAN	284	139
STA. 322		TO STA.		
FED. ROAD DIST. NO.		ILLINOIS FED. AID PROJECT		

**PERFORMANCE REQUIREMENTS**

NOTE: These performance requirements shall be the minimum acceptable standards of photometric performance for the luminaire.

ILLUMINATION: Average Horizontal Illumination, (Eave)	9.0 Lux
Uniformity Ratio, (Eave/Emin)	3.0
LUMINANCE: Average Luminance, (Lave)	0.6 Cd/sq. m
Uniformity Ratios: (Lave/Lmin)	3.5
(Lmax/Lmin)	6.0
Maximum Veiling Luminance Ratio: (Lv/Lave)	0.3

**LEGEND**

- LIGHTING CONTROLLER, POLE MOUNTED, 240 VOLT, 60 AMP
- LIGHT POLE ALUMINUM, 45' MOUNTING HEIGHT, 15' DAVIT ARM WITH 250 WATT HPS HORIZONTAL-MOUNT LUMINAIRE
- UNIT DUCT (AS NOTED)
- 2" PVC (SCH 80) CONDUIT PUSHED (LENGTH AS NOTED)

NOTES:  
 POLES TO BE OFFSET 15' BACK FROM EDGE OF PAVEMENT, FURTHER BACK IF IN FLOWLINE OF DITCH. IN THAT CASE, MOVE FURTHER BACK OUT OF THE FLOWLINE OR AS DIRECTED BY THE ENGINEER.

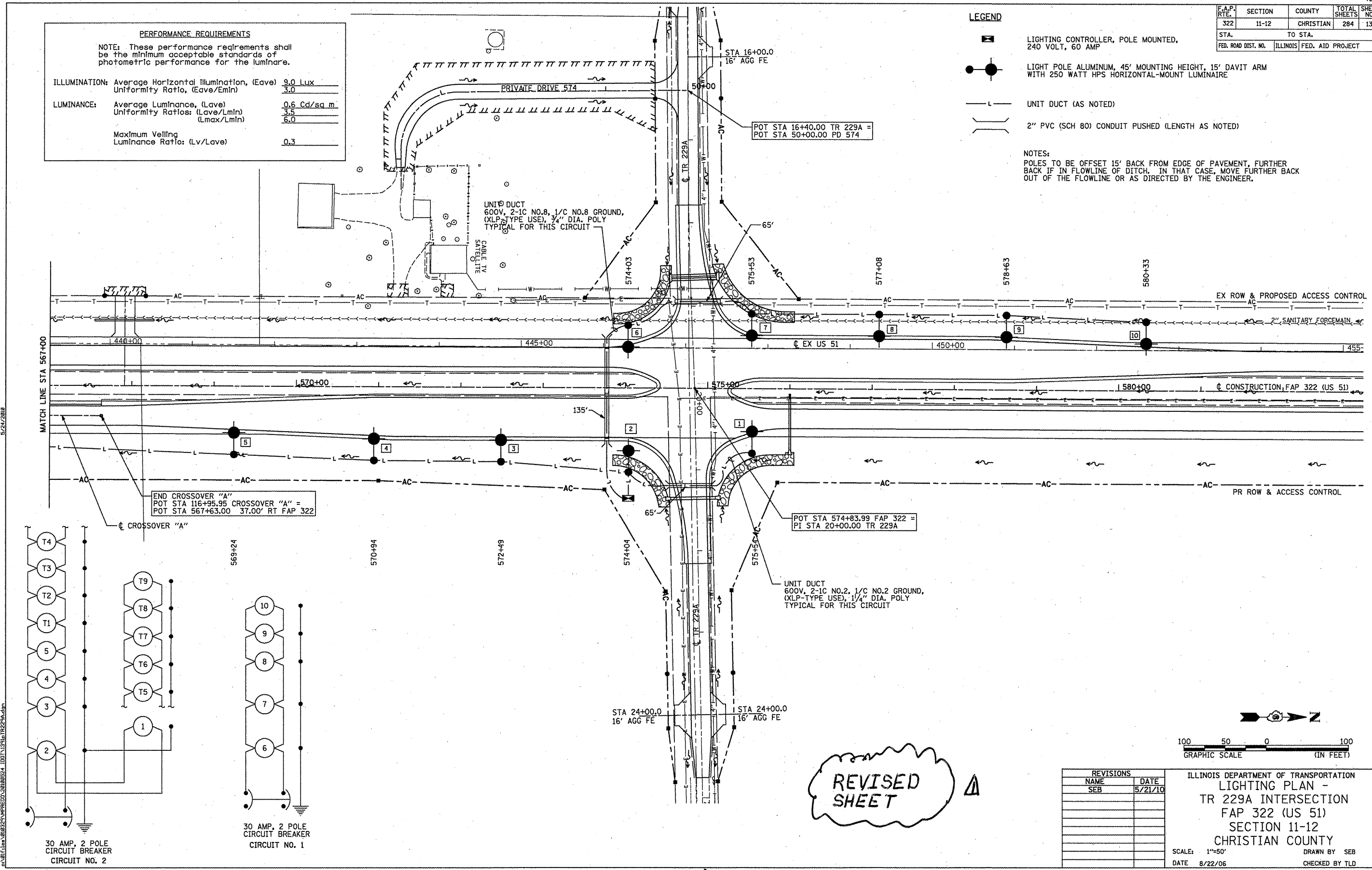

END CROSSOVER "A"  
 POT STA 116+95.95 CROSSOVER "A" =  
 POT STA 567+63.00 37.00' RT FAP 322

POT STA 574+83.99 FAP 322 =  
 PI STA 20+00.00 TR 229A

UNIT DUCT  
 600V, 2-1C NO.2, 1/C NO.2 GROUND,  
 OXLP-TYPE USE, 1/4" DIA. POLY  
 TYPICAL FOR THIS CIRCUIT

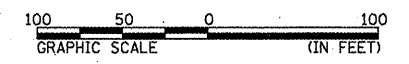
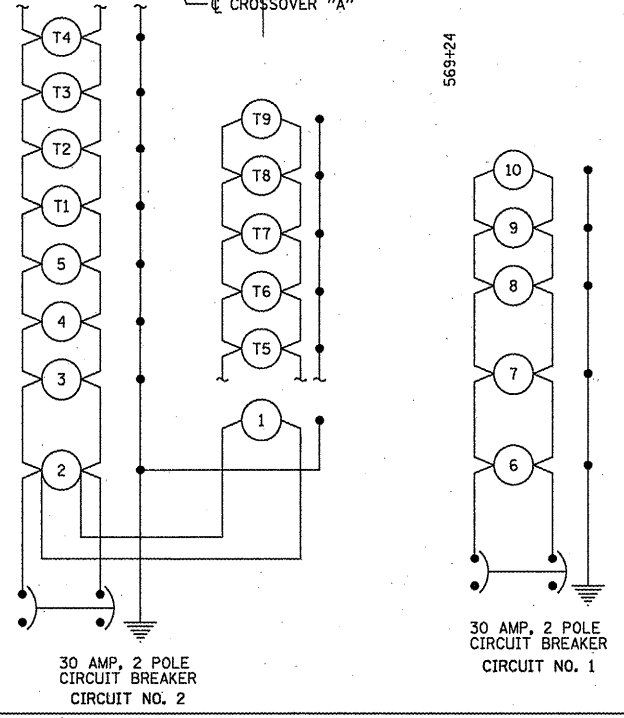

**REVISED SHEET**

REVISIONS	
NAME	DATE
SEB	5/21/10

ILLINOIS DEPARTMENT OF TRANSPORTATION  
 LIGHTING PLAN -  
 TR 229A INTERSECTION  
 FAP 322 (US 51)  
 SECTION 11-12  
 CHRISTIAN COUNTY

SCALE: 1"=50'  
 DATE: 8/22/06

DRAWN BY SEB  
 CHECKED BY TLD