

F.A.P. RTE.	SECTION	COUNTY	TOTAL SHEETS	SHEET NO.
322	11-12	CHRISTIAN	284	56
STA.	TO STA.			
FED. ROAD DIST. NO.	ILLINOIS	FED. AID PROJECT		

TYPICAL STAGE 2 SIGNAGE & STRIPING PLAN WEST LEG TO BE RECONSTRUCTED

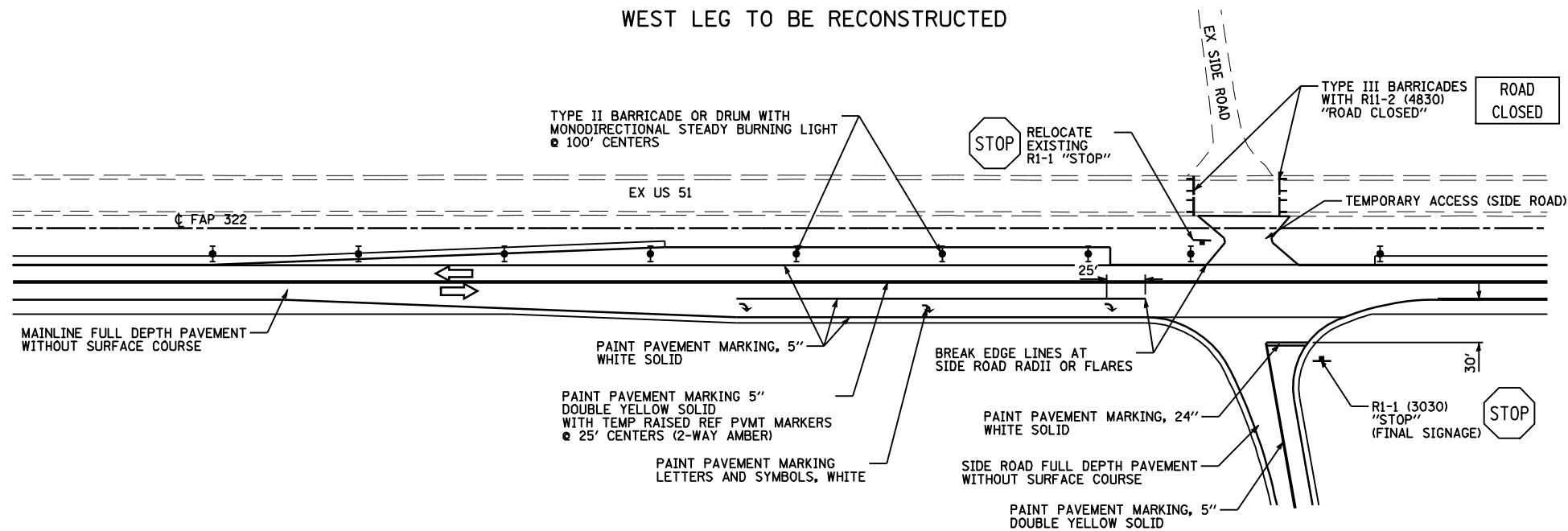

NOTES:

ALL SIGNS SHALL BE MOUNTED ACCORDING TO STANDARD 702001 OR METHOD APPROVED BY THE ENGINEER.

THE TRAFFIC CONTROL SET UP FOR SIDE ROAD INTERSECTIONS DURING STAGE CONSTRUCTION WILL NOT BE MEASURED AND PAID FOR SEPERATELY. THE COST WILL BE CONSIDERED TO BE INCLUDED IN THE CONTRACT UNIT BID PRICES OF THE TRAFFIC CONTROL AND PAY ITEMS INCLUDED IN THE CONTRACT. THESE TEMPORARY SIGNS, BARRICADES, AND DRUMS WILL REMAIN THE PROPERTY OF THE CONTRACTOR. TEMPORARY PAVEMENT STRIPING SHALL BE PAID FOR SEPERATELY.

TYPICAL STAGE 2 SIGNAGE & STRIPING PLAN WEST LEG CONSTRUCTED

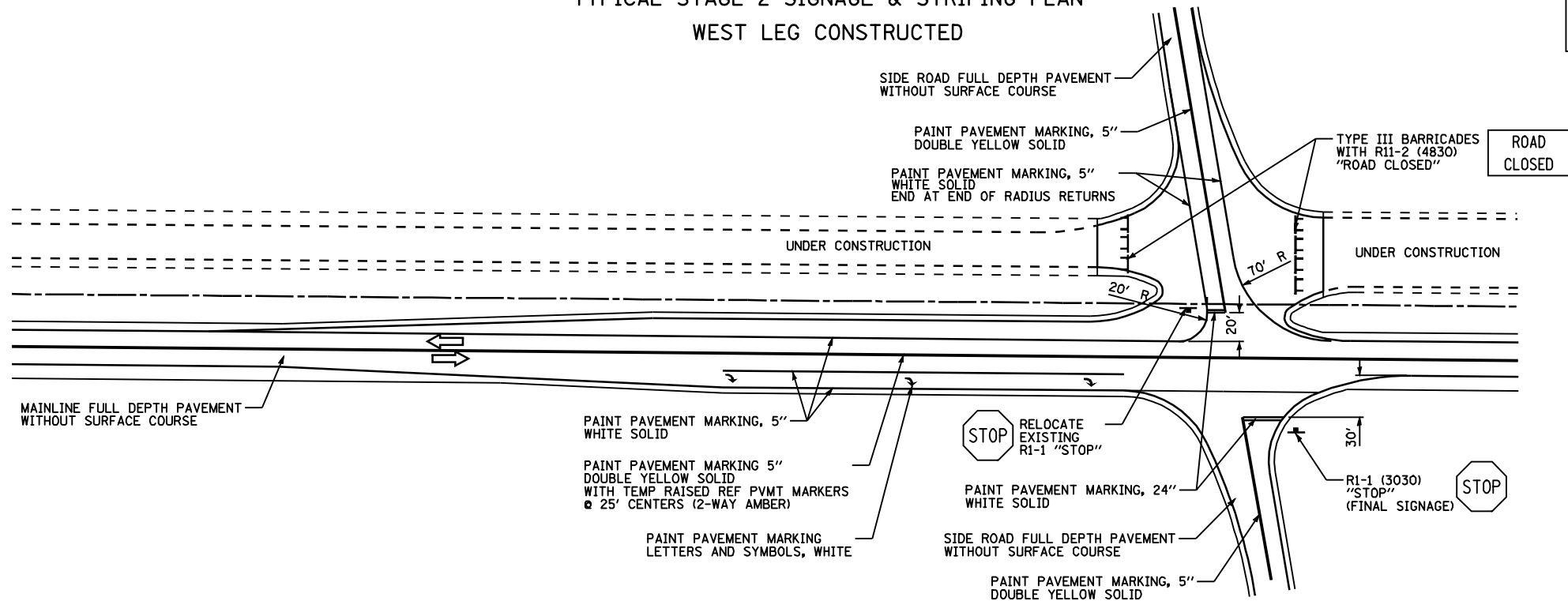

SEE STRIPING PLAN (SHEETS 111 - 130) FOR STRIPING ON TOP LIFT OF FULL-DEPTH PAVEMENT.

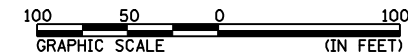

REVISIONS		NAME	DATE
NO.	DESCRIPTION		

ILLINOIS DEPARTMENT OF TRANSPORTATION
TRAFFIC CONTROL AND STAGING
SIGNAGE AND STRIPING
FAP 322 (US 51)
SECTION 11-12
CHRISTIAN COUNTY

SCALE: 1"=50' DRAWN BY: SEB
DATE: 8/22/06 CHECKED BY: TLD

Mo-15-2018 0144555PM

FILE