

F.A.P. RTE.	SECTION	COUNTY	TOTAL SHEETS	SHEET NO.
322	11-12	CHRISTIAN	284	149
STA.		TO STA.		
FED. ROAD DIST. NO.		ILLINOIS FED. AID PROJECT		

SE 1/4 SEC 14, T12N, R1E, 3RD PM

NE 1/4 SEC 14, T12N, R1E, 3RD PM

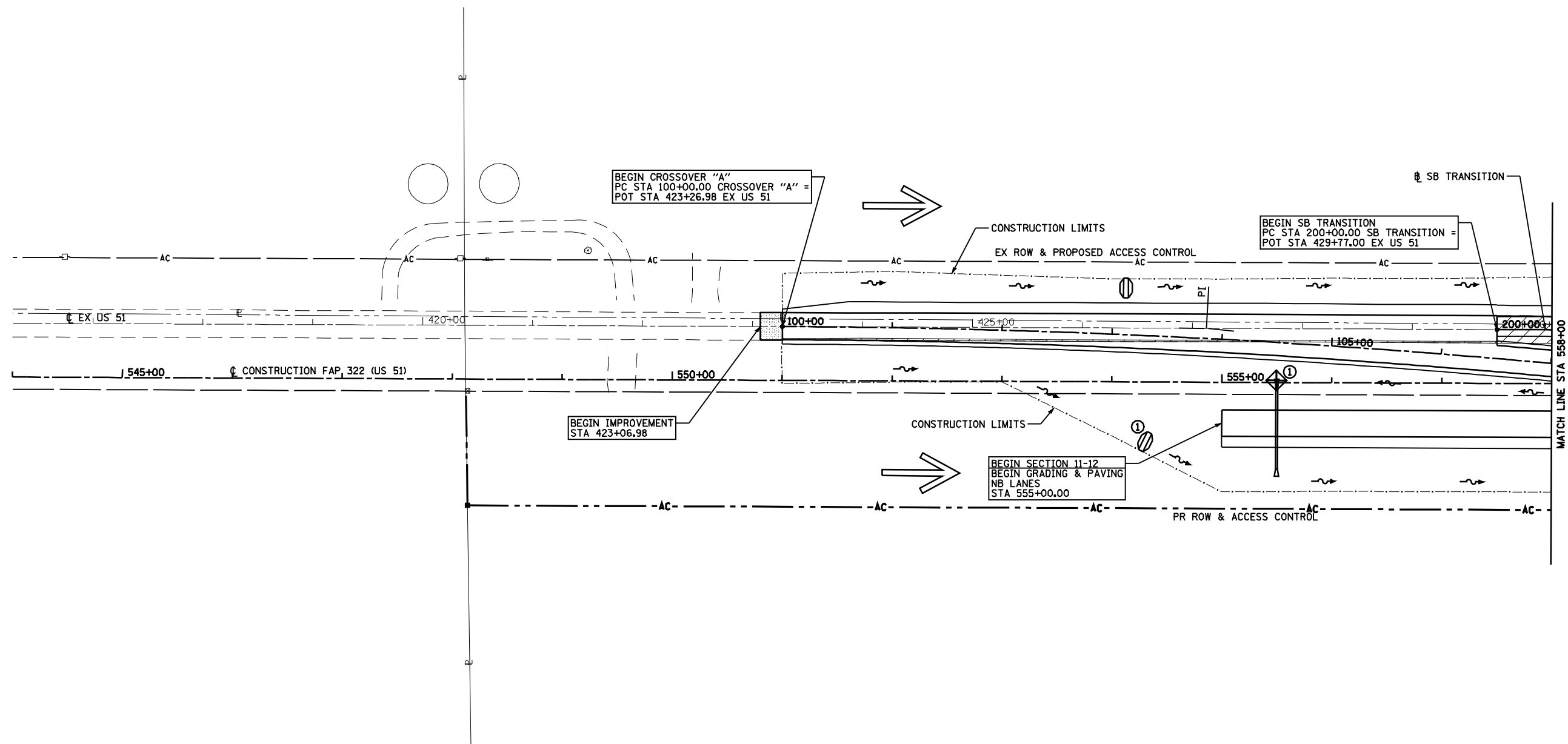

SW 1/4 SEC 13, T12N, R1E, 3RD PM

NW 1/4 SEC 13, T12N, R1E, 3RD PM

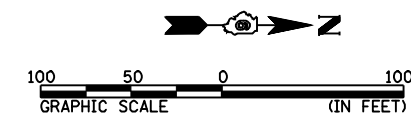

REVISIONS	
NAME	DATE

ILLINOIS DEPARTMENT OF TRANSPORTATION  
 STORM WATER POLLUTION PREVENTION PLAN  
 FAP 322 (US 51)  
 SECTION 11-12  
 CHRISTIAN COUNTY

SCALE: 1"=50'  
 DATE: 8/22/06  
 DRAWN BY: BGJ  
 CHECKED BY: SEB

FAP 322 (US 51) STA 544+00 TO STA 558+00

Mo-15-2018 12:29:26PM

FILE