

F.A.P. RTE.	SECTION	COUNTY	TOTAL SHEETS	SHEET NO.
322	11-12	CHRISTIAN	284	158
STA.		TO STA.		
FED. ROAD DIST. NO.		ILLINOIS FED. AID PROJECT		

NW 1/4 SEC 1, T12N, R1E, 3RD PM

SW 1/4 SEC 36, T13N, R1E, 3RD PM

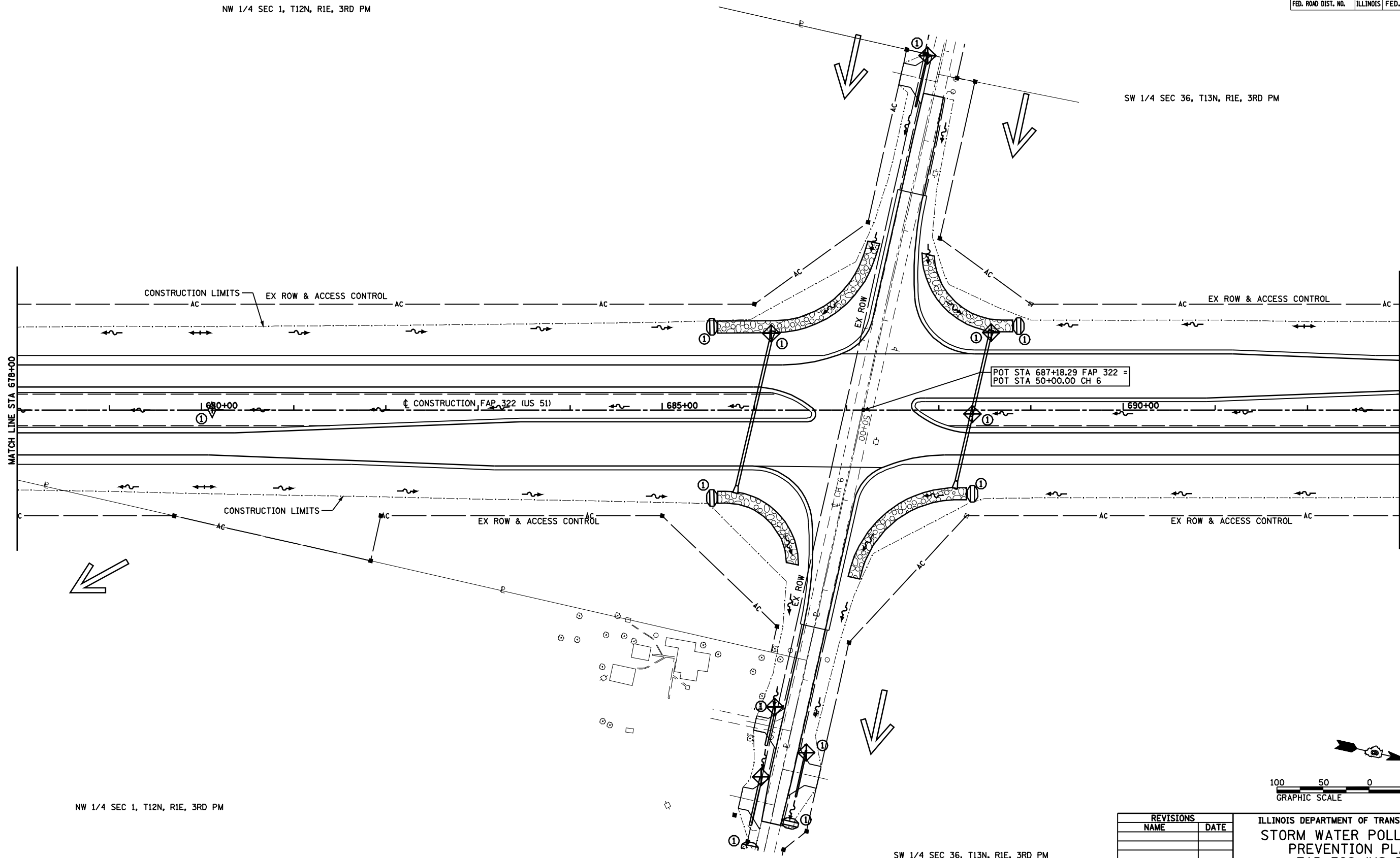

NW 1/4 SEC 1, T12N, R1E, 3RD PM

SW 1/4 SEC 36, T13N, R1E, 3RD PM

REVISIONS	
NAME	DATE

ILLINOIS DEPARTMENT OF TRANSPORTATION
 STORM WATER POLLUTION
 PREVENTION PLAN
 FAP 322 (US 51)
 SECTION 11-12
 CHRISTIAN COUNTY

SCALE: 1"=50'
 DATE: 8/22/06
 DRAWN BY: BGJ
 CHECKED BY: SEB

FAP 322 (US 51) STA 678+00 TO STA 693+00

Mo-15-2018 12:29:46PM

\$FILE\$