

STATE OF ILLINOIS
DEPARTMENT OF TRANSPORTATION
DIVISION OF HIGHWAYS

**PROPOSED
HIGHWAY PLANS**

FAS ROUTE 1773 (BL-55) & FAU ROUTE 7706 (OLD US 66)
SECTION 21RS-4, 22RS-5

LOGAN COUNTY

C-96-137-10

F.A.S./RTE.	SECTION	COUNTY	TOTAL SHEETS	SHEET NO.
•	21RS-4, 22RS-5	LOGAN	31	1
		ILLINOIS	CONTRACT NO. 72A44	

• FAS 1773/ FAU 7706

D-96-520-06

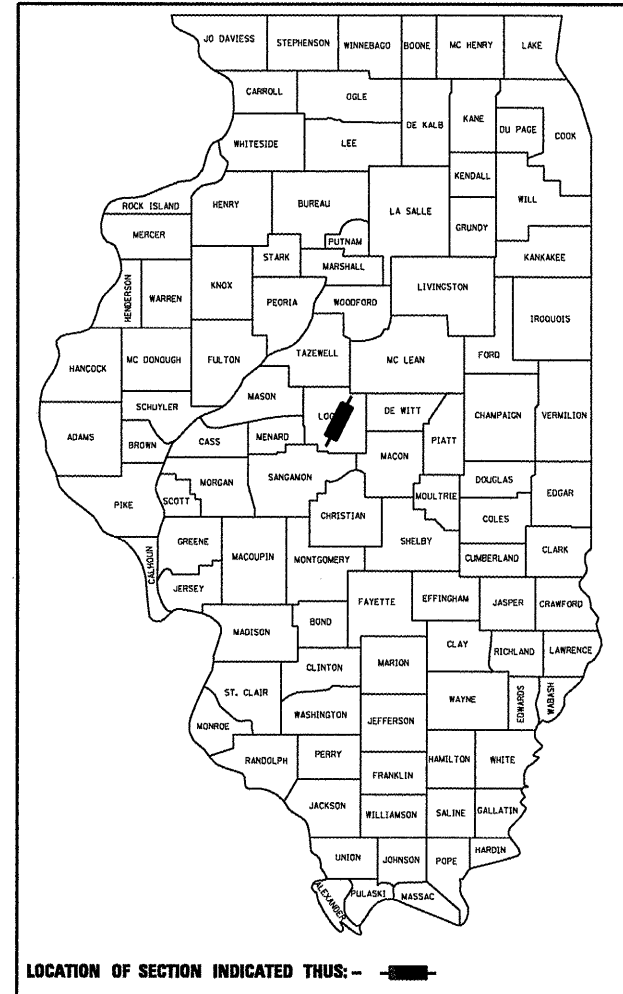

INDEX OF SHEETS

- 1 COVER SHEET
- 2 GENERAL NOTES
- 3 SUMMARY OF QUANTITIES
- 4-9 SCHEDULE OF QUANTITIES
- 10-12 TYPICAL SECTIONS
- 13-29 PLAN SHEETS
- 30-31 DETAIL SHEETS

TRAFFIC

ADT 5138 (2006)
%SU = 10.0 (2006)
%MU = 4.0 (2006)

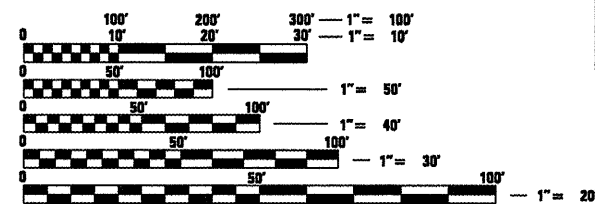

FULL SIZE PLANS HAVE BEEN PREPARED USING STANDARD ENGINEERING SCALES. REDUCED SIZED PLANS WILL NOT CONFORM TO STANDARD SCALES. IN MAKING MEASUREMENTS ON REDUCED PLANS, THE ABOVE SCALES MAY BE USED.

J.U.L.I.E.
JOINT UTILITY LOCATION INFORMATION FOR EXCAVATION
1-800-892-0123
OR 811

PROJECT ENGINEER : JOHN NEGANGARD
PROJECT MANAGER : VICTOR YOUNG

CONTRACT NO. 72A44

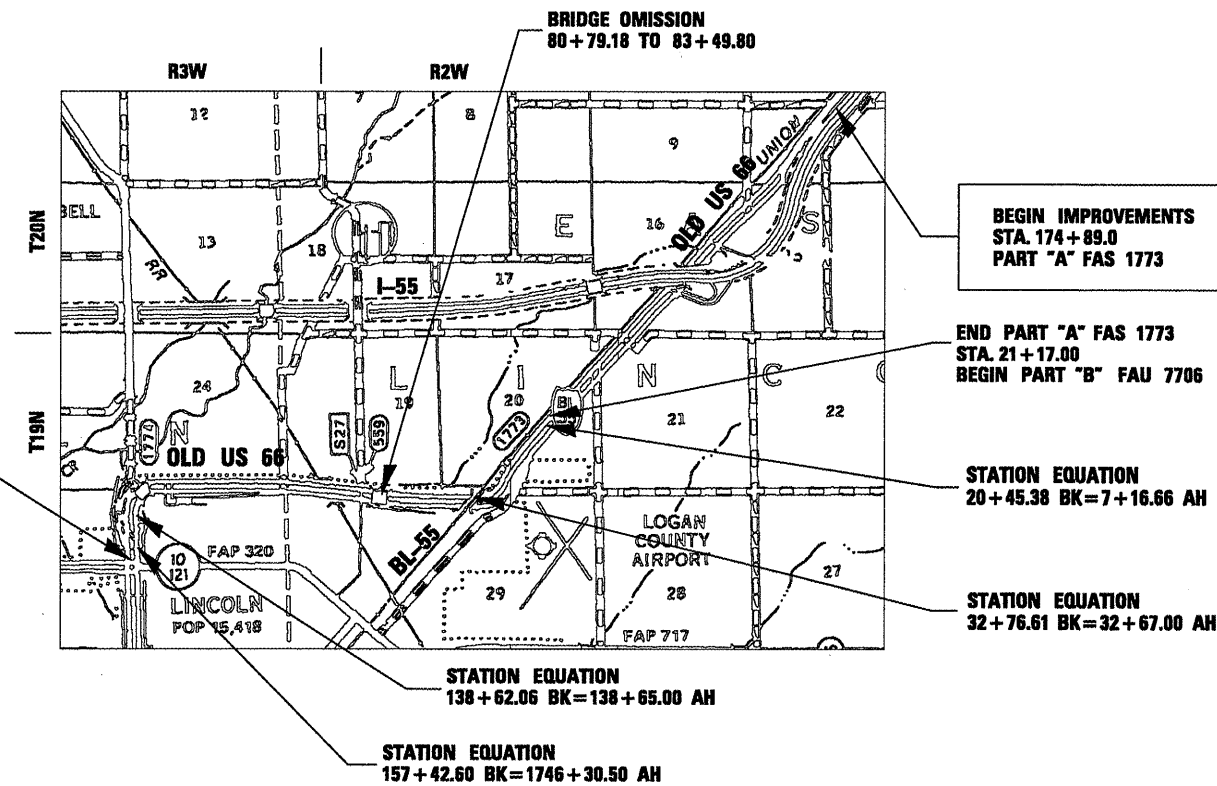

GROSS LENGTH = 31,655.03 FT. = 5.99 MILE
NET LENGTH = 31,384.41 FT. = 5.94 MILE

STATE OF ILLINOIS
DEPARTMENT OF TRANSPORTATION
DIVISION OF HIGHWAYS

SUBMITTED April 8 2010
Roger Z. Dinskey
DEPUTY DIRECTOR OF HIGHWAYS, REGION ENGINEER

May 7 2010
Scott E. Stitt, P.E.
acting ENGINEER OF DESIGN AND ENVIRONMENT

May 7 2010
Christine M. Roser
DIRECTOR OF HIGHWAYS, CHIEF ENGINEER

**PRINTED BY THE AUTHORITY
OF THE STATE OF ILLINOIS**