

EXIST. CURVE 23  
 PI STA. = 410+98.40  
 $\Delta = 2^\circ 25' 00''$  (RT)  
 D =  $0^\circ 55' 00''$   
 R = 6,250.56'  
 T = 131.84'  
 L = 263.64'  
 E = 1.39'  
 e = 2.6%  
 T.R. = 39.81'  
 S.E. RUN = 69'  
 P.C. STA. = 409+66.56  
 P.T. STA. = 412+30.20

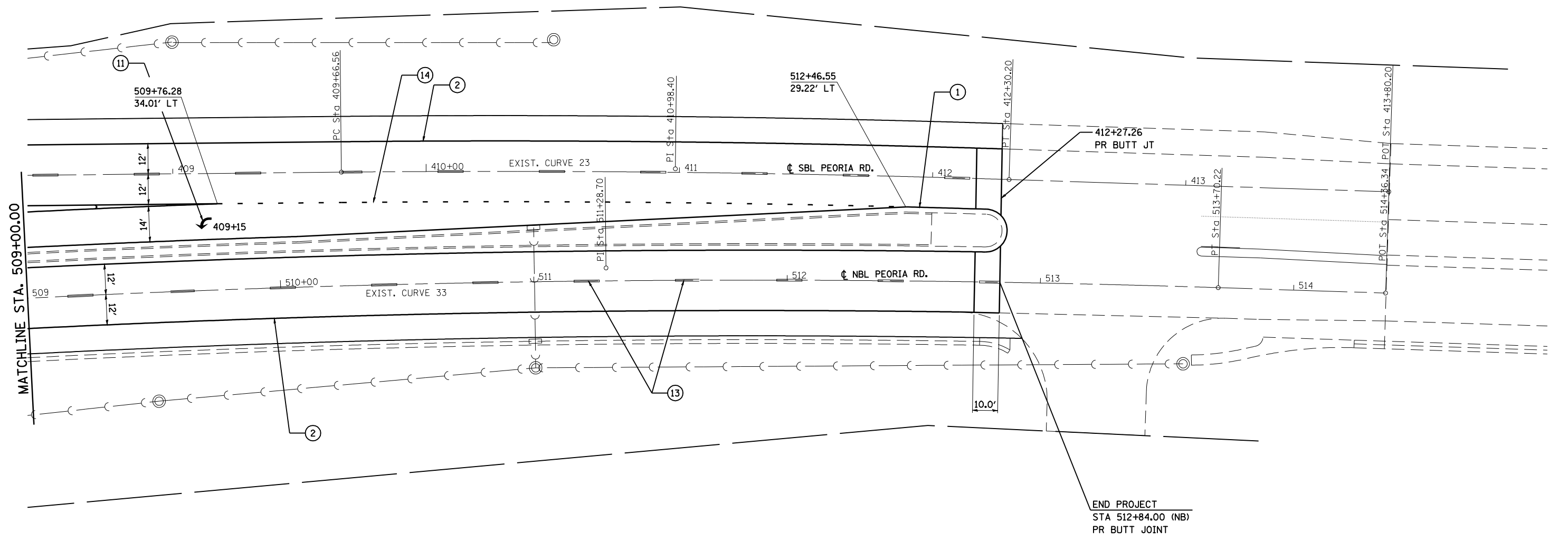

**LEGEND**

- |                            |   |
|----------------------------|---|
| ① URETHANE- 5" YELLOW      | ⑨ THERMOPLASTIC- 12" YELLOW                             |
| ② URETHANE- 5" WHITE       | ⑩ THERMOPLASTIC- 12" WHITE                              |
| ③ URETHANE- 8" WHITE       | ⑪ PREFORMED PLASTIC TYPE B- INLAID- LETTERS AND SYMBOLS |
| ④ URETHANE- 12" YELLOW     | ⑫ PREFORMED PLASTIC TYPE B- INLAID - 5" YELLOW          |
| ⑤ URETHANE-12" WHITE       | ⑬ PREFORMED PLASTIC TYPE B- INLAID - 5" WHITE           |
| ⑥ THERMOPLASTIC- 5" YELLOW | ⑭ PREFORMED PLASTIC TYPE B- INLAID - 6" WHITE           |
| ⑦ THERMOPLASTIC- 5" WHITE  | ⑮ PREFORMED PLASTIC TYPE B- INLAID - 24" WHITE          |
| ⑧ THERMOPLASTIC- 8" WHITE  |   |

EXIST. CURVE 33  
 PI STA. = 511+28.70  
 $\Delta = 4^\circ 50' 00''$  (RT)  
 D =  $1^\circ 00' 00''$   
 R = 5,729.58'  
 T = 241.81'  
 L = 483.33'  
 E = 5.10'  
 e = 2.6%  
 T.R. = 39.81'  
 S.E. RUN = 69'  
 P.C. STA. = 508+86.89  
 P.T. STA. = 513+70.22

FILE NAME =	USER NAME = laughlinr1	DESIGNED -	REVISED -	<b>STATE OF ILLINOIS DEPARTMENT OF TRANSPORTATION</b>	<b>PLAN SHEET - SECTION "C" (PEORIA RD.)</b>		F.A.P. RTE.	SECTION	COUNTY	TOTAL SHEETS	SHEET NO.	
et:\pwork\pwidot\LAUGHLINRL\dms47710\672C35-SHT-plan-peoria.tbl		DRAWN -	REVISED -		SCALE:	SHEET NO. 13 OF 13 SHEETS	STA.	TO STA.	658		206	117
		CHECKED -	REVISED -						CONTRACT NO. 72C35			
		DATE -	REVISED -		ILLINOIS FED. AID PROJECT							

\* 1-1(RS,TS-1027RS-6)79Z&102RS-4